

- NOTES:**
- FOR PROPOSED SIGN PANEL LAYOUT DIMENSIONS, SEE SIGN PANEL DETAILS SHEET.
 - PROPOSED SIGN OFFSET IS MEASURED FROM CENTERLINE OF SPECIFIED ROAD TO THE SIGN CENTER UNLESS OTHERWISE NOTED.
 - FOR A SUMMARY OF SIGN REMOVALS, SEE REMOVAL SCHEDULES.

LEGEND	
① - THERMOPLASTIC PAVEMENT MARKING - LETTERS AND SYMBOLS	⑤ - PREFORMED PLASTIC PAVEMENT MARKING, TYPE B - INLAID - LETTERS AND SYMBOLS
② - THERMOPLASTIC PAVEMENT MARKING - LINE 4"	⑥ - PREFORMED PLASTIC PAVEMENT MARKING, TYPE B - INLAID - LINE 4"
③ - THERMOPLASTIC PAVEMENT MARKING - LINE 12"	⑦ - PREFORMED PLASTIC PAVEMENT MARKING, TYPE B - INLAID - LINE 8"
④ - THERMOPLASTIC PAVEMENT MARKING - LINE 24"	⑧ - PREFORMED PLASTIC PAVEMENT MARKING, TYPE B - INLAID - LINE 12"
Ⓐ - DENOTES STANDARD SIGN PANELS (SEE NOTE 1)	⑨ - PREFORMED PLASTIC PAVEMENT MARKING, TYPE B - INLAID - LINE 24"
Ⓝ-1 - DENOTES NON-STANDARD SIGN PANELS (SEE NOTE 1)	Ⓞ - RAISED REFLECTIVE PAVEMENT MARKERS
Ⓟ - EXISTING SIGN TO BE REMOVED	● - PROPOSED SIGNS

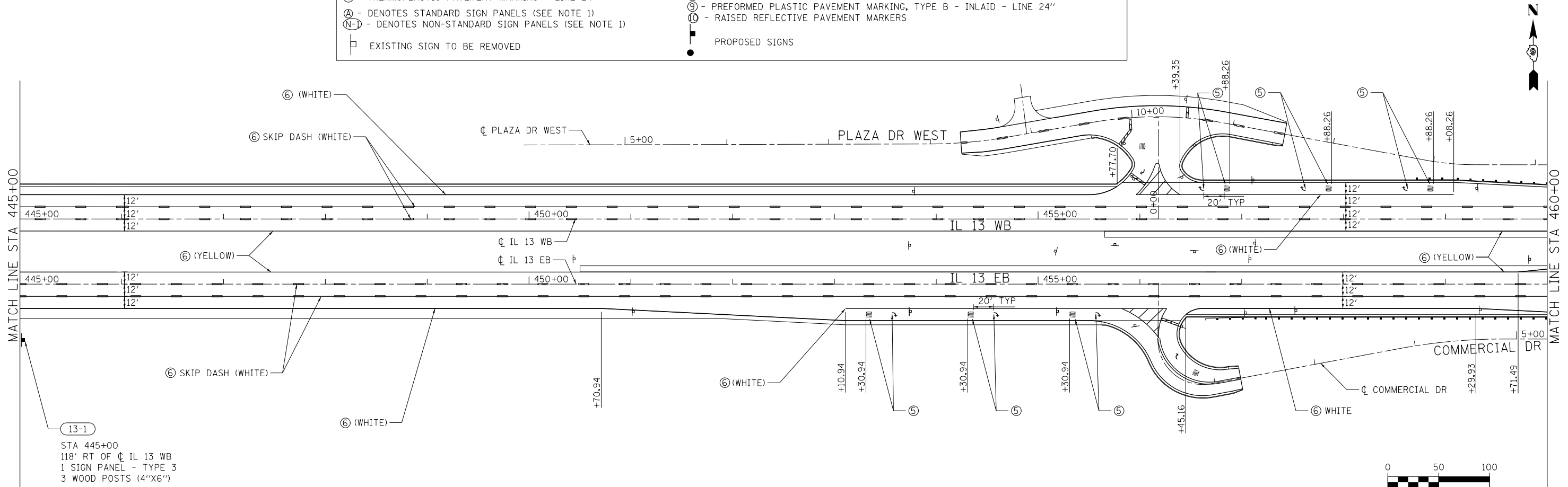

13-1
 STA 445+00
 118' RT OF CL IL 13 WB
 1 SIGN PANEL - TYPE 3
 3 WOOD POSTS (4"X6")

FILE NAME = D978258-sht-pmk-01.dgn
CH2MHILL

USER NAME = mfox	DESIGNED - KN	REVISED -
PLOT SCALE = 100.0000' / in.	DRAWN - AS	REVISED -
PLOT DATE = 3/11/2013	CHECKED -	REVISED -
	DATE -	REVISED -

**STATE OF ILLINOIS
 DEPARTMENT OF TRANSPORTATION**

**PAVEMENT MARKING AND SIGNING PLAN
 IL 13**

SCALE: SHEET NO. 1 OF 16 SHEETS STA. 441+02.20 TO STA. 460+00.00

F.A.P. RTE.	SECTION	COUNTY	TOTAL SHEETS	SHEET NO.
331	(1-4)R-2, N-4, TS-4	WILLIAMSON	381	222
DRAWING NO. PM-01		CONTRACT NO. 78258		
ILLINOIS FED. AID PROJECT				