

- NOTES:**
- FOR PROPOSED SIGN PANEL LAYOUT AND DIMENSIONS, SEE SIGN PANEL DETAILS SHEET.
 - PROPOSED SIGN OFFSET IS MEASURED FROM CENTERLINE OF SPECIFIED ROAD TO THE SIGN CENTER UNLESS OTHERWISE NOTED.
 - THE INTERSECTION OF NORTH FRONTAGE RD / DIVISION ST NORTH SIGNING IS COVERED ON PM-05 (BOTTOM) AND PM-03 (BOTTOM).
 - BRENTWOOD DR SIGNING IS COVERED ON PM-15 (TOP).
 - FOR A SUMMARY OF SIGN REMOVALS, SEE REMOVAL SCHEDULES.
 - DOUBLE YELLOW CENTERLINE PAVEMENT MARKING DETAILED WITH PC, PT AND RADIUS SHALL BE PLACED AT A SPLIT OF PAVEMENT EDGES.

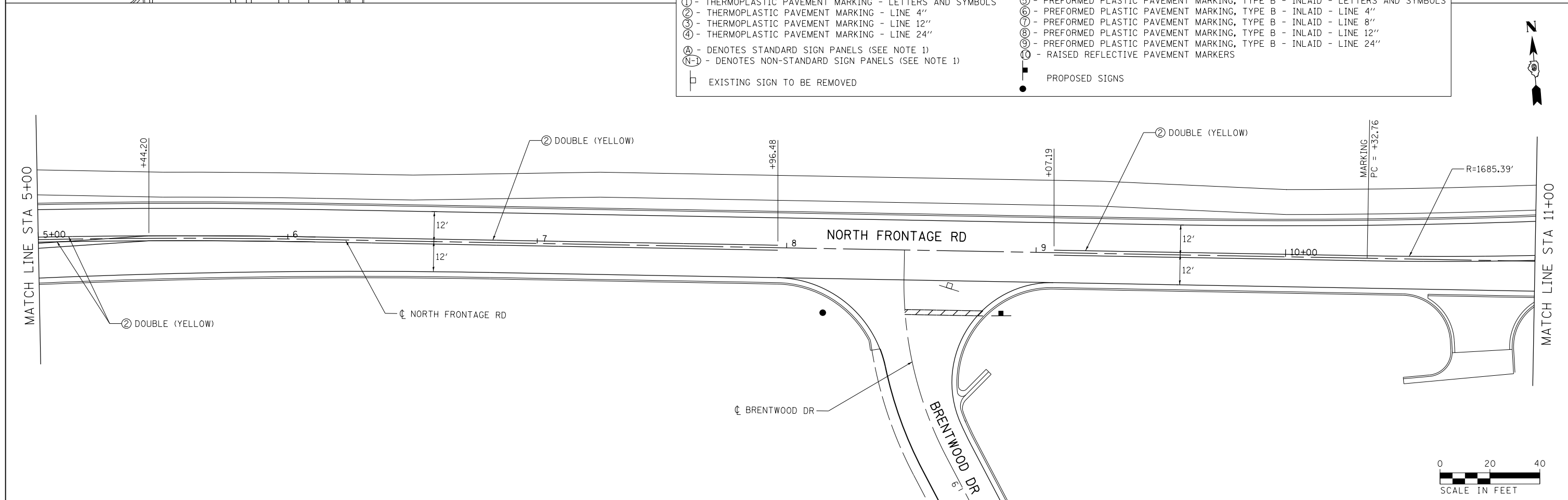

LEGEND	
① - THERMOPLASTIC PAVEMENT MARKING - LETTERS AND SYMBOLS	⑤ - PREFORMED PLASTIC PAVEMENT MARKING, TYPE B - INLAID - LETTERS AND SYMBOLS
② - THERMOPLASTIC PAVEMENT MARKING - LINE 4"	⑥ - PREFORMED PLASTIC PAVEMENT MARKING, TYPE B - INLAID - LINE 4"
③ - THERMOPLASTIC PAVEMENT MARKING - LINE 12"	⑦ - PREFORMED PLASTIC PAVEMENT MARKING, TYPE B - INLAID - LINE 8"
④ - THERMOPLASTIC PAVEMENT MARKING - LINE 24"	⑧ - PREFORMED PLASTIC PAVEMENT MARKING, TYPE B - INLAID - LINE 12"
A - DENOTES STANDARD SIGN PANELS (SEE NOTE 1)	⑨ - PREFORMED PLASTIC PAVEMENT MARKING, TYPE B - INLAID - LINE 24"
N-1 - DENOTES NON-STANDARD SIGN PANELS (SEE NOTE 1)	⑩ - RAISED REFLECTIVE PAVEMENT MARKERS
□ EXISTING SIGN TO BE REMOVED	● PROPOSED SIGNS



FILE NAME = D978258-sht-pmk-10.dgn	USER NAME = mfox	DESIGNED - KN	REVISED -	STATE OF ILLINOIS DEPARTMENT OF TRANSPORTATION	PAVEMENT MARKING AND SIGNING PLAN NORTH FRONTAGE ROAD		F.A.P. RTE. 331	SECTION (1-4)R-2, N-4, TS-4	COUNTY WILLIAMSON	TOTAL SHEETS 381	SHEET NO. 231	
CH2MHILL	PLOT SCALE = 40.0000' / in.	DRAWN - AS	REVISED -		SCALE:	SHEET NO. 10 OF 16 SHEETS	STA. 0+00.00 TO STA. 11+00.00	DRAWING NO. PM-10		CONTRACT NO. 78258		
	PLOT DATE = 3/11/2013	CHECKED -	REVISED -		ILLINOIS FED. AID PROJECT							
		DATE -	REVISED -									