

DATE	
BY	
FINISHED SURVEY	
PLOTTED	
NOTE BOOK	
AREAS CHECKED	

DATE	
BY	
ORIGINAL SURVEY	
PLOTTED	
NOTE BOOK	
AREAS CHECKED	

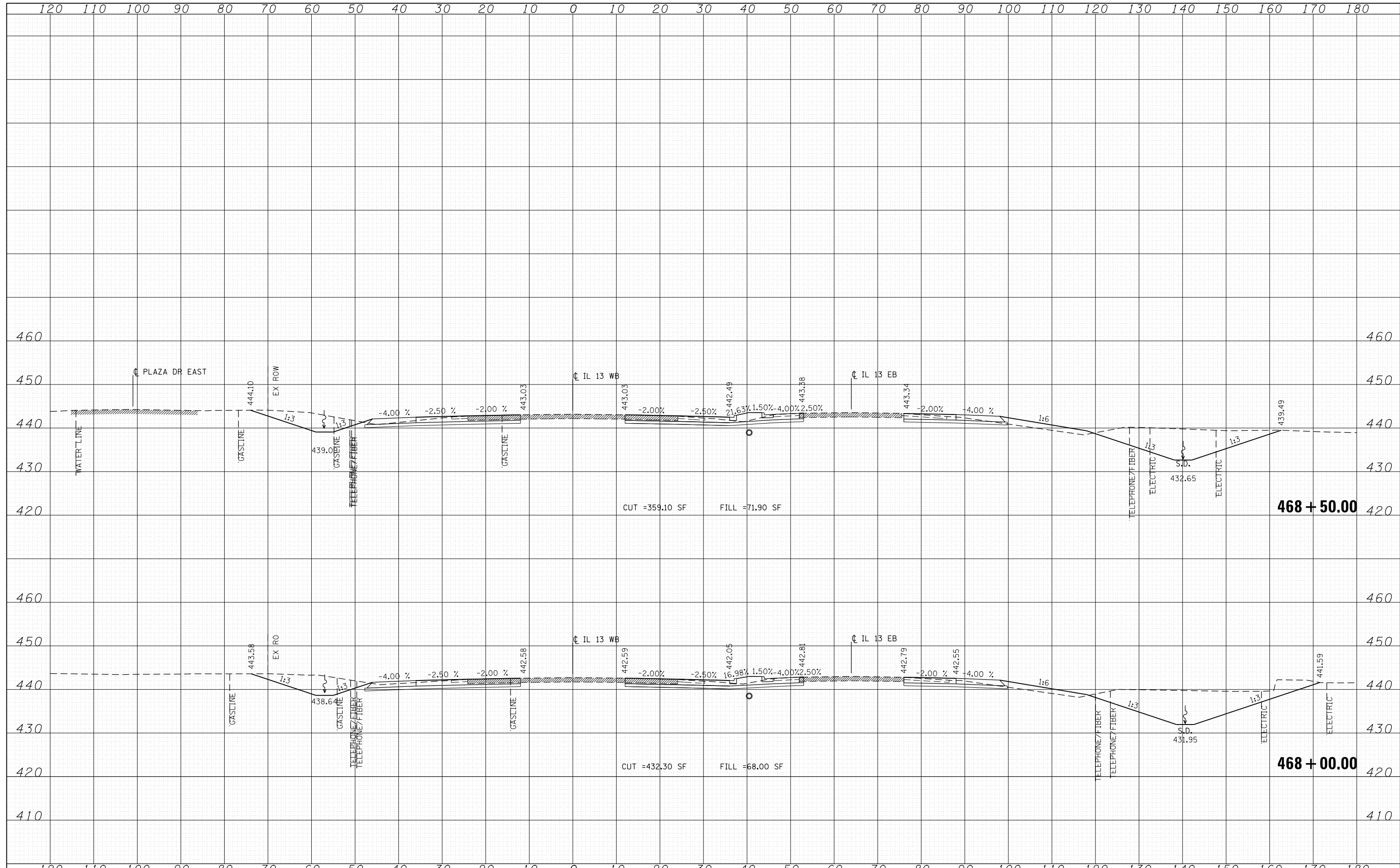

FILE NAME = D978258-sht-xssh-IL13.dgn  
**CH2MHILL**

USER NAME = mfox	DESIGNED - KN	REVISED -
	DRAWN - AS	REVISED -
PLOT SCALE = 20.0000' / in.	CHECKED -	REVISED -
PLOT DATE = 1/31/2013	DATE -	REVISED -

**STATE OF ILLINOIS  
DEPARTMENT OF TRANSPORTATION**

**PROPOSED CROSS SECTIONS  
ILLINOIS ROUTE 13**

SCALE: SHEET NO. 22 OF 33 SHEETS STA. 468+00.00 TO STA. 468+50.00

F.A.P. RTE.	SECTION	COUNTY	TOTAL SHEETS	SHEET NO.
331	(1-4)R-2, N-4, TS-4	WILLIAMSON	381	290
DRAWING NO. XS-022			CONTRACT NO. 78258	
ILLINOIS FED. AID PROJECT				