

| | |
|--------------|---------------|
| DATE | |
| BY | |
| FINAL SURVEY | SURVEYED |
| NOTE BOOK | PLOTTED |
| NO. | TEMPLATE |
| | AREAS CHECKED |
| | AREAS CHECKED |

| | |
|-----------------|---------------|
| DATE | |
| BY | |
| ORIGINAL SURVEY | SURVEYED |
| NOTE BOOK | PLOTTED |
| NO. | TEMPLATE |
| | AREAS CHECKED |
| | AREAS CHECKED |

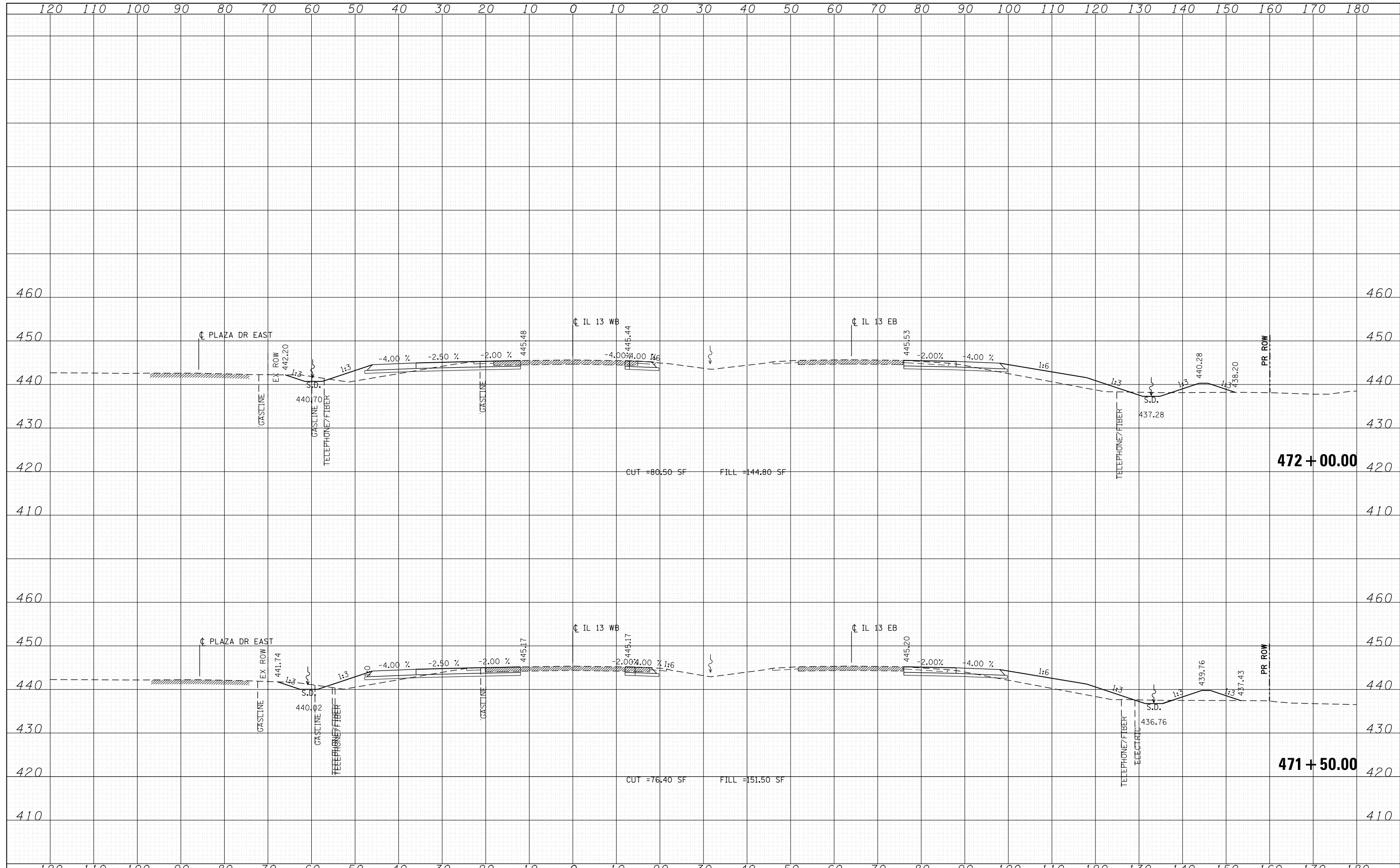

FILE NAME = D978258-sht-xxsht-IL13.dgn
CH2MHILL

| | | |
|-----------------------------|---------------|-----------|
| USER NAME = mfox | DESIGNED - KN | REVISED - |
| | DRAWN - AS | REVISED - |
| PLOT SCALE = 20.0000' / in. | CHECKED - | REVISED - |
| PLOT DATE = 1/31/2013 | DATE - | REVISED - |

**STATE OF ILLINOIS
DEPARTMENT OF TRANSPORTATION**

**PROPOSED CROSS SECTIONS
ILLINOIS ROUTE 13**

SCALE: SHEET NO. 26 OF 33 SHEETS STA. 471+50.00 TO STA. 472+00.00

| F.A.P. RTE. | SECTION | COUNTY | TOTAL SHEETS | SHEET NO. |
|---------------------------|---------------------|------------|--------------------|-----------|
| 331 | (1-4)R-2, N-4, TS-4 | WILLIAMSON | 381 | 294 |
| DRAWING NO. XS-026 | | | CONTRACT NO. 78258 | |
| ILLINOIS FED. AID PROJECT | | | | |