

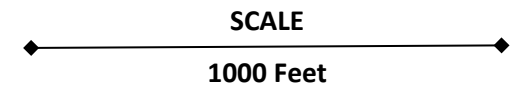

Site Plan – Total Site 3.0 Acres



1941 Aerial Photo



2015 Aerial Photo



USGS Soil Map (Soil Description Table Below)

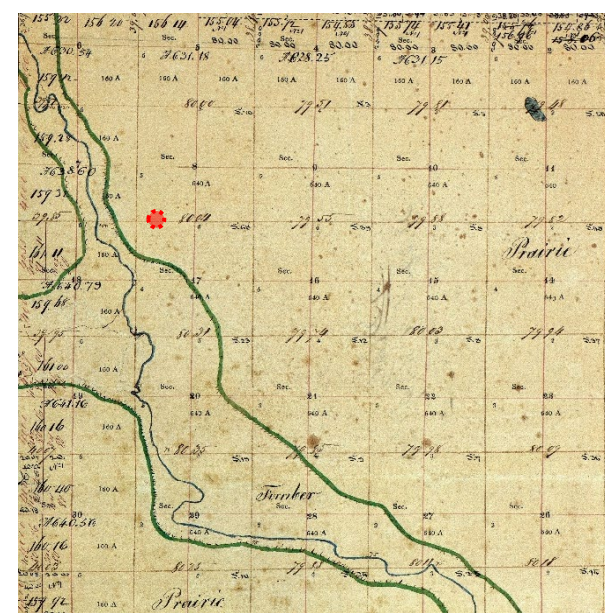

1821 Historic Vegetation Map

CODE	149A	148B	228A
NAME	Brenton Silt Loam	Proctor Silt Loam	Nappanee Silt Loam
Drainage Class	Somewhat Poorly Drained	Well Drained	Somewhat Poorly Drained
Permeability	Moderate	Moderate	Moderate or Moderately Slow
Distance to Groundwater	12" – 18"	More than 80"	6" – 24"
Frequency of Flooding	None	None	None
Frequency of Ponding	None	None	None
Hydric Soil Classification	No	No	No
Ecological Classification 1	Outwash Prairie – 97%	Outwash Prairie – 95%	Moist Glacial Drift Upland – 92%
Ecological Classification 2	Wet Outwash Mollisol – 97%	Moist Loamy or Clayey Lowland – 5%	Wet Glacial Drift Upland – 6%
Ecological Classification 3	Wet Outwash Prairie – 3%		Loamy and Clayey Upland – 1%
Ecological Classification 4	Ponded Depressional Sedge Meadow – 3%		
Historic Vegetation	Tall Prairie Grass	Prairie Grass	Forest beech, maple, oak, elm, and basswood

Three Rivers Rest Area EB
0025-21-GRUN
 I-80 EB, MM 117.1
 East of Morris, IL 60450

County: Grundy (41.431394, -88.345367)
 Team Section: 351 - Morris

Drawn By: Andy Stahr

Site Plan

- Approximate Property Line
- 780 Topographic Contour Lines (10' Intervals)
- Soil Type Divider Lines
- Prairie Areas – 2.5 Acres
- Savanna Areas – 0.5 Acres



02/28/2024



District 3 – 700 E Norris Drive, Ottawa, IL 61350
 Bureau of Operations – (815) 434-8445