

STATE OF ILLINOIS  
DEPARTMENT OF TRANSPORTATION

Benchmarks: 1.) "□" cut in Northeast corner of concrete drinking fountain base near restrooms, North of swimming pool ±75' South of Bridge, Elevation = 438.98.  
2.) "□" cut in Northeast corner of top bridge wall at Southwest corner of pool, ±200' Southwest of Bridge, Elevation = 439.13.

Existing Structure: SN 076-9907. The structure consists of a two span steel stringers with wood deck superstructure with closed concrete abutments. The back-to-back abutment dimension measures ±31'-0" while the out-to-out width measures ±16'-0". Removal of adjacent pedestrian bridge, which measures ±34'-0" long and ±4'-0" wide, to be included with existing structure removal.

No Salvage.

F.A. RTE.	SECTION	COUNTY	TOTAL SHEETS	SHEET NO.
	POPE	60	27	
STA.		TO STA.		
FED. ROAD DIST. NO.	ILLINOIS	FED. AID PROJECT		

DESIGN SPECIFICATIONS  
AASHTO 2002

DESIGN STRESSES

FIELD UNITS  
f'c = 3,500 psi (Cast-In-Place)  
fy = 60,000 psi (Reinforcement)

LOADING HS20-44

Allow 50#/sq. ft. for future wearing surface.

SEISMIC DATA

Seismic Performance Category (SPC) = B  
Bedrock Acceleration Coefficient (A) = 0.12  
Site Coefficient (S) = 1.0

SHEET NO. B1  
OF 11 SHEETS

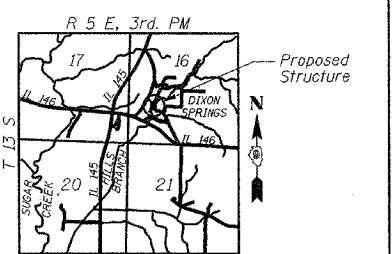
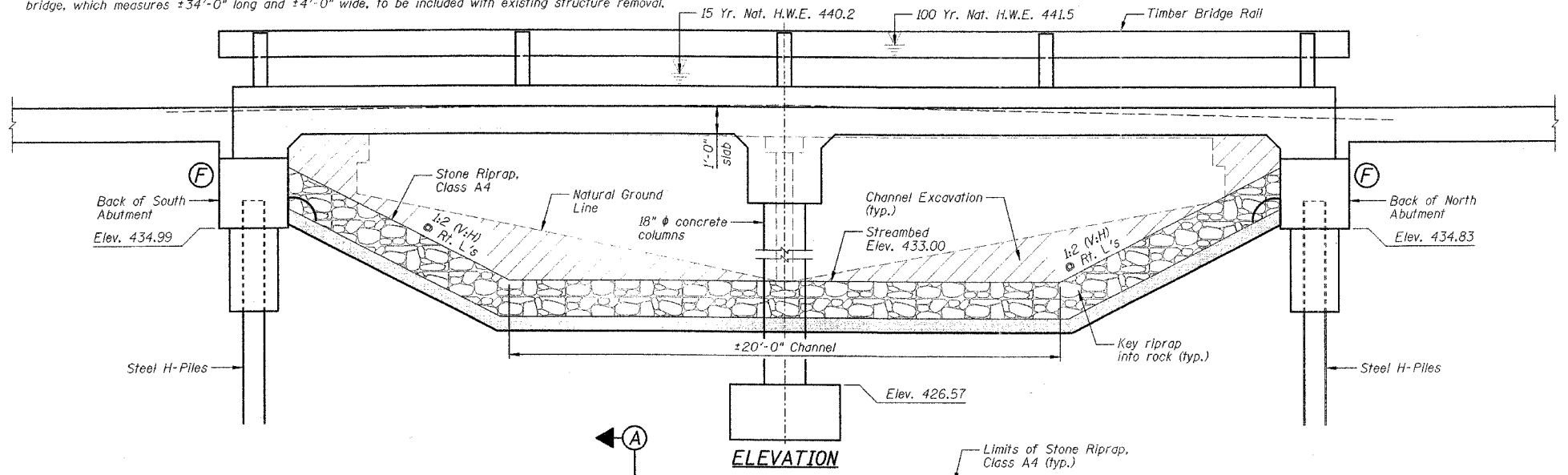

STATION 34+19.83  
BUILT 200\_ BY  
STATE OF ILLINOIS  
DIXON SPRINGS PARK ROAD  
LOADING HS20  
STR. NO. 076-9924

NAME PLATE  
See Standard 515001

WATERWAY INFORMATION

Drainage Area = 1.34 Sq. Mi.		Low Grade Elev. 438.20 @ Sta. 35+00.00		
Flood Yr.	Freq. C.F.S.	Opening Sq. Ft.	Nat. Head - Ft.	Headwater El.
Design	15 1026	71 86	440.2 0.3	0.3 440.5
Base	100 1672	71 86	441.5 0.1	0.1 441.6
Overtopping				
Max. Calc.				

INDEX TO SHEETS

SHEET NO.	TITLE
B1	GENERAL PLAN AND ELEVATION
B2	GENERAL NOTES, BILL OF MATERIAL, DETAIL, SECTION AND SUBSTRUCTURE LAYOUT PLAN
B3	SUPERSTRUCTURE DECK (TOP OF SLAB)
B4	SUPERSTRUCTURE DECK (BOTTOM OF SLAB)
B5	SUPERSTRUCTURE CROSS SECTION
B6	TIMBER BRIDGE RAIL DETAILS
B7	SOUTH ABUTMENT
B8	NORTH ABUTMENT
B9	PIER
B10	RUSTICATION FINISH LOCATIONS
B11	SOIL BORING LOGS

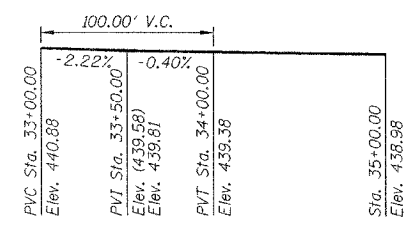

PROFILE GRADE  
(Along Roadway)

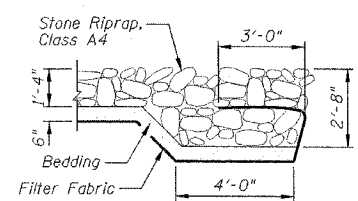

SECTION A-A

APPROVED  
FOR STRUCTURAL ADEQUACY ONLY

Signature: *Ralph E. Anderson (TSP)*  
ENGINEER OF BRIDGES AND STRUCTURES



Signature: *Mark S. Wylie* Date: 5/23/07  
MARK S. WYLIE  
ILLINOIS STRUCTURAL ENGINEER  
NO. 081-005002  
Exp. Date 11/30/08

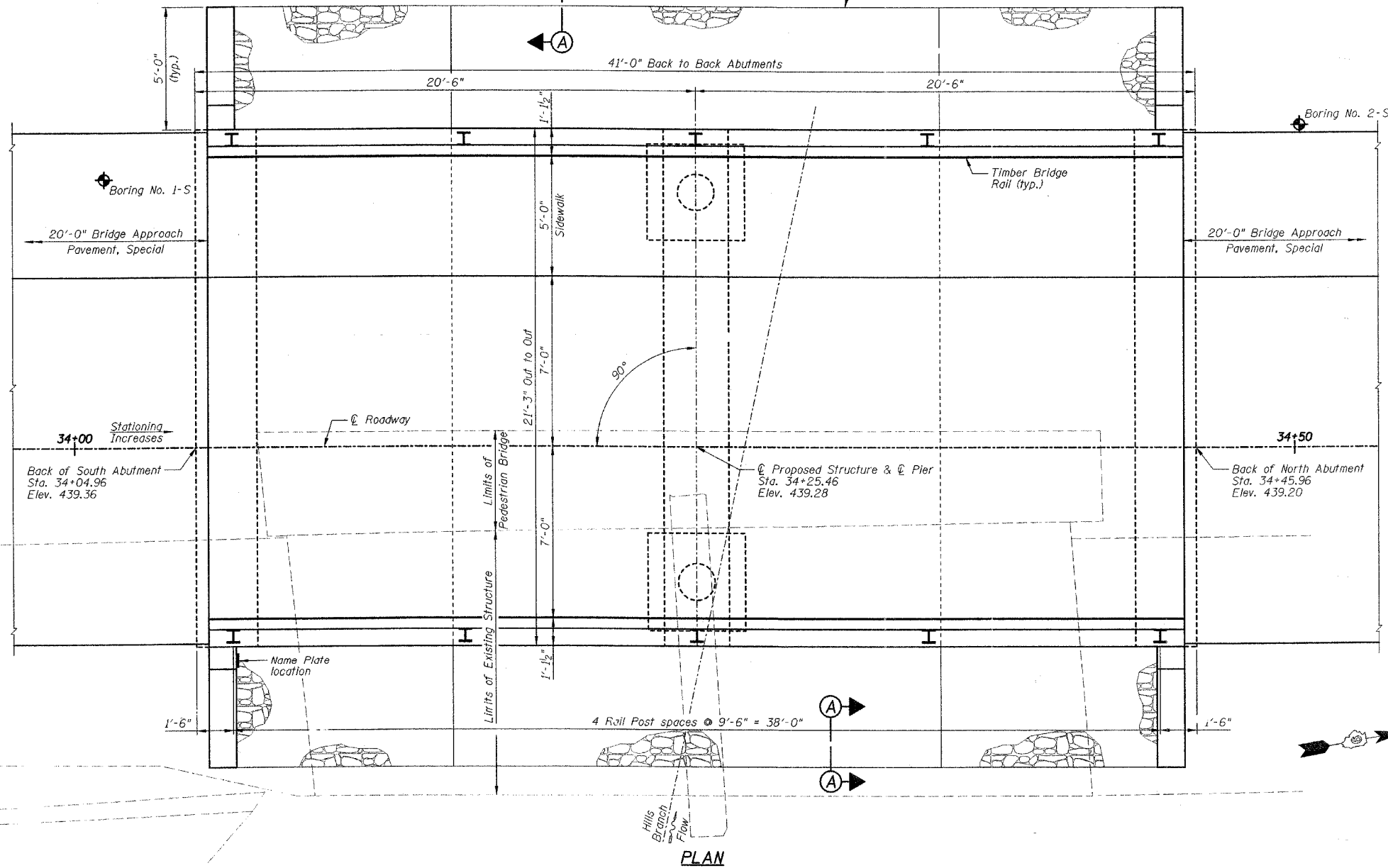

PLAN

REVISIONS	NAME	DATE
	DJM	4/02/07

ILLINOIS DEPARTMENT OF TRANSPORTATION  
GENERAL PLAN AND ELEVATION  
DIXON SPRINGS STATE PARK  
ROAD OVER HILLS BRANCH  
POPE COUNTY  
STRUCTURE NO. 076-9924  
DESIGNED BY: MJG  
DRAWN BY: DJM  
DATE: 11/30/06  
CHECKED BY: MSW