

REF-70P003
REF-P003

CONTRACT NO. 60A91				
F.A.P. RTE.	SECTION	COUNTY	TOTAL SHEETS	SHEET NO.
334	111 RS-5 & 116 B-1	MCHENRY	98	16
STA.	TO STA.			
FED. ROAD DIST. NO.	ILLINOIS	FED. AID PROJECT		

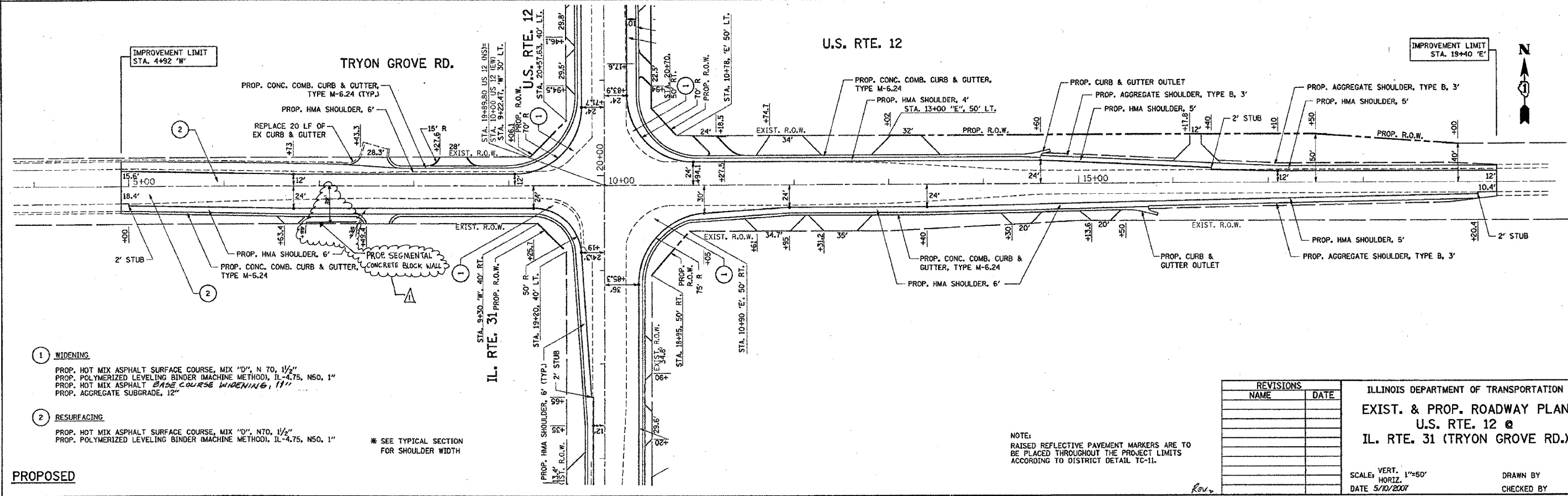
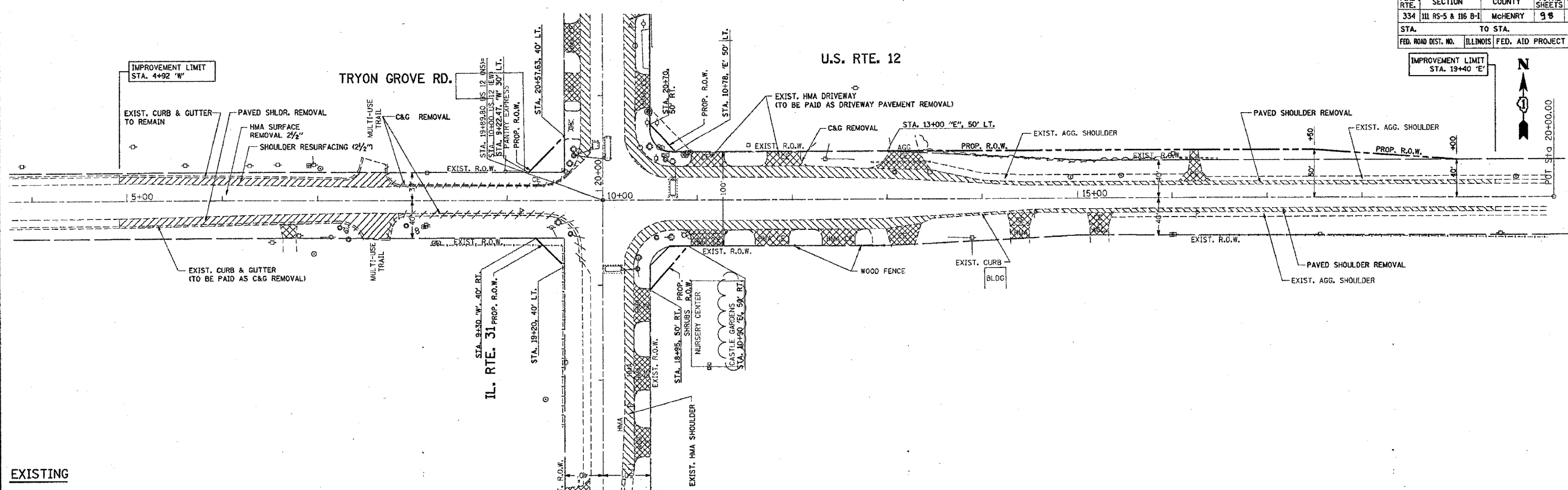

- 1 WIDENING
PROP. HOT MIX ASPHALT SURFACE COURSE, MIX "D", N 70, 1 1/2"
PROP. POLYMERIZED LEVELING BINDER (MACHINE METHOD), IL-4.75, NS0, 1"
PROP. HOT MIX ASPHALT BASE COURSE WIDENING, 1 1/2"
PROP. AGGREGATE SUBGRADE, 12"
- 2 RESURFACING
PROP. HOT MIX ASPHALT SURFACE COURSE, MIX "D", N 70, 1 1/2"
PROP. POLYMERIZED LEVELING BINDER (MACHINE METHOD), IL-4.75, NS0, 1"

* SEE TYPICAL SECTION FOR SHOULDER WIDTH

NOTE:
RAISED REFLECTIVE PAVEMENT MARKERS ARE TO BE PLACED THROUGHOUT THE PROJECT LIMITS ACCORDING TO DISTRICT DETAIL 1C-11.

REVISIONS	
NAME	DATE

ILLINOIS DEPARTMENT OF TRANSPORTATION
EXIST. & PROP. ROADWAY PLAN
U.S. RTE. 12 @
IL. RTE. 31 (TRYON GROVE RD.)

SCALE: VERT. 1"=50'
HORIZ. 1"=50'
DATE 5/10/2007

DRAWN BY
CHECKED BY

PLOT DATE = 5/10/2007
FILE NAME = C:\p003\60A91\14899\plan\dwg2.dwg
PLOT SCALE = 1/8"=1'-0"
USER NAME = baward

REVISED 7/23/07 AM