

SHEET NO.	DESCRIPTION
1	COVER SHEET
2	INDEX OF SHEETS, STANDARDS, AND GENERAL NOTES
3-6	SUMMARY OF QUANTITIES
7-12	TYPICAL SECTIONS
13-14	SCHEDULES OF QUANTITIES
15	ALIGNMENT, CONTROL POINTS AND BENCHMARKS
16-23	ROADWAY PLAN AND PROFILE
24-34	SUGGESTED STAGING AND TRAFFIC CONTROL PLANS
35-36	EROSION AND SEDIMENT CONTROL DETAILS
37-39	DRAINAGE AND UTILITY PLANS
40-41	DRAINAGE PROFILE
42	DRAINAGE SCHEDULE
43-47	PLATS OF HIGHWAYS
48-49A	PAVEMENT MARKING & LANDSCAPING PLANS & SIGNING PLANS 
50-61	TRAFFIC SIGNAL PLANS
62-71	BRIDGE PLANS
72	TRAFFIC CONTROL-BRIDGE
73-74	DRIVEWAY DETAILS
75	OULET FOR CONCRETE CURB AND GUTTER
76	DETAILS FOR FRAMES AND LIDS ADJUSTMENT WITH MILLING
77	PAVEMENT PATCHING FOR HMA SURFACED PAVEMENT
78	CURB OR CURB AND GUTTER REMOVAL AND REPLACEMENT
79	BUTT JOINT AND HMA TAPER DETAILS
80	BENCHING DETAIL FOR EMBANKMENT WIDENING
81	TRAFFIC CONTROL AND PROTECTION FOR SIDE ROADS, INTERSECTIONS AND DRIVEWAYS
82	TYPICAL APPLICATIONS RAISED REFLECTIVE PAVEMENT MARKERS (SNOW-PLOW RESISTANT)
83	DISTRICT ONE TYPICAL PAVEMENT MARKINGS
84	ARTERIAL ROAD INFORMATION SIGN
85	DRIVEWAY ENTRANCE SIGNING
86	DISTRICT ONE DETECTOR LOOP INSTALLATION DETAILS FOR ROADWAY RESURFACING
87-98	CROSS SECTIONS

STANDARD NO.	DESCRIPTION
000001-04	STANDARD SYMBOLS, ABBREVIATIONS AND PATTERNS
280001-03	TEMPORARY EROSION CONTROL SYSTEMS
442201-02	CLASS C AND D PATCHES
482001-01	HMA SHOULDER ADJACENT TO FLEXIBLE PAVEMENT
482011-02	HMA SHOULDER STRIPS/SHOULDER WITH RESURFACING OR WIDENING AND RESURFACING PROJECTS
542311	GRATING FOR CONCRETE FLARED END SECTION (FOR 600 mm (24") THRU 1350 mm (54") PIPE)
542301-01	PRECAST REINFORCED CONCRETE FLARED END SECTION
542306-01	PRECAST REINFORCED CONCRETE ELLIPTICAL FLARED END SECTION
542311	GRATING FOR CONCRETE FLARED END SECTION (FOR 600 mm (24") THRU 1350 mm (54") PIPE)
602011	CATCH BASIN TYPE C
602401-01	MANHOLE TYPE A
604001-02	FRAME AND LIDS TYPE I
604091-01	FRAME AND GRATE TYPE 24
606001-03	CONCRETE CURB TYPE B AND COMBINATION CONCRETE CURB AND GUTTER
701201-02	LANE CLOSURE, 2L, 2W, DAY ONLY, FOR SPEEDS \geq 45 MPH
701301-02	LANE CLOSURE, 2L 2W, SHORT TIME OPERATIONS
701306-01	LANE CLOSURE, 2L 2W, SLOW MOVING DAY ONLY OPERATIONS, FOR SPEEDS \geq 45 MPH
701311-02	LANE CLOSURE, 2L 2W, MOVING OPERATIONS-DAY ONLY, FOR SPEEDS \geq 45 MPH
701326-02	LANE CLOSURE, 2L 2W, PAVEMENT WIDENING, FOR SPEEDS $>$ 45 MPH
701336-04	LANE CLOSURE, 2L 2W, WORK AREA IN SERIES, FOR SPEED $>$ 45 MPH
701501-03	URBAN LANE CLOSURE, 2L 2W, UNDIVIDED
701701-04	URBAN LANE CLOSURE, MULTILANE INTERSECTION
701801-03	LANE CLOSURE MULTILANE 1W OR 2W CROSSWALK OR SIDEWALK CLOSURE
702001-04	TRAFFIC CONTROL DEVICES
720001	SIGN PANEL MOUNTING DETAILS
720006-01	SIGN PANEL ERECTION DETAILS
780001-01	TYPICAL PAVEMENT MARKINGS
814001-01	HANDHOLES
814006-01	DOUBLE HANDHOLES
862001	UNINTERRUPTABLE POWER SUPPLY (UPS)
878001-05	CONCRETE FOUNDATION DETAILS

BEFORE STARTING ANY EXCAVATION, THE CONTRACTOR SHALL CALL "JULIE" AT 800-892-0123 FOR FIELD LOCATIONS OF BURIED ELECTRIC, TELEPHONE AND GAS FACILITIES. (48 HOUR NOTIFICATION IS REQUIRED)

THE CONTRACTOR SHALL COORDINATE CONSTRUCTION ACTIVITIES WITH UTILITY COMPANIES.

THE CONTRACTOR WILL NOT BE ALLOWED TO SET UP A YARD OR FIELD OFFICE ON STATE PROPERTY WITHOUT WRITTEN PERMISSION FROM THE DEPARTMENT.

WHEN MILLED PAVEMENT IS OPEN TO TRAFFIC THE MAXIMUM GRADE DIFFERENTIAL BETWEEN PASSES OF THE MILLING MACHINE SHALL NOT EXCEED 40 MM (1 1/2 INCHES) WHERE THE SPEED LIMIT IS 80 KM/H (45 MPH) OR LESS AND 25 MM (1 INCH) WHERE THE SPEED LIMIT IS GREATER THAN 80 KM/H (45 MPH). WITH WRITTEN APPROVAL FROM THE ENGINEER, A MAXIMUM GRADE DIFFERENTIAL OF 75 MM (3 INCHES) MAY BE ALLOWED IF THE EDGE OF THE MILLING IS SLOPED A MINIMUM 1:3 (V:H).

BUTT JOINTS WILL BE INSTALLED AT THE ENDS OF ALL RESURFACING (WHERE RESURFACING MEETS EXISTING PAVEMENT), IN ACCORDANCE WITH THE "BUTT JOINT AND HOT-MIX ASPHALT TAPER DETAILS" SHEET INCLUDED IN THE PLANS, UNLESS OTHERWISE SPECIFIED.

UNLESS OTHER CONDITIONS WARRANT EXTENDED LANE CLOSURE AS DETERMINED AND APPROVED IN WRITING BY THE ENGINEER OR AS PROVIDED FOR IN THE CONTRACT SPECIFICATIONS, OVERNIGHT CLOSURES SHALL NOT BE ALLOWED FOR REHABILITATION PROJECTS INVOLVING DAYTIME MILLING AND RESURFACING OPERATIONS AND CLASS D PATCHING.

PRIOR TO EMBANKMENT PLACEMENT, ALL VEGETATION, LOOSE MATERIAL, AND UNSTABLE MATERIAL SHOULD BE REMOVED TO DEPTH ENCOUNTERED AND REPLACED WITH SUITABLE EMBANKMENT MATERIAL. ANY EMBANKMENT WIDENING ON EXISTING SLOPES SHOULD BE BENCHED IN ACCORDANCE WITH ARTICLE 205.04 OF THE STANDARD SPECIFICATIONS FOR ROAD AND BRIDGE CONSTRUCTION.

IT IS THE CONTRACTOR'S RESPONSIBILITY TO PROVIDE A FIELD LABORATORY FOR USE FOR ANY ON SITE TESTING BY THE ENVIRONMENTAL FIRM. NO TESTING OF ANY KIND, CONTAMINATED OR NON-CONTAMINATED FLUID OR SOLID SHALL BE PERMITTED IN THE ENGINEER'S FIELD OFFICE.

THE RESIDENT ENGINEER SHALL CONTACT MS. DEBBIE HANLON AREA TRAFFIC FIELD ENGINEER AT (847) 438-2300 A MINIMUM OF 2 WEEKS PRIOR TO PLACEMENT OF PERMANENT PAVEMENT MARKING.

THE CONTRACTOR SHALL BE REQUIRED TO COMPLETE ALL PAVEMENT PATCHING AFTER THE HOT-MIX ASPHALT SURFACE REMOVAL OPERATION.

ALL PAVEMENT MARKINGS SHALL BE PLACED THROUGHOUT THE IMPROVEMENT ACCORDING TO DISTRICT 1 TYPICAL PAVEMENT MARKING.

RAISED REFLECTIVE PAVEMENT MARKERS SHALL BE PLACED THROUGHOUT THE IMPROVEMENT ACCORDING TO THE DISTRICT STANDARDS AS NOTED IN THE DETAIL.

THE RESIDENT ENGINEER SHALL VERIFY THE LOCATIONS OF ALL EXISTING PAVEMENT MARKINGS PRIOR TO MILLING OR RESURFACING.

PAVEMENT MARKING TAPE, TYPE III SHALL BE USED FOR SHORT TERM PAVEMENT MARKINGS ON ALL FINAL SURFACES. THE COST OF THE PAVEMENT MARKING TAPE, TYPE III AND ITS REMOVAL SHALL BE INCLUDED IN THE COST OF SHORT TERM PAVEMENT MARKING.

ON STATE STANDARD 482001 AGGREGATE SUBGRADE 12" SPECIAL SHALL BE USED IMPROVED SUBGRADE. THE ADDITIONAL THICKNESS OF AGGREGATE SUBGRADE UNDER THE SHOULDER SHALL BE INCLUDED IN THE COST PER SQUARE YARD OF AGGREGATE SUBGRADE 12" SPECIAL

CONTRACT NO. 60A91				
F.A.P. R.T.E.	SECTION	COUNTY	TOTAL SHEETS	SHEET NO.
334	..	MCHEMRY	98	2
STA.		TO STA.		
FED. ROAD DIST. NO. 1	ILLINOIS		FED. AID PROJECT	
.. 111 RS-5 & 116 B-I				

REVISIONS		ILLINOIS DEPARTMENT OF TRANSPORTATION US 12 @ ILL 31 /TRYON GROVE RD. INDEX OF SHEETS LIST OF STATE STANDARDS PLAN NOTES
NAME	DATE	
SCALE: VERT. : NONE		DRAWN BY:
DATE		CHECKED BY:

F.A.P. RTE.	SECTION	COUNTY	TOTAL SHEETS	SHEET NO.
334	111 RS-5 & 116 B-I	McHENRY	98	3
FED. ROAD DIST. NO. 1		ILLINOIS	HIGHWAY PROJECT	

SUMMARY OF QUANTITIES			URBAN 80% FED./20% STATE	CONSTRUCTION TYPE CODE				
CODE NO	ITEM	UNIT	TOTAL QUANTITIES	LOCATION 1 INTERSECTION HPP 1000-2A	LOCATION 2 TRAFFIC SIGNAL HPP Y031-1F	LOCATION 3 RESURFACING (3 P) F 1000	LOCATION 4 SN 056-0017 BRIDGE BHF SFTY-2A	
20100110	TREE REMOVAL (6 TO 15 UNITS DIAMETER)	UNIT	13	13				
20100210	TREE REMOVAL (OVER 15 UNITS DIAMETER)	UNIT	47	47				
20200100	EARTH EXCAVATION	CU YD	3817	3817				
20201006	GRADING AND SHAPING SHOULDERS	UNIT	148.5	23.5		125		
20201200	REMOVAL AND DISPOSAL OF UNSUITABLE MATERIAL	CU YD	1444	1444				
20800150	TRENCH BACKFILL	CU YD	238.6	238.6				
21001000	GEOTECHNICAL FABRIC FOR GROUND STABILIZATION	SQ YD	905	905				
21101615	TOPSOIL FURNISH AND PLACE, 4"	SQ YD	8803	8803				
25000210	SEEDING, CLASS 2A	ACRE	0.2	0.2				
25000400	NITROGEN FERTILIZER NUTRIENT	POUND	164	164				
25000500	PHOSPHORUS FERTILIZER NUTRIENT	POUND	164	164				
25000600	POTASSIUM FERTILIZER NUTRIENT	POUND	164	164				
25100630	EROSION CONTROL BLANKET	SQ YD	966	966				
25200110	SODDING, SALT TOLERANT	SQ YD	7837	7837				
25200200	SUPPLEMENTAL WATERING	UNIT	79	79				
28000300	TEMPORARY DITCH CHECKS	EACH	7	7				
28000500	INLET AND PIPE PROTECTION	EACH	5	5				
28100107	STONE RIPRAP, CLASS A4	SQ YD	38	38				
28200200	FILTER FABRIC	SQ YD	38	38				
31101400	SUB-BASE GRANULAR MATERIAL, TYPE B 6"	SQ YD	988	988				
35501308	HOT-MIX ASPHALT BASE COURSE, 6"	SQ YD	270	270				
35501316	HOT-MIX ASPHALT BASE COURSE, 8"	SQ YD	1649	1649				
35600720	HOT-MIX ASPHALT BASE COURSE WIDENING, 11"	SQ YD	3322	3322				
40600200	BITUMINOUS MATERIALS (PRIME COAT)	TON	36.8	11.8		25		
40600300	AGGREGATE (PRIME COAT)	TON	186.4	59.4		127		
40600400	MIXTURE FOR CRACKS, JOINTS, AND FLANGWAYS	TON	13.5	4		9.5		
40600895	CONSTRUCTING TEST STRIP	EACH	1	1				
40600982	HOT-MIX ASPHALT SURFACE REMOVAL - BUTT JOINT	SQ YD	365.5	55.5		262	48	
40600985	PORTLAND CEMENT CONCRETE SURFACE REMOVAL - BUTT JOINT	SQ YD	216			216		

SUMMARY OF QUANTITIES			URBAN 80% FED./20% STATE	CONSTRUCTION TYPE CODE				
CODE NO	ITEM	UNIT	TOTAL QUANTITIES	LOCATION 1 INTERSECTION HPP 1000-2A	LOCATION 2 TRAFFIC SIGNAL HPP Y031-1F	LOCATION 3 RESURFACING (3 P) F 1000	LOCATION 4 SN 056-0017 BRIDGE BHF SFTY-2A	
40601005	HOT-MIX ASPHALT REPLACEMENT OVER PATCHES	TON	184.3	88.5		95.8		
40603310	HOT-MIX ASPHALT SURFACE COURSE, MIX "C", N50	TON	210.5	210.5				
40603340	HOT-MIX ASPHALT SURFACE COURSE, MIX "D", N70	TON	4105	1247		2818	40	
42001300	PROTECTIVE COAT	SQ YD	1500	1500				
44000155	HOT-MIX ASPHALT SURFACE REMOVAL, 1 1/2"	SQ YD	1423			1423		
44000158	HOT-MIX ASPHALT SURFACE REMOVAL, 2 1/4"	SQ YD	32123			31678	445	
44000159	HOT-MIX ASPHALT SURFACE REMOVAL, 2 1/2"	SQ YD	11523	11523				
44000200	DRIVEWAY PAVEMENT REMOVAL	SQ YD	2051	2051				
44000300	CURB REMOVAL	FOOT	1852	1852				
44000500	COMBINATION CURB AND GUTTER REMOVAL	FOOT	743	743				
44000915	HOT-MIX ASPHALT SURFACE REMOVAL (DECK)	SQ YD	359				359	
44001700	COMBINATION CONCRETE CURB AND GUTTER REMOVAL AND REPLACEMENT	FOOT	610			610		
44002218	HOT-MIX ASPHALT REMOVAL OVER PATCHES, 4 1/2"	SQ YD	729	355		374		
44004250	PAVED SHOULDER REMOVAL	SQ YD	3570	3570				
44201345	CLASS C PATCHES, TYPE III, 9 INCH	SQ YD	19			19		
44201753	CLASS D PATCHES, TYPE II, 9 INCH	SQ YD	431	169		262		
44201757	CLASS D PATCHES, TYPE III, 9 INCH	SQ YD	230	118		112		
44201759	CLASS D PATCHES, TYPE IV, 9 INCH	SQ YD	64	64				
48101500	AGGREGATE SHOULDERS, TYPE B 6"	SQ YD	783	783				
48102100	AGGREGATE WEDGE SHOULDER, TYPE B	TON	929			929		
48203029	HOT-MIX ASPHALT SHOULDERS, 8"	SQ YD	4046	4046				
50102400	CONCRETE REMOVAL	CU YD	5.9				5.9	
50105220	PIPE CULVERT REMOVAL	FOOT	369	369				
50300255	CONCRETE SUPERSTRUCTURE	CU YD	28.8				28.8	
50800205	REINFORCEMENT BARS, EPOXY COATED	POUND	4900				4900	
54207159	PIPE CULVERTS, TYPE 1, REINFORCED CONCRETE - ELLIPTICAL, EQUIVALENT ROUND-SIZE 24"	FOOT	62	62				
54213657	PRECAST REINFORCED CONCRETE FLARED END SECTIONS 12"	EACH	4	4				

* SPECIALITY ITEMS

REVISIONS	
NAME	DATE

ILLINOIS DEPARTMENT OF TRANSPORTATION
SUMMARY OF QUANTITIES

Rev. 7-26-07

CONTRACT NO. 60A91

F.A.P. RTE.	SECTION	COUNTY	TOTAL SHEETS	SHEET NO.
334	III RS-5 & 116 B-1	McHENRY	98	4
FED. ROAD DIST. NO. 1		ILLINOIS	HIGHWAY PROJECT	

SUMMARY OF QUANTITIES			URBAN 80% FED./20% STATE	CONSTRUCTION TYPE CODE				
CODE NO	ITEM	UNIT	TOTAL QUANTITIES	LOCATION 1	LOCATION 2	LOCATION 3		
				INTERSECTION HPP 1000-2A	TRAFFIC SIGNAL HPP Y031-1F	RESURFACING (3 P) F 1000		
						SN 056-0017 BRIDGE BHF SFTY-2A		
54213660	PRECAST REINFORCED CONCRETE FLARED END SECTIONS 15"	EACH	5	5				
54214719	PRECAST REINFORCED CONCRETE FLARED END SECTIONS - ELLIPTICAL, EQUIVALENT ROUND-SIZE 24"	EACH	2	2				
54248130	GRATING FOR CONCRETE FLARED END SECTION EQUIVALENT ROUND-SIZE 24"	EACH	2	2				
542A0217	PIPE CULVERTS, CLASS A, TYPE 1 12"	FOOT	90	90				
542A0220	PIPE CULVERTS, CLASS A, TYPE 1 15"	FOOT	240	240				
550A0050	STORM SEWERS, CLASS A, TYPE 1 12"	FOOT	1102	1102				
550A0310	STORM SEWERS, CLASS A, TYPE 2 6"	FOOT	125	125				
550A0340	STORM SEWERS, CLASS A, TYPE 2 12"	FOOT	410	410				
550A0360	STORM SEWERS, CLASS A, TYPE 2 15"	FOOT	430	430				
60100060	CONCRETE HEADWALL FOR PIPE DRAINS	EACH	5	5				
60107600	PIPE UNDERDRAINS 4"	FOOT	780	780				
60208240	CATCH BASINS, TYPE C, TYPE 24 FRAME AND GRATE	EACH	11	11				
60218400	MANHOLES, TYPE A, 4'-DIAMETER, TYPE 1 FRAME, CLOSED LID	EACH	5	5				
60255500	MANHOLES TO BE ADJUSTED	EACH	1			1		
60260100	INLETS TO BE ADJUSTED	EACH	2			2		
60300305	FRAMES AND LIDS TO BE ADJUSTED	EACH	21			21		
60300310	FRAMES AND LIDS TO BE ADJUSTED (SPECIAL)	EACH	2			2		
60404950	FRAMES AND GRATES, TYPE 24	EACH	6			6		
60406000	FRAMES AND LIDS, TYPE 1, OPEN LID	EACH	2			2		
60610400	COMBINATION CONCRETE CURB AND GUTTER, TYPE M-6.24	FOOT	3889	3889				
67000400	ENGINEER'S FIELD OFFICE, TYPE A	CAL MO	10	4		3	3	
67100100	MOBILIZATION	L SUM	1	0.4		0.3	0.3	
70101800	TRAFFIC CONTROL AND PROTECTION (SPECIAL)	L SUM	1	0.5		0.3	0.2	
70103815	TRAFFIC CONTROL SURVEILLANCE	CAL DA	25	25				
70300100	SHORT-TERM PAVEMENT MARKING	FOOT	14980	4050		10930		
70300210	TEMPORARY PAVEMENT MARKING - LETTERS AND SYMBOLS	SQ FT	963.6	891		72.6		

* SPECIALITY ITEMS

SUMMARY OF QUANTITIES			URBAN 80% FED./20% STATE	CONSTRUCTION TYPE CODE				
CODE NO	ITEM	UNIT	TOTAL QUANTITIES	LOCATION 1	LOCATION 2	LOCATION 3		
				INTERSECTION HPP 1000-2A	TRAFFIC SIGNAL HPP Y031-1F	RESURFACING (3 P) F 1000		
						SN 056-0017 BRIDGE BHF SFTY-2A		
70300220	TEMPORARY PAVEMENT MARKING - LINE 4"	FOOT	54554	15324		38886	344	
70300240	TEMPORARY PAVEMENT MARKING - LINE 6"	FOOT	2583	2440		143		
70300260	TEMPORARY PAVEMENT MARKING - LINE 12"	FOOT	1482	437		1045		
70300280	TEMPORARY PAVEMENT MARKING - LINE 24"	FOOT	246	136		110		
70400100	TEMPORARY CONCRETE BARRIER	FOOT	225			225		
* 72000100	SIGN PANEL - TYPE 1	SQ FT	380	380				
* 72000200	SIGN PANEL - TYPE 2	SQ FT	15	15				
* 78000100	THERMOPLASTIC PAVEMENT MARKING - LETTERS AND SYMBOLS	SQ FT	963.6	891		72.6		
* 78000200	THERMOPLASTIC PAVEMENT MARKING - LINE 4"	FOOT	53812	15324		38488		
* 78000400	THERMOPLASTIC PAVEMENT MARKING - LINE 6"	FOOT	2583	2440		143		
* 78000600	THERMOPLASTIC PAVEMENT MARKING - LINE 12"	FOOT	1482	437		1045		
* 78000650	THERMOPLASTIC PAVEMENT MARKING - LINE 24"	FOOT	276	136		140		
* 78008210	POLYUREA PAVEMENT MARKING TYPE I - LINE 4"	FOOT	248			248		
* 78008250	POLYUREA PAVEMENT MARKING TYPE I - LINE 12"	FOOT	30			30		
* 78100100	RAISED REFLECTIVE PAVEMENT MARKER	EACH	403	138		265		
* 78300200	RAISED REFLECTIVE PAVEMENT MARKER REMOVAL	EACH	403	138		265		
* 81000600	CONDUIT IN TRENCH, 2" DIA., GALVANIZED STEEL	FOOT	990		990			
* 81000700	CONDUIT IN TRENCH, 2 1/2" DIA., GALVANIZED STEEL	FOOT	120		120			
* 81001000	CONDUIT IN TRENCH, 4" DIA., GALVANIZED STEEL	FOOT	166		166			
* 81018500	CONDUIT PUSHED, 2" DIA., GALVANIZED STEEL	FOOT	66		66			
* 81018900	CONDUIT PUSHED, 4" DIA., GALVANIZED STEEL	FOOT	152		152			
* 81400100	HANDHOLE	EACH	7		7			
* 81400200	HEAVY-DUTY HANDHOLE	EACH	4		4			

REVISIONS	
NAME	DATE

ILLINOIS DEPARTMENT OF TRANSPORTATION
SUMMARY OF QUANTITIES

Rev. 7-26-07

PLOT DATE: 5/14/2007

F.A.P. RTE.	SECTION	COUNTY	TOTAL SHEETS	SHEET NO.
334	111 RS-5 & 116 B-I	MCHENRY	98	6
FED. ROAD DIST. NO. 1		ILLINOIS	HIGHWAY PROJECT	

SUMMARY OF QUANTITIES				CONSTRUCTION TYPE CODE			
CODE NO	ITEM	UNIT	TOTAL QUANTITIES	LOCATION 1		LOCATION 2	LOCATION 3
				INTERSECTION	TRAFFIC SIGNAL	RESURFACING (3 P)	SN 056-0017 BRIDGE
				I000-2A	Y031-1F	I000	SFTY-2A
X7030104	WET REFLECTIVE TEMPORARY TAPE TYPE III - LINE 4''	FOOT	3426				3426
© 20076600	TRAINEES	HOUR	2000	2000			
44300200	STRIP REFLECTIVE CRACK CONTROL TREATMENT	FOOT	1350	1350			
X0322923	SEGMENTAL CONCRETE BLOCK WALL	SQ FT	99	99			

[illegible]

© Y080
* SPECIALITY ITEMS

REVISIONS	
NAME	DATE

ILLINOIS DEPARTMENT OF TRANSPORTATION SUMMARY OF QUANTITIES

① Rev. 7-26-07

PLOT DATE: 5/11/2007

CONTRACT NO. 60A91				
F.A.P. RTE.	SECTION	COUNTY	TOTAL SHEETS	SHEET NO.
334	**	MCHENRY	98	10
STA.		TO STA.		
FED. ROAD DIST. NO.		ILLINOIS FED. AID PROJECT		
** 111 RS-5 & 116 B-1				

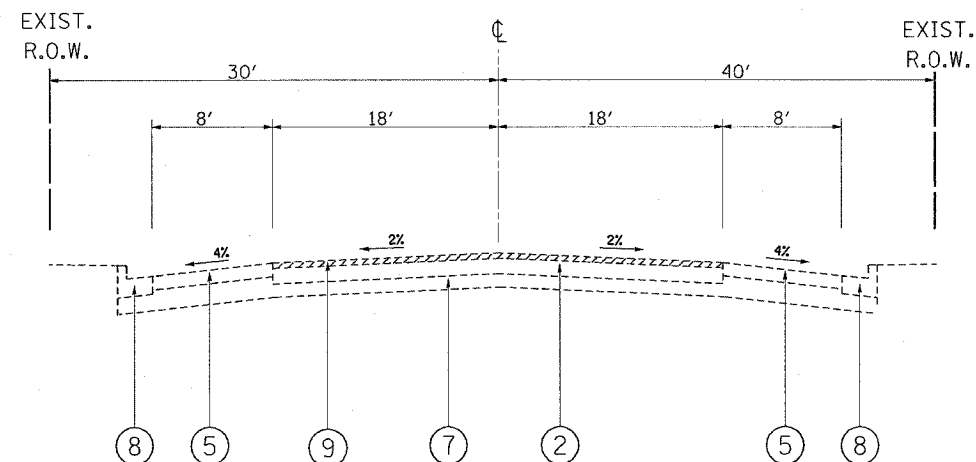

EXISTING TYPICAL SECTION
TRYON GROVE ROAD
STA. 4+92 'W' TO 7+50 'W'

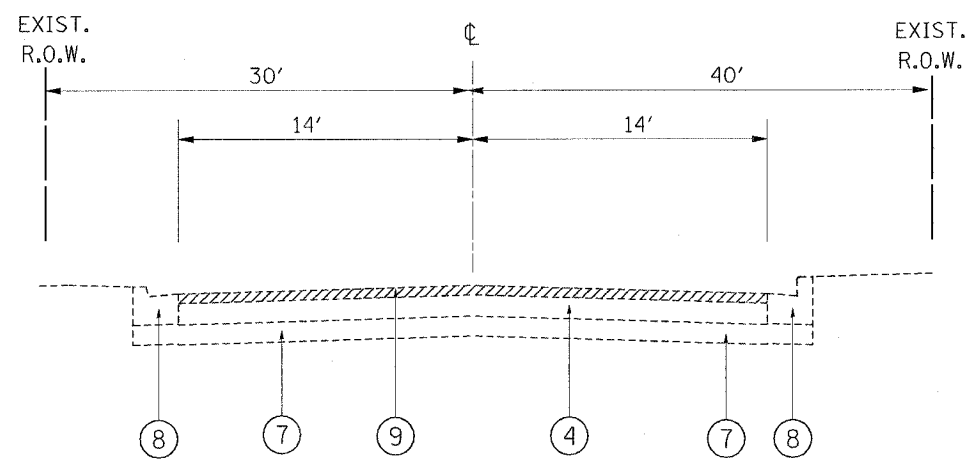

EXISTING TYPICAL SECTION
TRYON GROVE ROAD
STA. 7+50 'W' TO 10+00 'W'

- LEGEND:**
- ① EXISTING PORTLAND CEMENT CONCRETE PAVEMENT, $\pm 8\frac{1}{2}$ "
 - ② EXISTING HMA SURFACE COURSE, $\pm 5\frac{1}{2}$ "
 - ③ EXISTING HMA SURFACE COURSE, ± 3 "
 - ④ EXISTING HMA SURFACE COURSE, ± 4 "
 - ⑤ EXISTING HMA SHOULDER
 - ⑥ EXISTING AGGREGATE SHOULDER
 - ⑦ EXISTING AGGREGATE SUBBASE,
 - ⑧ EXISTING COMBINATION CONCRETE CURB AND GUTTER
 - ⑨ PROP. HMA SURFACE REMOVAL, $2\frac{1}{2}$ "
 - ⑩ PROP. HMA SURFACE COURSE, MIX "D", N70 $1\frac{1}{2}$ "
 - ⑪ PROP. POLYMERIZED LEVELING BINDER (MACHINE METHOD), IL-4.75, N50, 1"
 - ⑫ PROP. HMA BASE COURSE WIDENING, IL-19 mm, 11" (3 LIFTS)
 - ⑬ PROP. AGGREGATE SUBGRADE, 12" SPECIAL
 - ⑭ PROP. HMA SHOULDER, 8"
 - ⑮ PROP. AGGREGATE SHOULDER, TYPE B, 6"
 - ⑯ PROP. COMBINATION CURB AND GUTTER, TYPE M-6.24
 - ⑰ PROP. SUBBASE GRANULAR MATERIAL TYPE B, 6"
 - ⑱ PROP. HMA SURFACE REMOVAL, $2\frac{1}{4}$ "
 - ⑲ PROP. AGGREGATE WEDGE SHOULDER, TYPE B
 - ⑳ PROP. POLYMERIZED LEVELING BINDER (MACHINE METHOD), IL-4.75, N50, $\frac{3}{4}$ "
 - ㉑ PROP. HMA SURFACE REMOVAL, $1\frac{1}{2}$ "

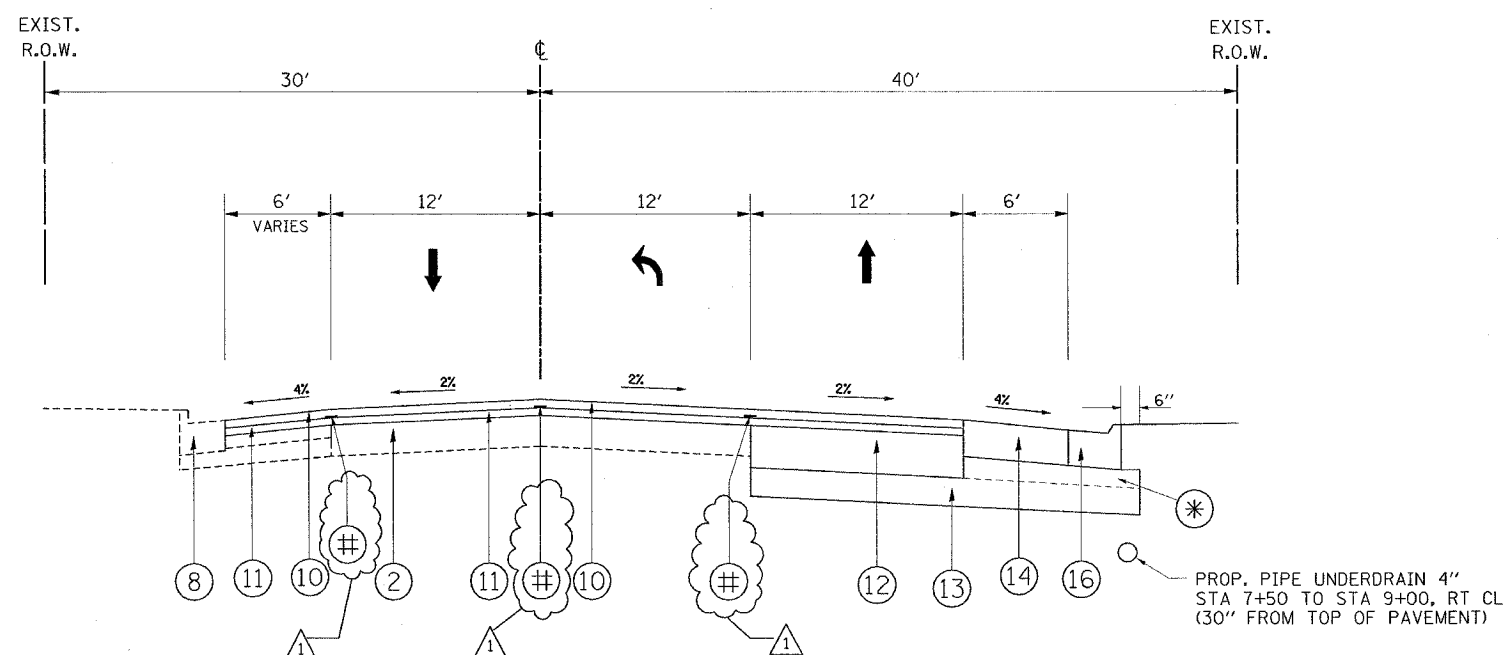

PROPOSED TYPICAL SECTION
TRYON GROVE ROAD - WEST LEG
STA. 4+92 'W' TO 10+00 'W'

⊕ PROP. STRIP REFLECTIVE CRACK CONTROL TREATMENT

* ADDITIONAL THICKNESS OF AGGREGATE SUBGRADE SHALL BE INCIDENTAL TO AGGREGATE SUBGRADE 12" SPECIAL

REVISIONS	
NAME	DATE

ILLINOIS DEPARTMENT OF TRANSPORTATION

**EXISTING & PROPOSED
TYPICAL SECTION
TRYON GROVE ROAD - WEST LEG
STA. 4+92 'W' TO 10+00 'W'**

SCALE: VERT.
HORIZ.
DATE

DRAWN BY
CHECKED BY

1 REVISED 7/23/07 AM

F.A.P. RTE.	SECTION	COUNTY	TOTAL SHEETS	SHE NO.
334	111 RS-5 & 116 B-1	McHENRY	98	16
STA.		TO STA.		
FED. ROAD DIST. NO.	ILLINOIS	FED. AID PROJECT		

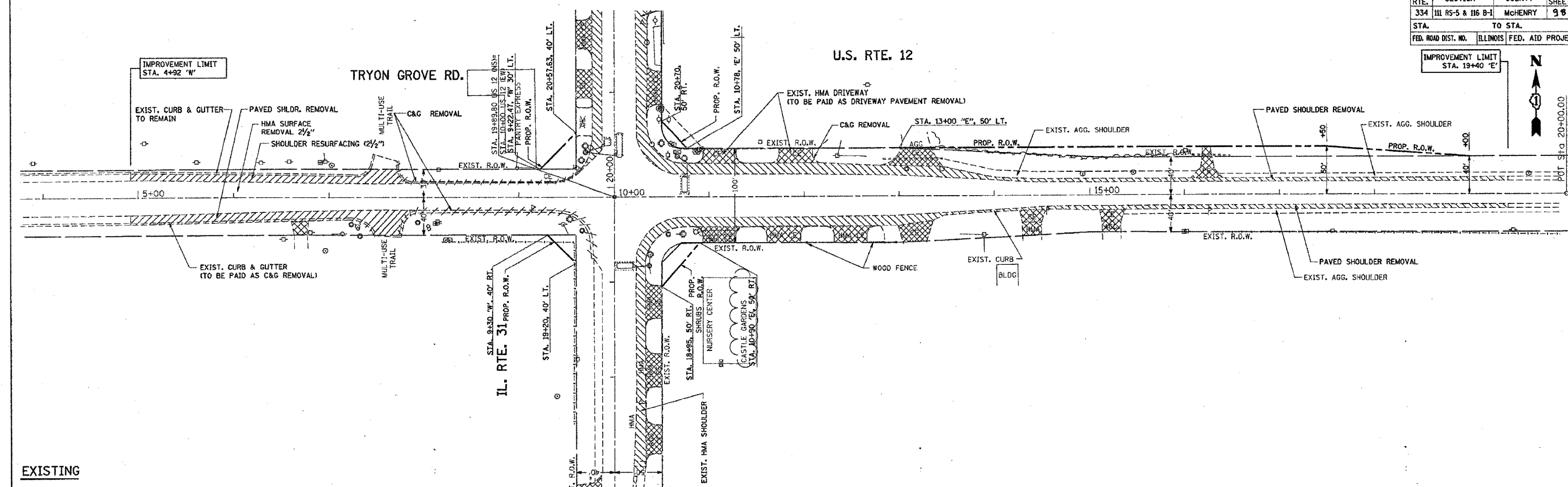

EXISTING

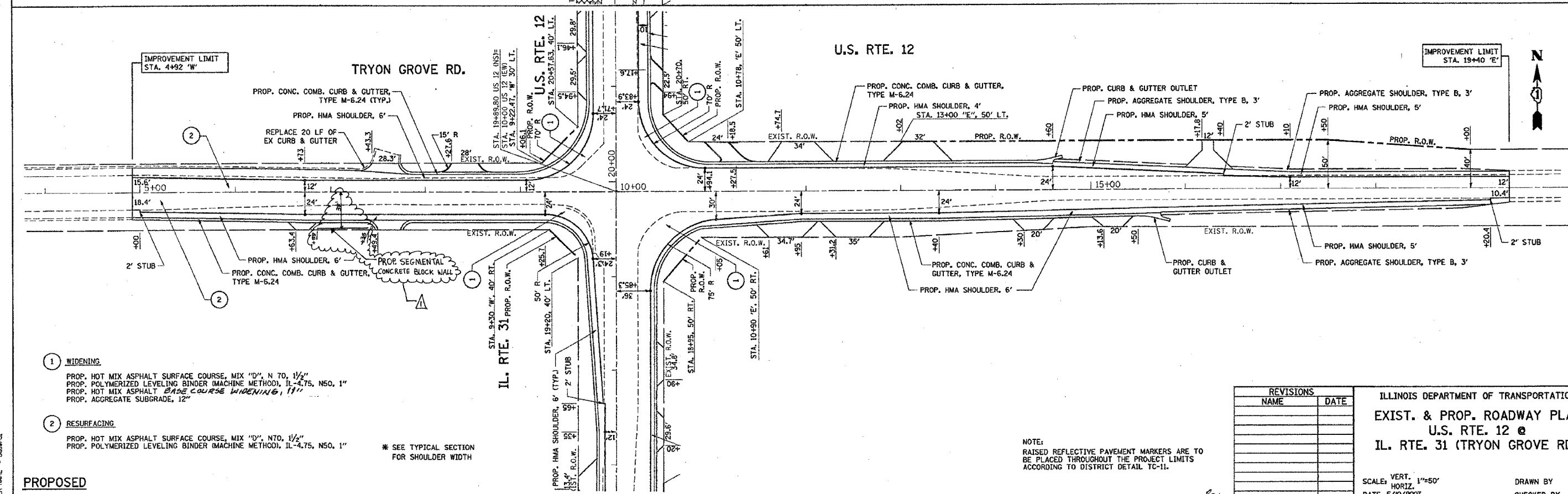

1 WIDENING

PROP. HOT MIX ASPHALT SURFACE COURSE, MIX "D", N 70, 1 1/2"
PROP. POLYMERIZED LEVELING BINDER (MACHINE METHOD), IL-4.75, N50, 1"
PROP. HOT MIX ASPHALT BASE COURSE WIDENING, 1 1/2"
PROP. AGGREGATE SUBGRADE, 12"

2 RESURFACING

PROP. HOT MIX ASPHALT SURFACE COURSE, MIX "D", N70, 1 1/2"
PROP. POLYMERIZED LEVELING BINDER (MACHINE METHOD), IL-4.75, N50, 1"

* SEE TYPICAL SECTION
FOR SHOULDER WIDTH

NOTE:
RAISED REFLECTIVE PAVEMENT MARKERS ARE TO
BE PLACED THROUGHOUT THE PROJECT LIMITS
ACCORDING TO DISTRICT DETAIL TC-11.

[illegible]

ILLINOIS DEPARTMENT OF TRANSPORTATION
EXIST. & PROP. ROADWAY PLAN
U.S. RTE. 12 @
IL. RTE. 31 (TRYON GROVE RD.)

SCALE: VERT. 1"=50'
HORIZ.
DATE 5/10/2007

DRAWN BY
CHECKED BY

1 REVISED 7/23/07 AM

REF-TOP005
REF-PP05

CONTRACT NO. 60A91

F.A.P. RTE.	SECTION	COUNTY	TOTAL SHEETS	NO.
334	III RS-5 & 116 B-1	MCHEERY	98	21
STA.	TO STA.			
FED. ROAD DIST. NO.	ILLINOIS	FED. AID PROJECT		

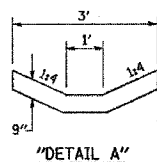
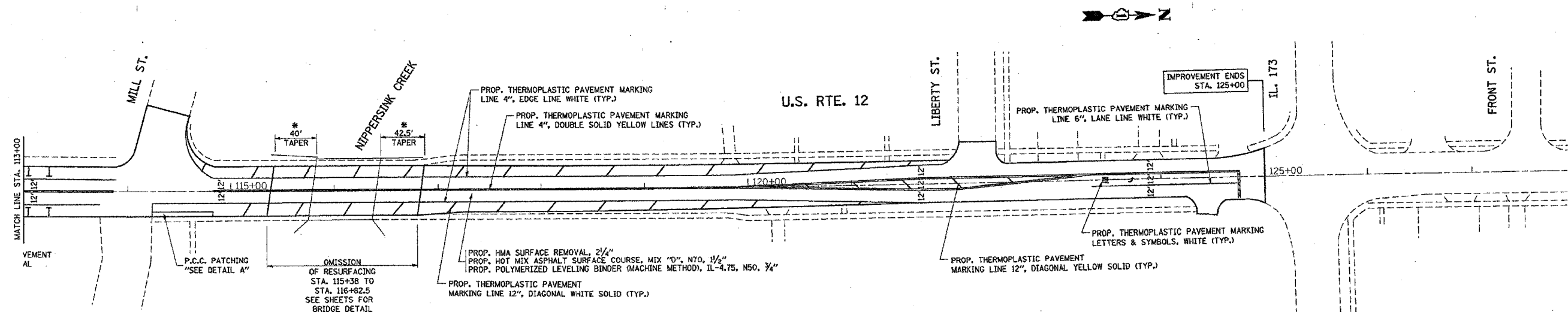
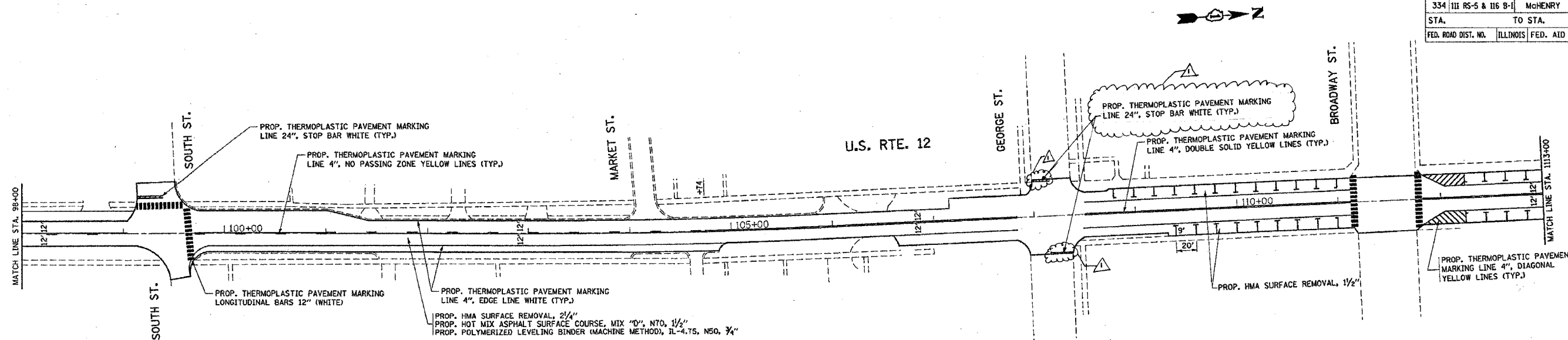

- * HMA SURFACE REMOVAL, 2 1/4"
- * TAPER AND PCC BUTT JOINT TO BE PERFORMED DURING BRIDGE DECK OVERLAY STAGE (SEE SHEET 72)

NOTE:
RAISED REFLECTIVE PAVEMENT MARKERS ARE TO BE PLACED THROUGHOUT THE PROJECT LIMITS ACCORDING TO DISTRICT DETAIL TC-11.
POLYUREA PAVEMENT MARKING SHALL BE USED ON THE BRIDGE.

REVISIONS	
NAME	DATE

ILLINOIS DEPARTMENT OF TRANSPORTATION
EXIST. & PROP. ROADWAY PLAN
U.S. RTE. 12 @
IL. RTE. 31 (TRYON GROVE RD.)

SCALE: VERT. 1"=50'
HORIZ. 1"=50'
DATE 5/10/2007

DRAWN BY
CHECKED BY

REVISED 7/23/07 AM

CONTRACT NO. 60A91				
F.A.P. RTE.	SECTION	COUNTY	TOTAL SHEETS	SHEET NO.
334	**	MCHENRY	93	30
STA.		TO STA.		
FED. ROAD DIST. NO.		ILLINOIS FED. AID PROJECT		
** 111 RS-5 & 116 B-1				

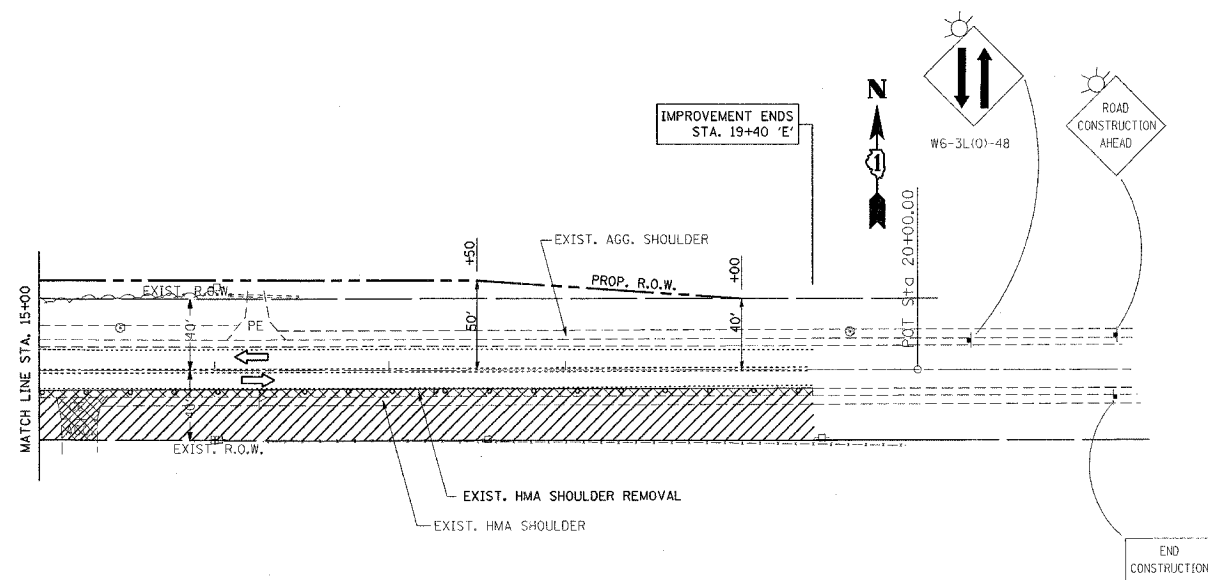
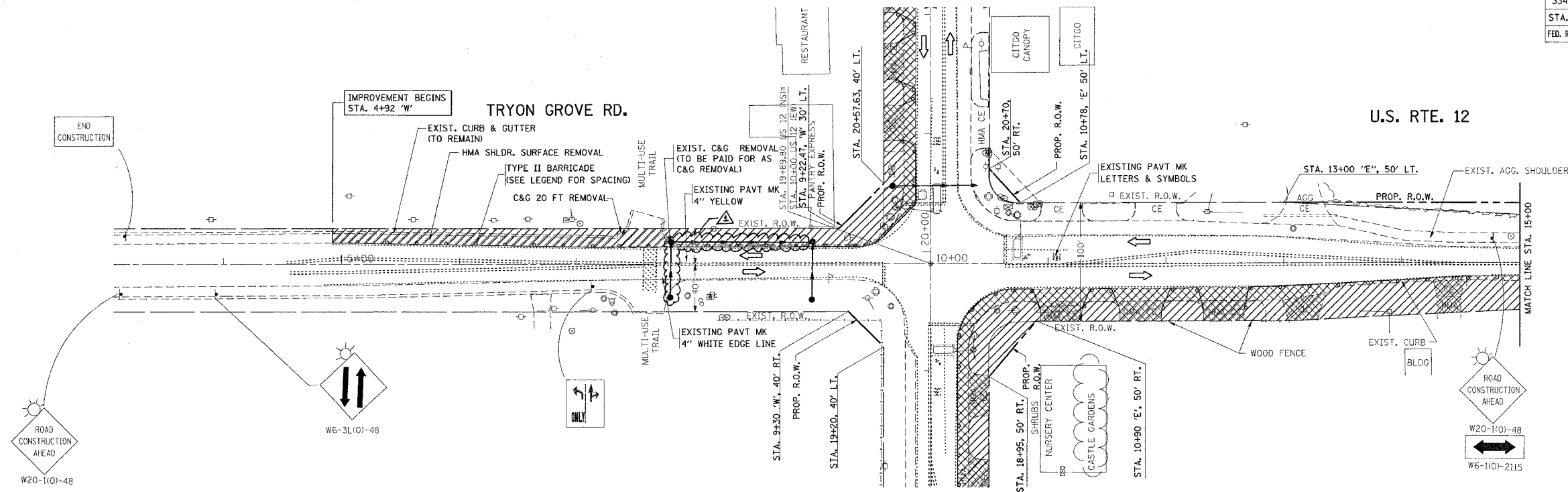

- LEGEND
- - TYPE II BARRICADE
 - 50' C-C TANGENTS
 - 25' C-C LANE SHIFTS & TAPERS
 - 10' C-C RADII (TYP)

- WORK ZONE
- DIRECTION OF TRAFFIC

REVISIONS		ILLINOIS DEPARTMENT OF TRANSPORTATION	
NAME	DATE		
		STAGE I CONSTRUCTION U.S. RTE. 12 @ IL. RTE. 31/TRYON GROVE DR.	
SCALE: VERT.		DRAWN BY	
DATE		CHECKED BY	

F.A.P. RTE.	SECTION	COUNTY	TOTAL SHEETS	SHEET NO.
334	**	MCHENRY	98	32
STA.		TO STA.		
FED. ROAD DIST. NO.		ILLINOIS	FED. AID PROJECT	

** 111 RS-5 & 116 B-1

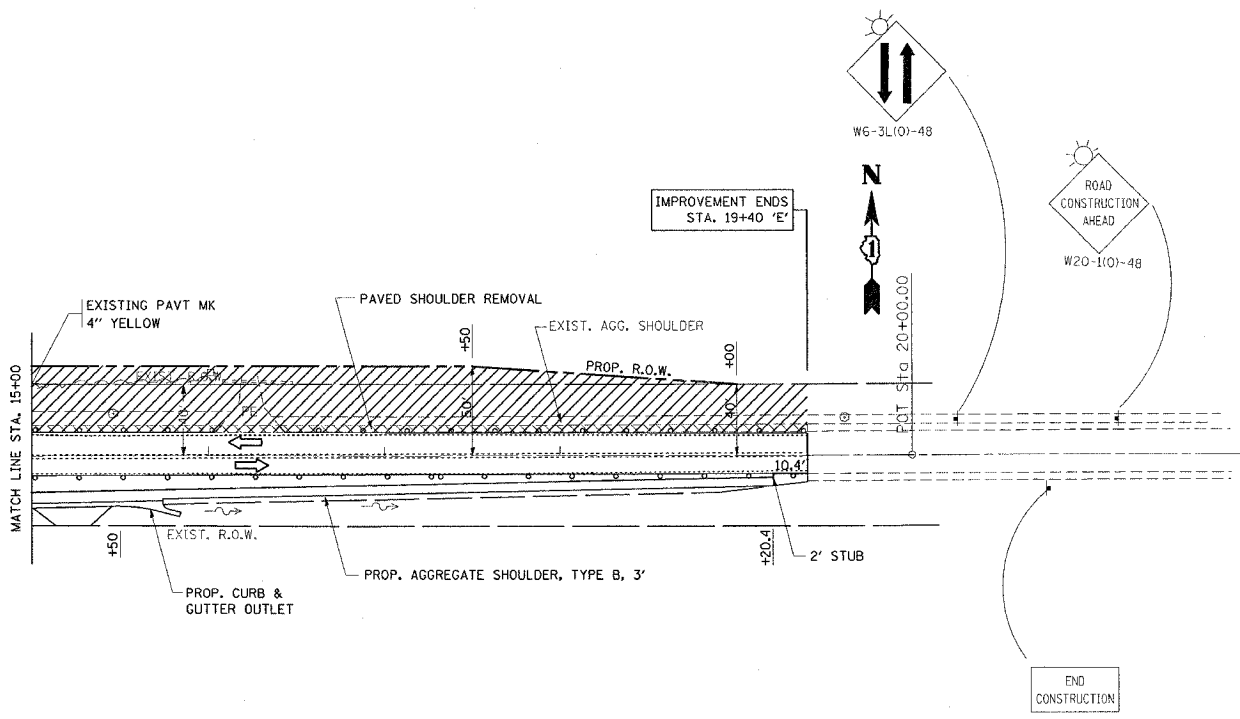
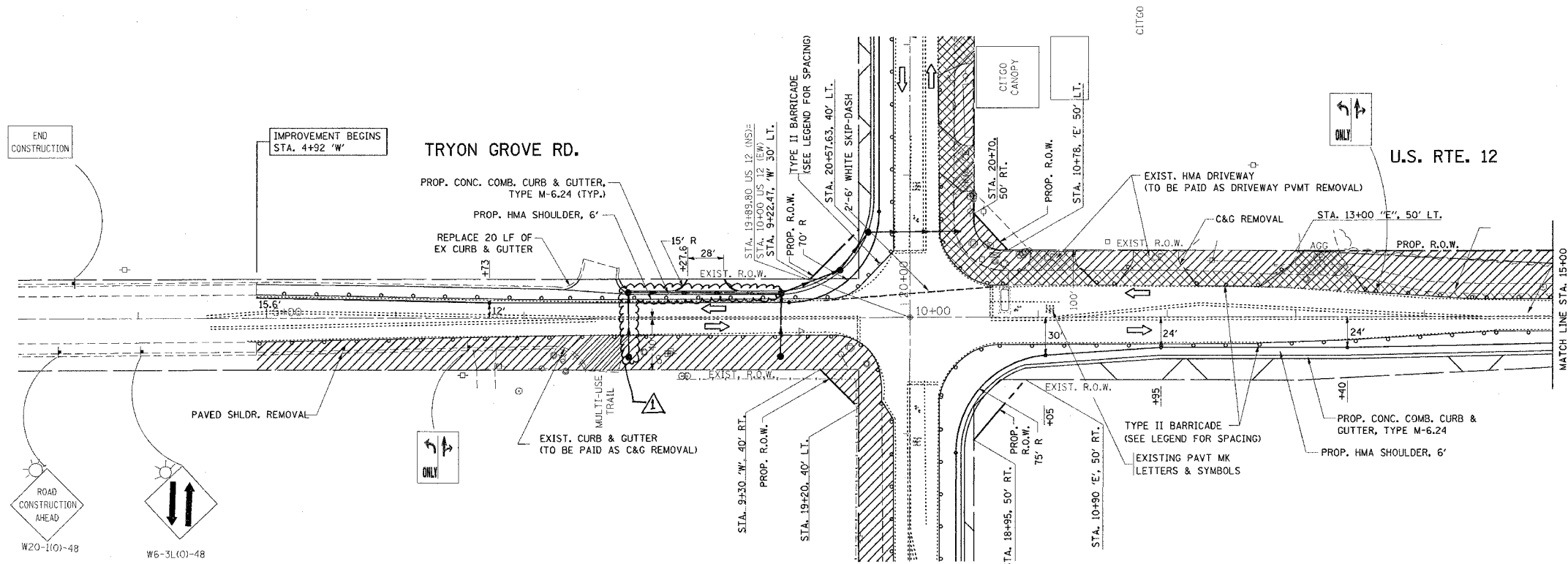

- LEGEND
- - TYPE II BARRICADE
 - 50' C-C TANGENTS
 - 25' C-C LANE SHIFTS & TAPERS
 - 10' C-C RADII (TYP)
 - ▨ - WORK ZONE
 - ➡ - DIRECTION OF TRAFFIC

REVISIONS	
NAME	DATE

ILLINOIS DEPARTMENT OF TRANSPORTATION

STAGE II CONSTRUCTION
U.S. RTE. 12 @
IL. RTE. 31/TRYON GROVE DR.

SCALE: VERT. _____
HORIZ. _____

DATE _____

DRAWN BY _____
CHECKED BY _____

PLOT DATE = 7/24/2007
PLOT SCALE = 1/4\"/>

CONTRACT NO. 60A91				
F.A.P. RTE.	SECTION	COUNTY	TOTAL SHEETS	SHEET NO.
334	**	MCHENRY	98	34
STA.		TO STA.		
FED. ROAD DIST. NO.	ILLINOIS	FED. AID PROJECT		
** 111 RS-5 & 116 B-I				

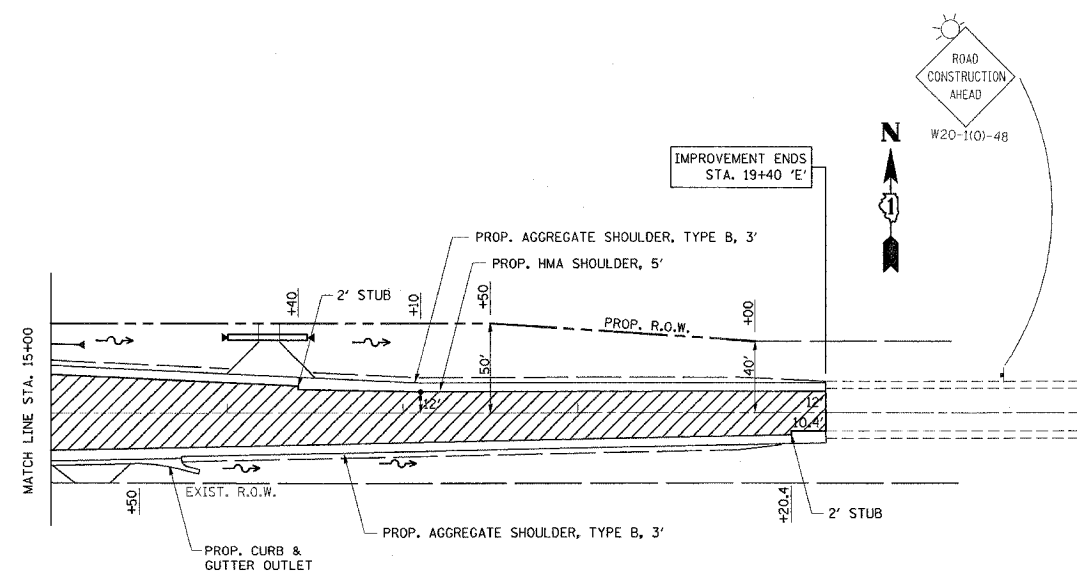
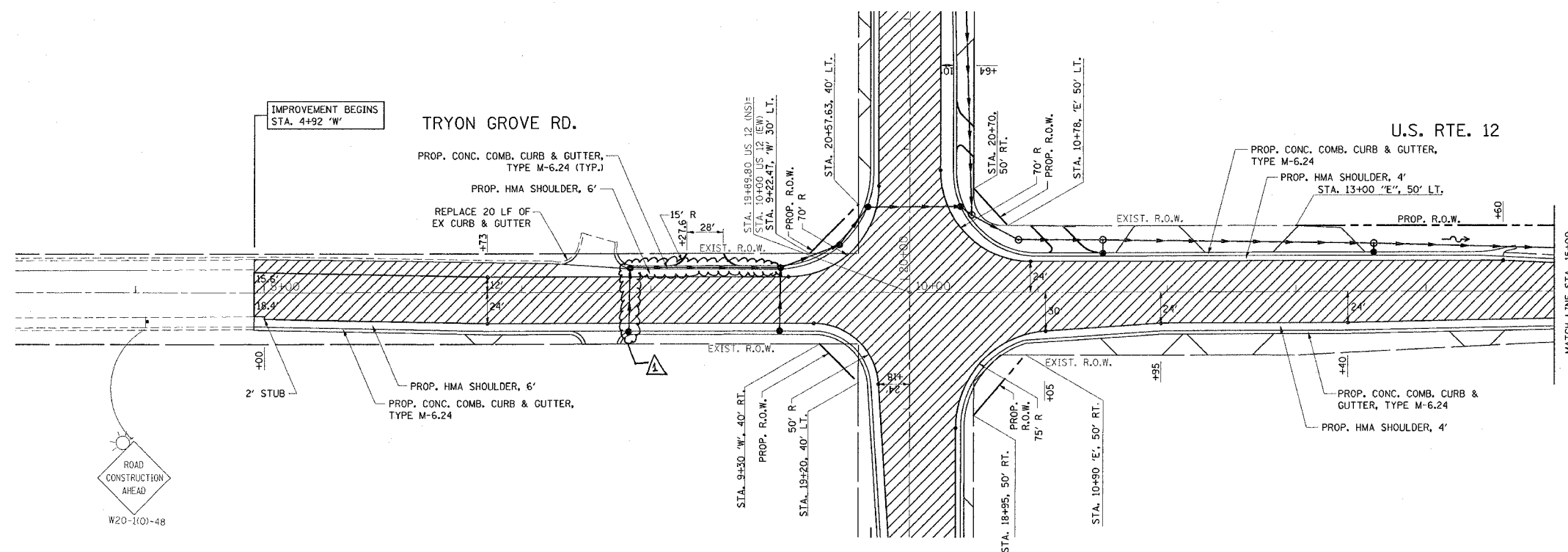

- LEGEND
- - TYPE II BARRICADE
 - 50' C-C TANGENTS
 - 25' C-C LANE SHIFTS & TAPERS
 - 10' C-C RADII (TYP)
 - ▨ - WORK ZONE
 - ➡ - DIRECTION OF TRAFFIC

REVISIONS	
NAME	DATE

ILLINOIS DEPARTMENT OF TRANSPORTATION

STAGE III CONSTRUCTION
U.S. RTE. 12 @
IL. RTE. 31/TRYON GROVE DR.

SCALE: VERT.
 DATE: HORIZ.

DRAWN BY
 CHECKED BY

REF-003

CONTRACT NO. 60A91				
F.A.P. RTE.	SECTION	COUNTY	TOTAL SHEETS	SHEET NO.
334	11 RS-5 & 116 B-1	MCHEMRY	98	35
STA.		TO STA.		
FED. ROAD DIST. NO.		ILLINOIS FED. AID PROJECT		

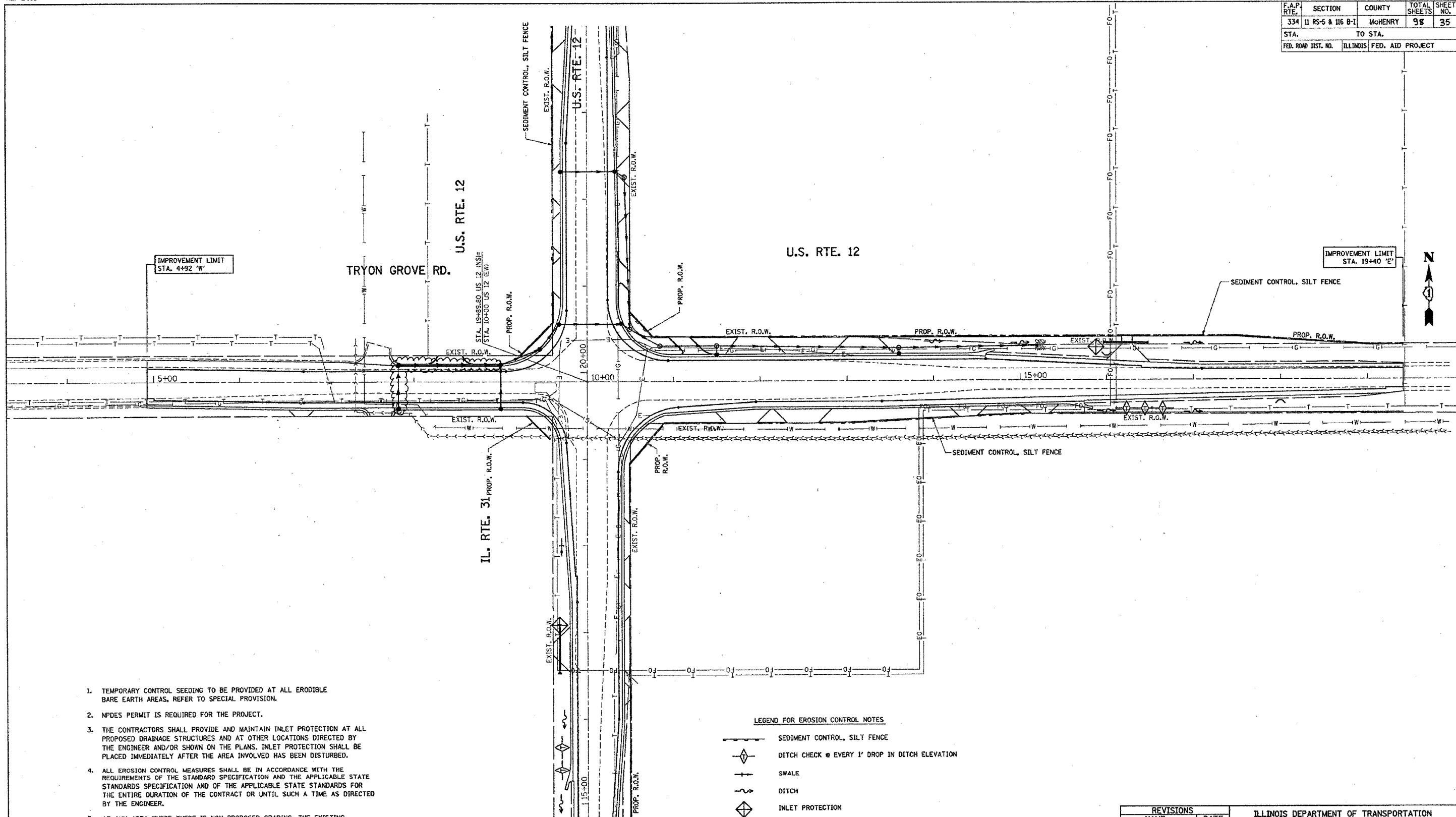

- TEMPORARY CONTROL SEEDING TO BE PROVIDED AT ALL ERODIBLE BARE EARTH AREAS. REFER TO SPECIAL PROVISION.
- NPDES PERMIT IS REQUIRED FOR THE PROJECT.
- THE CONTRACTORS SHALL PROVIDE AND MAINTAIN INLET PROTECTION AT ALL PROPOSED DRAINAGE STRUCTURES AND AT OTHER LOCATIONS DIRECTED BY THE ENGINEER AND/OR SHOWN ON THE PLANS. INLET PROTECTION SHALL BE PLACED IMMEDIATELY AFTER THE AREA INVOLVED HAS BEEN DISTURBED.
- ALL EROSION CONTROL MEASURES SHALL BE IN ACCORDANCE WITH THE REQUIREMENTS OF THE STANDARD SPECIFICATION AND THE APPLICABLE STATE STANDARDS SPECIFICATION AND OF THE APPLICABLE STATE STANDARDS FOR THE ENTIRE DURATION OF THE CONTRACT OR UNTIL SUCH A TIME AS DIRECTED BY THE ENGINEER.
- AT ANY AREA WHERE THERE IS NON PROPOSED GRADING, THE EXISTING GROUND COVER SHALL REMAIN.
- "WETLANDS" SIGN SHALL BE ATTACHED TO THE SEDIMENT CONTROL SILT FENCE POST AT EACH WETLAND. SIGNS ARE AVAILABLE FROM THE ROADSIDE DEVELOPMENT UNIT (847)705-4171.

LEGEND FOR EROSION CONTROL NOTES

- SEDIMENT CONTROL, SILT FENCE
- DITCH CHECK @ EVERY 1' DROP IN DITCH ELEVATION
- SWALE
- DITCH
- INLET PROTECTION

NOTE: WETLAND SIGN



REVISIONS	
NAME	DATE

ILLINOIS DEPARTMENT OF TRANSPORTATION
EROSION CONTROL PLAN
U.S. RTE. 12 @
IL. RTE. 31 (TRYON GROVE RD.)

SCALE: VERT. 1"=50'
HORIZ. 1"=50'
DATE 5/10/2007

DRAWN BY
CHECKED BY

△ REVISED 7/23/07 AM

FILE NAME = 5/10/2007
PLOT NAME = c:\projects\1114899\ah_erosion.dgn
PLOT SCALE = 1/8"=1'-0"
USER NAME = boudard

REF-EDR03
REF-PDR03

CONTRACT NO. 60A91

F.A.P. RTE.	SECTION	COUNTY	TOTAL SHEETS	SHEET NO.
334	III RS-5 & 116 B-1	McHENRY	38	37
STA.	TO STA.			
FED. ROAD DIST. NO.	ILLINOIS	FED. AID PROJECT		

IMPROVEMENT LIMIT
STA. 19+40 'E'

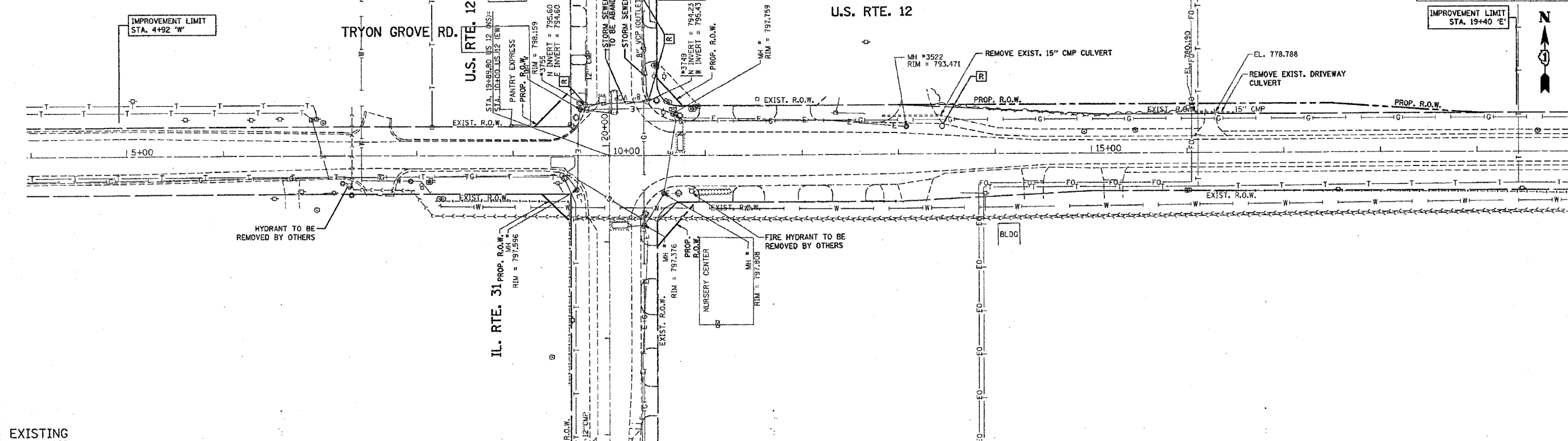

EXISTING

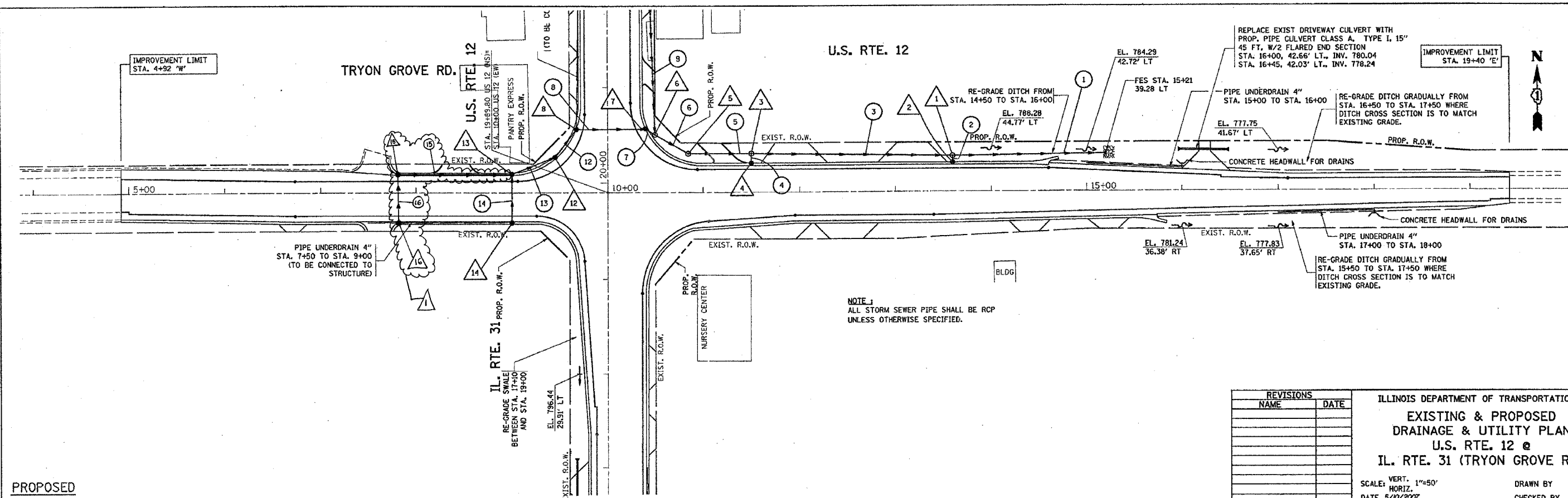

PROPOSED

REVISIONS	
NAME	DATE

ILLINOIS DEPARTMENT OF TRANSPORTATION
EXISTING & PROPOSED
DRAINAGE & UTILITY PLAN
U.S. RTE. 12 @
IL. RTE. 31 (TRYON GROVE RD.)

SCALE: VERT. 1"=50'
HORIZ. 1"=50'
DATE 5/10/2007

DRAWN BY
CHECKED BY

REVISD 7/23/07 AM

PLOT DATE = 5/10/2007
FILE NAME = c:\projects\60a91\plan2.dgn
PLOT SCALE = 1/8"=1'-0"
USER NAME = bauer

CONTRACT NO. 60A91				
F.A.P. RTE.	SECTION	COUNTY	TOTAL SHEETS	SHEET NO.
334	**	MCHENRY	98	42
STA.		TO STA.		
FED. ROAD DIST. NO.		ILLINOIS	FED. AID PROJECT	
** 111 RS-5 & 116 B-1				

1 PROP. 15' STORM SEWER,
CLASS A, TY II, 155' @ 2.0%
US 12 (E), STA 15+21, 39.28' LT
INV. 782.30 (E)

2 PROP. 12' STORM SEWER,
CLASS A, TY II, 6' @ 1.0%

3 PROP. 15' STORM SEWER,
CLASS A, TY II, 210' @ 1.64%
T.B.F.: 85 CY

4 PROP. 12' STORM SEWER,
CLASS A, TY II, 10' @ 1.0%

5 PROP. 15' STORM SEWER,
CLASS A, TY II, 65' @ 1.38%
T.B.F.: 22 CY

6 PROP. 12' STORM SEWER,
CLASS A, TY II, 40' @ 1.4%

7 PROP. 12' STORM SEWER,
CLASS A, TY II, 9' @ 1.0%

8 PROP. 12' STORM SEWER,
CLASS A, TY II, 75' @ 0.68%
T.B.F.: 47 CY

9 PROP. 12' STORM SEWER,
CLASS A, TY II, 175' @ 0.6%
T.B.F.: 20.9 CY

10 PROP. 12' STORM SEWER,
CLASS A, TY II, 11' @ 1%

11 PROP. 12' STORM SEWER,
CLASS A, TY I, 63' @ 1.0%
T.B.F.: 11.2 CY

12 PROP. 12' STORM SEWER,
CLASS A, TY II, 38' @ 0.80%
T.B.F.: 24.6 CY

13 PROP. 12' STORM SEWER,
CLASS A, TY II, 46' @ 1.13%

14 PROP. 12' STORM SEWER,
CLASS A, TY I, 48' @ 1.56%
T.B.F.: 6.34 CY

15 PROP. 6" STORM SEWER,
CLASS A, TY II, 125' @ 0.4%
T.B.F.: 5 CY

16 PROP. 12' STORM SEWER,
CLASS A, TY I, 51' @ 0.2%
T.B.F.: 5.6 CY



MH TY A, 4' DIA.
TYPE I FRAME, CLOSED LID
US 12 (E), STA 13+60, 37.3' LT
T.O.G. 792.0
INV. 785.45 (W)
INV. 785.25 (E)
INV. 786.68 (S)



CB TY C, 2' DIA.
TYPE 24 FRAME AND GRATE
US 12 (E), STA 13+60, 29.3' LT
T.O.G. 791.67
INV. 786.75 (N)



MH TY A, 4' DIA.
TYPE I FRAME, CLOSED LID
US 12 (E), STA 11+50, 40.5' LT
T.O.G. 796.80
INV. 789.00 (W)
INV. 788.90 (E)
INV. 791.00 (S)



CB TY C, 2' DIA.
TYPE 24 FRAME AND GRATE
US 12 (E), STA 11+50, 29.3' LT
T.O.G. 796.26
INV. 791.09 (N)



MH TY A, 4' DIA.
TYPE I FRAME, CLOSED LID
US 12 (E), STA 10+85, 40.3' LT
T.O.G. 797.5
INV. 790.00 (NW)
INV. 789.90 (E)



MH TY A, 4' DIA.
TYPE I FRAME, CLOSED LID
US 12 (N), STA 20+50, 49.6' RT
T.O.G. 798.0
INV. 792.08 (N)
INV. 790.30 (SE)
INV. 790.55 (W)



CB TY C, 2' DIA.
TYPE 24 FRAME AND GRATE
US 12 (N), STA 20+56, 41.4' RT
T.O.G. 797.42
INV. 790.65 (SE)
INV. 790.75 (W)

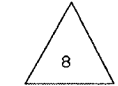

CB TY C, 2' DIA.
TYPE 24 FRAME AND GRATE
US 12 (N), STA 20+56, 34.34' LT
T.O.G. 797.61
INV. 791.26 (E)
INV. 791.36 (SW)

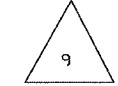

MH TY A, 4' DIA.
TYPE I FRAME, CLOSED LID
US 12 (N), STA 22+24, 43.8' RT
T.O.G. 798.5
INV. 793.33 (NW)
INV. 793.13 (S)

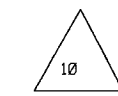

CB TY C, 2' DIA.
TYPE 24 FRAME AND GRATE
US 12 (N), STA 22+31, 33.6' RT
T.O.G. 798.5
INV. 793.73 (W)
INV. 793.43 (SE)

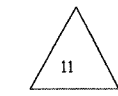

CB TY C, 2' DIA.
TYPE 24 FRAME AND GRATE
US 12 (N), STA 22+31, 29.2' LT
T.O.G. 798.7
INV. 794.35 (E)



CB TY C, 2' DIA.
TYPE 24 FRAME AND GRATE
US 12 (N), STA 20+25, 57.2' LT
T.O.G. 796.80
INV. 791.76 (SW)
INV. 791.66 (NE)

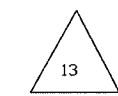

CB TY C, 2' DIA.
TYPE 24 FRAME AND GRATE
TRYON G. RD., STA 9+00, 19.2' LT
T.O.G. 796.78
INV. 792.28 (NE)
INV. 792.38 (S)

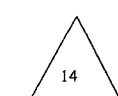

CB TY C, 2' DIA.
TYPE 24 FRAME AND GRATE
TRYON G. RD., STA 9+00, 31.2' RT
T.O.G. 796.57
INV. 793.13 (N)

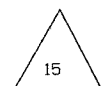

CB TY C, 2' DIA.
TYPE 24 FRAME AND GRATE
TRYON G. RD., STA 7+82, 19.6' LT
T.O.G. 796.35
INV. 793.00 (E)
INV. 793.25 (S)

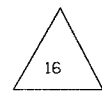

CB TY C, 2' DIA.
TYPE 24 FRAME AND GRATE
TRYON G. RD., STA 7+80, 30.8' RT
T.O.G. 796.00
INV. 793.3 (N)

NOTE:
ALL OFFSETS OF CATCH BASINS ARE MESURED TO THE CENTER OF THE FRAME

REVISIONS	
NAME	DATE

ILLINOIS DEPARTMENT OF TRANSPORTATION

DRAINAGE SCHEDULE
U.S. RTE. 12 @
IL. RTE. 31 /TRYON GROVE RD.

SCALE: VERT.
HORIZ.
DATE

DRAWN BY
CHECKED BY

F.A.P. RTE.	SECTION	COUNTY	TOTAL SHEETS	SHEET NO.
334	**	MCHENRY	98	49A
STA.		TO STA.		
FED. ROAD DIST. NO.		ILLINOIS FED. AID PROJECT		

** 111 RS-5 & 116 B-1

NOTE:
ALL COUNTY SIGNS SHALL BE IN YELLOW ON BLUE
ALL NON COUNTY SIGNS SHALL BE IN BLACK ON WHITE

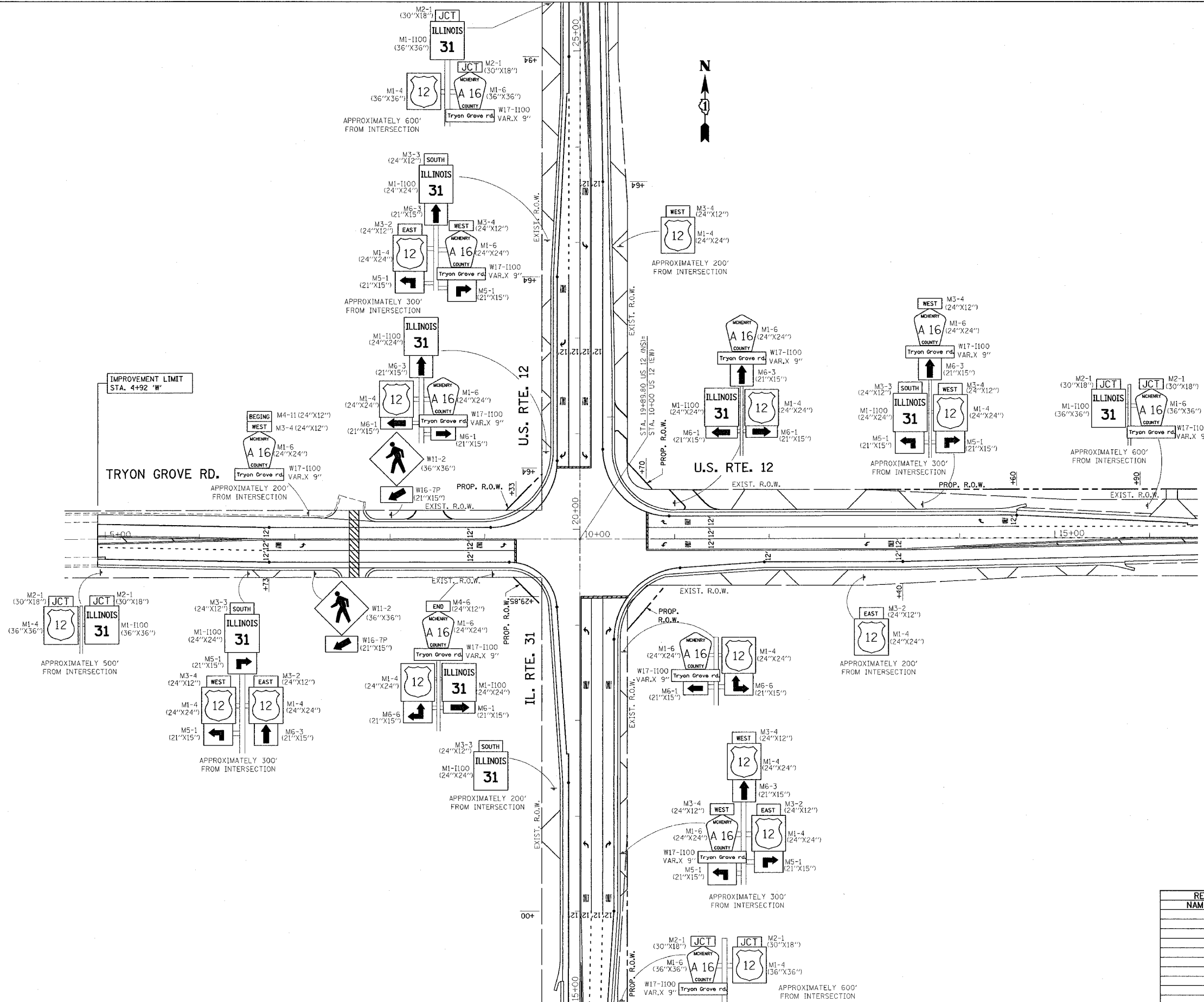
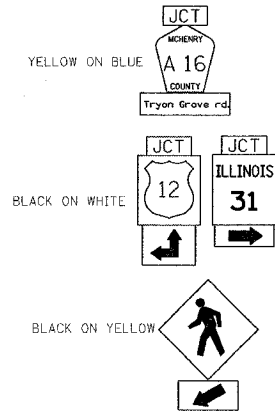

REVISIONS	
NAME	DATE

ILLINOIS DEPARTMENT OF TRANSPORTATION

SIGNING PLAN

SCALE: VERT.
DATE HORIZ.

DRAWN BY
CHECKED BY

PLOT DATE = 7/24/2007
FILE NAME = c:\p\projects\11499\p11499a.dwg
PLOT SCALE = 50.000000
USER NAME = mjd

PLOT DATE = 7/23/2007
FILE NAME = c:\projects\11189\11189-12-tryon-4\11189-12-tryon-4.dwg
USER NAME = m440

ORIGINAL SURVEY
PLOT
BOOK
NO.

DATE
BY
SURVEY
PLOT
BOOK
NO.

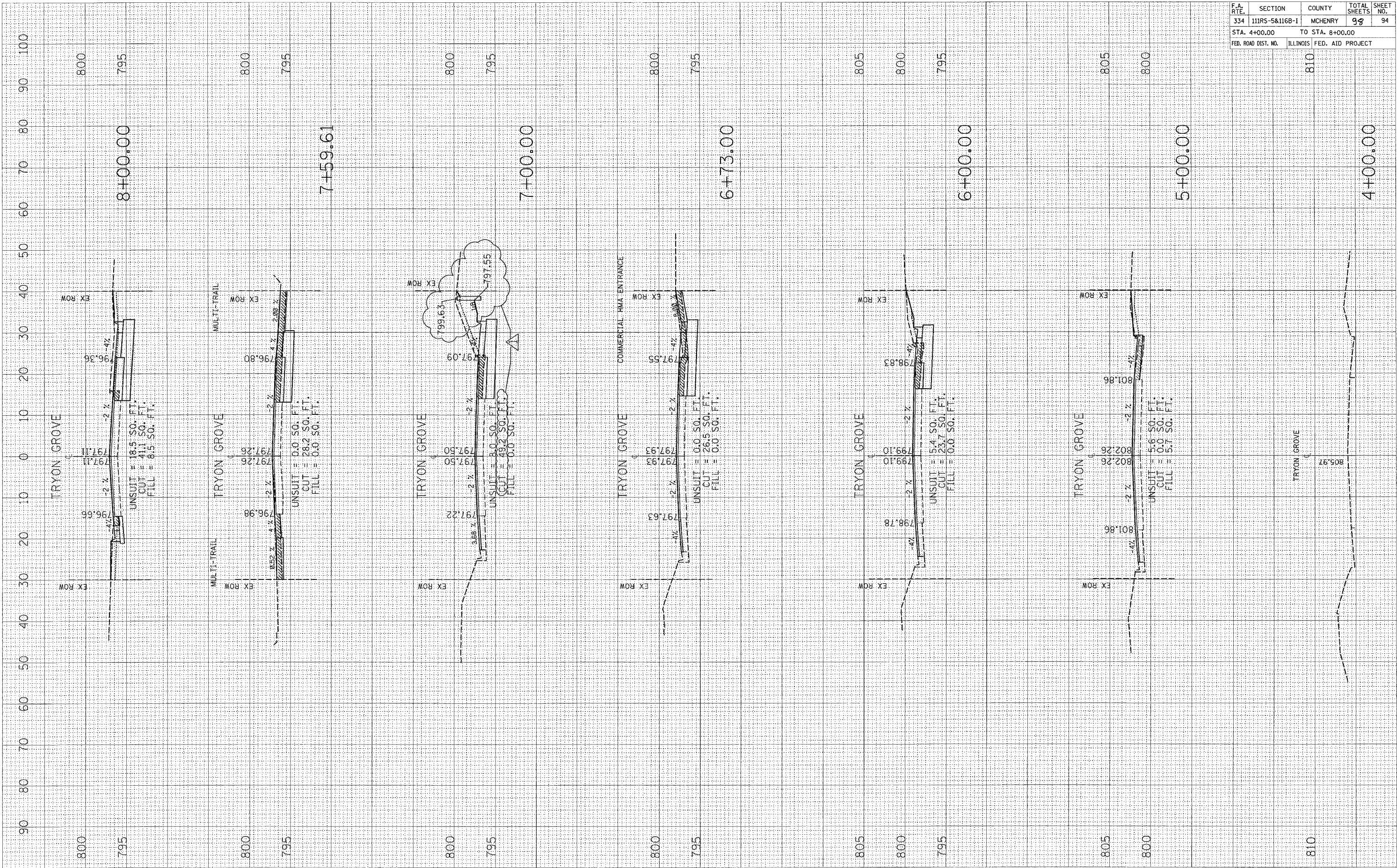

CONTRACT NO. 60A91				
F.A. RTE.	SECTION	COUNTY	TOTAL SHEETS	SHEET NO.
334	111RS-5&1168-1	MCHENRY	93	94
STA. 4+00.00		TO STA. 8+00.00		
FED. ROAD DIST. NO.		ILLINOIS FED. AID PROJECT		

REVISD 7/23/07 AM