

REF-TP003
REF-PP03

CONTRACT NO. 60A91

F.A.P. RTE.	SECTION	COUNTY	TOTAL SHEETS	SHEET NO.
334	III RS-5 & 116 B-1	MCHENRY	36	19
STA.		TO STA.		
FED. ROAD DIST. NO.	ILLINOIS	FED. AID PROJECT		

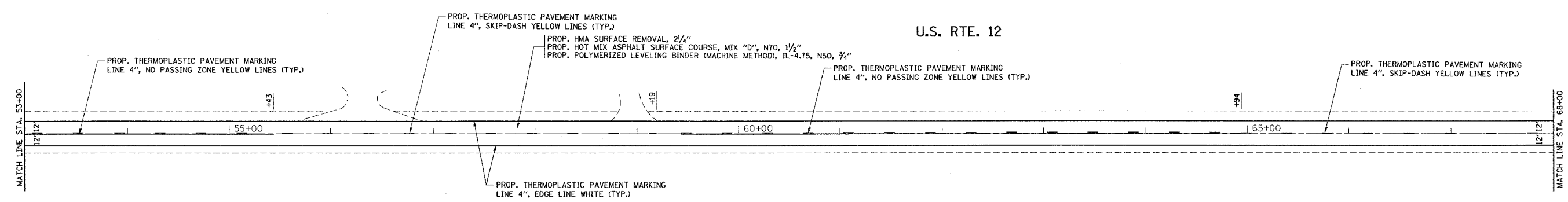
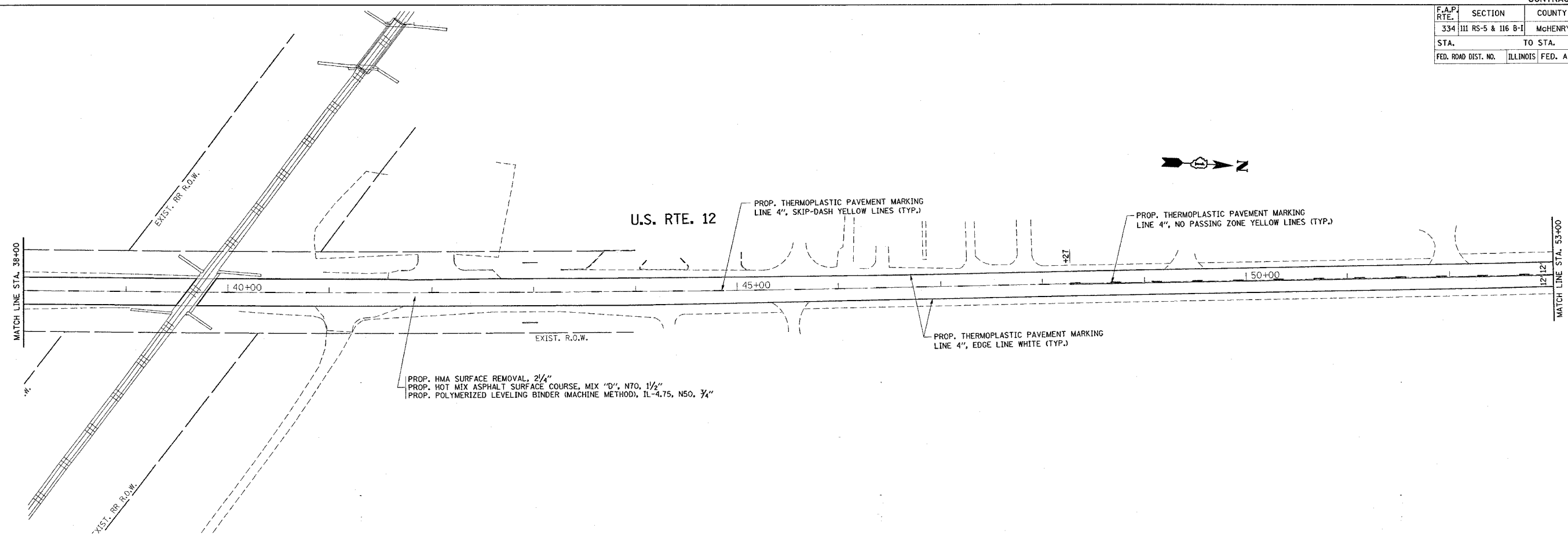

PLOT DATE = 5/10/2007
FILE NAME = c:\nrcs\secta\0114895a\ah_dwg2.dgn
PLOT SCALE = 50.0000' / 1" IN.
USER NAME = bward

NOTE:
RAISED REFLECTIVE PAVEMENT MARKERS ARE TO BE PLACED THROUGHOUT THE PROJECT LIMITS ACCORDING TO DISTRICT DETAIL TC-11.

REVISIONS	
NAME	DATE

ILLINOIS DEPARTMENT OF TRANSPORTATION
EXIST. & PROP. ROADWAY PLAN
U.S. RTE. 12 @
IL. RTE. 31 (TRYON GROVE RD.)
SCALE: VERT. 1"=50'
HORIZ. 1"=50'
DATE 5/10/2007
DRAWN BY
CHECKED BY