

F.A.P. RTE.	SECTION	COUNTY	TOTAL SHEETS	SHEET NO.
334	**	MCHENRY	98	72
STA.		TO STA.		
FED. ROAD DIST. NO.		ILLINOIS FED. AID PROJECT		

** 111 RS-5 & 116 B-I

NOTE:
COVER EXISTING CONFLICTING PAVEMENT MARKINGS WITH BLACK TYPE III TAPE. THE COST AND ITS REMOVAL IS INCLUDED IN THE COST OF "TRAFFIC CONTROL AND PROTECTION (SPECIAL)"

SIDEWALK CLOSURE AT EACH CONSTRUCTION STAGE PER STANDARD 701801 WHICH COST SHALL BE INCLUDED IN THE COST OF "TRAFFIC CONTROL AND PROTECTION (SPECIAL)"

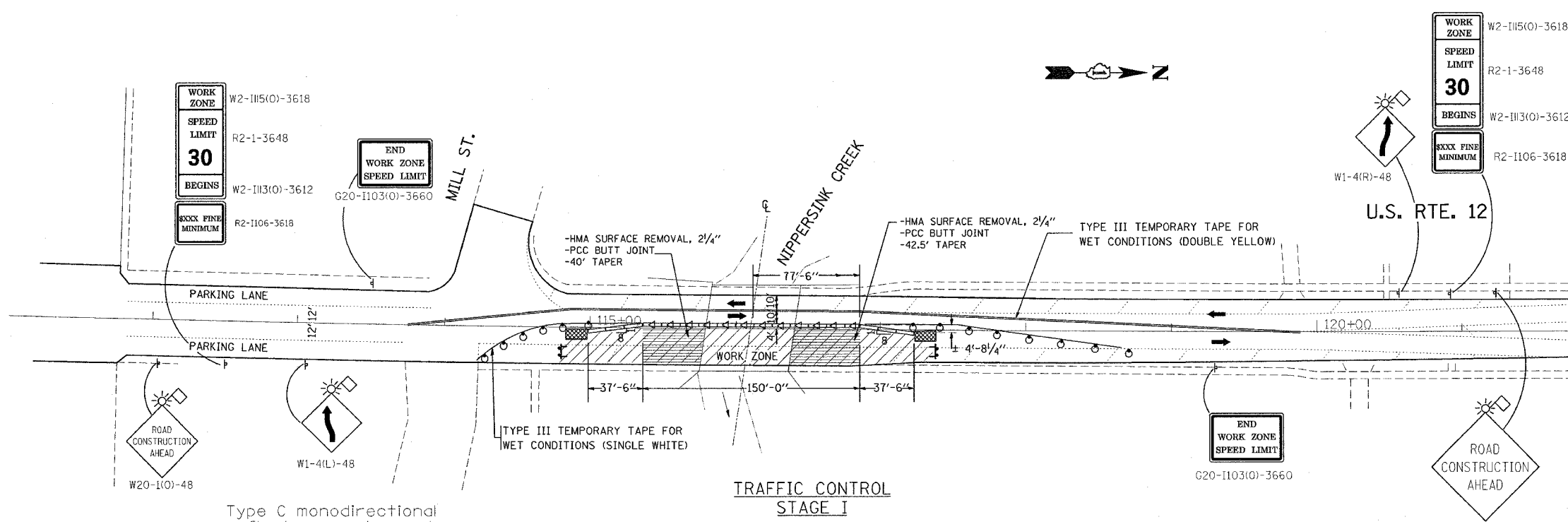
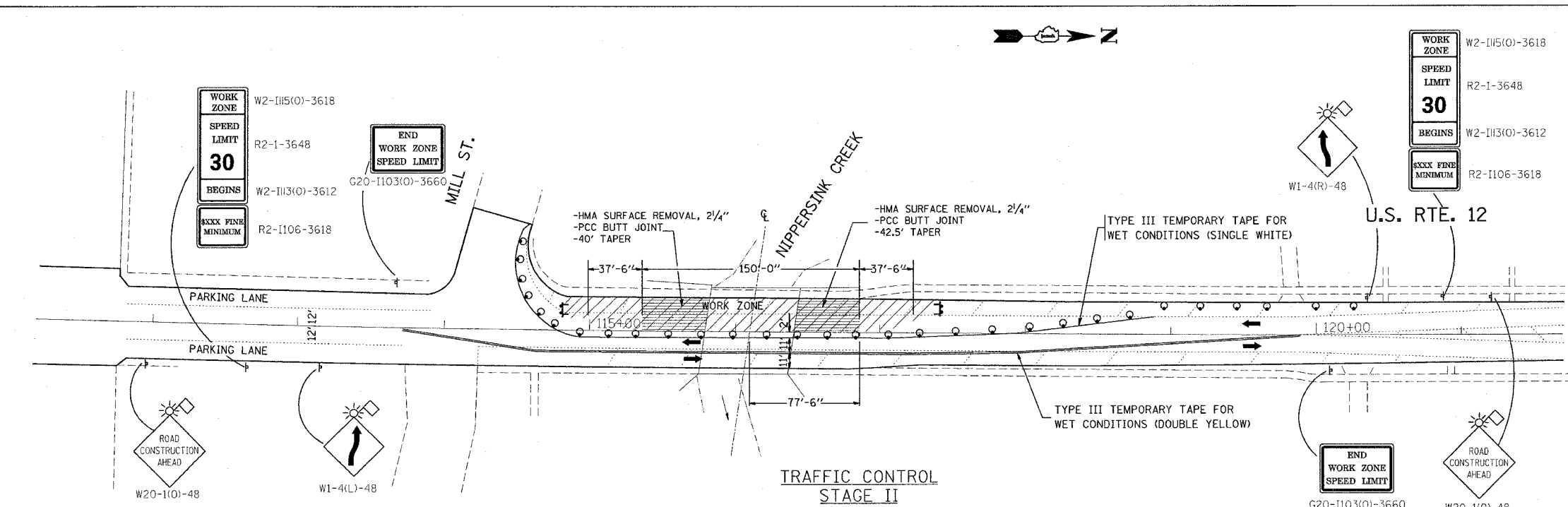

Type C monodirectional reflectors on tangent portion of barrier at 15 m (50') cts.

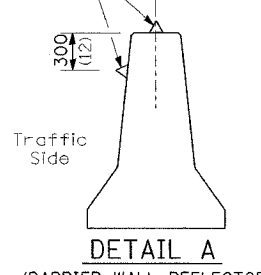

LEGEND

- Sign
- Type C Monodirectional reflector
- Impact attenuator
- Type III Barricade
- HMA Surface Removal (Variable Depth)
- Drums with steady burn monodirectional light
- 50' C-C TANGENTS
- 25' C-C LANE SHIFTS & TAPERS
- 10' C-C RADII (TYP)

REVISIONS	
NAME	DATE

ILLINOIS DEPARTMENT OF TRANSPORTATION

**TRAFFIC CONTROL
NIPPERSINK BRIDGE**

SCALE: VERT. _____
HORIZ. _____

DATE _____

DRAWN BY _____
CHECKED BY _____

PLOT DATE = 5/14/2007
FILE NAME = \\s114899\pl14899\m32
PLOT SCALE = 42.750000' / IN.
USER NAME = mdyjls