

| F.A.P. RTE. | SECTION | COUNTY | TOTAL SHEETS | SHEET NO. |
|---------------------|----------|-------------------|------------------|-----------|
| 335 | 119R-2 | LAKE | 439 | 63 |
| STA. 432+83.12 | | TO STA. 470+56.84 | | |
| FED. ROAD DIST. NO. | ILLINOIS | | FED. AID PROJECT | |

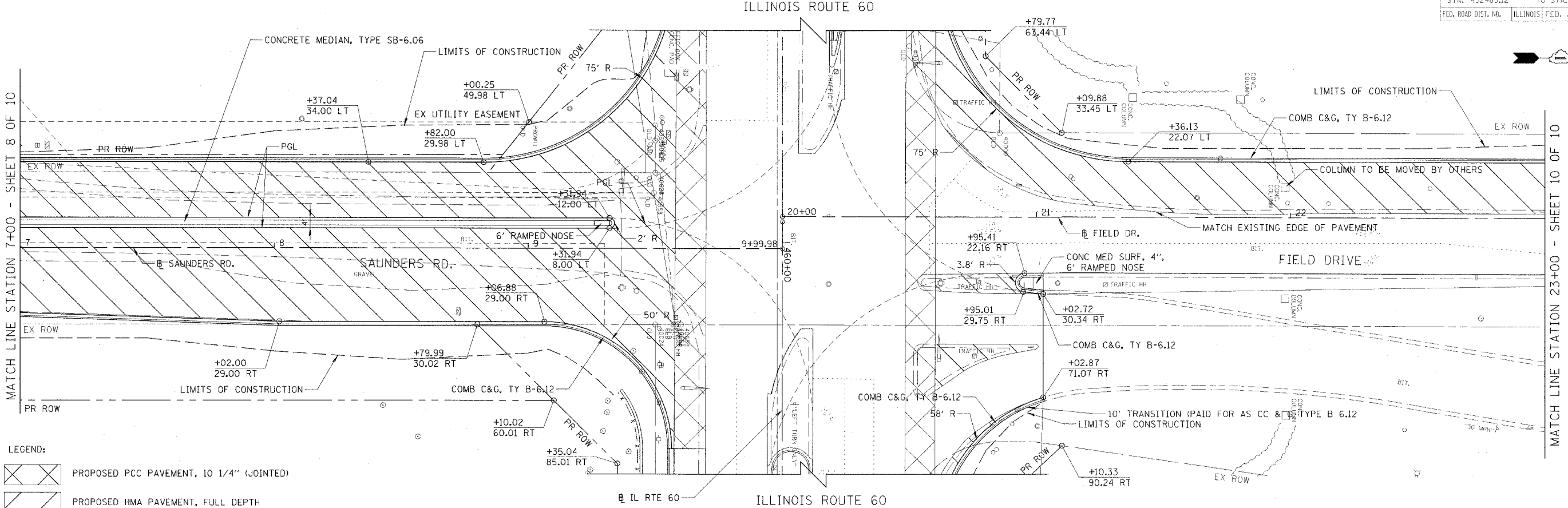

- LEGEND:
- PROPOSED PCC PAVEMENT, 10 1/4" (JOINTED)
 - PROPOSED HMA PAVEMENT, FULL DEPTH (PAID AS HMA SURFACE & BINDER COURSES - SEE PROPOSED TYPICAL SECTION SHEET 5 OF 5)

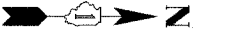
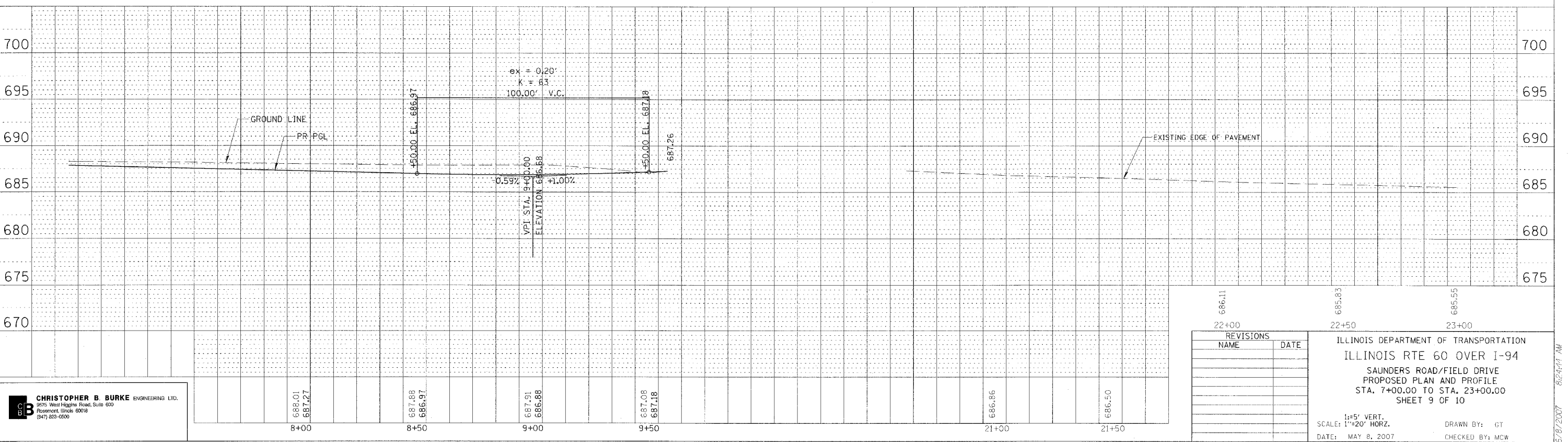

| PLAN | DATE |
|--------------------|------|
| REVISIONS | |
| BY | |
| CHECKED | |
| DATE | |
| NO. OF WAY CHECKED | |
| ADD FILE NAME | |

| PROFILE | DATE |
|--------------------|------|
| REVISIONS | |
| BY | |
| CHECKED | |
| DATE | |
| NO. OF WAY CHECKED | |
| ADD FILE NAME | |

CHRISTOPHER B. BURKE ENGINEERING LTD.
 875 West Higgins Road, Suite 600
 Rosemont, Illinois 60018
 (847) 823-0500

| REVISIONS | |
|-----------|------|
| NAME | DATE |
| | |
| | |
| | |
| | |
| | |
| | |
| | |
| | |

ILLINOIS DEPARTMENT OF TRANSPORTATION
 ILLINOIS RTE 60 OVER I-94
 SAUNDERS ROAD/FIELD DRIVE
 PROPOSED PLAN AND PROFILE
 STA. 7+00.00 TO STA. 23+00.00
 SHEET 9 OF 10

1"=5' VERT.
 SCALE: 1"=20' HORZ.
 DATE: MAY 8, 2007

DRAWN BY: GT
 CHECKED BY: MCW

REVISED 9/15/03 BY C.W.F./03/02 SAUNDERS

8/18/2007 8:24:11 AM