

F.A.P. RTE.	SECTION	COUNTY	TOTAL SHEETS	SHEET NO.
335	119R-2	LAKE	439	109
STA. 432+83.12		TO STA. 470+56.84		
FED. ROAD DIST. NO.	ILLINOIS	FED. AID PROJECT		

60B01

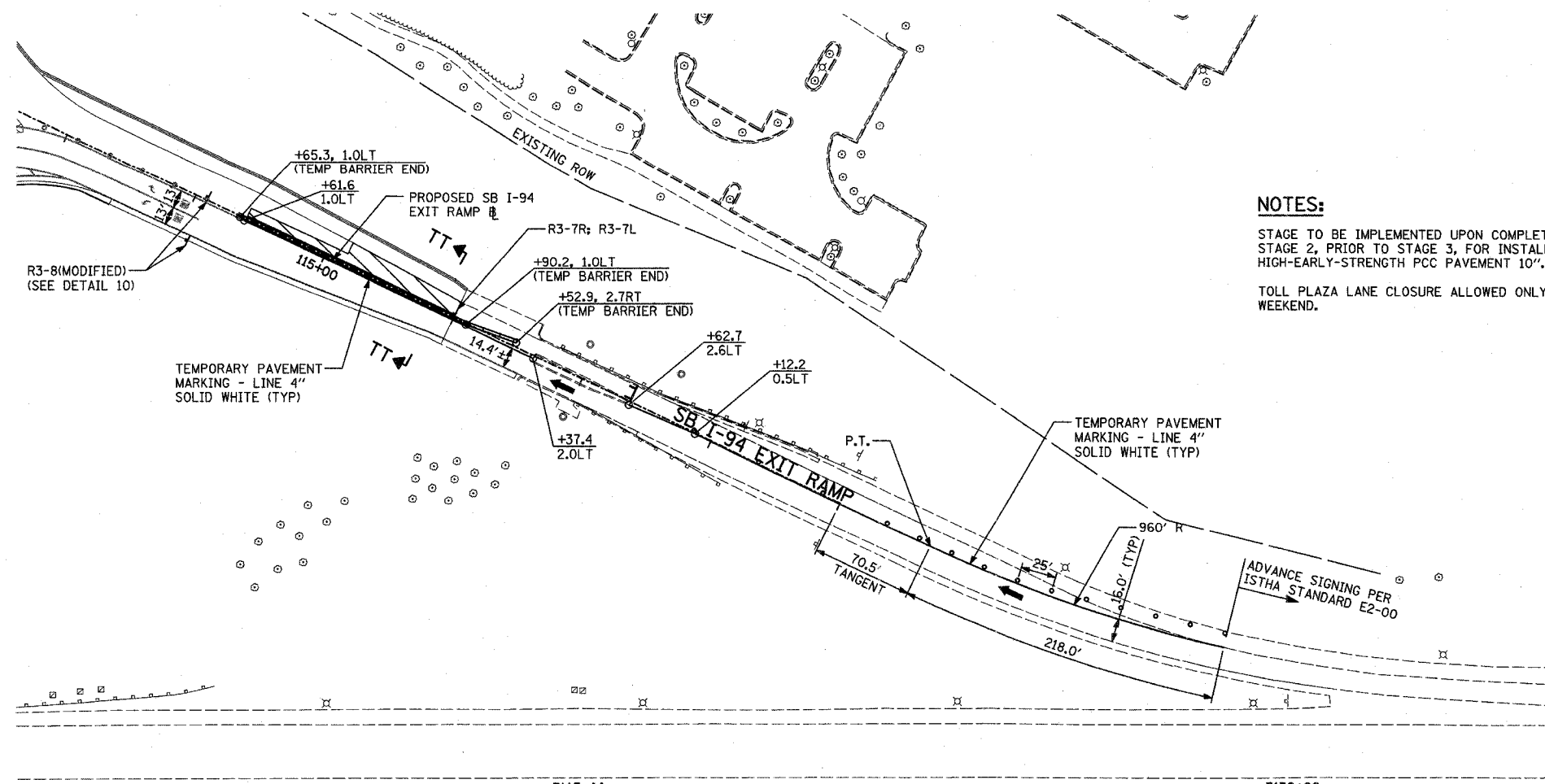

NOTES:

STAGE TO BE IMPLEMENTED UPON COMPLETION OF STAGE 2, PRIOR TO STAGE 3, FOR INSTALLATION OF HIGH-EARLY-STRENGTH PCC PAVEMENT 10\"/>

TOLL PLAZA LANE CLOSURE ALLOWED ONLY ON WEEKEND.

LEGEND:

- CONSTRUCTION ZONE
- TEMPORARY PAVEMENT
- TRAFFIC MOVEMENT
- TEMPORARY SIGN (SEE M.O.T. SIGNING LEGEND)
- TYPE II BARRICADES OR DRUMS W/ MONO-DIRECTIONAL STEADY BURNING LIGHT
- TYPE III BARRICADE W/2 FLASHING BIDIRECTIONAL LIGHTS
- TEMPORARY CONCRETE BARRIER
- ARROW BOARD
- M.O.T. APPURTENANCES REMAINING FROM PREVIOUS STAGES

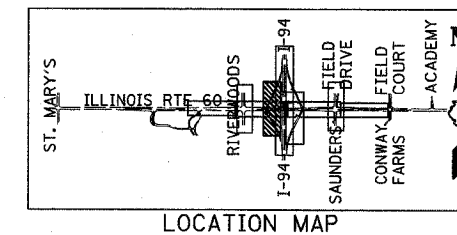
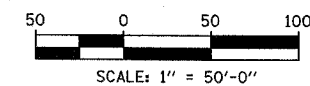

LOCATION MAP

REVISIONS	
NAME	DATE

ILLINOIS DEPARTMENT OF TRANSPORTATION
ILLINOIS RTE 60 OVER I-94
 MAINTENANCE OF TRAFFIC PLAN
 SOUTHBOUND INTERSTATE 94 EXIT RAMP
 STAGE 2 SUB-STAGE - SHEET 1 OF 1

SCALE: 1"=50'-0"
 DATE: MAY 8, 2007
 DRAWN BY: MPG, CBS
 CHECKED BY: JDF

TYLIN INTERNATIONAL

05/02/2007 10:28:53 AM P:\50245811-60\road\60mofesub_s101.dgn