

F.A.P. RTE.	SECTION	COUNTY	TOTAL SHEETS	SHEET NO.
335	119R-2	LAKE	439	178
STA. 432+83.12		TO STA. 470+56.84		
FED. ROAD DIST. NO.	ILLINOIS	FED. AID PROJECT		

60B01

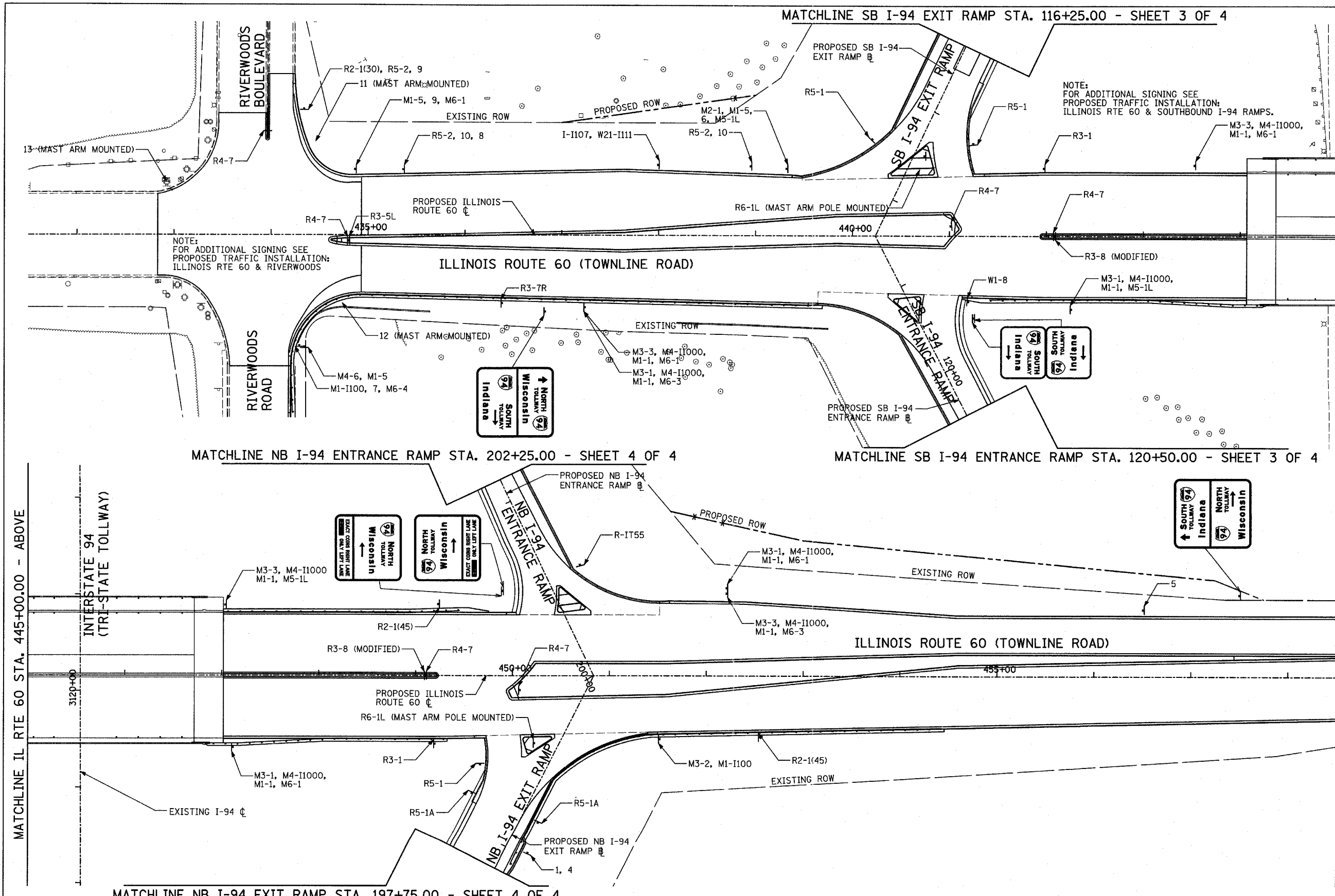

SIGNING LEGEND:

- EXISTING GROUND MOUNTED SIGN
- PROPOSED GROUND MOUNTED SIGN
- R1-1 — SEE PROPOSED SIGNING LEGEND AND SCHEDULE
- PROPOSED LARGE SIGN PANEL (SEE SIGN PANEL DETAILS AND SCHEDULE)

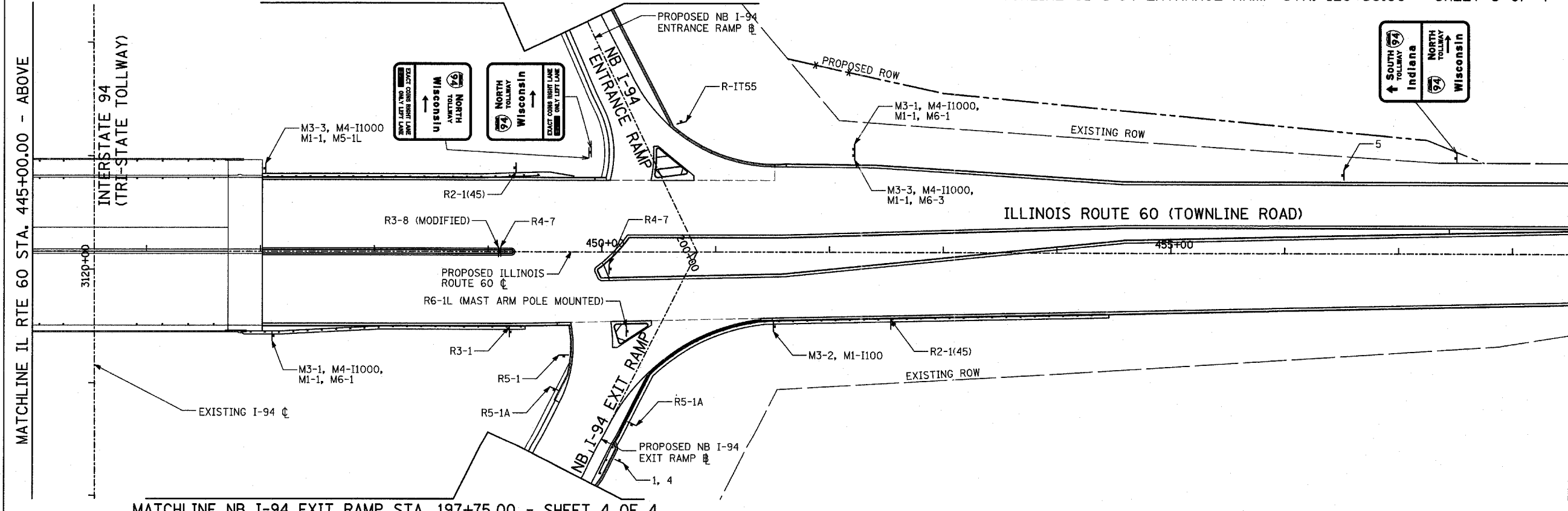
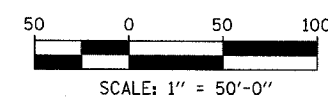
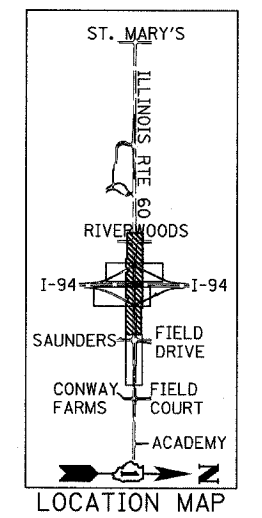
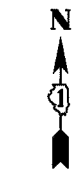

MATCHLINE IL RTE 60 STA. 445+00.00 - ABOVE

MATCHLINE IL RTE 60 STA. 458+50.00 - SHEET 2 OF 4

MATCHLINE IL RTE 60 STA. 445+00.00 - BELOW

MATCHLINE NB I-94 ENTRANCE RAMP STA. 202+25.00 - SHEET 4 OF 4

MATCHLINE SB I-94 ENTRANCE RAMP STA. 120+50.00 - SHEET 3 OF 4

MATCHLINE NB I-94 EXIT RAMP STA. 197+75.00 - SHEET 4 OF 4

TYLIN INTERNATIONAL

REVISIONS	
NAME	DATE

ILLINOIS DEPARTMENT OF TRANSPORTATION
ILLINOIS RTE 60 OVER I-94
 PROPOSED SIGNING PLAN
 IL RTE 60 STA. 432+83.12 TO 458+50.00
 SHEET 1 OF 4

SCALE: 1"=50'-0"
 DATE: MAY 8, 2007

DRAWN BY: AMB
 CHECKED BY: MPG