

F.A.P. RTE.	SECTION	COUNTY	TOTAL SHEETS	SHEET NO.
335	119R-2	LAKE	439	373
STA. 432+83.12		TO STA. 470+56.84		
FED. ROAD DIST. NO.		ILLINOIS FED. AID PROJECT		60B01

NOTE: PRE-STAGE EARTHWORK ADDITIONS/SUBTRACTIONS ARE NOT INCLUDED IN THE EARTHWORK QUANTITIES FOR EACH CROSS SECTION (SEE EARTHWORK SCHEDULE FOR BREAKDOWN OF QUANTITIES BY STAGE).

EARTHWORK QUANTITIES (SF)	
EXCAVATION	= 58.7
UNSUITABLE	= 147.8
EMBANKMENT	= 1367.6
EXC.(SPECIAL)	= 117.8

EARTHWORK QUANTITIES (SF)	
EXCAVATION	= 62.8
UNSUITABLE	= 136.4
EMBANKMENT	= 1216.8
EXC.(SPECIAL)	= 55.3

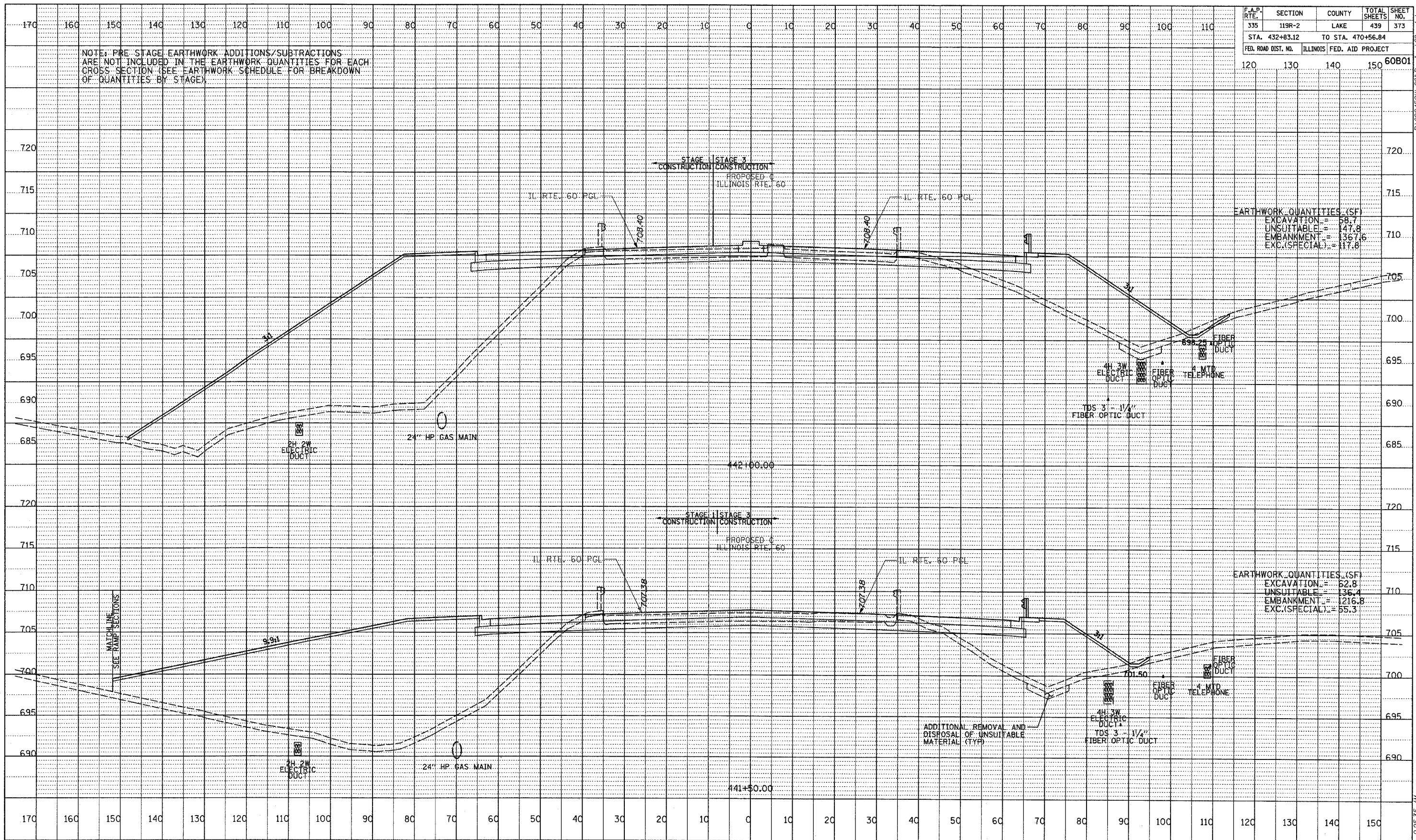

DATE	BY	REVISION
		1. APPROVED
		2. CHECKED
		3. STRUCK
		4. NOTATION
		5. OTHER

TYLIN INTERNATIONAL

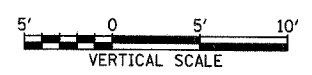
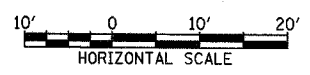

ILLINOIS RTE. 60 (TOWNLINE RD)
STA. 441+50 TO STA. 442+00

5/7/2007 9:25:35 AM