

PROFILE	SURVEYED	BY	DATE
NOTE BOOK	GRADES CHECKED		
NO.	STRUCTURE NOTATION	CHRG	

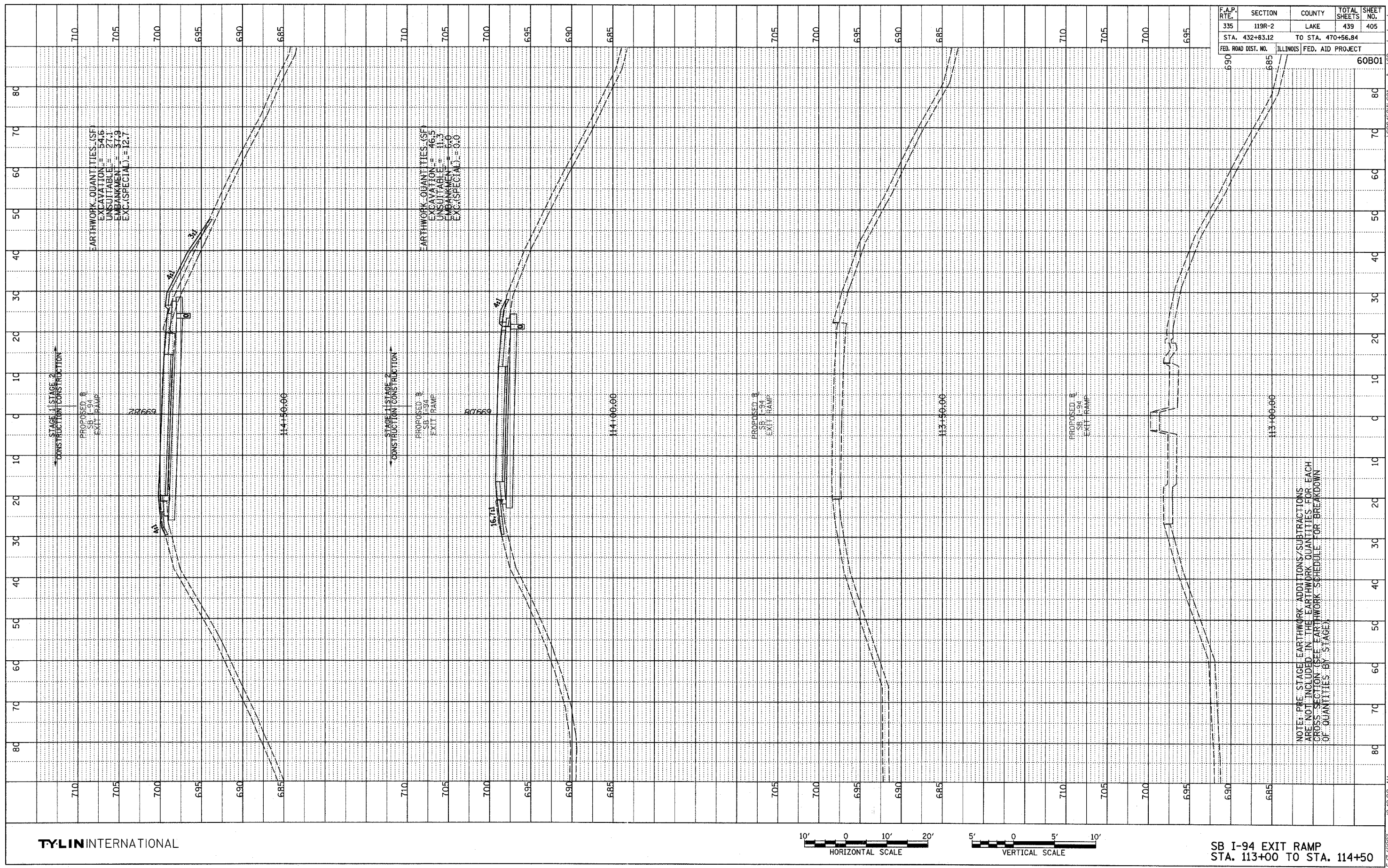

F.A.P. RTE.	SECTION	COUNTY	TOTAL SHEETS	SHEET NO.
335	119R-2	LAKE	439	405
STA. 432+83.12		TO STA. 470+56.84		
FED. ROAD DIST. NO.	ILLINOIS	FED. AID PROJECT	60B01	

TYLINT INTERNATIONAL

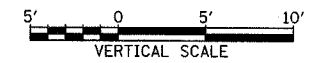
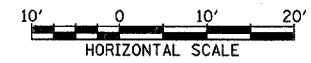

SB I-94 EXIT RAMP
STA. 113+00 TO STA. 114+50

5/7/2007 10:40:22 AM p:\62458\11401\road\gk60\ssst_sbx.dgn