

PROFILE REVISIONS
 NO. _____ DATE _____
 BY _____
 NOTE BOOK PLANNED _____
 NO. _____ GRADES CHECKED _____
 STRUCTURE NOTATIONS CHECKED _____

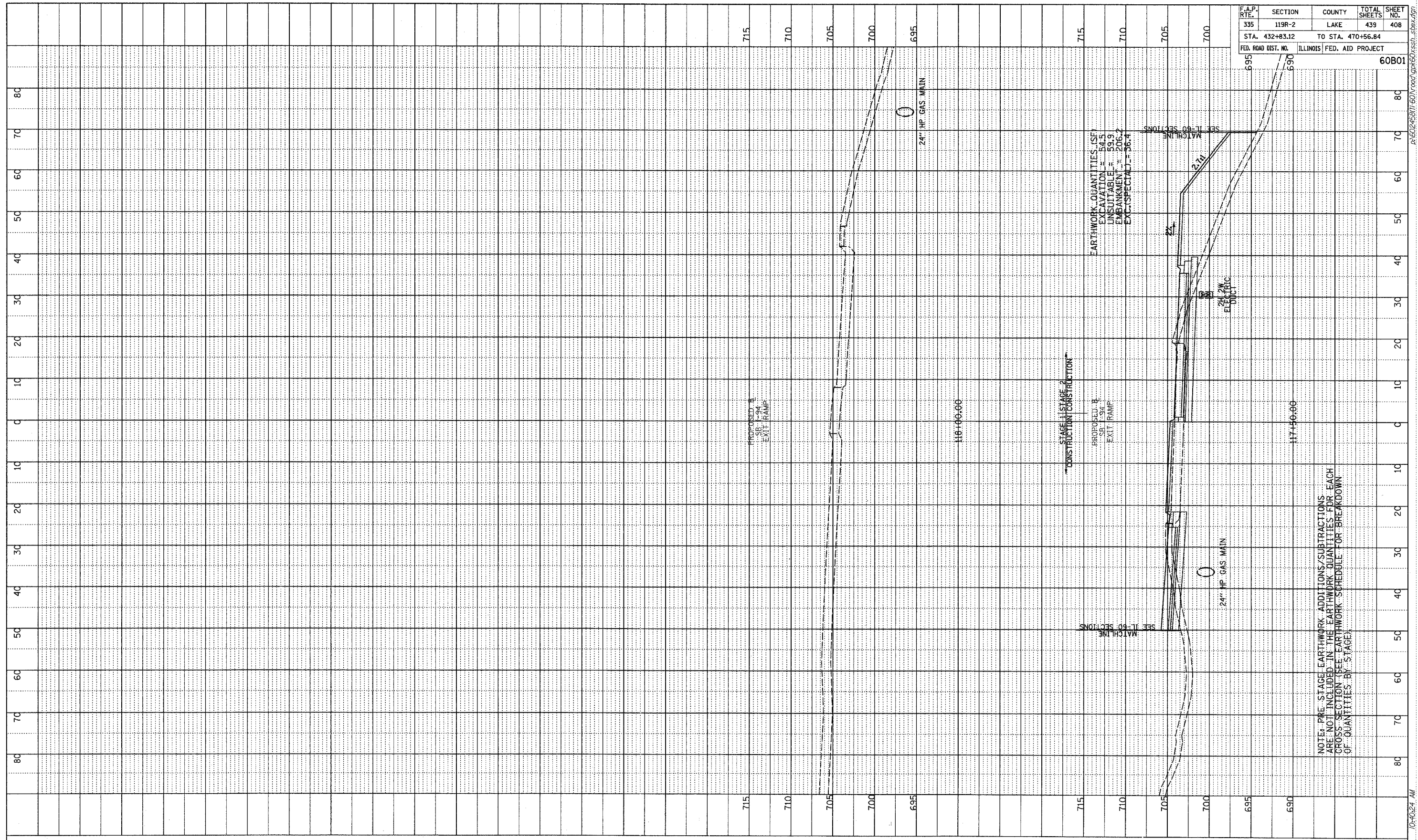

F.A.P. RTE.	SECTION	COUNTY	TOTAL SHEETS	SHEET NO.
335	119R-2	LAKE	439	408
STA. 432+83.12		TO STA. 470+56.84		
FED. ROAD DIST. NO.	ILLINOIS FED. AID PROJECT			60B01

TYLIN INTERNATIONAL

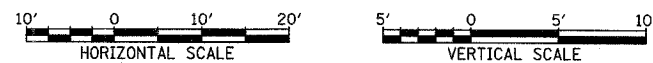

SB I-94 EXIT RAMP
 STA. 117+50 TO STA. 118+00

A:\602458171-601\road\gpk60\ssht_sbx.dgn
 10-10-24 AM
 5/7/2007