

PROFILE	DESIGNED	BY	DATE
NOTE BOOK	PLOTTED		
NO.	CHECKED		
	STRUCTURE NOTATION	CRD	

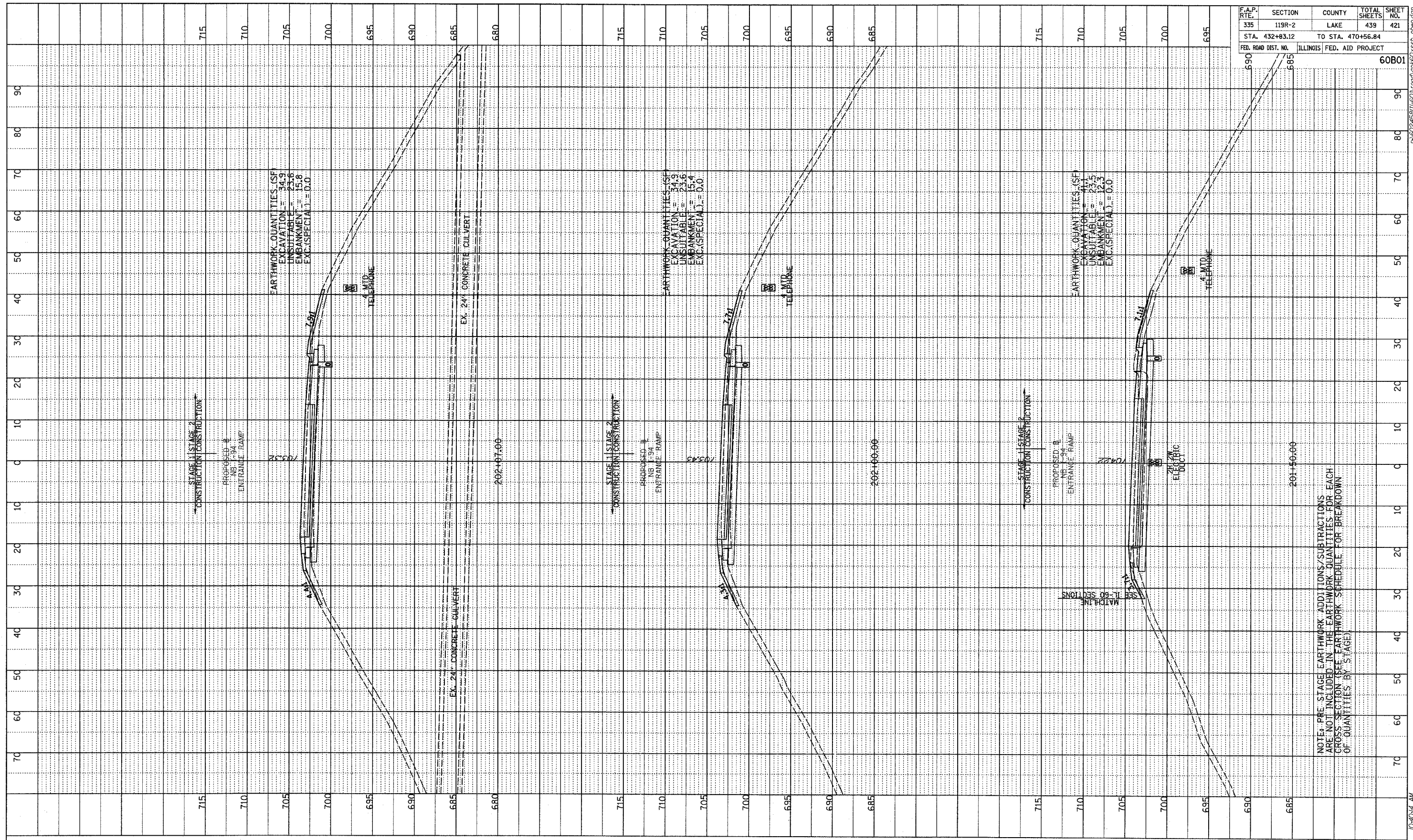

F.A.P. RTE.	SECTION	COUNTY	TOTAL SHEETS	SHEET NO.
335	119R-2	LAKE	439	421
STA. 432+83.12		TO STA. 470+56.84		
FED. ROAD DIST. NO.	ILLINOIS FED. AID PROJECT			60B01

NOTE: PRE-STAGE EARTHWORK ADDITIONS/SUBTRACTIONS ARE NOT INCLUDED IN THE EARTHWORK QUANTITIES FOR EACH CROSS SECTION (SEE EARTHWORK SCHEDULE FOR BREAKDOWN OF QUANTITIES BY STAGE)

TYLINT INTERNATIONAL

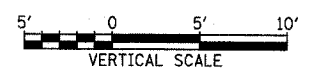
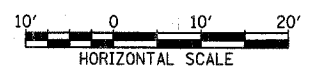

NB I-94 ENTRANCE RAMP
STA. 201+50 TO STA. 202+07

10-4044 AM 5/7/2007