

STATE OF ILLINOIS  
DEPARTMENT OF TRANSPORTATION

ROUTE NO.	SECTION	COUNTY	TOTAL SHEETS	SHEET
F.A.I. 94	2006-043 RS	COOK	135	113
FED. ROAD DIST. NO. 7	ILLINOIS	FED. AID PROJECT-		

Contract # 62747

B.M. - Engineer to set temporary benchmark in field as necessary.

Existing Structure - Structure No. 016-0106, built as S.A. Edens Superhighway, Section 263-0202.1-15D at Station 19+28.67 in 1949. The structure was rehabilitated and widened in 1979 as FAI Route 94 (Edens Expressway), Section 1975-118-R & BR. The existing structure consists of a simple span with vaulted, sand filled approach spans. The main span of the existing structure is a composite reinforced concrete deck supported by 36" PPC I-Beams. The sand filled vaulted approaches consist of 16" reinforced concrete slabs supported by the abutment, a pile supported intermediate bent and a pile supported end bent. The substructure consists of reinforced concrete full height abutments supported on pile foundations.

Stage construction shall be utilized to maintain traffic during construction.

No Salvage

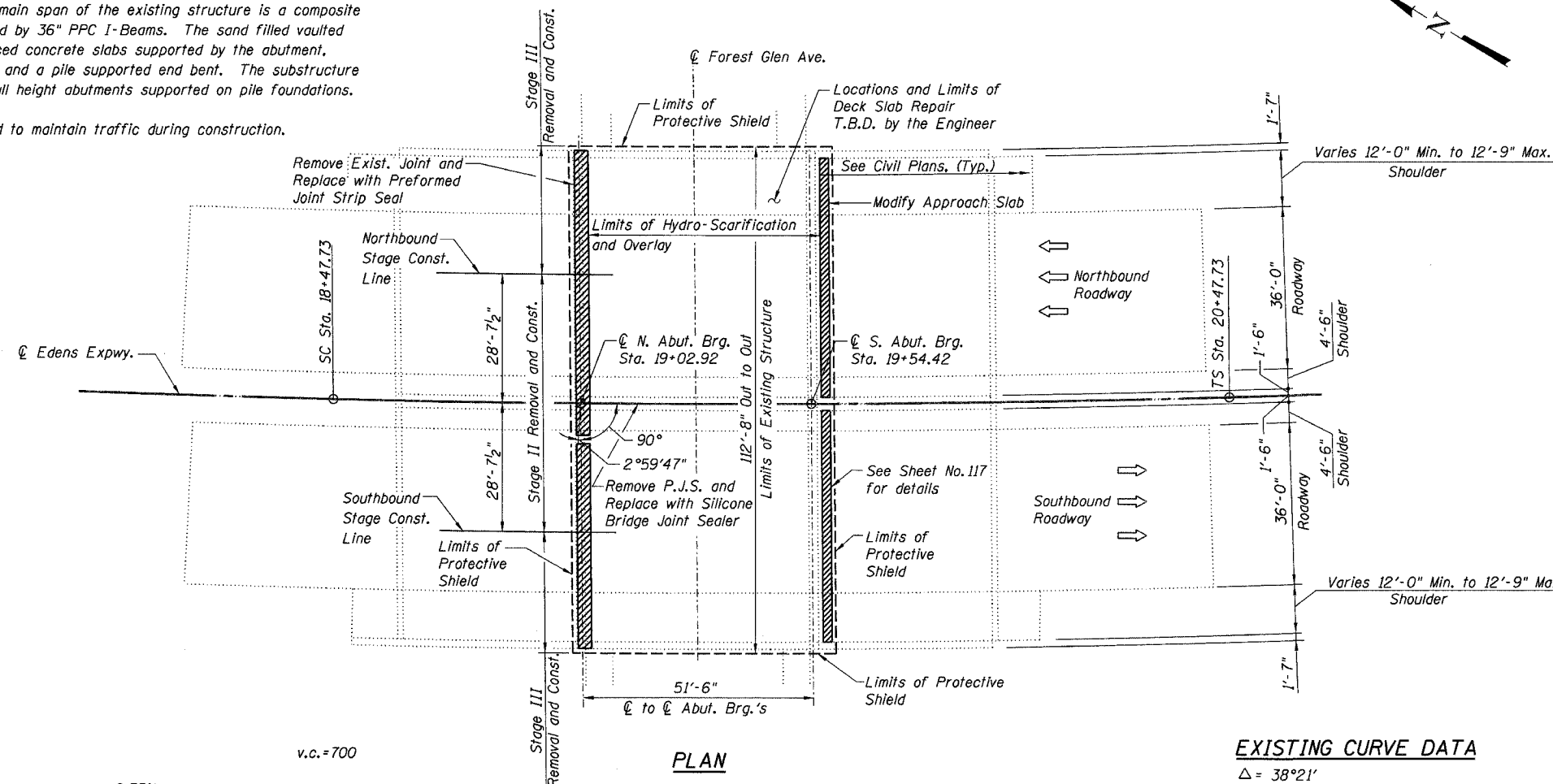

PLAN

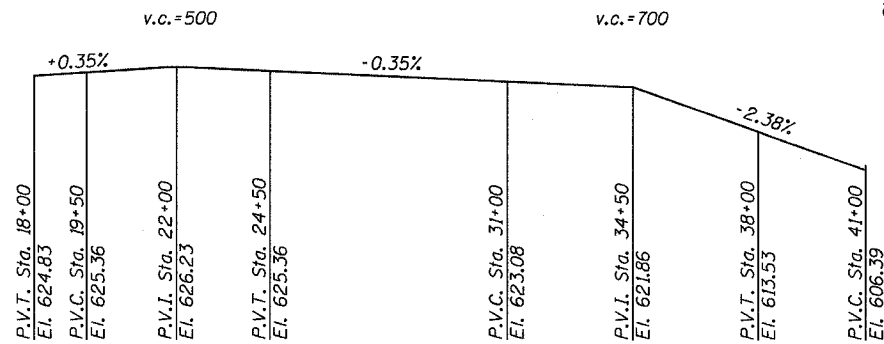

EXISTING PROFILE GRADE  
EDENS EXPRESSWAY

EXISTING CURVE DATA

$\Delta = 38^{\circ}21'$   
 $D = 3^{\circ}$   
 $T = 764.52'$   
 $L_s = 200.0'$   
 $E_s = 113.12'$   
 $R = 1910.08'$   
 $L_c = 1078.33'$   
 $P.I. = Sta. 13+33.92$

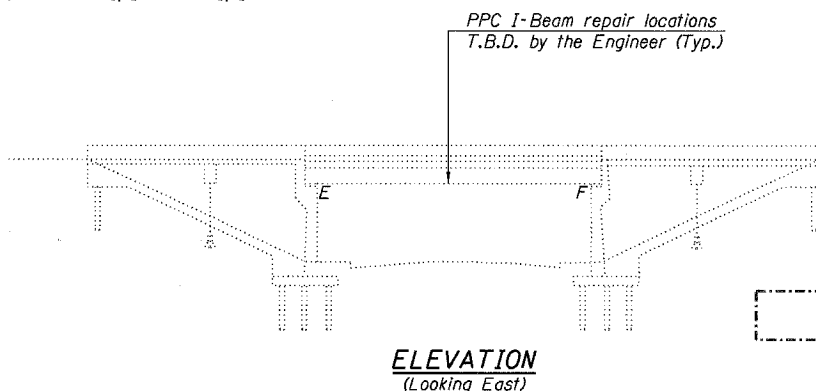

ELEVATION  
(Looking East)

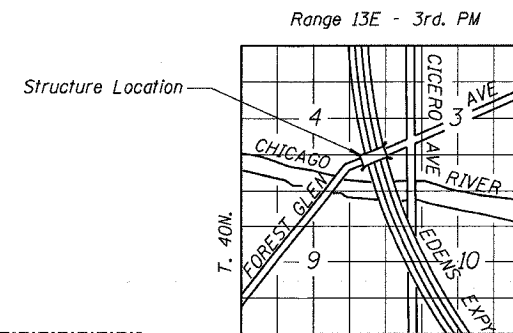

LOCATION SKETCH

DESIGN SPECIFICATIONS

2002 AASHTO

DESIGN STRESSES

FIELD UNITS

$f'_c = 3,500$  psi  
 $f_y = 60,000$  psi (reinforcement)

SCOPE OF WORK

1. Provide Protective Shield with limits as indicated.
2. [Redacted]
3. Close Stage II construction areas to traffic.
4. Hydro-Scarify the deck slab.
5. Remove and replace expansion joint and surrounding concrete (including parapets); Remove and replace concrete at fixed joint.
6. Perform deck slab repair.
7. Place Overlay.
8. Place temporary roadway transitions.
9. Open Stage II Removal area to staged traffic.
10. Close Stage III Removal areas to traffic.
11. Repeat steps 4-8 but for Stage III construction.
12. Open bridge to traffic.

NOTES

1. For joint removal and replacement plans and details, see Sheet No. 116 thru 117b
2. See Structural Notes on Sheet No. 113a

LEGEND

- Protective Shield Limits
- Concrete Removal / Joint Reconstruction



GENERAL PLAN & ELEVATION  
 F.A.I. 94/ (EDENS EXPRESSWAY)  
 OVER FOREST GLEN  
 COOK COUNTY  
 STATION 19+28.67  
 STRUCTURE NO. 016-0106

Revised 07/13/2007

T:\2299\struct\dgn\0106GPE00.dgn

DESIGNED -	DWH
CHECKED -	JSD
DRAWN -	EF
CHECKED -	JSD

**LOCHNER**  
 H.W. LOCHNER, INC., CHICAGO, ILLINOIS