

| F.A.I. RTE. | SECTION | COUNTY | TOTAL SHEETS | SHEET NO. |
|-----------------------|-------------|----------------|------------------|-----------|
| 94 | 2006-043 RS | COOK | 135 | 56 |
| STA. 200+00 | | TO STA. 212+00 | | |
| FED. ROAD DIST. NO. 7 | | ILLINOIS | FED. AID PROJECT | |

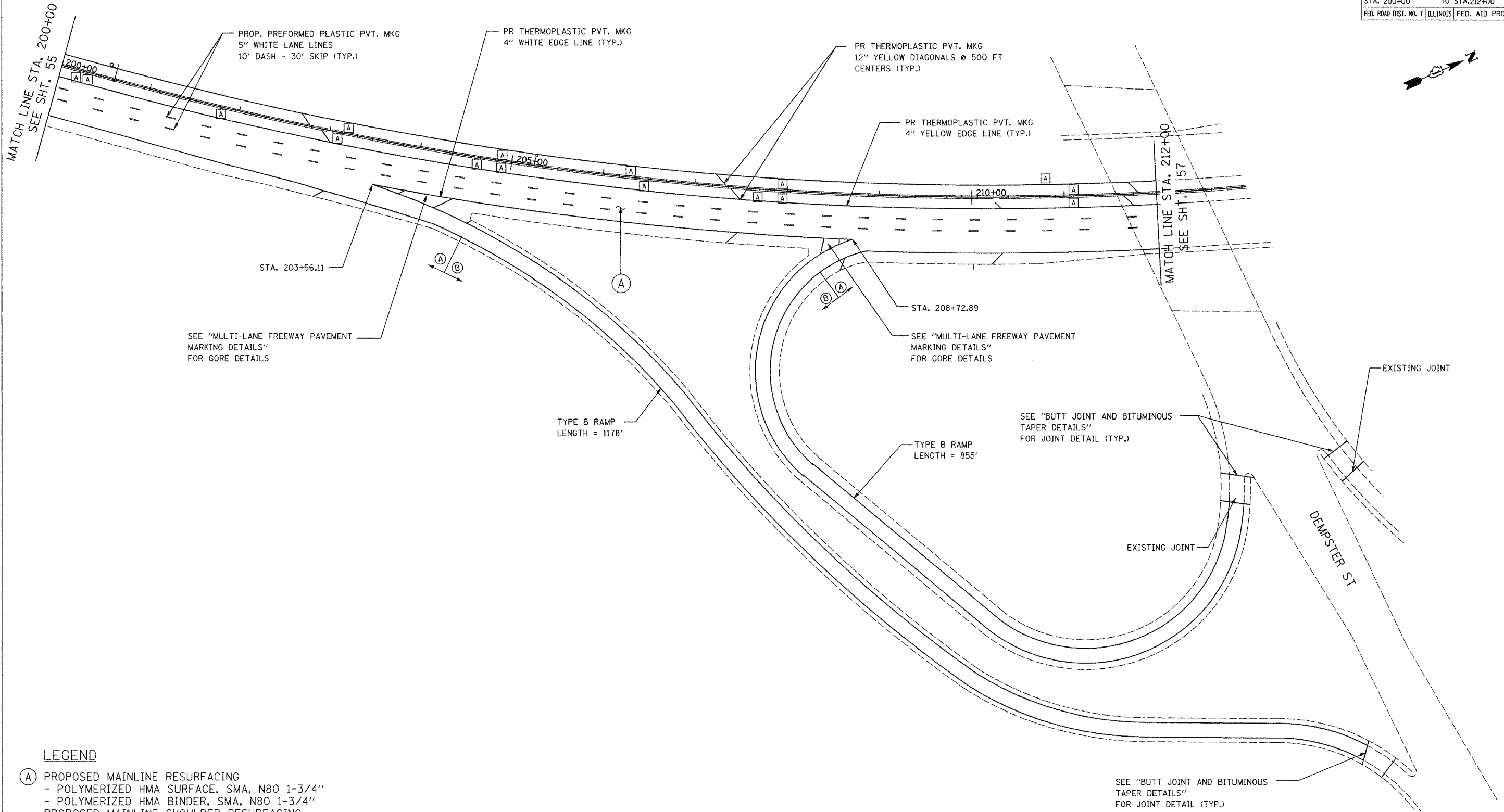

LEGEND

- (A) PROPOSED MAINLINE RESURFACING
 - POLYMERIZED HMA SURFACE, SMA, N80 1-3/4"
 - POLYMERIZED HMA BINDER, SMA, N80 1-3/4"
- PROPOSED MAINLINE SHOULDER RESURFACING
 - HMA SURFACE, MIX D, N70 (IL 9.5 mm) 1-3/4"
 - HMA BINDER, IL-19, N70, VARIES 2-1/4" TO 2-3/4"
- (B) PROPOSED RAMP AND RAMP SHOULDER RESURFACING
 - HMA SURFACE, MIX D, N70 (IL 9.5mm) 1-3/4"
 - HMA BINDER, IL-19, N70, VARIES 2-1/4" TO 2-3/4"
- (A) FRAMES AND GRATES TO BE ADJUSTED

NOTE:
SEE SHEET 25 FOR SOUTHBOUND

NOTE:
SEE "MULTI-LANE FREEWAY PAVEMENT MARKING DETAILS" FOR PLACEMENT & TYPE OF RAISED REFLECTIVE PAVEMENT MARKERS (TYP.)

| REVISIONS | |
|-----------|------|
| NAME | DATE |
| | |
| | |
| | |
| | |
| | |
| | |
| | |
| | |
| | |
| | |

ILLINOIS DEPARTMENT OF TRANSPORTATION
 PROPOSED ROADWAY PLANS
 F.A.I. 94 (I-94)
 STA 200+00 TO STA 212+00 NB
 SCALE: DATE JAN 2007
 DRAWN BY: CHECKED BY:

PLOT DATE = 5/21/2007
 FILE NAME = WFL1E1
 PLOT SCALE = 1/4"=1'-0"
 USER NAME = 087047