

F.A.I. RTE.	SECTION	COUNTY	TOTAL SHEETS	SHEET NO.
94	2006-043 RS	COOK	135	65
STA. 290+00		TO STA. 300+00		
FED. ROAD DIST. NO. 7		ILLINOIS FED. AID PROJECT		

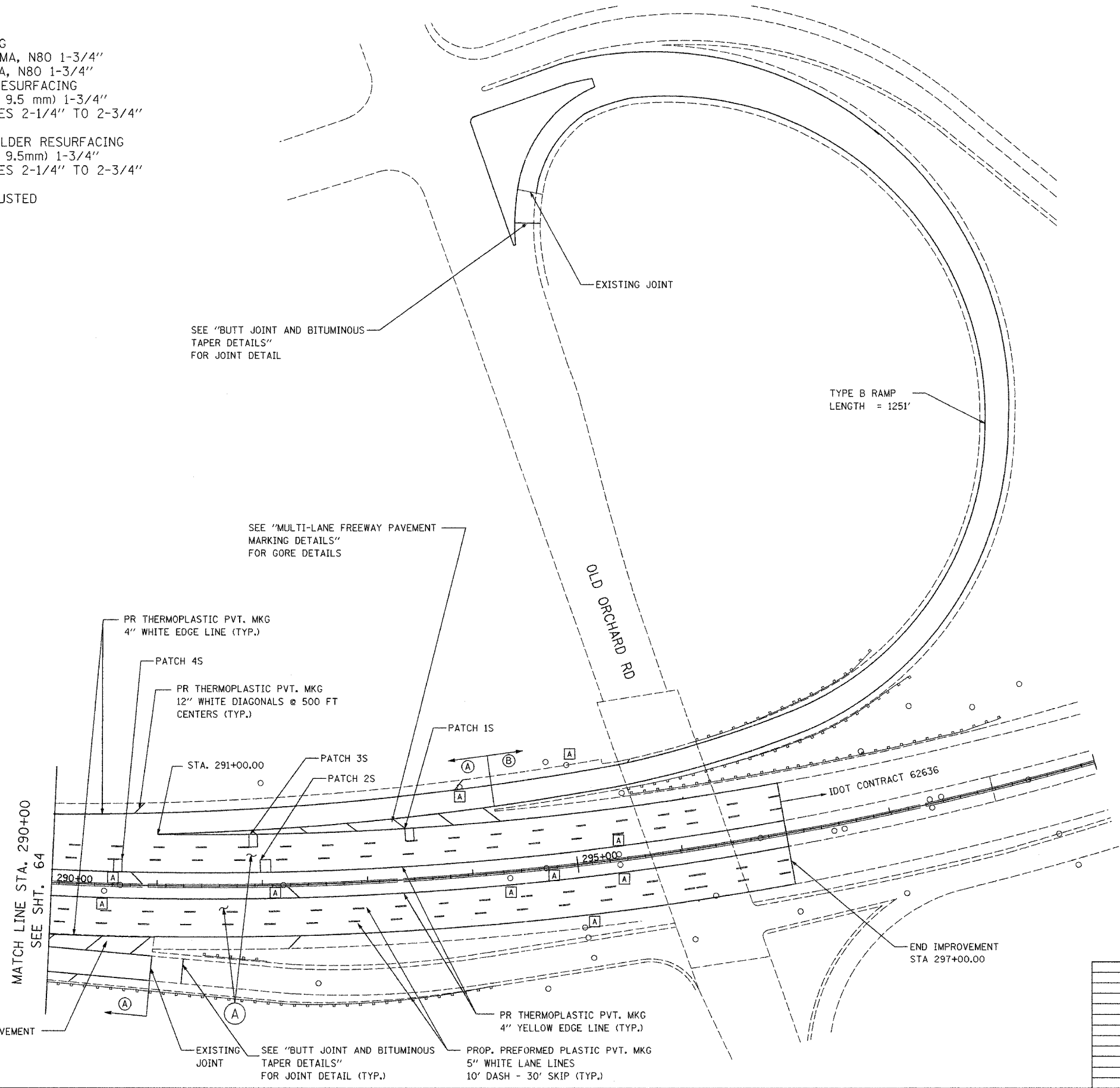

LEGEND

- (A) PROPOSED MAINLINE RESURFACING
 - POLYMERIZED HMA SURFACE, SMA, N80 1-3/4"
 - POLYMERIZED HMA BINDER, SMA, N80 1-3/4"
- PROPOSED MAINLINE SHOULDER RESURFACING
 - HMA SURFACE, MIX D, N70 (IL 9.5 mm) 1-3/4"
 - HMA BINDER, IL-19, N70, VARIES 2-1/4" TO 2-3/4"
- (B) PROPOSED RAMP AND RAMP SHOULDER RESURFACING
 - HMA SURFACE, MIX D, N70 (IL 9.5mm) 1-3/4"
 - HMA BINDER, IL-19, N70, VARIES 2-1/4" TO 2-3/4"
- (A) FRAMES AND GRATES TO BE ADJUSTED



SEE "BUTT JOINT AND BITUMINOUS TAPER DETAILS" FOR JOINT DETAIL

SEE "MULTI-LANE FREEWAY PAVEMENT MARKING DETAILS" FOR GORE DETAILS

PR THERMOPLASTIC PVT. MKG 4" WHITE EDGE LINE (TYP.)

PATCH 4S

PR THERMOPLASTIC PVT. MKG 12" WHITE DIAGONALS @ 500 FT CENTERS (TYP.)

PATCH 1S

STA. 291+00.00

PATCH 3S

PATCH 2S

MATCH LINE STA. 290+00
SEE SHT. 64

END IMPROVEMENT
STA 297+00.00

SEE "MULTI-LANE FREEWAY PAVEMENT MARKING DETAILS" FOR GORE DETAILS

EXISTING JOINT SEE "BUTT JOINT AND BITUMINOUS TAPER DETAILS" FOR JOINT DETAIL (TYP.)

PR THERMOPLASTIC PVT. MKG 4" YELLOW EDGE LINE (TYP.)

PROP. PREFORMED PLASTIC PVT. MKG 5" WHITE LANE LINES 10' DASH - 30' SKIP (TYP.)

NOTE:
SEE "MULTI-LANE FREEWAY PAVEMENT MARKING DETAILS" FOR PLACEMENT & TYPE OF RAISED REFLECTIVE PAVEMENT MARKERS

REVISIONS	
NAME	DATE

ILLINOIS DEPARTMENT OF TRANSPORTATION
PROPOSED ROADWAY PLANS
F.A.I. 94 (I-94)
STA 290+00 TO STA 300+00

SCALE: 1"=50'
DATE: JAN 2007

DRAWN BY
CHECKED BY

PLOT DATE = 5/21/2007
PLOT SCALE = 1"=50'
PLOT USER = 08/10/07