

CONTRACT NO. 62747			
F.A. RTE.	SECTION	COUNTY	TOTAL SHEET NO.
94	2006-043 RS	COOK	185 69
STA.		TO STA.	
FED. ROAD DIST. NO. 1 ILLINOIS FED. AID PROJECT			

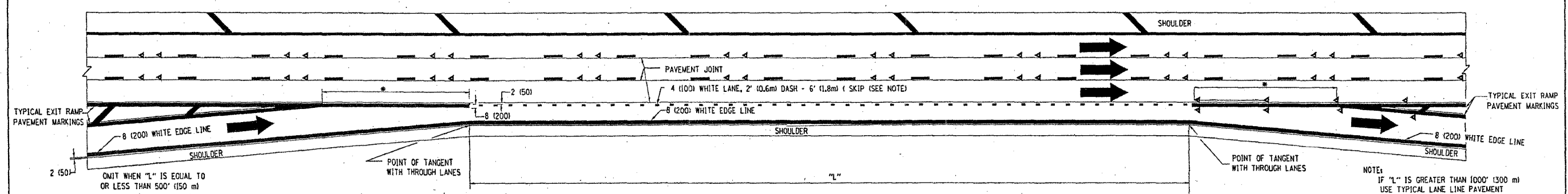

TYPICAL ENTRANCE/EXIT RAMP COMBINATION PAVEMENT MARKINGS

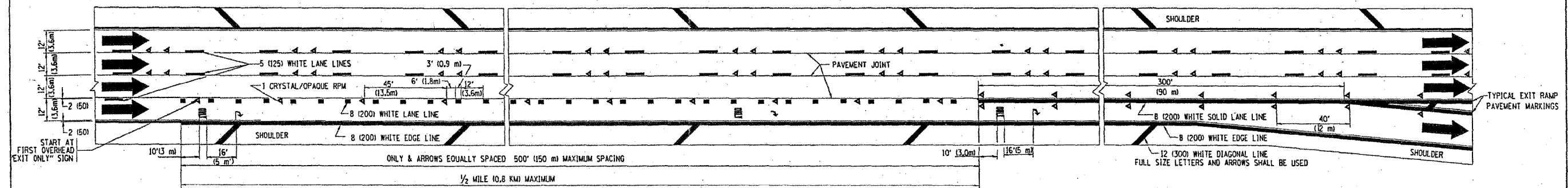

TYPICAL EXIT ONLY LANE PAVEMENT MARKINGS

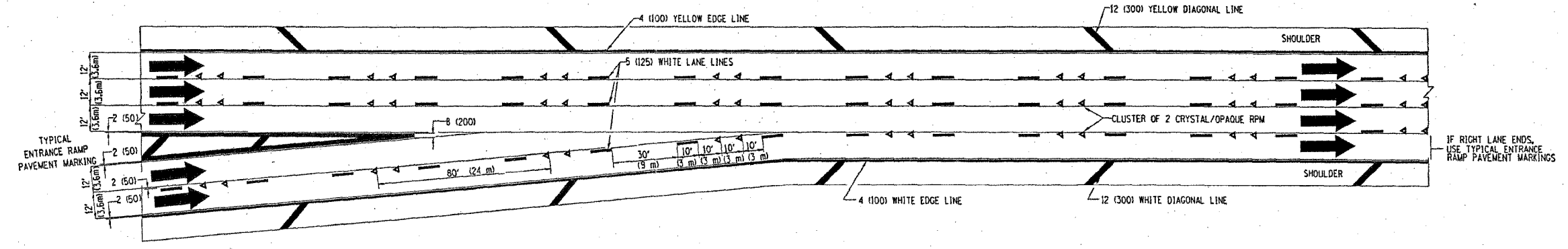

TYPICAL TWO LANE ENTRANCE RAMP PAVEMENT MARKINGS

PLOT DATE: 1/16/2007
 PLOT SCALE: 1/8" = 1'-0"
 USER NAME: jaygo

REVISIONS	
NAME	DATE
DWS	1/30
DWS	2/21
SPB	1/07

ILLINOIS DEPARTMENT OF TRANSPORTATION
 MULTI-LANE FREEWAY
 PAVEMENT MARKING
 DETAILS
 SCALE: NONE
 DATE: 1/16/2007
 DRAWN BY: C.A.D.D.
 CHECKED BY:
 TC12 SHEET 2 OF 2
 REVISION DATE: 01/01/07