

B.M. - Engineer to set temporary benchmark in field as necessary.

Existing Structure - Structure No. 016-0108, built as S.A. Edens Superhighway, Section 263-0101.1-15D at Station 29+14.49 in 1949. The structure was rehabilitated and widened in 1979 as FAI Route 94 (Edens Expressway), Section 1975-118-R & BR. The existing structure consists of a four span continuous steel multi-beam structure supporting a 7 1/2" reinforced concrete deck. The deck is composite with the steel beams in the end spans only. The steel beams consist of W36 rolled shapes. The original (1949) substructure consists of reinforced concrete pile bent abutments and reinforced concrete multi-column piers supported by concrete piles. The widened substructure (1979) utilizes drilled shafts to support the abutment extension and solid wall pier extensions supported by concrete piles.

Stage construction shall be utilized to maintain traffic during construction.

Salvage Existing Drainage Scupper Grates.

STATE OF ILLINOIS
DEPARTMENT OF TRANSPORTATION

ROUTE NO.	SECTION	COUNTY	SHEET	TOTAL
F.A.I. 94	2006-043 RS	COOK	135	123
FED. ROAD DIST. NO. 7		ILLINOIS	FED. AID PROJECT	

Contract # 62747

DESIGN SPECIFICATIONS
2002 AASHTO

DESIGN STRESSES

FIELD UNITS
f'c = 3,500 psi
fy = 60,000 psi (reinforcement)

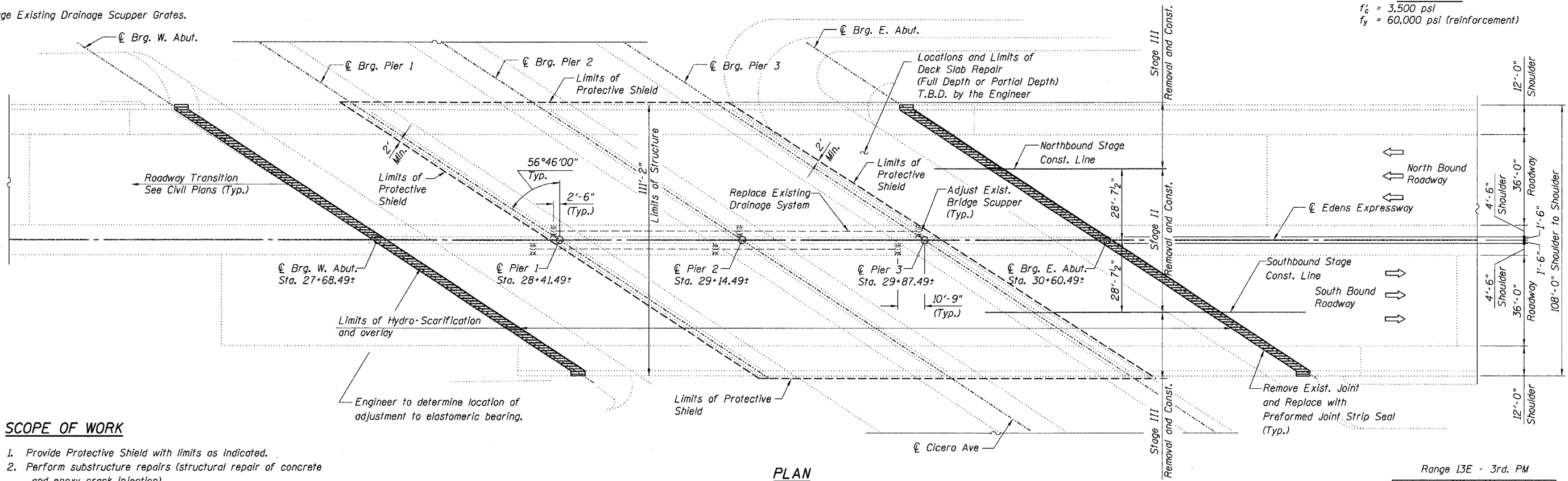

PLAN

SCOPE OF WORK

1. Provide Protective Shield with limits as indicated.
 2. Perform substructure repairs (structural repair of concrete and epoxy crack injection).
- Stage II:
3. Close Stage II construction areas to traffic.
 4. Hydro-Scarify the deck slab.
 5. Remove and replace expansion joints and surrounding concrete (including parapets).
 6. Perform deck slab repair.
 7. Adjust existing scuppers and install new grates; replace drainage system.
 8. Place Overlay.
 9. Place temporary roadway transitions.
 10. Open Stage II Construction area to staged traffic.
- Stage III:
11. Close Stage III Removal areas to traffic.
 12. Repeat steps 4-9 but for Stage III construction.
 13. Open bridge to traffic.

LEGEND

- Protective Shield Limits
- ▨ Concrete Removal / Joint Reconstruction

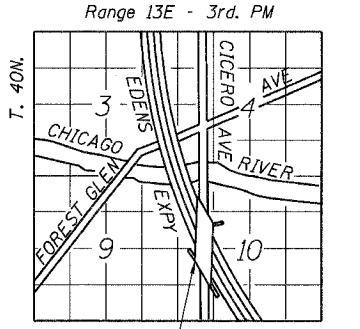

LOCATION SKETCH

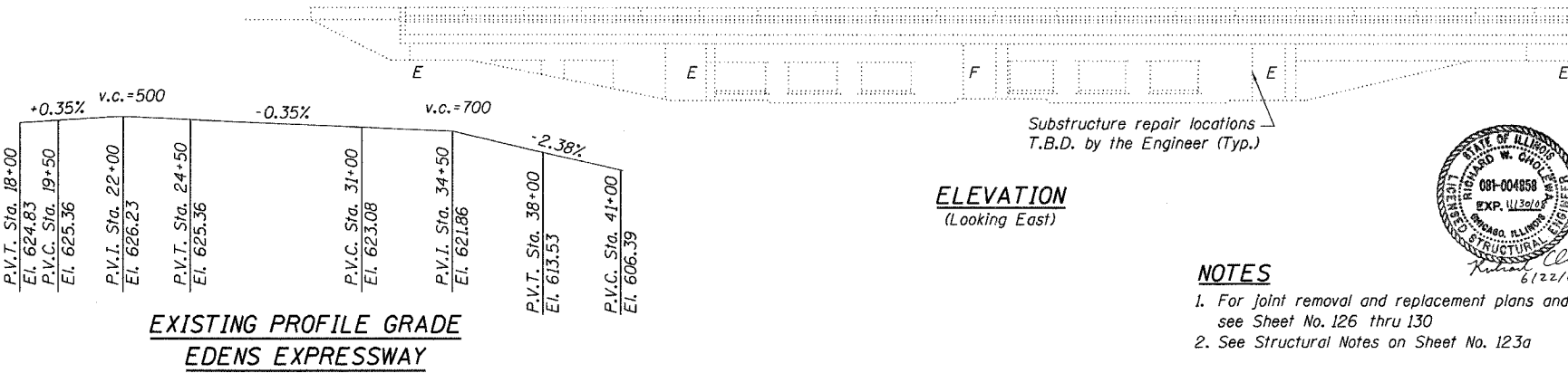

ELEVATION
(Looking East)

DESIGNED -	DWH
CHECKED -	JSD
DRAWN -	EF
CHECKED -	JSD

LOCHNER
H.W. LOCHNER, INC., CHICAGO, ILLINOIS

EXISTING PROFILE GRADE
EDENS EXPRESSWAY

NOTES

1. For joint removal and replacement plans and details, see Sheet No. 126 thru 130
2. See Structural Notes on Sheet No. 123a



GENERAL PLAN & ELEVATION
F.A.I. 94/ (EDENS EXPRESSWAY)
OVER CICERO AVE.
COOK COUNTY
STATION 29+14.49
STRUCTURE NO. 016-0108

T:\2298\struct\dgn\2108GPE00.dgn