

CONTRACT NO. 68469			
F.A.P. RTE.	SECTION	COUNTY	TOTAL SHEET NO.
317	146-1RS-7	PEORIA	62 23
STA.		TO STA.	
FED. ROAD DIST. NO.		ILLINOIS FED. AID PROJECT	

BENCHMARK #2
TOP OF ROW MARKER @
SW CORNER OF PERU ST.
ELEV. 470.57

STA. 58+07.92 FAP 317 (US 24) =
☉ ARGENTINA ST.

STA. 54+77.70 ☉ FAP 317 (US 24) =
☉ WEST PERU ST.

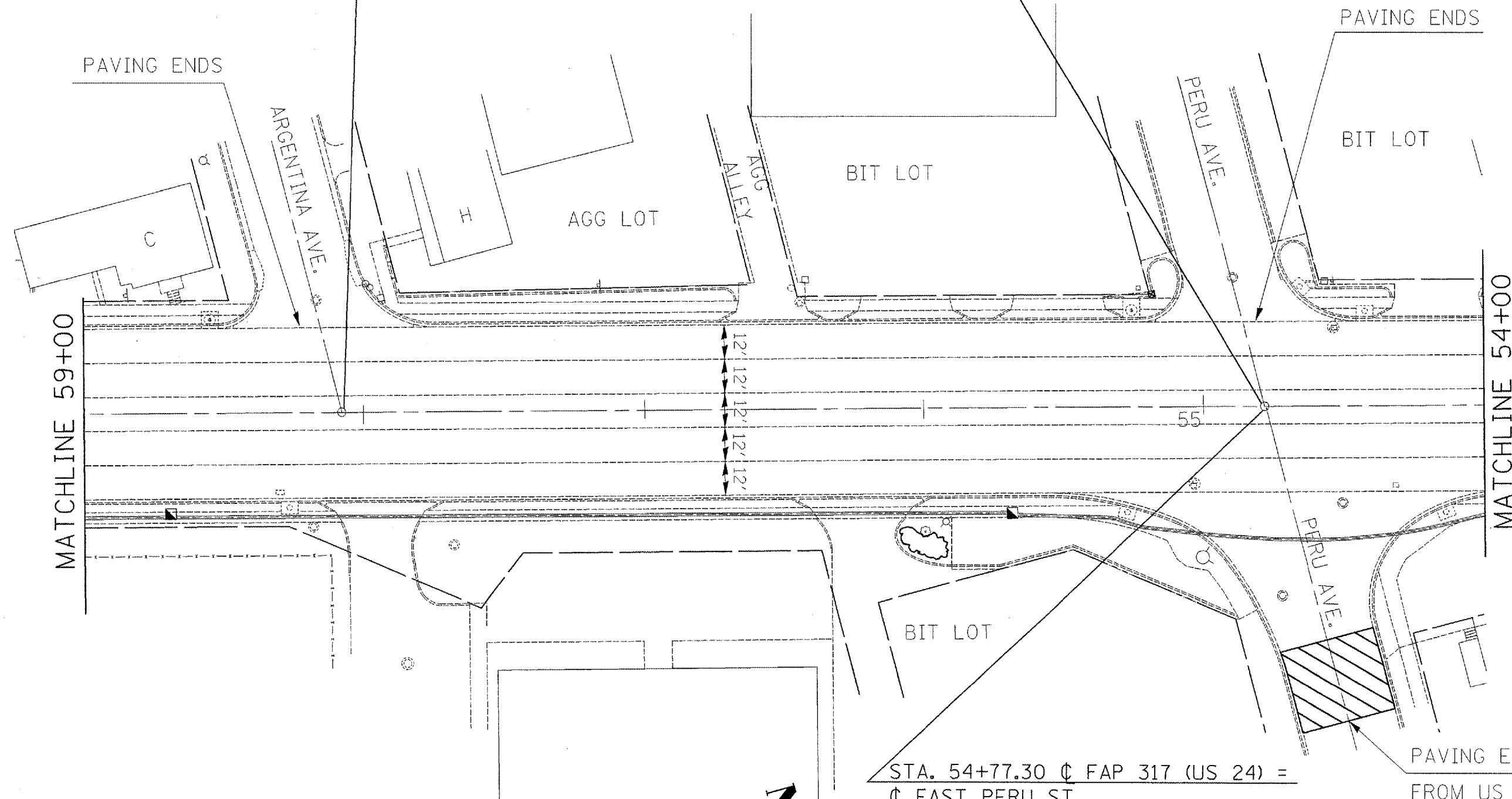

REMOVAL LEGEND

- BUTT JOINT
- CCC&G

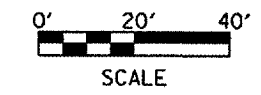
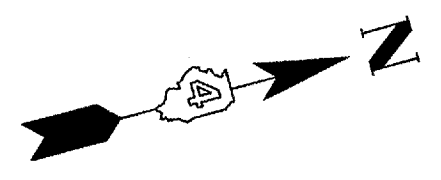

REVISIONS	
NAME	DATE

ILLINOIS DEPARTMENT OF TRANSPORTATION

EXISTING

PLAN SHEETS

STA 59+00 - 54+00

SCALE: VERT. _____
HORIZ. _____

DATE _____

DRAWN BY _____
CHECKED BY _____

PLOT DATE = 01/12/2007
 FILE NAME = c:\p\c\p\mst\us24bar\plan\mshass.dgn
 PLOT SCALE = 48.0000 / 1" = 40' / 1" (48:1)
 USER NAME = gbnoverp1

MATCHLINE 59+00

MATCHLINE 54+00

STA. 54+77.30 ☉ FAP 317 (US 24) =
☉ EAST PERU ST.

PAVING ENDS 114.5'
FROM US 24 ☉