

F.A.S. RTE.	SECTION	COUNTY	TOTAL SHEETS	SHEET NO.
1388	(ZC-120-BRI)	PEORIA	20	10
STA. 380+48.12 TO STA. 381+61.87				
FED. ROAD DIST. NO. 4 ILLINOIS FED. AID PROJECT				

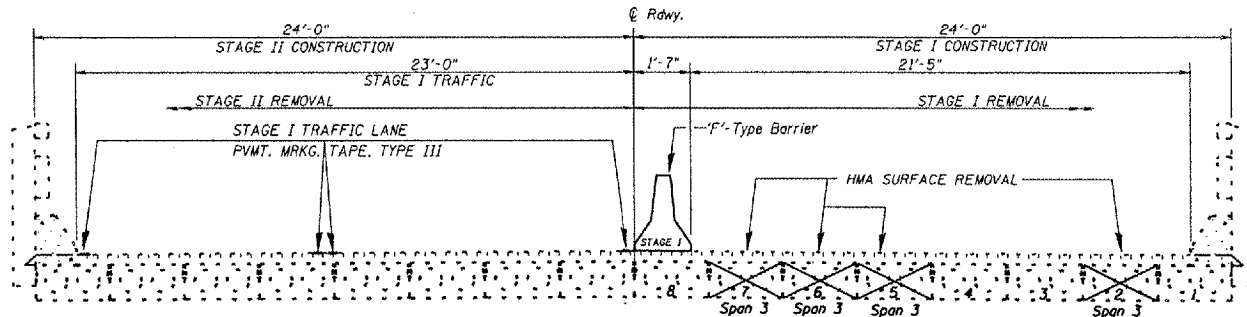

CROSS SECTION
(Looking West)

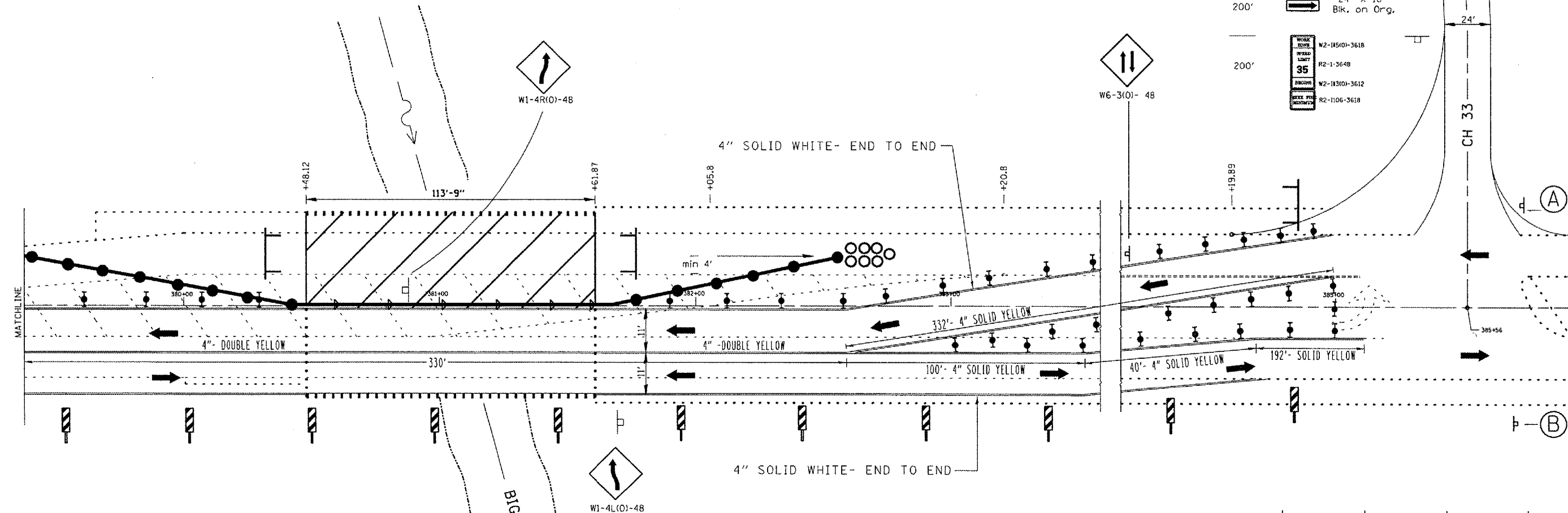
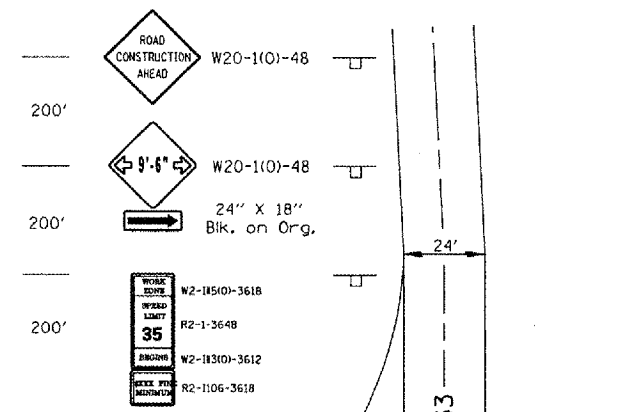

STAGE I PLAN

DEVICE SPACING

- = 50' cts.
- = 50' cts.
- = 25' cts.
- = 25' cts.

SYMBOLS

- Work Area
- Sign
- Type III Barricade
- Drum w/steady burning light
- Double Vertical Panels w/ steady-burning lights
- Type C bidirectional reflector
- Temporary Concrete Barrier
- Impact Attenuator

REVISIONS

NAME	DATE

= W1-4R(0)-48
 = W2-1(5)(0)-3618
 W2-1(3)(0)-3612
 R2-1106-3618
 W20-1(0)-48
 W20-1(0)-48

* TO BE PLACED ACROSS FROM THE 35 MPH SIGN ON OPPOSING LANE.
* C20-11031013660

SN. 072-0137 IL.8
over Big Hollow Crk.

ILLINOIS DEPARTMENT OF TRANSPORTATION
TRAFFIC CONTROL SPECIAL

SCALE: VERT. DATE 04-25-2007
HORIZ. DATE 04-25-2007

DRAWN BY CEJ
CHECKED BY

NOT TO SCALE

80475-18-87
 FILED IN DRAWING 14 VARIATION
 REPR-CONTRACT 68475
 SN 072-0137
 SN 072-0137 IL.8 over Big Hollow Crk.