

P.A.S. RTE.	SECTION	COUNTY	TOTAL SHEETS	SHEET NO.
1388	12C-12D-BR1	PEORIA	20	12
STA. 380+48.12		TO STA. 381+61.87		
FED. ROAD DIST. NO. 4 ILLINOIS FED. AID PROJECT				

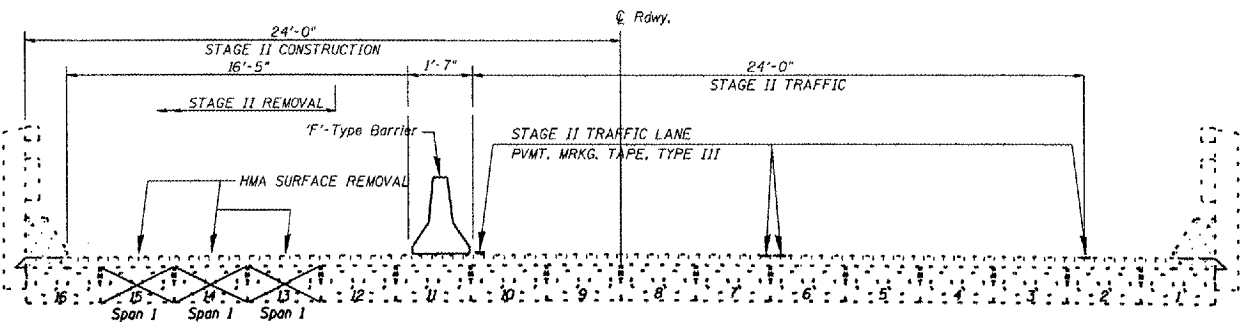

CROSS SECTION
(Looking West)
STAGE II

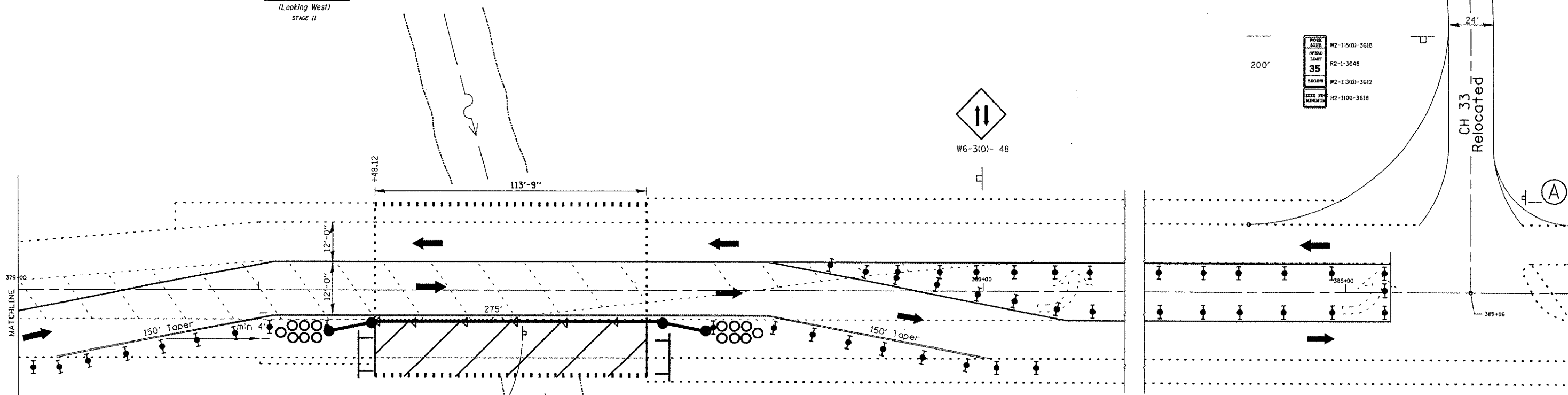

STAGE II PLAN

DEVICE SPACING

- = 50' cts.
- = 50' cts.
- = 25' cts.
- = 25' cts.

SYMBOLS

- Work Area
- Sign on Portable Support
- Type III Barricade
- Drum w/ steady burning light
- Double Vertical Panels w/ steady-burning lights
- Type C bidirectional reflector
- Temporary Concrete Barrier
- Impact Attenuator

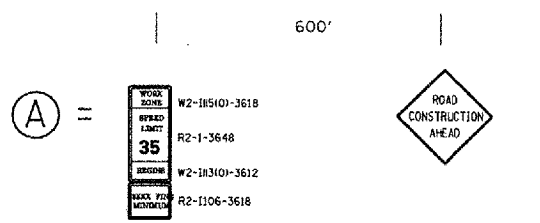
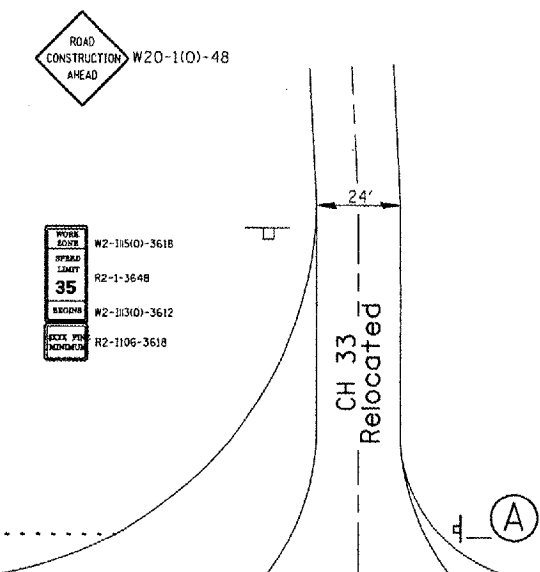

NOT TO SCALE

REVISIONS	
NAME	DATE

ILLINOIS DEPARTMENT OF TRANSPORTATION
TRAFFIC CONTROL SPECIAL
SCALE: VERT. HORIZ.
DATE 04-25-2007
DRAWN BY CEJ
CHECKED BY

NOTES: 18-87
 #FILE# GENDRIFT\STONPLNS\SQAD 14\BRIDGE Repr-Contracts\68478 SN072-0137\IL 08-8\BigHollowCrk.dgn
 SCALE:
 SHEET: