

STATE OF ILLINOIS
DEPARTMENT OF TRANSPORTATION

ROUTE NO.	SECTION	COUNTY	TOTAL SHEETS	SHEET NO.
		Peoria	20	14
FED. ROAD DIST. NO. 7	ILLINOIS	FED. AID PROJECT		

Contract Number: 68751

GENERAL NOTES

The cut strands at each beam end shall be given two coats of zinc dust spray or paint meeting the requirements of ASTM A780. The zinc dust spray or paint shall be applied before corrosion appears and allowed to dry according to manufacturer's specifications prior to another coat of zinc. This work shall be performed by the producer and included with the cost of the beam.

Any damage done to the bridge during beam removal shall be repaired by the Contractor. Cost to be included in the cost of Removal of Existing PPC Deck Beams.

The top surface of the beams shall be finished according to the IDOT Manual for Fabrication of Precast Prestressed Concrete Products.

Plan dimensions and details relative to existing plans are subject to routine variations. The Contractor shall field verify existing dimensions and details affecting new construction and make necessary approved adjustments prior to construction or ordering of materials. Such variations shall not be cause for additional compensation for a change in scope of the work, however, the Contractor will be paid for the quantity actually furnished based upon the unit price bid for the work.

Temporary Concrete Barrier should only be anchored into the overlay and not into the PPC Deck Beams.

The contractor is advised that the existing PPC Deck Beams are in a deteriorated condition with reduced load carrying capacity. It is the contractor's responsibility to account for the condition of the beams when developing construction procedures.

If the contractor's procedure for existing beam removal or placement of new beams involves placement of cranes or other heavy equipment on the bridge, a detailed procedure shall be submitted to the Engineer for approval. The procedure shall include calculations, prepared and sealed by an Illinois Licensed Structural Engineer, verifying that the equipment and procedure used will not overstress the new or existing beams. To distribute load to multiple beams and protect the existing surface, in all cases a double layer mat of heavy timbers shall be used at all times under crane tracks or wheels and any outriggers in the down position. If necessary, shims shall be used under the crane mat to ensure uniform contact with the underlying beams. If heavy equipment will be placed on new PPC deck beams, the following shall be done prior to placement of the timber mats: placement and tightening of transverse tie assemblies, grouting and curing the dowel rods 24 hours minimum and grouting and curing the shear keys.

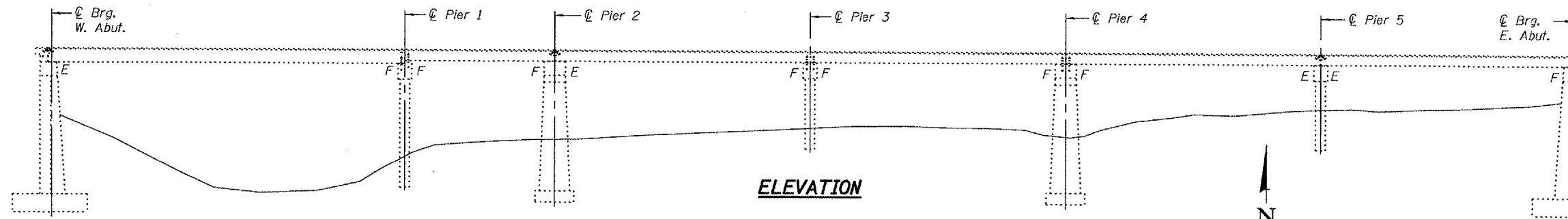

ELEVATION

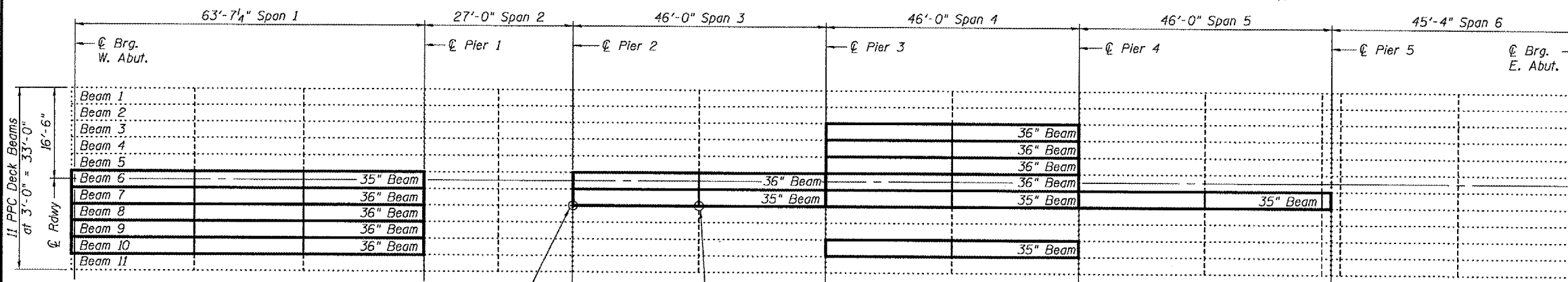

PLAN

Existing WT section to be cut flush with face of beam to remain. (Typ.)

Existing tie rod to be cut see detail this sheet. (Typ.)

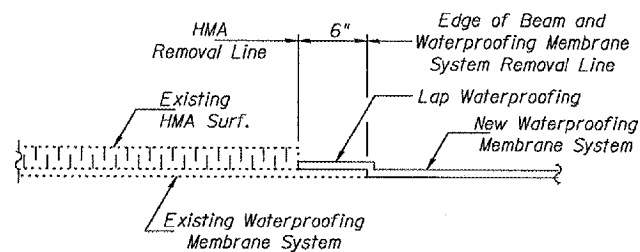

WATERPROOFING TREATMENT

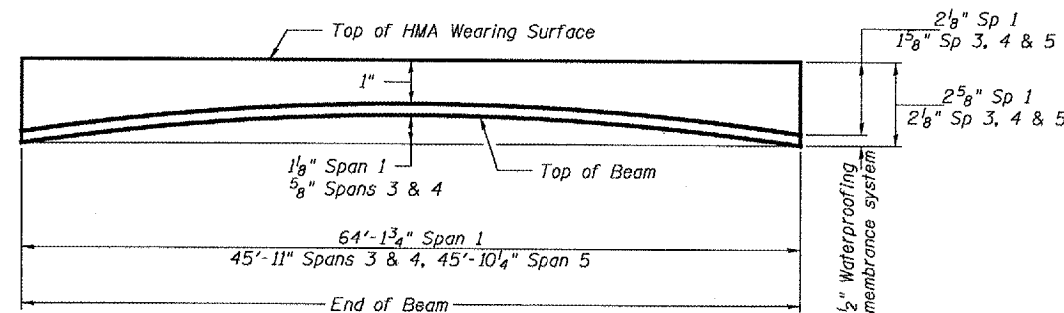

ANTICIPATED INITIAL CAMBER DIAGRAM

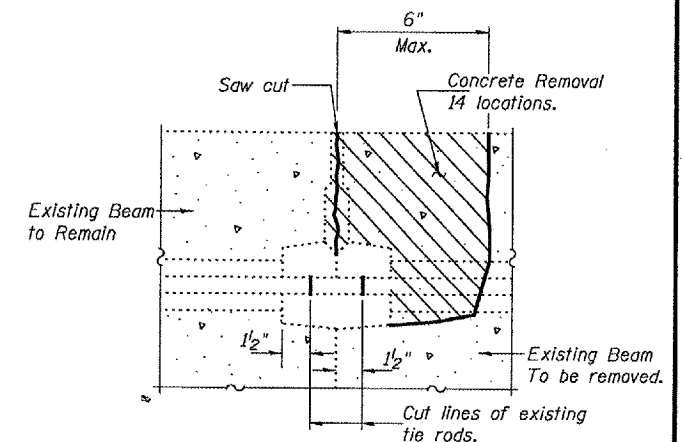

BEAM REMOVAL DETAIL AT TRANSVERSE TIES

TOTAL BILL OF MATERIAL

ITEM	UNIT	QUANTITY
Removal Existing PPC Deck Beams	Sq. Ft.	2,202
PPC Deck Beams (21" Depth)	Sq. Ft.	1,225
PPC Deck Beams (27" Depth)	Sq. Ft.	957
HMA Surface Removal	Sq. Yd.	27.6
HMA Surface Course, Mix "D", N50	Tons	29.5
Waterproofing Membrane System	Sq. Yd.	262
PC Mortar Fairing Course	Foot	981
Asbestos Bearing Pad Removal	Each	8
Furnishing and Erecting Structural Steel	Pound	852

DESIGN STRESSES

PRECAST UNITS
 $f'c = 5,000$ psi
 $f'ci = 4,000$ psi
 $f's = 270,000$ psi ($1/2$ " ϕ low lax strands)
 $f'si = 201,960$ psi ($1/2$ " ϕ low lax strands)

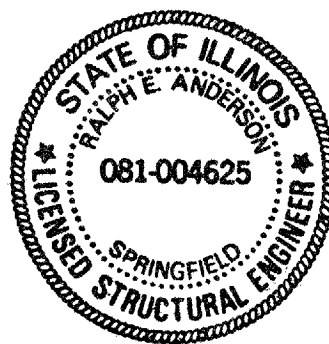

Expires: November 30, 2008

DESIGNED: Victor A. Veliz
 CHECKED: [Signature]
 DRAWN: [Signature]
 CHECKED: UHV SJB

EXAMINED: [Signature]
 PASSED: [Signature]
 ENGINEER OF BRIDGES AND STRUCTURES

PLAN AND ELEVATION
F.A.S. RT.384
PEORIA COUNTY
SN 072-0047