

(217)465-4181

PROJECT ENGINEER: TIM BRANDENBURG

SQUAD LEADER: JEFF SHERER

DESIGNER: JULIE WEGER

F.A.P. RTE.	SECTION	COUNTY	TOTAL SHEETS	SHEET NO.
840	121BR	VERMILION	19	1

CONTRACT NO. 70585

19+1=20

STATE OF ILLINOIS
DEPARTMENT OF TRANSPORTATION

DIVISION OF HIGHWAYS

**PROPOSED
HIGHWAY PLANS**

FAP ROUTE 840 (IL 49)
SECTION 121BR
VERMILION COUNTY

C-95-102-06

CULVERT REPLACEMENT

FOR INDEX OF SHEETS, SEE SHEET NO. 2
FOR SUMMARY OF QUANTITIES, SEE SHEET NO. 4



PROPOSED STRUCTURE NO. 092-8072
STATION 806+80.46
PRECAST CONCRETE BOX CULVERT
8' X 3' (M273)

CURRENT ADT
MINOR ARTERIAL
FAP 840 (IL 49) = 1400 (2006)

DESIGN DESIGNATION
N/A

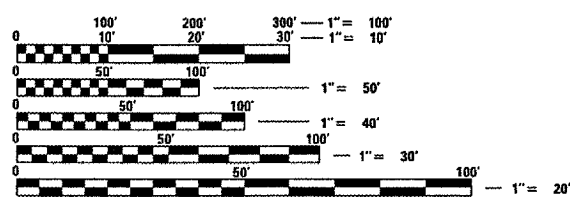

FULL SIZE PLANS HAVE BEEN PREPARED USING STANDARD ENGINEERING SCALES. REDUCED SIZED PLANS WILL NOT CONFORM TO STANDARD SCALES. IN MAKING MEASUREMENTS ON REDUCED PLANS, THE ABOVE SCALES MAY BE USED.

J.U.L.I.E.
JOINT UTILITY LOCATION INFORMATION FOR EXCAVATION
1-800-892-0123

EXISTING STRUCTURE NO. 092-8043
STATION 796+57.5
TO BE FILLED WITH
CONTROLLED LOW-STRENGTH MATERIAL

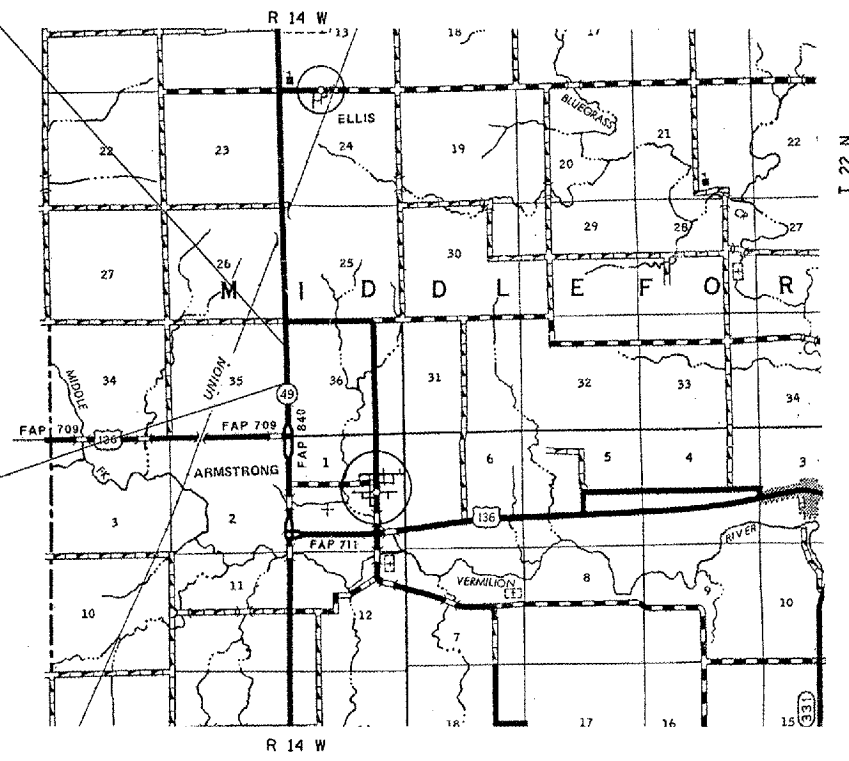

TOTAL LENGTH OF SECTION = 1300 FT = 0.246 MILES
NET LENGTH OF SECTION = 27.3 FT = 0.005 MILES



STATE OF ILLINOIS
DEPARTMENT OF TRANSPORTATION
DIVISION OF HIGHWAYS

SUBMITTED 5/14 2007
Joseph E. Cooney
DEPUTY DIRECTOR OF HIGHWAYS, REGION ENGINEER

June 29, 2007
Eric F. Horn
INTERIM ENGINEER OF DESIGN AND ENVIRONMENT

June 29, 2007
Milton L. Sees, P.E.
DIRECTOR OF HIGHWAYS, CHIEF ENGINEER

**PRINTED BY THE AUTHORITY
OF THE STATE OF ILLINOIS**

CONTRACT NO. 70585

F.A.P. RTE.	SECTION	COUNTY	TOTAL SHEETS	SHEET NO.
840	121BR	VERMILION	19	3
STA.		TO STA.		
FED. ROAD DIST. NO.	ILLINOIS	FED. AID PROJECT		

GENERAL NOTES

- G.N.-100**
ENGLISH UNITS OF MEASUREMENT SHALL GOVERN OVER AND SUPERSEDE ANY METRIC UNITS SHOWN IN THIS CONTRACT. WHERE INCLUDED, METRIC UNITS ARE FOR INFORMATION ONLY.
- G.N.-105.09A**
ALL ELEVATIONS SHOWN IN THE PLANS ARE BASED ON NORTH AMERICAN VERTICAL DATUM OF 1988. (NAVD 88)
- G.N.-107.31**
UTILITY LINES WERE PLOTTED FROM INFORMATION FURNISHED BY THE VARIOUS UTILITY COMPANIES INVOLVED (QUALITY LEVEL C &/OR QUALITY LEVEL D) AND THE ACCURACY SHOULD BE CONSIDERED APPROXIMATE ONLY.
- UTLILITY COMPANIES MAY BE ADJUSTING THEIR FACILITIES DURING CONSTRUCTION. THE CONTRACTOR SHALL COOPERATE WITH THESE ORGANIZATIONS WHILE THESE ADJUSTMENTS ARE BEING PERFORMED. J.U.L.I.E. - JOINT UTILITY LOCATION INFORMATION FOR EXCAVATORS SYSTEM (800)892-0123.
- G.N.-540**
THE CONTRACTOR SHALL ASSEMBLE AND MATCH-MARK THE PRECAST BOX CULVERT SECTIONS AND END SECTIONS PRIOR TO SHIPMENT OF THESE COMPONENTS FROM THE MANUFACTURER, AND AS DIRECTED BY THE ENGINEER IN ORDER TO SECURE A PROPER FIT ON EACH JOINT. ANY SECTIONS OR END SECTIONS WHICH DO NOT PROVIDE A PROPER FIT AT THE JOINT SHALL BE REJECTED BY THE ENGINEER AND REPLACED BY THE CONTRACTOR WITH NO ADDITIONAL COMPENSATION BEING ALLOWED.
- THIS WORK WILL NOT BE PAID FOR SEPARATELY, BUT SHALL BE INCLUDED IN THE CONTRACT UNIT PRICE PER FOOT FOR PRECAST CONCRETE BOX CULVERTS OF THE SIZE SPECIFIED.
- G.N.-542.07**
AT LOCATIONS WHERE END SECTIONS ARE SPECIFIED, CAST-IN-PLACE CONCRETE HEADWALLS WILL NOT BE ALLOWED.
- G.N.-1004.01**
COARSE AGGREGATE GRADATION CA-10 MAY BE USED WHENEVER COARSE AGGREGATE CA-6 IS SPECIFIED IN THE STANDARD SPECIFICATIONS.
- G.N.-542.07**
AT LOCATIONS WHERE END SECTIONS ARE SPECIFIED, CAST-IN-PLACE CONCRETE HEADWALLS WILL NOT BE ALLOWED.

COMMITMENTS

COMMITMENTS ARE NOT TO BE ALTERED WITHOUT THE WRITTEN APPROVAL OF ALL PARTIES TO WHICH THE COMMITMENT WAS MADE.

THERE ARE NO COMMITMENTS FOR THIS CONTRACT.

PLOT DATE : 5/14/2007
FILE NAME : d:\projects\10585\10585.dwg
USER : cdl1142

REVISIONS		ILLINOIS DEPARTMENT OF TRANSPORTATION
NAME	DATE	
		COMMITMENTS / GENERAL NOTES
SCALE:	VERT. DATE	HORIZ. DRAWN BY CHECKED BY

SUMMARY OF QUANTITIES

F. A. P. NO.	SECTION	COUNTY	TOTAL SHEETS	SHEET NO.
840	121BR	VERMILION	19	4
STA.		TO STA.		
FED. ROAD DIST. NO.	LENGHT	FED. AID PROJECT		

SUMMARY OF QUANTITIES				TOTAL QUANTITIES	S.N. 092-8043 FAP 840 (IL 49) VERMILION COUNTY STA. 796+57.5	S.N. 092-8072 FAP 840 (IL 49) VERMILION COUNTY STA. 806+80.46
CODE NO	ITEM	UNIT			RURAL	RURAL
					100% STATE	100% STATE
					Y007	Y007
20200100	EARTH EXCAVATION	CU YD		325.0	3.0	322.0
20900110	POROUS GRANULAR BACKFILL	CU YD		43.0	0.0	43.0
21400100	GRADING AND SHAPING DITCHES	FOOT		106.0	65.0	41.0
28000300	TEMPORARY DITCH CHECKS	EACH		5.0	1.0	4.0
28000400	PERIMETER EROSION BARRIER	FOOT		260.0	100.0	160.0
28000500	INLET & PIPE PROTECTION	EACH		1.0	0.0	1.0
28100105	STONE RIPRAP, CLASS A3	SQ YD		8.0	0.0	8.0
28101500	RIPRAP, SPECIAL	SQ YD		77.0	0.0	77.0
44000100	PAVEMENT REMOVAL	SQ YD		80.0	0.0	80.0
44201383	CLASS C, PATCHES TYPE IV, 12"	SQ YD		80.0	0.0	80.0
50104300	CONCRETE HEADWALL REMOVAL	CU YD		2.0	2.0	0.0
51205200	TEMPORARY SHEET PILING	SQ FT		132.0	0.0	132.0
51500100	NAME PLATES	EACH		1.0	0.0	1.0
54020803	PRECAST CONCRETE BOX CULVERT 8' X 3' (M273)	FOOT		42.0	0.0	42.0
59300100	CONTROLLED LOW-STRENGTH MATERIAL	CU YD		46.0	46.0	0.0
67100100	MOBILIZATION	L SUM		1.0	0.5	0.5
70100450	TRAFFIC CONTROL AND PROTECTION, STANDARD 701201	L SUM		1.0	0.5	0.5
X0336900	PRECAST CONCRETE BOX CULVERT END SECTIONS 8' X 3'	EACH		2.0	0.0	2.0

* No Specialty Items

F.A.P. RTE.	SECTION	COUNTY	TOTAL SHEETS	SHEET NO.
840	121BR	VERMILION	19	5
STA.		TO STA.		
FED. ROAD DIST. NO.		ILLINOIS	FED. AID PROJECT	

EARTHWORK SCHEDULE						
LOCATION	EARTH EXCAVATION (CUT)	EARTH EXCAVATION ADJUSTED FOR SHRINKAGE	EMBANKMENT (FILL)	EARTHWORK BALANCE WASTE (+) OR SHORTAGE (-)	* FURNISH EXCAVATION	GRADING & SHAPING DITCHES
Proposed Box Culvert	CU YD	CU YD	CU YD	CU YD	CU YD	FOOT
STA. 806+80.46	322.4	241.8	11.6	230.2	-230.2	41
STA. 796+25 - 797+00	2.5	1.9	8.9	-7.0	7.0	65
TOTAL	324.8	243.6	20.4	223.2	-223.2	106.0
USE	325.0	244.0	21.0	224.0	-224.0	106.0

* Quantity for Furnish Excavation is (-) negative; therefore, no Furnished Excavation is needed.

20900110 - POROUS GRANULAR BACKFILL	
LOCATION	CU YD
STA. 806+80.46	
LEFT SIDE	24.5
RIGHT SIDE	17.9
TOTAL	42.4
USE	43.0

28101500 - RIPRAP, SPECIAL	
LOCATION	SQ YD
PROPOSED STRUCTURE	
STA. 806+80.46	77.0
TOTAL	77.0

54020803 - PRECAST CONCRETE BOX CULVERT 8 X 3 (M273)	
LOCATION	FOOT
IL 49	
STA. 806+80.46	42
TOTAL	42.0

28000300 - TEMPORARY DITCH CHECKS	
LOCATION	EACH
RT. STA. 797+10	1.0
LT. & RT. STA. 806+40	2.0
LT. & RT. STA. 807+20	2.0
TOTAL	5.0

51500100 - NAME PLATES	
LOCATION	EACH
IL 49	
LT & RT STA. 806+80.46	1
TOTAL	1.0

59300100 - CONTROLLED LOW-STRENGTH MATERIAL	
LOCATION	CU YD
STRUCTURE NO. 092-8043	
STA. 796+57.5	45.8
TOTAL	46.0

28000400 - PERIMETER EROSION BARRIER	
LOCATION	FOOT
RT STA. 796+10 - 797+10	100.0
LT & RT STA. 806+40 - 807+20	160.0
TOTAL	260.0

44201383 - CLASS C, PATCHES TY. IV, 12"	
LOCATION	SQ YD
STA. 806+66.8 - 806+94.1	79.0
TOTAL	80.0

67100100 - MOBILIZATION	
LOCATION	L SUM
PROJECT LIMITS	
STA. 795+00 - 808+00	1
TOTAL	1.0

28000500 - INLET & PIPE PROTECTION	
LOCATION	EACH
PROPOSED STRUCTURE	
RT. STA. 806+80.46	1.0
TOTAL	1.0

44000100 - PAVEMENT REMOVAL	
LOCATION	SQ YD
STA. 806+66.8 - 806+94.1	79.0
TOTAL	80.0

70100450 - TRAFFIC CONTROL AND PROTECTION, STANDARD 701201	
LOCATION	L SUM
PROJECT LIMITS	
STA. 795+00 - 808+00	1
TOTAL	1.0

28100105 - STONE RIPRAP, CLASS A3	
LOCATION	SQ YD
RIGHT SIDE	
STA. 806+80.46	7.3
TOTAL	7.3
USE	8.0

50104300 - CONCRETE HEADWALL REMOVAL	
LOCATION	CU YD
IL 49	
17' RT. STA. 796+74	1.1
TOTAL	2.0

X0336900 - PRECAST CONCRETE BOX CULVERT END SECTION, 8 X 3	
LOCATION	EACH
IL 49	
LT & RT STA. 806+80.46	2
TOTAL	2.0

REVISIONS	
NAME	DATE

ILLINOIS DEPARTMENT OF TRANSPORTATION

SCHEDULE OF QUANTITIES

SCALE: VERT. / HORIZ. DATE

DRAWN BY / CHECKED BY

PLAN & PROFILE OF A.R. CULVERT @ STA. 796+57.5

CONTRACT NO. 70585

F.A.P. RTE.	SECTION	COUNTY	TOTAL SHEETS	SHEET NO.
840	121BR	VERMILION	19	6
STA.		TO STA.		
FED. ROAD DIST. NO.		ILLINOIS FED. AID PROJECT		

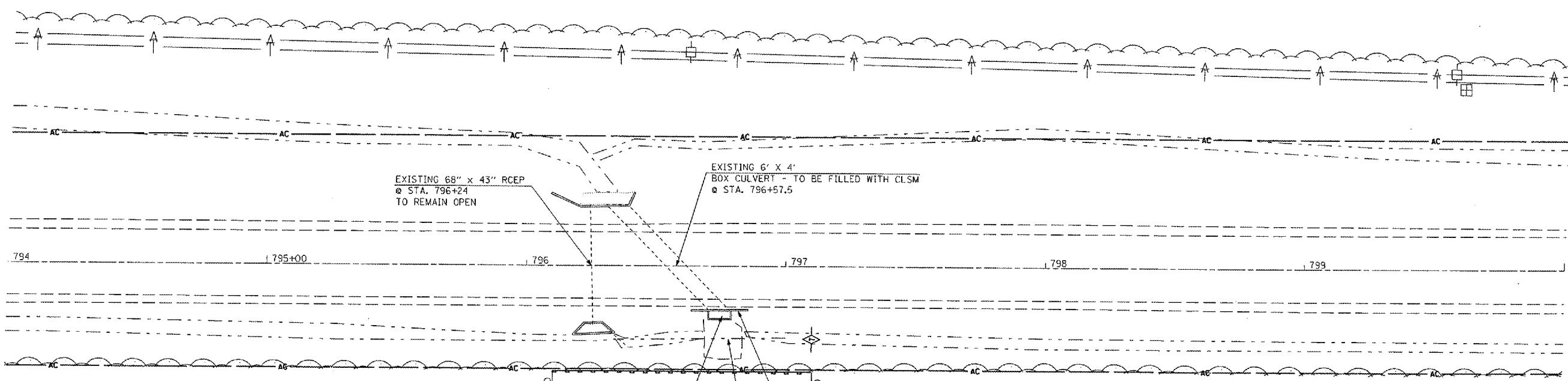

ALL AREAS DISTURBED DURING BOX CULVERT CONSTRUCTION SHALL BE REPAIRED AND SEEDED ACCORDING TO SECTION 250 OF THE STANDARD SPECIFICATIONS. THIS WORK SHALL BE INCLUDED IN THE CONTRACT UNIT PRICE FOR GRADING & SHAPING DITCHES.

SEE SHEET 7 OF 18 FOR CLSM DETAIL

DROP STRUCTURE TO BE FILLED WITH CLSM

EXISTING 6' X 4' BOX CULVERT - TO BE FILLED WITH CLSM @ STA. 796+57.5

EXISTING 68" X 43" RCEP @ STA. 796+24 TO REMAIN OPEN

EXISTING HEADWALL TO BE REMOVED ABOVE DROP STRUCTURE

GRADING AND SHAPING DITCHES

PERIMETER EROSION BARRIER
TEMPORARY DITCH CHECK

SHEET 1 OF 2

T 22 N, R 14 W, SEC. 35 / 36

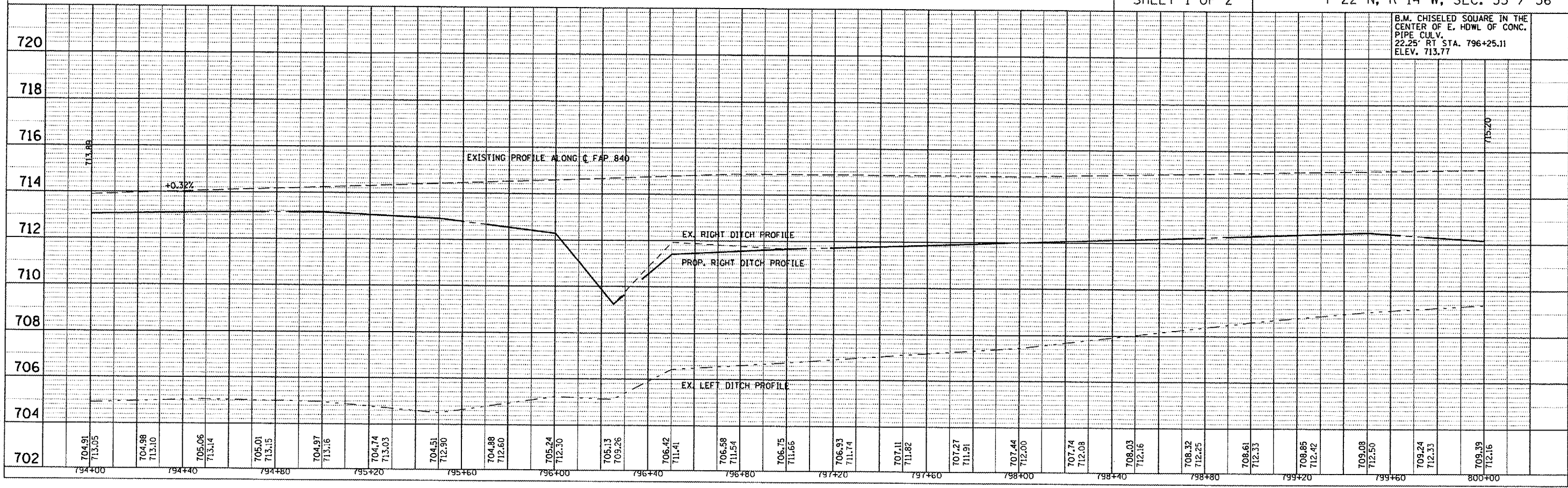

PLAN

DATE	
BY	
REVISIONS	
NO.	
DATE	
BY	
REVISIONS	
NO.	
DATE	
BY	
REVISIONS	
NO.	

PROFILE

DATE	
BY	
REVISIONS	
NO.	
DATE	
BY	
REVISIONS	
NO.	

PLOT DATE: 6/16/2007
 FILE NAME: s:\projects\818206\818206.dwg
 PLOT SCALE: 42.853' / IN.
 USER NAME: collierb

F.A.P. RTE.	SECTION	COUNTY	TOTAL SHEETS	SHEET NO.
840	121BR	VERMILION	19	7
STA.		TO STA.		
FED. ROAD DIST. NO.		ILLINOIS FED. AID PROJECT		

SHEET 2 OF 2

S.N. 092-8043 @ STA. 796+57.5
TO BE FILLED WITH CLSM

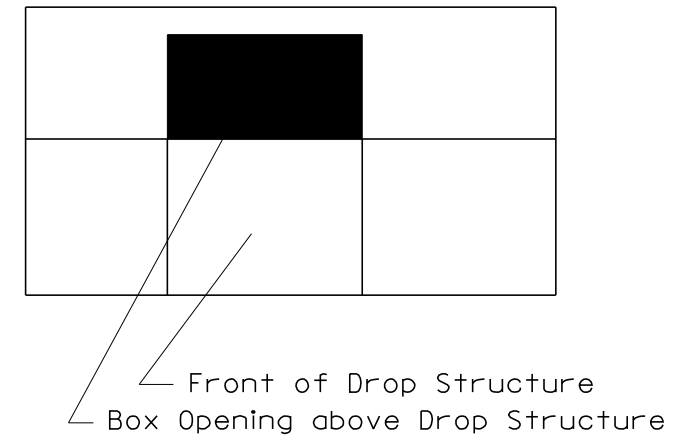
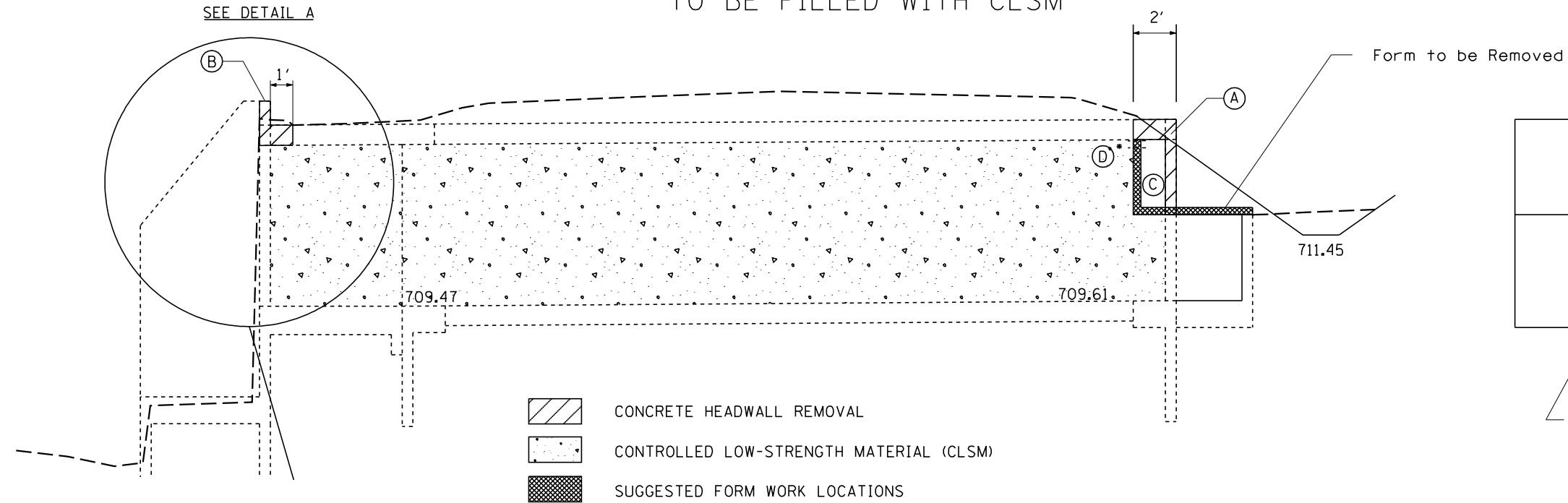

- CONCRETE HEADWALL REMOVAL
- CONTROLLED LOW-STRENGTH MATERIAL (CLSM)
- SUGGESTED FORM WORK LOCATIONS

BILL OF MATERIALS		
ITEM	UNIT	QUANTITY
3/4" Expansion Hook Bolts	EACH	18
# 4 Re-Bar	EACH	9
Class SI Concrete	CU YD	1.0

This work will not be paid for separately, but shall be included in the contract unit price per CU YD for CONTROLLED LOW-STRENGTH MATERIAL

PLAN NOTE:

- (A) The 2' of Concrete Headwall Removal shall be removed prior to the filling of the existing box culvert.
- (B) Concrete Headwall Removal shall be removed and new cap in place prior to the filling of the existing box culvert.
- (C) The height of form is based on how much space is needed for shute or hose to fill box.
- (D) (* & **) Provide two 8" PVC pipe openings for CSLM Placement and Capacity Verification.
- (E) Expansion bolts shall consist of self drilling expansion shields & 3/4" Ø hooked bolts. Bolts shall extend a minimum of 9" into existing concrete.

DETAIL A

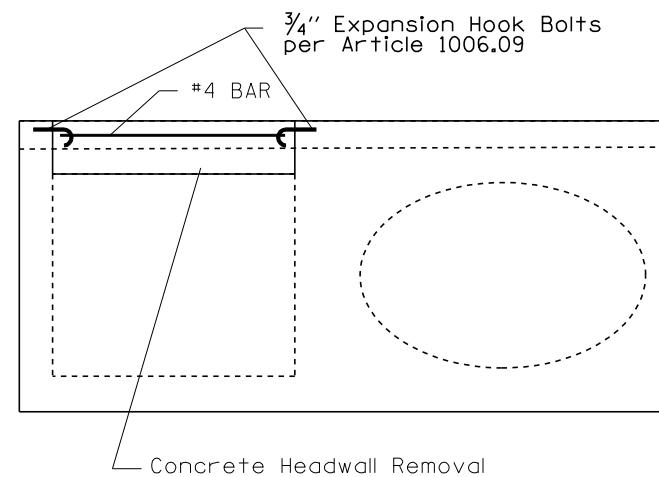
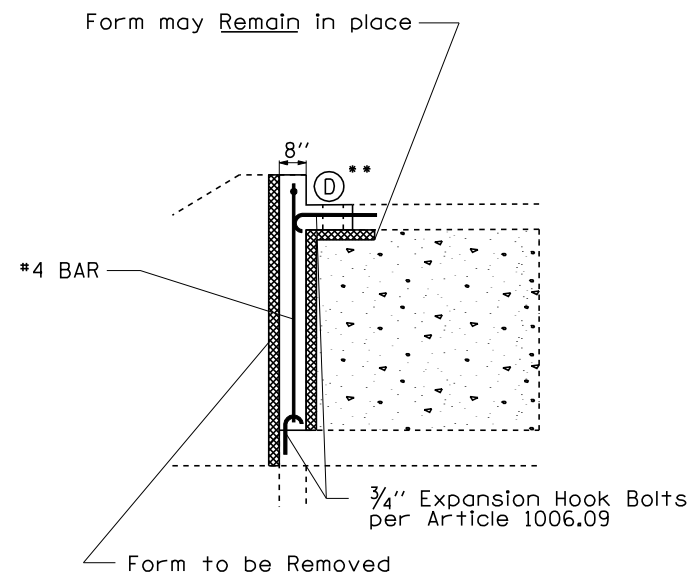

PLAN VIEW

REINFORCEMENT DETAIL

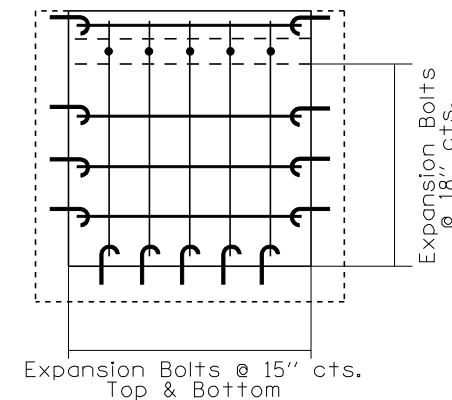

REVISIONS	
NAME	DATE

ILLINOIS DEPARTMENT OF TRANSPORTATION

CONTROLLED LOW-STRENGTH MATERIAL DETAIL

SCALE: VERT. NOT TO SCALE
HORIZ. NOT TO SCALE
DRAWN BY
CHECKED BY

F.A.P. RTE.	SECTION	COUNTY	TOTAL SHEETS	SHEET NO.
840	121BR	VERMILION	19	8

SHEET 1 OF 6

STA.	TO STA.
FED. ROAD DIST. NO.	ILLINOIS FED. AID PROJECT

**EXISTING TYPICAL SECTION
STA. 765+00 - 847+14**

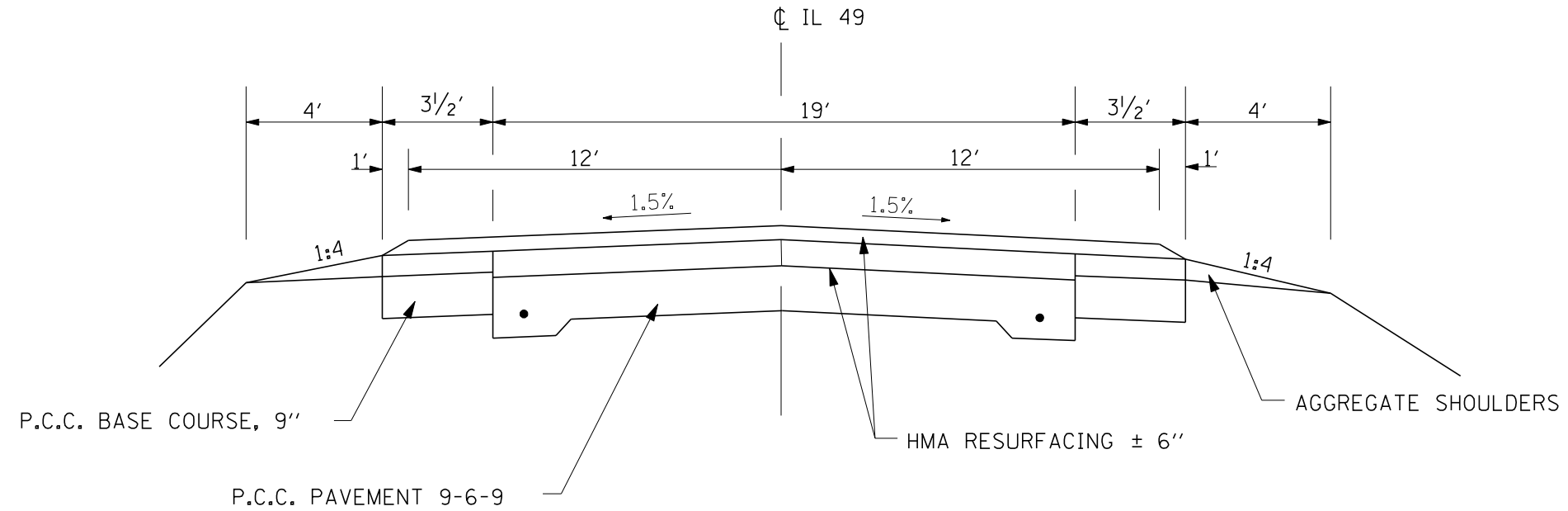

**PROPOSED TYPICAL SECTION
STA. 806+80.46**

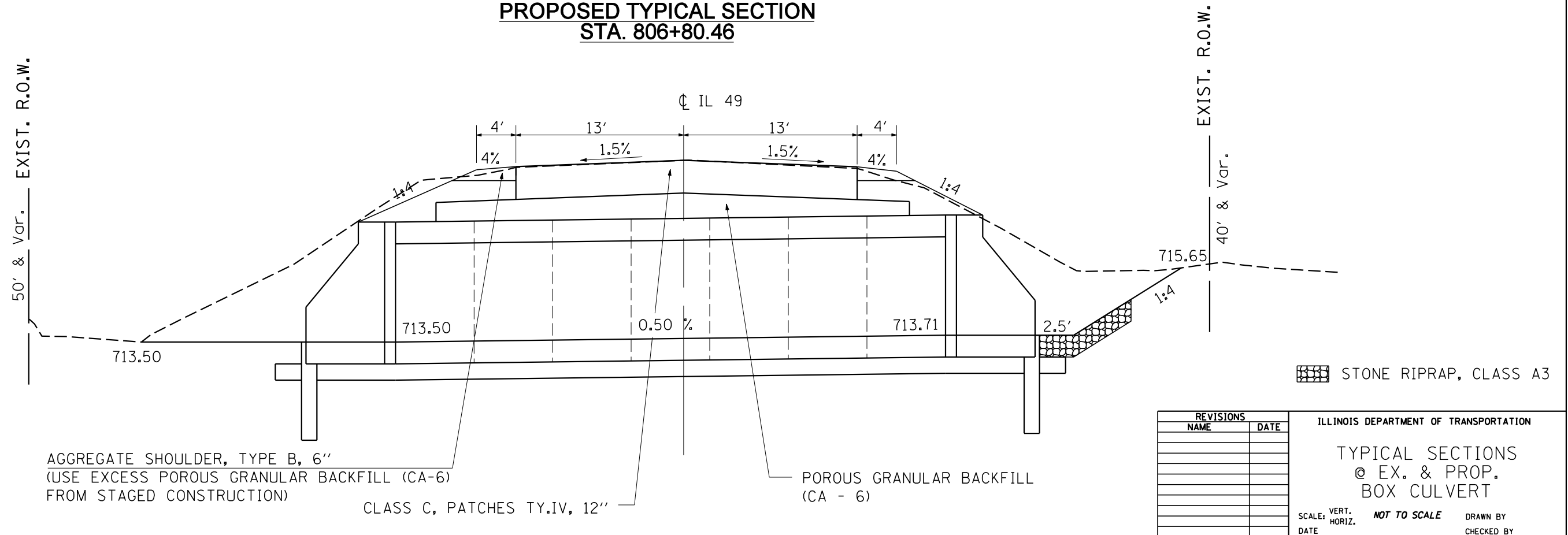

STONE RIPRAP, CLASS A3

REVISIONS	
NAME	DATE

ILLINOIS DEPARTMENT OF TRANSPORTATION

TYPICAL SECTIONS
@ EX. & PROP.
BOX CULVERT

SCALE: VERT. **NOT TO SCALE** HORIZ. DRAWN BY
DATE CHECKED BY

PLOT DATE = 5/14/2007
FILE NAME = c:\projects\102086\102086\102086\102086\102086.dgn
PLOT SCALE = 42.3525' / IN.
USER NAME = collierb

F.A.P. RTE.	SECTION	COUNTY	TOTAL SHEETS	SHEET NO.
840	121BR	VERMILION	19	10
STA.		TO STA.		
FED. ROAD DIST. NO.	ILLINOIS	FED. AID PROJECT		



DETAIL OF POROUS GRANULAR BACKFILL AT A.R. CULVERTS

SHEET 3 OF 6

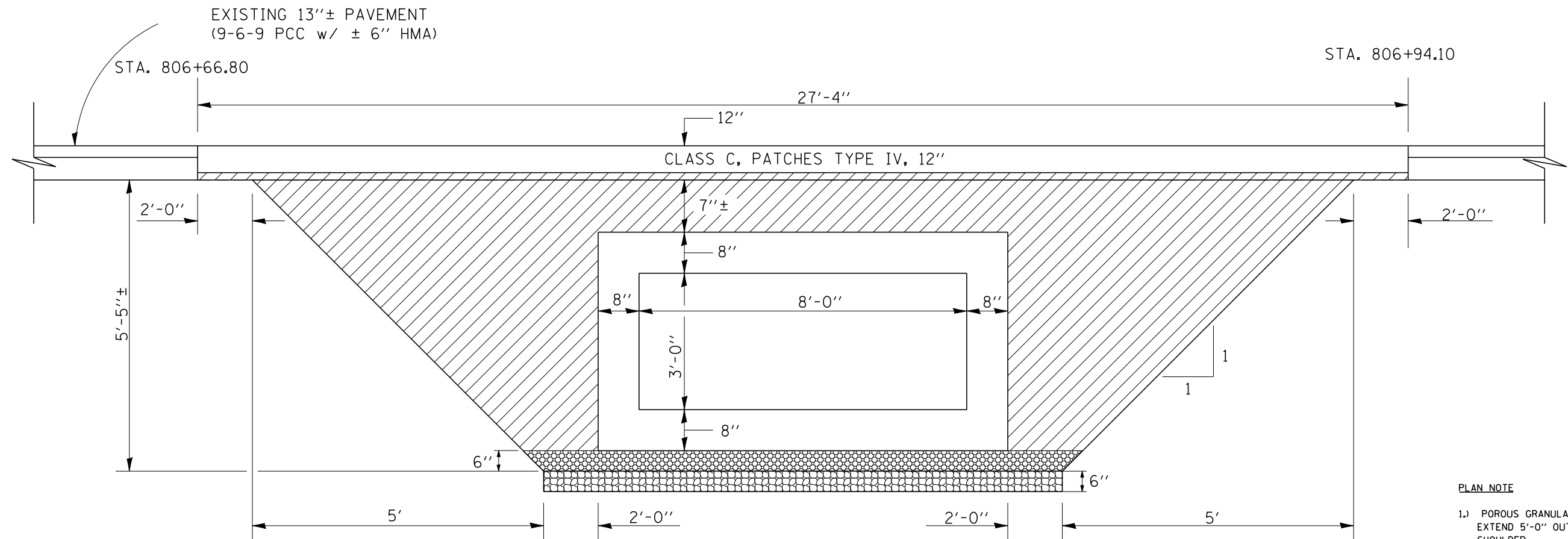
STATION 806+80.46

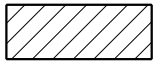
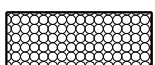

- PLAN NOTE
- 1.) POROUS GRANULAR BACKFILL SHALL EXTEND 5'-0" OUTSIDE OF THE EDGE OF SHOULDER.
 - 2.) THE RIPRAP, SPECIAL USED FOR THE UNDERCUT SHALL BE RR 1. ALL WORK ASSOCIATED WITH THE UNDERCUT IS INCLUDED IN THE COST FOR RIPRAP, SPECIAL.

-  PAY LIMITS OF POROUS GRANULAR BACKFILL-CA 6= 43.0 CU. YD.
-  POROUS GRANULAR MATERIAL, CA-6 (6") INCLUDED IN PAY ITEM FOR BOX CULVERT
-  RIPRAP, SPECIAL (STONE RIPRAP, CLASS A1), 6"

REVISIONS	
NAME	DATE

ILLINOIS DEPARTMENT OF TRANSPORTATION
POROUS GRANULAR BACKFILL DETAIL
 SCALE: VERT. *NOT TO SCALE*
 DATE: _____ DRAWN BY: _____
 CHECKED BY: _____

PLOT DATE = 5/15/2007
 FILE NAME = c:\projects\510206 (v8)\14\plan sheets_revised.dgn
 PLOT SCALE = 42,352% / IN.
 USER NAME = collierb

F.A.P. RTE.	SECTION	COUNTY	TOTAL SHEETS	SHEET NO.
840	121BR	VERMILION	19	12
STA.		TO STA.		
FED. ROAD DIST. NO.		ILLINOIS FED. AID PROJECT		

TYPICAL STAGING DETAILS AT A.R. CULVERTS
STAGE III

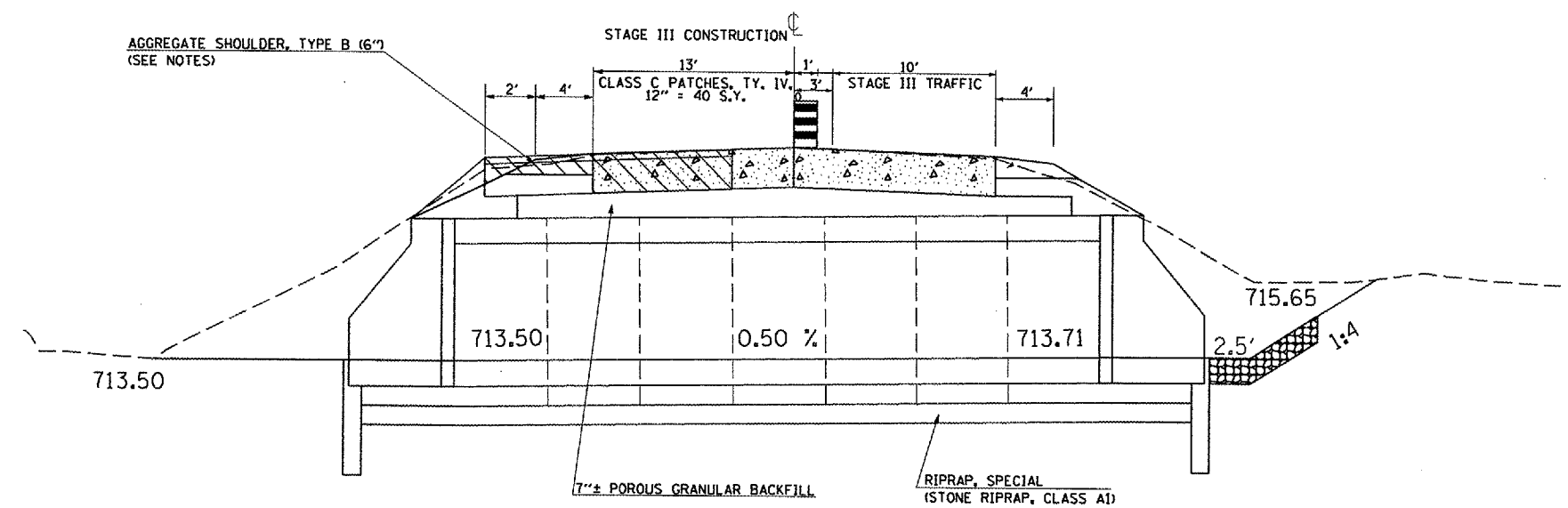

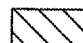
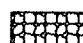
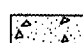
-  REMOVAL OF TEMPORARY PATCH
-  RIPRAP, CLASS A3
-  CLASS C, PATCHES TYPE IV, 12"

(ASSUMED (7) PRECAST CONCRETE BOX CULVERT SECTIONS @ 6' LAY LENGTH)
IN PLACE TOTAL LENGTH = 42'

LOCATION	A.R. CULVERT	AGGREGATE SHOULDERS, TYPE B, 6"		EARTH EXCAVATION
	FOOT	LENGTH (LT & RT)	TON	CU YD
STA. 806+80.46	42	27.3	8.8	325.0
TOTALS	42.0	9.0		325.0

* Aggregate Shoulder, Type B, 6" quantity is estimated and material used shall be excess Porous Granular Backfill (CA-6).

A.R. CULVERT LOCATION	TRAFFIC CONTROL STANDARD	ESTIMATED TIME
STA. 806+80.46	701201	24 hrs. - (2) - 12 hr. days

PAY ITEMS - TRAFFIC CONTROL AND PROTECTION, STANDARD 701201 - 1 L SUM

BILL OF MATERIALS						
SEEDING SCHEDULE - FOR INFORMATION ONLY						
LOCATION	SEEDING CLASS 2A	MULCH METHOD 2	NITROGEN FERTILIZER NUTIRENT	PHOSPHORUS FERTILIZER NUTRIENT	POTASSIUM FERTILIZER NUTRIENT	TEMPORARY EROSION CONTROL SEEDING
PROPOSED BOX CULVERT	ACRE	ACRE	POUND	POUND	POUND	POUND
STA. 806+80.46	0.03	0.03	2.5	2.5	2.5	8.5
STA. 796+74	0.04	0.04	4.0	4.0	4.0	13.4
TOTAL	0.1	0.1	6.6	6.6	6.6	22

This breakdown is for informational purposes only. All items shown in the Seeding Schedule shall be paid for incidental to Grading & Shaping Ditches.

NOTES

- 1) Refer to Special Provisions titled TRAFFIC CONTROL AND PROTECTION, STANDARD 701201 and STAGE CONSTRUCTED ACROSS ROAD STRUCTURES for additional information.
- 2) Construct downstream end of A.R. Culverts first.
- 3) Earth excavated for the construction of AGGREGATE SHOULDERS, TYPE B, 6" shall be deposited and graded to smooth the foreslopes. This excavated earth will be added to the final cross-section volumes for the EARTHWORK BALANCE / WASTE calculations.
- 4) Aggregate Shoulders, Type B, 6" may consist of the excess Porous Granular Backfill (CA-6) from the Temporary Patch. This material and placement shall be included in the cost of the A.R. Box Culvert.
- 5) The Placement and Removal of the Temporary Patch is included in the cost of the A.R. Box Culvert
- 6) The Precast Toe Wall shall be included in the cost of the Precast Box Culvert End Section.

REVISIONS	
NAME	DATE

ILLINOIS DEPARTMENT OF TRANSPORTATION

STAGING DETAIL
@ S.N. 092-8072

SCALE: VERT. NOT TO SCALE
DATE: DRAWN BY: CHECKED BY:

PLOT DATE : 6/19/2007
 PLOT SCALE : 1"=20'-0"
 USER NAME : mllrba

F.A.P. RTE.	SECTION	COUNTY	TOTAL SHEETS	SHEET NO.
840	121BR	VERMILION	19	14
STA. 796+00.00		TO STA. 796+25.00		
FED. ROAD DIST. NO.	ILLINOIS	FED. AID PROJECT		

BY	DATE

NO.	AREAS CHECKED

BY	DATE

NO.	AREAS CHECKED

PLOT DATE = 5/14/2007
 FILE NAME = 10.5582
 PLOT SCALE = 10.5582 / IN.
 USER NAME = collier-bv

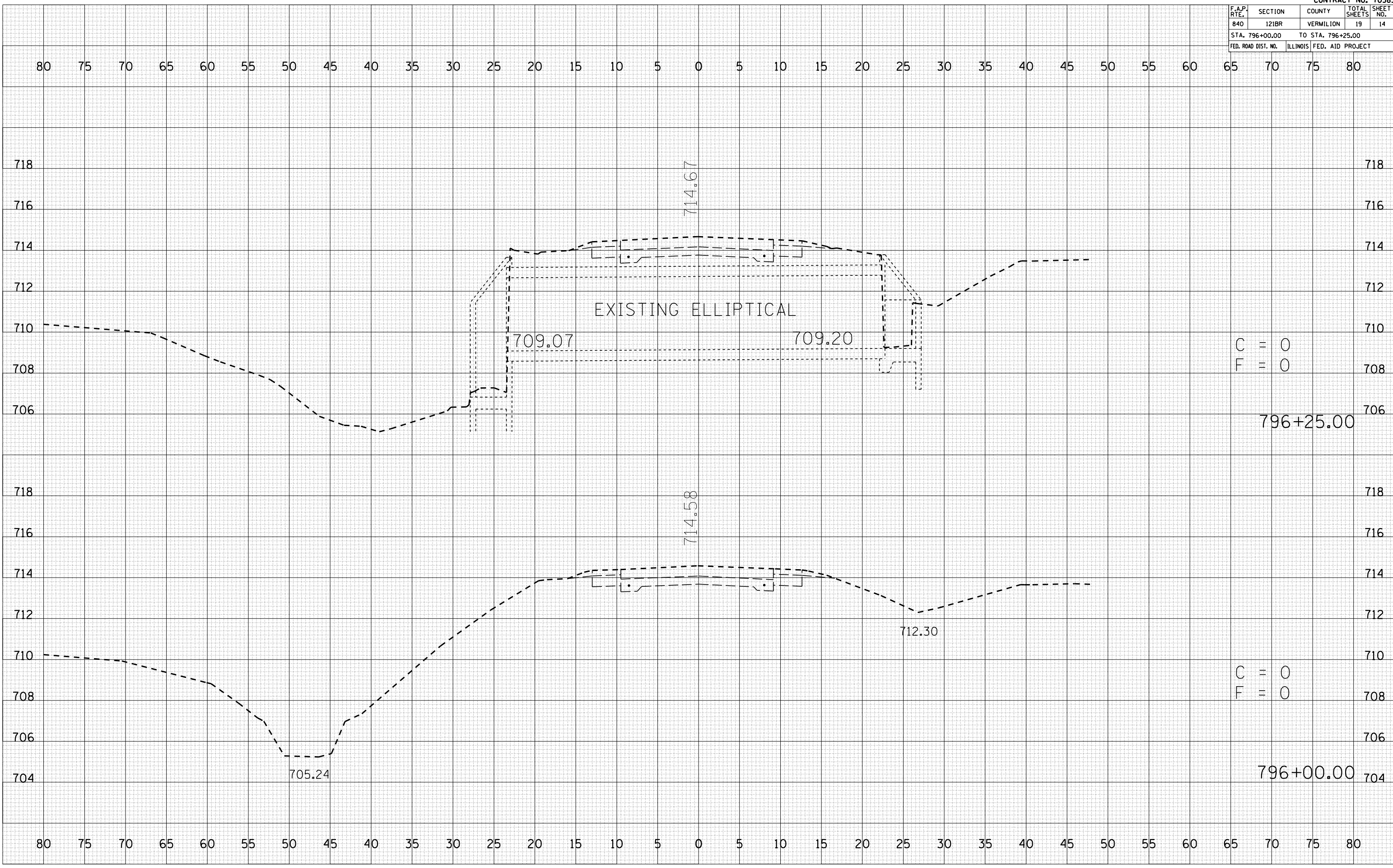

C = 0
 F = 0

C = 0
 F = 0

F.A.P. RTE.	SECTION	COUNTY	TOTAL SHEETS	SHEET NO.
840	121BR	VERMILION	19	15
STA. 796+50.00		TO STA. 796+74.02		
FED. ROAD DIST. NO.	ILLINOIS	FED. AID PROJECT		

BY	DATE

BY	DATE

BY	DATE

BY	DATE

PLOT DATE = 5/14/2007
FILE NAME = 10.5585
PLOT SCALE = 1/8" = 1'-0"
USER NAME = collier-bv

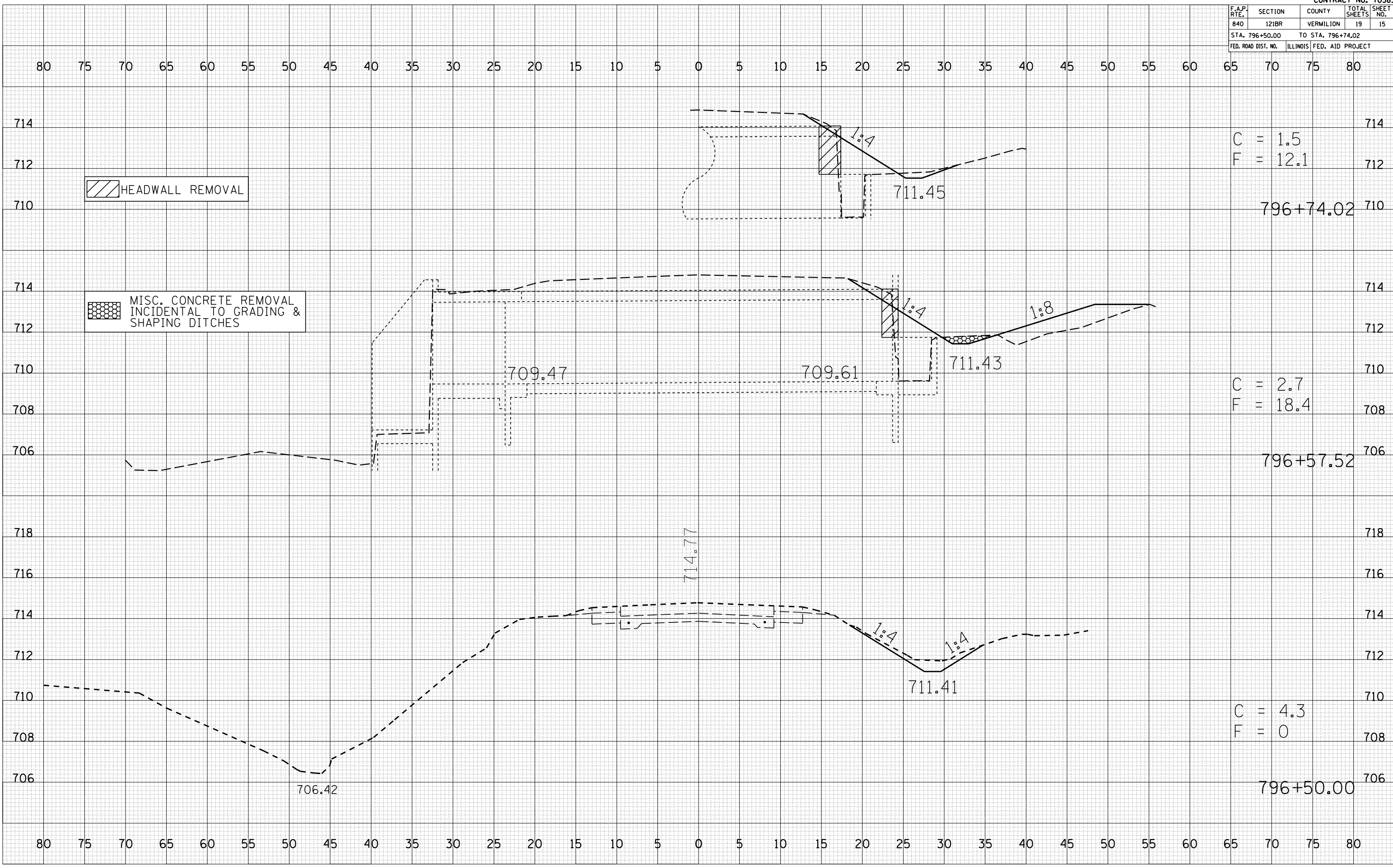

714

712

710

714

712

710

708

706

718

716

714

712

710

708

706

80

75

70

65

60

55

50

45

40

35

30

25

20

15

10

5

0

5

10

15

20

25

30

35

40

45

50

55

60

65

70

75

80

C = 1.5
F = 12.1

796+74.02

C = 2.7
F = 18.4

796+57.52

C = 4.3
F = 0

796+50.00

711.45

711.43

711.41

709.47

709.61

706.42

714.77

F.A.P. RTE.	SECTION	COUNTY	TOTAL SHEETS	SHEET NO.
840	121BR	VERMILION	19	17
STA. 806+00.00		TO STA. 806+50.00		
FED. ROAD DIST. NO.	ILLINOIS	FED. AID PROJECT		

BY	DATE

FINAL SURVEY	SURVEYED	PLOTTED	DATE

NO.	AREAS CHECKED

BY	DATE

ORIGINAL SURVEY	SURVEYED	PLOTTED	DATE

NO.	AREAS CHECKED

PLOT DATE = 5/14/2007
 FILE NAME = I:\1149\114910286\114910286.dwg
 PLOT SCALE = 10.5682" / IN.
 USER NAME = collier-bv

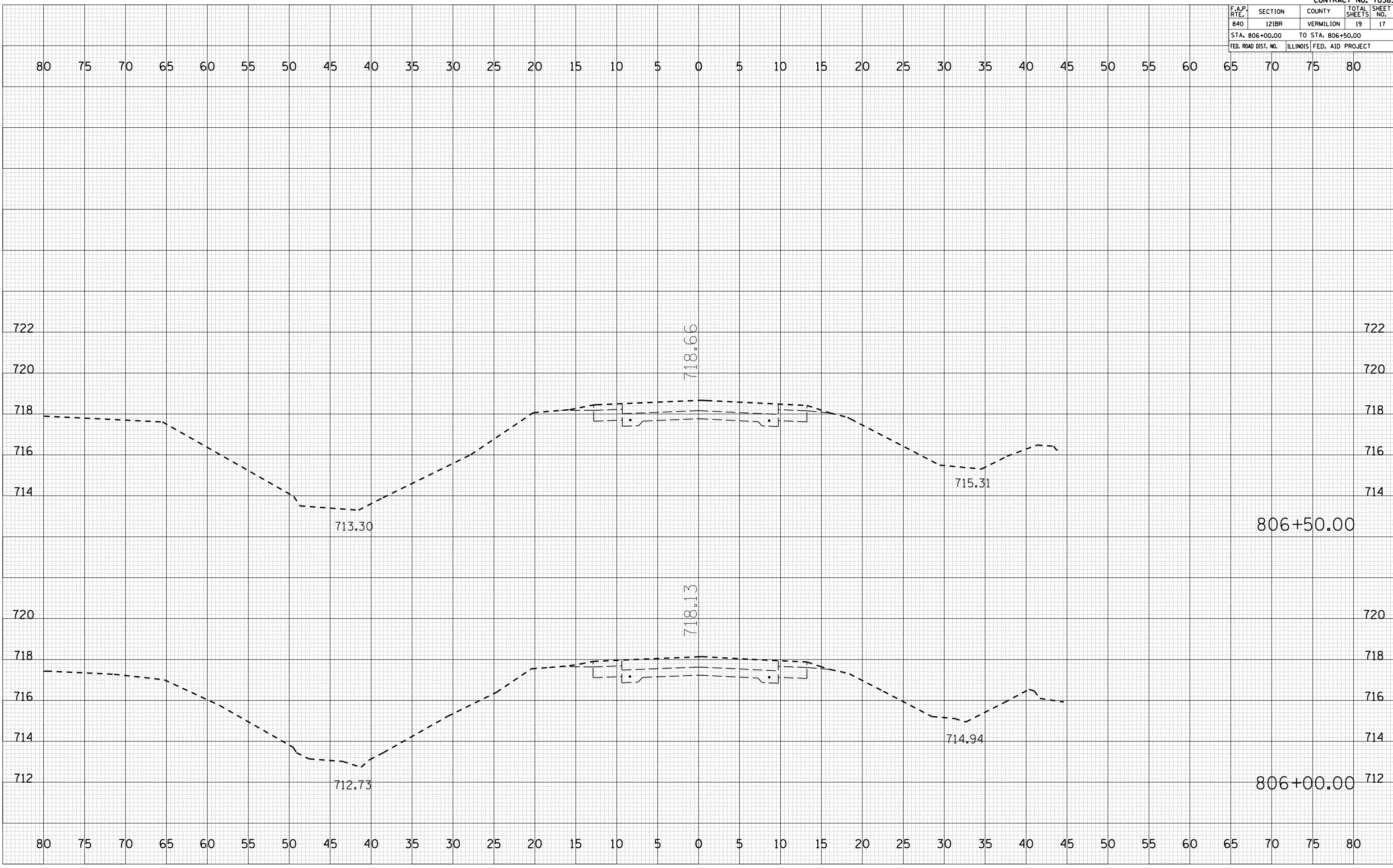

F.A.P. RTE.	SECTION	COUNTY	TOTAL SHEETS	SHEET NO.
840	121BR	VERMILION	19	18
STA. 806+80.46		TO STA. 807+00.00		
FED. ROAD DIST. NO.	ILLINOIS	FED. AID PROJECT		

BY	DATE

FINAL SURVEY	SURVEYED

BY	DATE

ORIGINAL SURVEY	SURVEYED

PLOT DATE = 5/14/2007
 FILE NAME = I:\114194\114194.dwg
 PLOT SCALE = 10.5682 / IN.
 USER NAME = collier-b

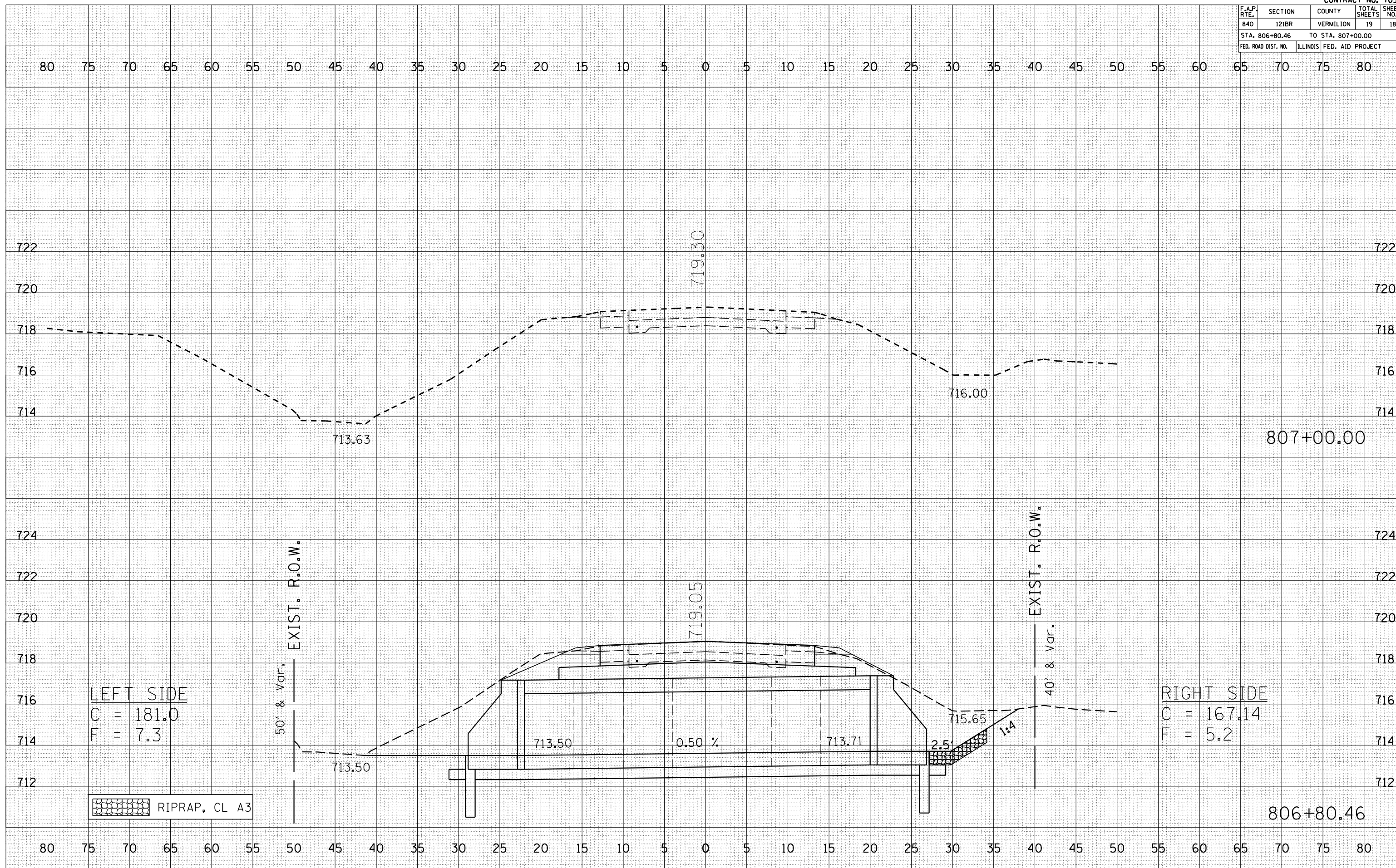

F.A.P. RTE.	SECTION	COUNTY	TOTAL SHEETS	SHEET NO.
840	121BR	VERMILION	19	19
STA. 807+50.00		TO STA. 808+00.00		
FED. ROAD DIST. NO.	ILLINOIS	FED. AID PROJECT		

BY	DATE

FINAL SURVEY	SURVEYED	PLOTTED	DATE

NOTE BOOK NO. AREAS CHECKED

BY	DATE

ORIGINAL SURVEY	SURVEYED	PLOTTED	DATE

NOTE BOOK NO. AREAS CHECKED

PLOT DATE = 5/14/2007
FILE NAME = 10.5582
PLOT SCALE = 10.5582 / IN.
USER NAME = collier-b

