

| | | | | |
|---------------------|------------|---------------------------|--------------|-----------|
| FAP RTE. | SECTION | COUNTY | TOTAL SHEETS | SHEET NO. |
| 666 | SP-Z, RS-4 | SANGAMON | 80 | 51 |
| STA. | | TO STA. | | |
| FED. ROAD DIST. NO. | | ILLINOIS FED. AID PROJECT | | |

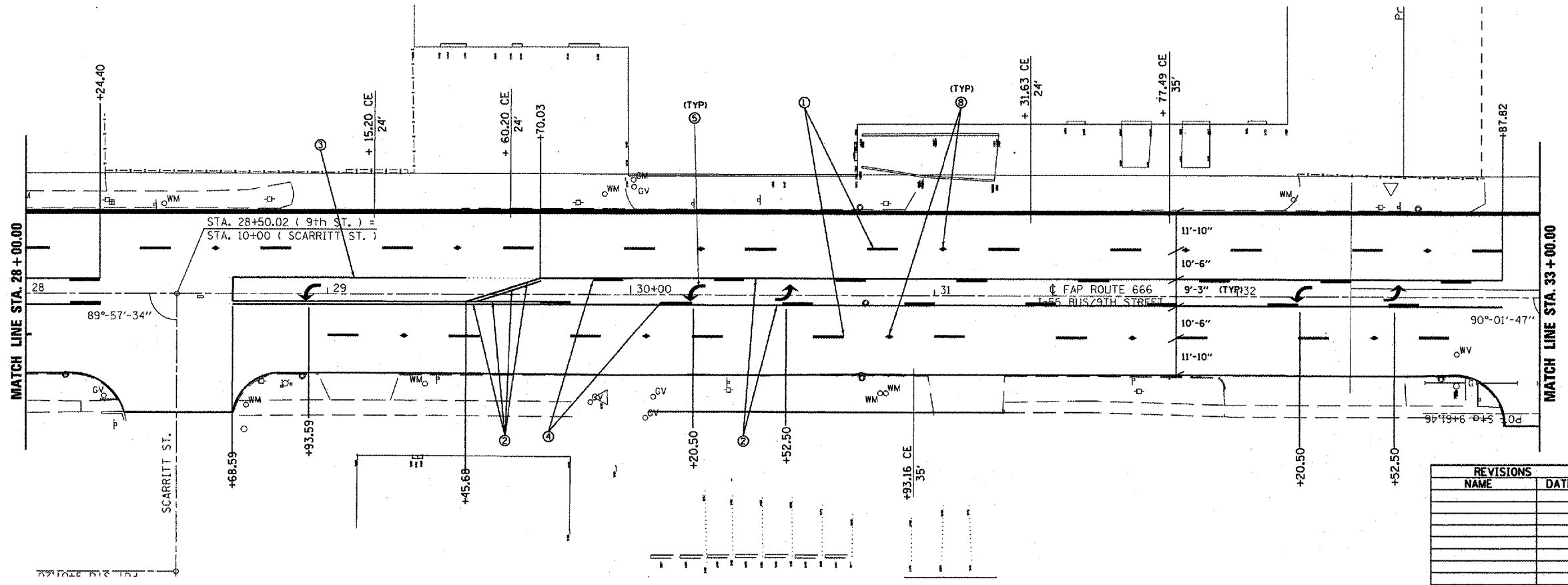
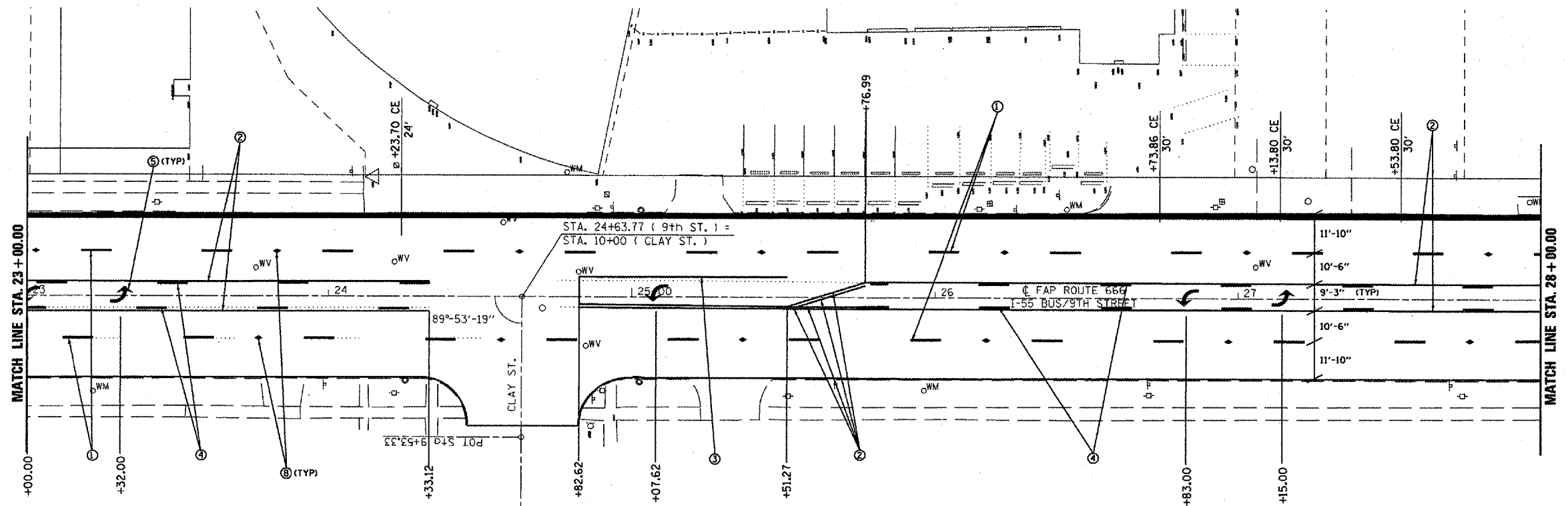

- PAVEMENT MARKING LEGEND**
- ① PR PPPM TY B (SKIP-DASH, WHITE, 5")
 - ② PR THERMOPLASTIC PM (SOLID, YELLOW, 5")
 - ③ PR PPPM TY B (SOLID, WHITE, 6")
 - ④ PR THERMOPLASTIC PM (SKIP-DASH, YELLOW, 5")
 - ⑤ PR PPPM TY B, LETTERS & SYMBOLS
 - ⑥ PR PPPM TY B (SOLID, WHITE, 24")
 - ⑦ PR THERMOPLASTIC PM (SOLID, YELLOW, 12")
 - ⑧ PR RAISED REFLECTIVE PAVEMENT MARKER
 - ⑨ PR POLYUREA PM TY 1 (SKIP-DASH, WHITE, 5")
 - ⑩ PR POLYUREA PM TY 1 (SOLID, YELLOW, 5")
 - ⑪ PR POLYUREA PM TY 1 (SKIP-DASH, YELLOW, 5")
 - ⑫ PR POLYUREA PM TY 1 (SOLID, WHITE, 6")
 - ⑬ PR POLYUREA PM TY 1 (SOLID, YELLOW, 12")

| REVISIONS | |
|-----------|------|
| NAME | DATE |
| | |
| | |
| | |
| | |
| | |
| | |
| | |
| | |
| | |
| | |

ILLINOIS DEPARTMENT OF TRANSPORTATION
PAVEMENT MARKING SHEET
FAP ROUTE 666 (I-55 BUS/9TH STREET)
SECTION SP-Z, RS-4
SANGAMON COUNTY
SHEET 11 OF 12

SCALE: VERT. _____
 HORIZ. _____
 DATE _____

DRAWN BY _____
 CHECKED BY _____