

F.A.P. RTE.	SECTION	COUNTY	TOTAL SHEETS	SHEET NO.
332	101B-1	WABASH	34	1

STATE OF ILLINOIS
DEPARTMENT OF TRANSPORTATION
DIVISION OF HIGHWAYS

**PROPOSED
HIGHWAY PLANS**

FAP ROUTE 332 (IL 1)
SECTION 101B-1
PROJECT: BHF-0005 (544)
WABASH COUNTY
C-97-050-03

INDEX OF SHEETS

- 1 COVER
- 2 GENERAL NOTES
- 3-4 SUMMARY OF QUANTITIES
- 5-6 SCHEDULE OF QUANTITIES
- 7 ALIGNMENT TIES & BENCHMARKS
- 8 TYPICAL SECTIONS
- 9-11 PLAN & PROFILE
- 12-14 STAGE CONSTRUCTION PLAN
- 15-17 EROSION CONTROL PLAN
- 18-28 STRUCTURE PLANS SN 093-0005
- 29-34 CROSS SECTIONS

INDEX OF IDOT HIGHWAY STANDARDS

- 000001-04 635011-01
- 001001-01 701201-02
- 001006 701306-01
- 280001-03 701321-08
- 515001-02 701326-02
- 630001-07 702001-06
- 630201-04 704001-03
- 630301-04 780001-01
- 631032-03 781001-02
- 635006-02

D-97-037-03

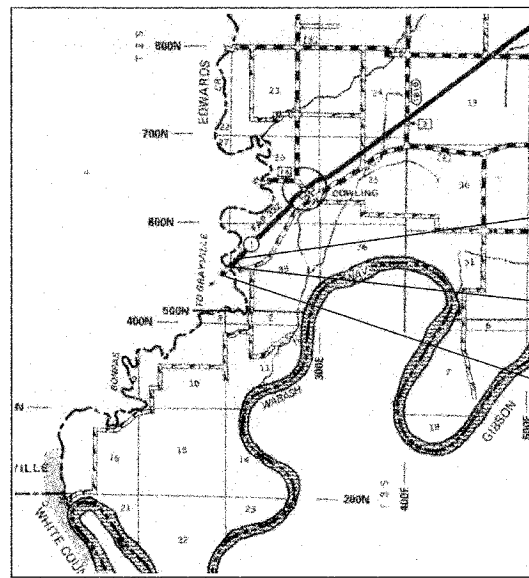

LOCATION MAP

WABASH COUNTY
IL 1

GROSS LENGTH OF PROJECT = 584.29 FEET (0.11 MILES)
NET LENGTH OF PROJECT = 584.29 FEET (0.11 MILES)

END PROJECT
STA 152+06.75

STRUCTURE # 093-0005
STA 148+47.08
to STA 150+13.09

BEGIN PROJECT
STA 146+22.46

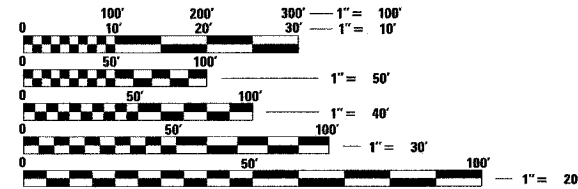
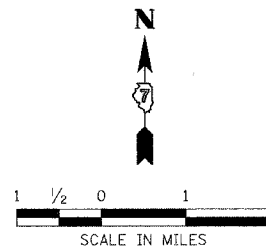

FULL SIZE PLANS HAVE BEEN PREPARED USING STANDARD ENGINEERING SCALES. REDUCED SIZED PLANS WILL NOT CONFORM TO STANDARD SCALES. IN MAKING MEASUREMENTS ON REDUCED PLANS, THE ABOVE SCALES MAY BE USED.

J.U.L.I.E.
JOINT UTILITY LOCATION INFORMATION FOR EXCAVATION
1-800-892-0123

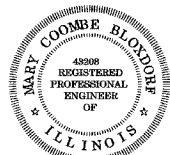

Mary Coombe Bloxdorf 6/25/07
MARY COOMBE BLOXDORF, P.E.
License Expires 11/30/2007

THIS SEAL IS VALID FOR THE FOLLOWING SHEETS IN THESE PLANS WHICH WERE PREPARED UNDER MY DIRECT SUPERVISION:

SHEETS 9 TO 34

PLANS PREPARED BY
HORNER & SHIFRIN, INC.
ENGINEERS

640 PIERCE BOULEVARD SUITE 200 • O'FALLON, ILLINOIS 62269
5200 OAKLAND AVENUE ■ ST. LOUIS, MISSOURI 63110
www.hornershifrin.com



Stephanie S. Muentnich 6/21/07
STEPHANIE S. MUENTNICH, P.E.
License Expires 11/30/2007

THIS SEAL IS VALID FOR THE FOLLOWING SHEETS IN THESE PLANS WHICH WERE PREPARED UNDER MY DIRECT SUPERVISION:

SHEETS 1 TO 8

STATE OF ILLINOIS
DEPARTMENT OF TRANSPORTATION
DIVISION OF HIGHWAYS

SUBMITTED June 26, 2007
Christian M. Road
DEPUTY DIRECTOR OF HIGHWAYS, REGION ENGINEER

June 29, 2007
Eric E. Harrel
ENGINEER OF DESIGN AND ENVIRONMENT

June 29, 2007
Melton R. Sees, P.E.
DIRECTOR OF HIGHWAYS, CHIEF ENGINEER

**PRINTED BY THE AUTHORITY
OF THE STATE OF ILLINOIS**