

F.A.P. RTE.	SECTION	COUNTY	TOTAL SHEETS	SHEET NO.
793	112BR-2	BOND	52	19
STA. 671+50		TO STA. 676+50		
FED. ROAD DIST. NO.		ILLINOIS FED. AID PROJECT		

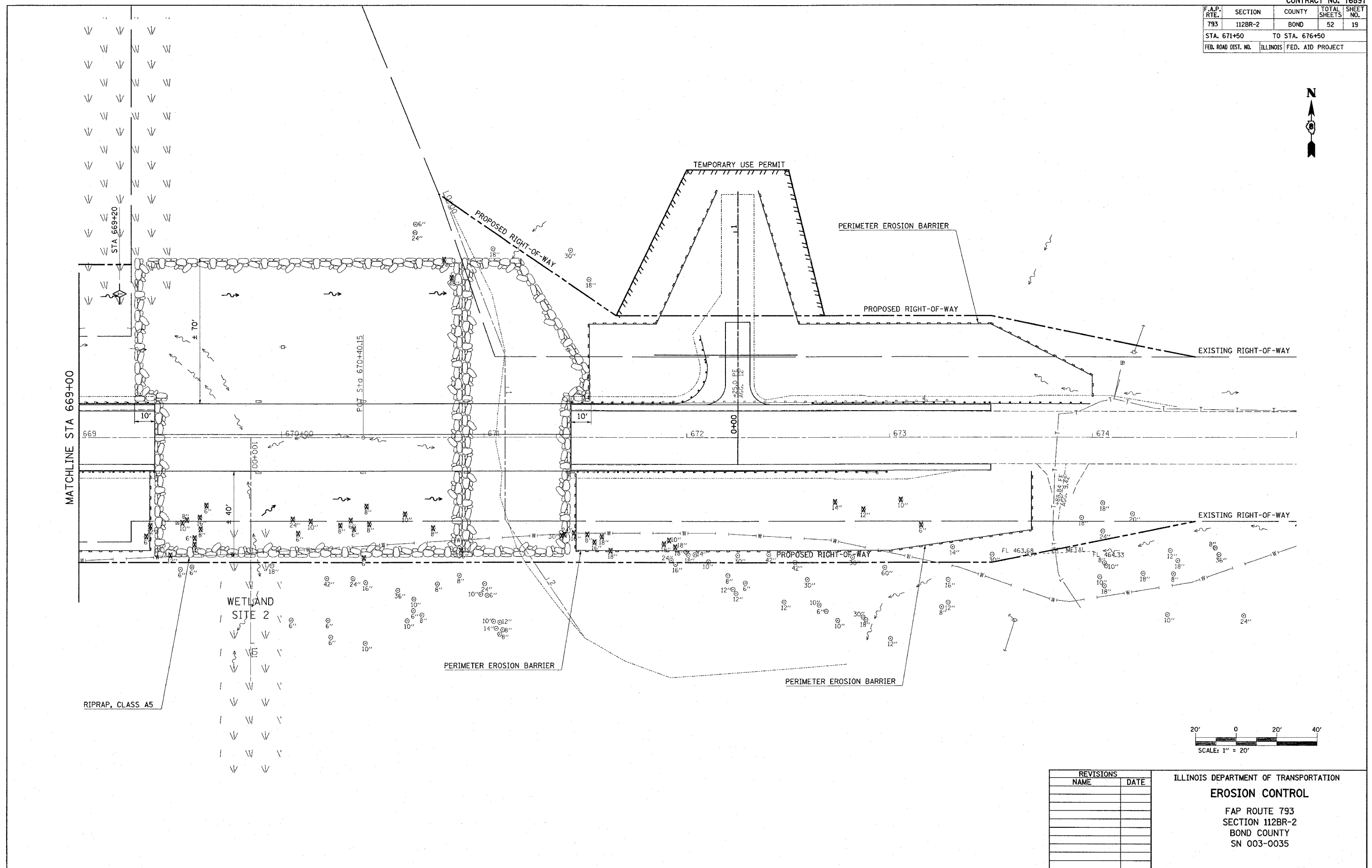

PLOT DATE = 6/12/2007  
 FILE NAME = c:\p\proj\sta\670\plan\p1-d3705.dgn  
 SCALE = 1" = 20'  
 REFERENCE = 4852

REVISIONS	
NAME	DATE

ILLINOIS DEPARTMENT OF TRANSPORTATION  
**EROSION CONTROL**  
 FAP ROUTE 793  
 SECTION 112BR-2  
 BOND COUNTY  
 SN 003-0035