

STATE OF ILLINOIS  
DEPARTMENT OF TRANSPORTATION

ROUTE NO.	SECTION	COUNTY	TOTAL SHEETS	SHEET NO.	SHEET NO. 12
F.A.P. RTE. 793	112BR-2	BOND	52	40	15 SHEETS
FED. ROAD DIST. NO. 7	ILLINOIS	FED. AID PROJECT-			

Contract #76897

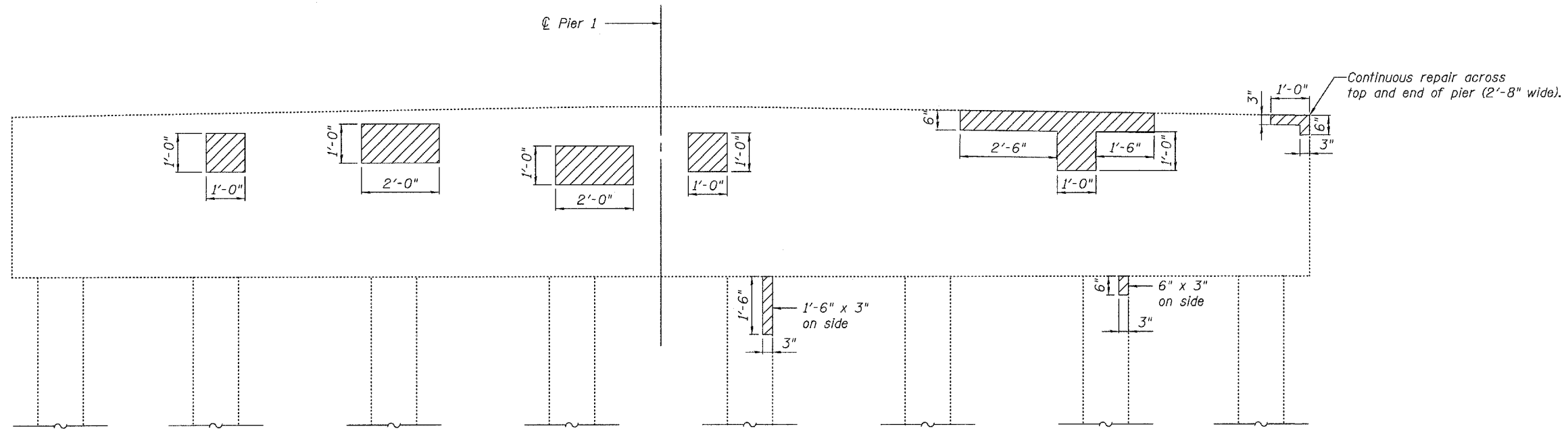

**WEST SIDE PIER 1**  
(Looking East)

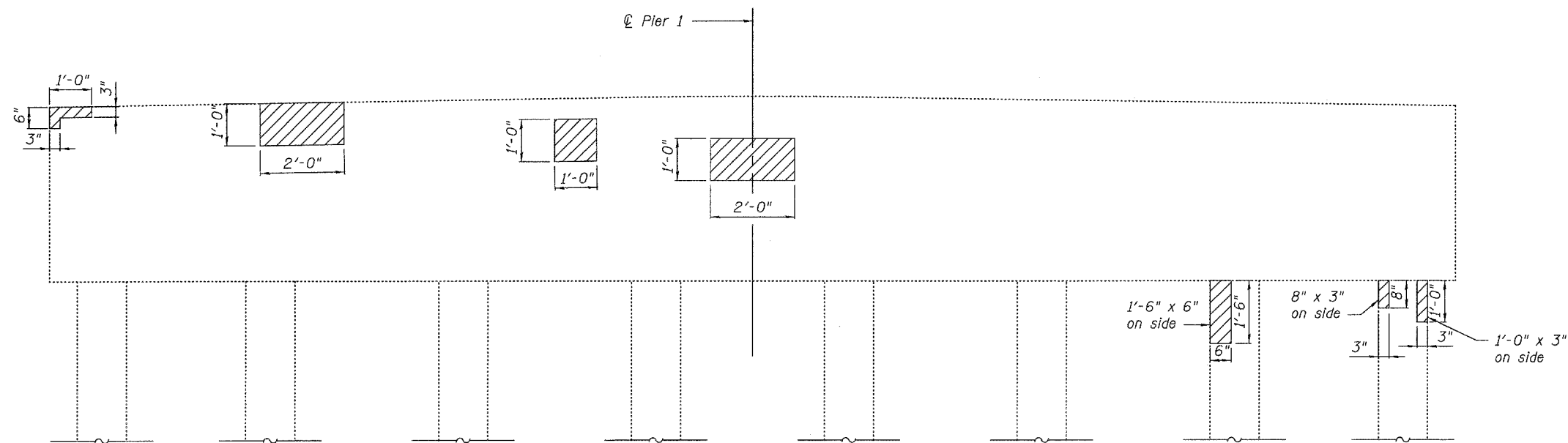

**EAST SIDE PIER 1**  
(Looking West)

**BILL OF MATERIAL**

Structural Repair of Concrete ( $\leq 5"$ )	Sq. Ft.	22
---	---------	----

Note:  
Hatched area indicates approximate area of Structural Repair of Concrete. Exact repair area to be determined by Engineer.

**PIER 1 STRUCTURAL REPAIR OF CONCRETE**  
**IL ROUTE 143 OVER BEAVER CREEK**  
**F.A.P. ROUTE 793 - SECTION 112BR-2**  
**BOND COUNTY**  
**STA. 670+40**  
**STRUCTURE NO. 003-0035**