

F.A.U. R.T.L.	SECTION	COUNTY	TOTAL SHEETS	SHEET NO.
1223	04-00272-00-TL	LAKE	72	29
TEMPORARY CABLE PLAN				
ILLINOIS				

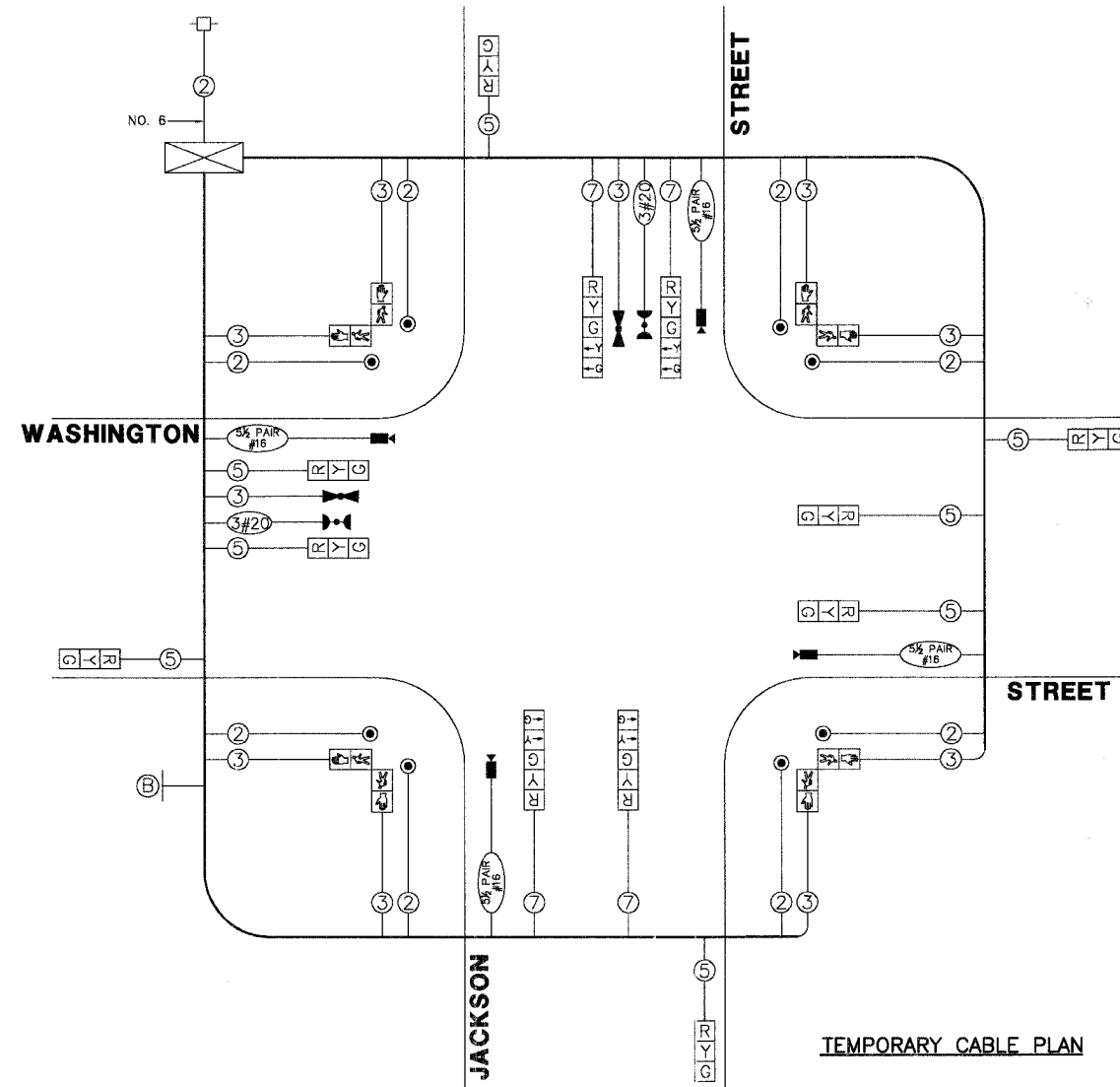

**TEMPORARY CABLE PLAN LEGEND**

- R TEMPORARY TRAFFIC SIGNAL SECTION OR PEDESTRIAN SIGNAL SECTION 12"
- TEMPORARY CONTROLLER CABINET
- TEMPORARY SERVICE INSTALLATION
- INDICATES NUMBER OF CONDUCTORS IN CABLE. ALL CONDUCTORS TO BE NUMBER 14 AWG WIRE UNLESS OTHERWISE NOTED.
- 5 EMERGENCY VEHICLE LIGHT DETECTOR
- CONFIRMATION BEACON
- VEHICLE DETECTOR, INDUCTION LOOP
- O PEDESTRIAN PUSHBUTTON DETECTOR
- P PEDESTRIAN SIGNAL HEAD
- VIDEO DETECTION CAMERA
- PTZ CAMERA
- LUMINAIRE
- TELEPHONE DROP
- MICROWAVE DETECTOR

TEMPORARY CABLE PLAN

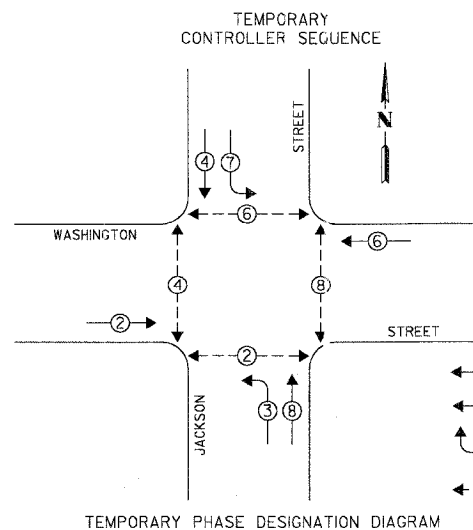

TEMPORARY PHASE DESIGNATION DIAGRAM

- LEGEND**
- S SINGLE ENTRY PHASE
  - D DUAL ENTRY PHASE
  - O OVERLAP
  - P PEDESTRIAN PHASE
  - \* NUMBER REFERS TO ASSOCIATED PHASE

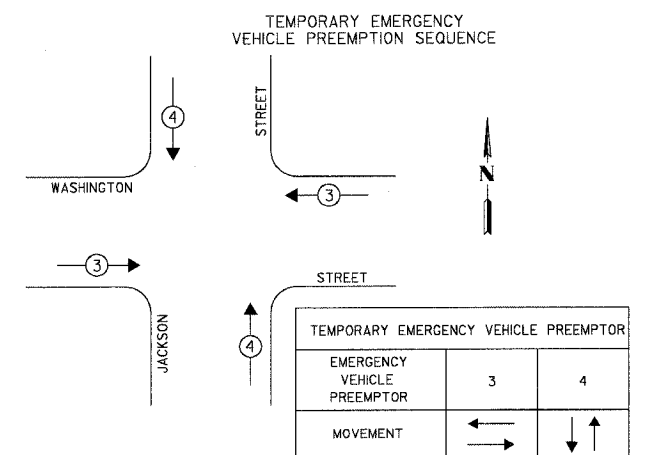

L.C.D.O.T. TRAFFIC SIGNAL INSTALLATION ELECTRICAL SERVICE REQUIREMENTS					TOTAL WATTAGE
TYPE	NO LAMPS	WATTAGE			
		INCAND.	L.E.D.	% OPERATION	
SIGNAL (RED)	12	135	10	0.50	810.0
SIGNAL (YELLOW)	12	135	19	0.10	162.0
SIGNAL (GREEN)	12	135	11	0.40	648.0
ARROW	8	135	9	0.10	108.0
PED.SIGNAL	8	90	9	1.00	720.0
CONTROLLER	1	100	100	1.00	100.0
LUMINAIRE			250	0.50	
L.E.D. ST. NAME SIGN			64	0.50	
VIDEO SYSTEM			150	1.00	
BATTERY BACKUP			25	1.00	
TOTAL =					2548.0

ENERGY COSTS - BILLED TO: CITY OF WAUKEGAN  
 (ADDRESS) 100 N. M.L.K. JR. AVENUE  
 (ADDRESS) WAUKEGAN, IL  
 ENERGY SUPPLY - CONTACT: MS. ALICE TAYLOR  
 PHONE: (847) 816-5323  
 COMPANY: COMED - LIBERTYVILLE

PLANS PREPARED BY:  
**GEWALT HAMILTON ASSOCIATES, INC.**  
 Consulting Engineers & Surveyors  
 850 Forest Edge Drive  
 Vernon Hills, IL 60061  
 (847) 478-9700  
 (847) 478-9700 Fax

REVISIONS	
NAME	DATE

LAKE COUNTY DIVISION OF TRANSPORTATION  
**TEMPORARY CABLE PLAN AND TEMPORARY PHASE DESIGNATION DIAGRAM**  
 WASHINGTON STREET AND JACKSON STREET  
 SCALE: NONE  
 DATE: MAY 1, 2007  
 DRAWN BY: PJS  
 DESIGNED BY: JRD  
 CHECKED BY: BLS