

SECTION 15, TOWNSHIP 36, RANGE 14
 SECTION 16, TOWNSHIP 36, RANGE 14
 SECTION 9, TOWNSHIP 36, RANGE 14
 SECTION 10, TOWNSHIP 36, RANGE 14

F. A. U. NO.	SECTION	COUNTY	TOTAL SHEETS	SHEET NO.
2806	07-00084-00-RS	COOK	016	006
STA. 62+00	TO STA. 88+93			
FED. ROAD DIST. NO.	SLABNO.	FED. AID PROJECT		

CONTRACT #83941

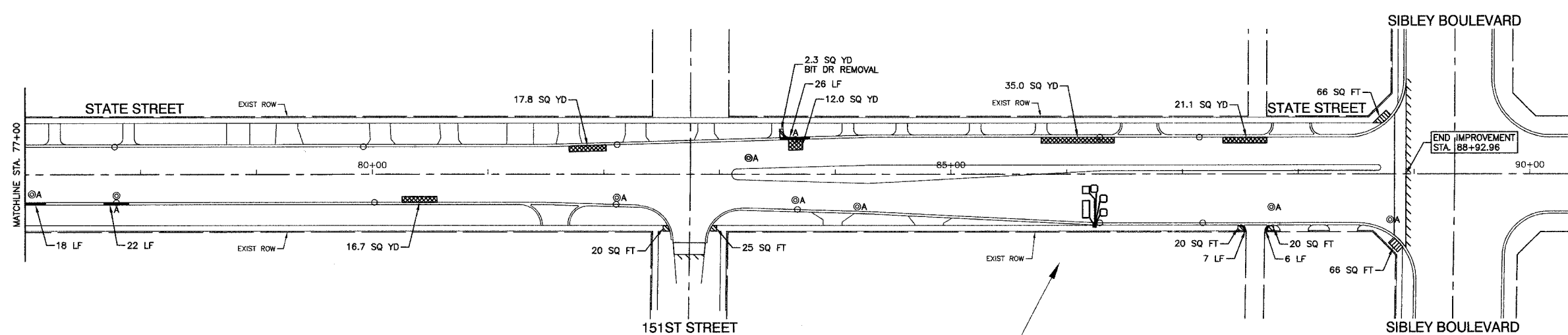
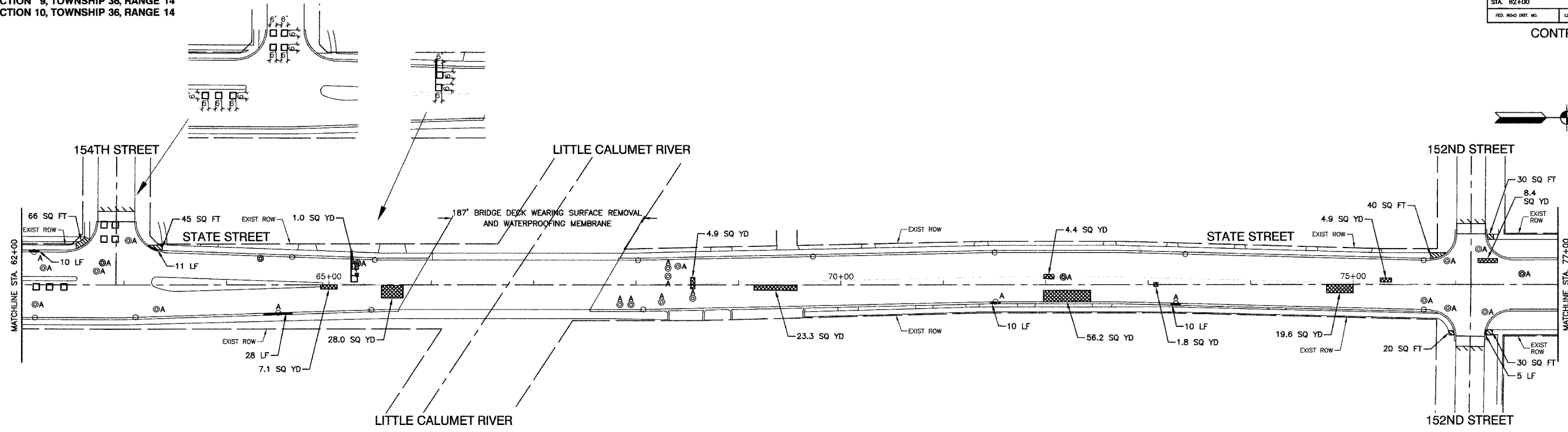
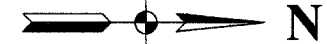

- LEGEND**
- BITUMINOUS PAVEMENT REPAIR
 - CONCRETE SIDEWALK REMOVAL AND REPLACEMENT
 - CURB REMOVAL
 - CONCRETE SIDEWALK REMOVAL AND REPLACEMENT
 - 10' BUTT JOINT (UNLESS OTHERWISE INDICATED)
 - STRUCTURE TO BE ADJUSTED
 - DETECTOR LOOP

REVISIONS	
NAME	DATE

ILLINOIS DEPARTMENT OF TRANSPORTATION

**STATE STREET
 STREET RESURFACING
 PAVEMENT PLAN**

SCALE: VERT. NA
 HORIZ. 1"=50'
 DATE 04-11-07

DRAWN BY PS/RG
 CHECKED BY PKB

ROBINSON ENGINEERING, LTD.
 17005 SOUTH PARK AVENUE, SOUTH HOLLAND, ILLINOIS 60470
 (708) 321-4700 FAX (708) 321-2828
 ILLINOIS DESIGN FIRM REGISTRATION NO. 156031-028

06106-PLAN-01