

E.A. RYE	SECTION	COUNTY	TOTAL SHEETS	SHEET NO.
525	06-00520-01-LT	WINNEBAGO	41	15
STA. 225+00		TO STA. 231+00		
FED. ROAD DIST. NO.		ILLINOIS FED. AID PROJECT		

LIGHTING PLANS

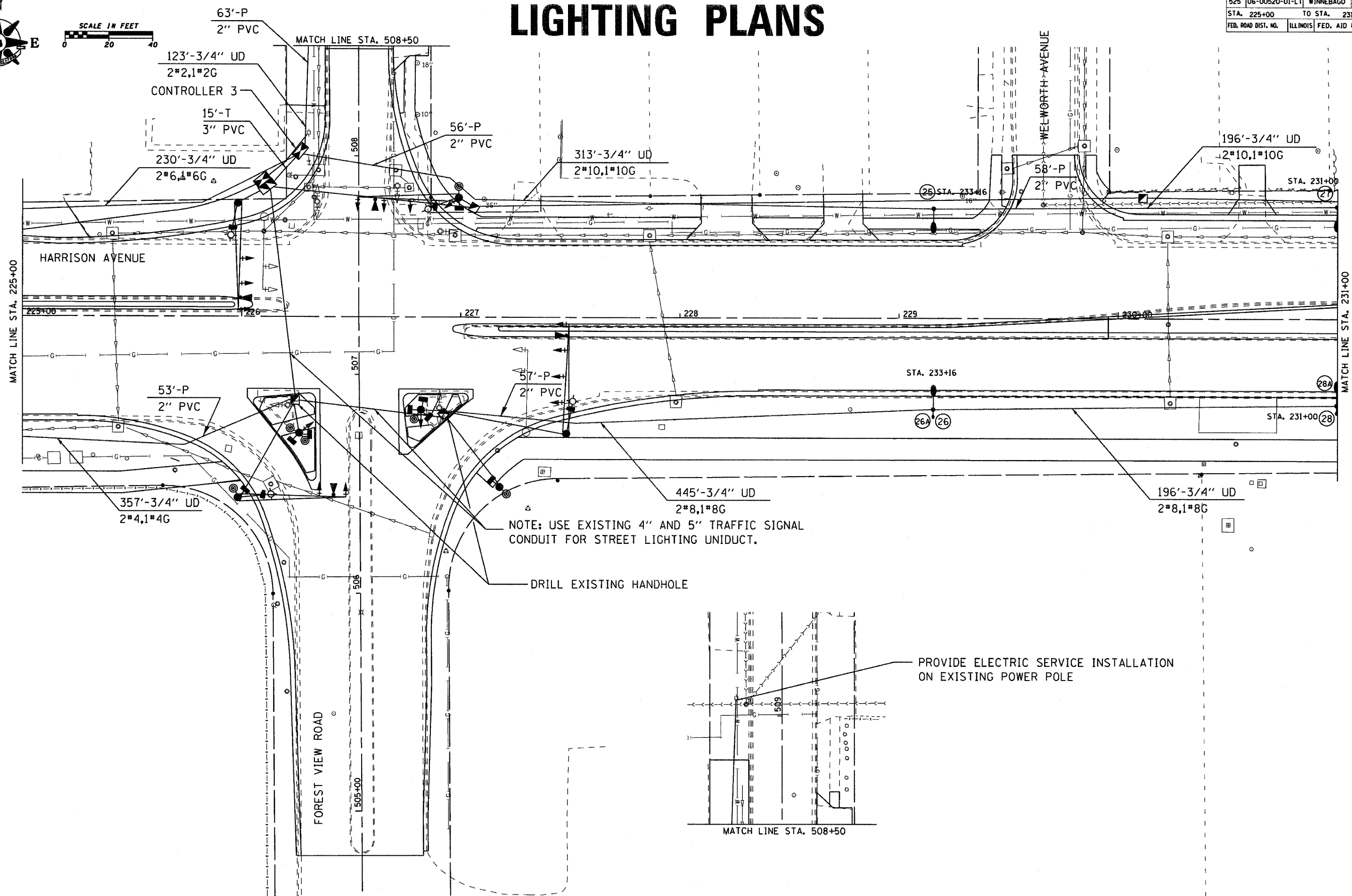
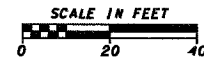

NOTE: USE EXISTING 4" AND 5" TRAFFIC SIGNAL CONDUIT FOR STREET LIGHTING UNIDUCT.

DRILL EXISTING HANDHOLE

PROVIDE ELECTRIC SERVICE INSTALLATION ON EXISTING POWER POLE

