

F.A.P. RTE. 1	SECTION	COUNTY	TOTAL SHEETS	SHEET NO.
591	06-00034-00-RP	KENDALL	37	17
STA. 9+00		TO STA. 11+15		
FED. ROAD DIST. NO. _		ILLINOIS	FED. AID PROJECT	

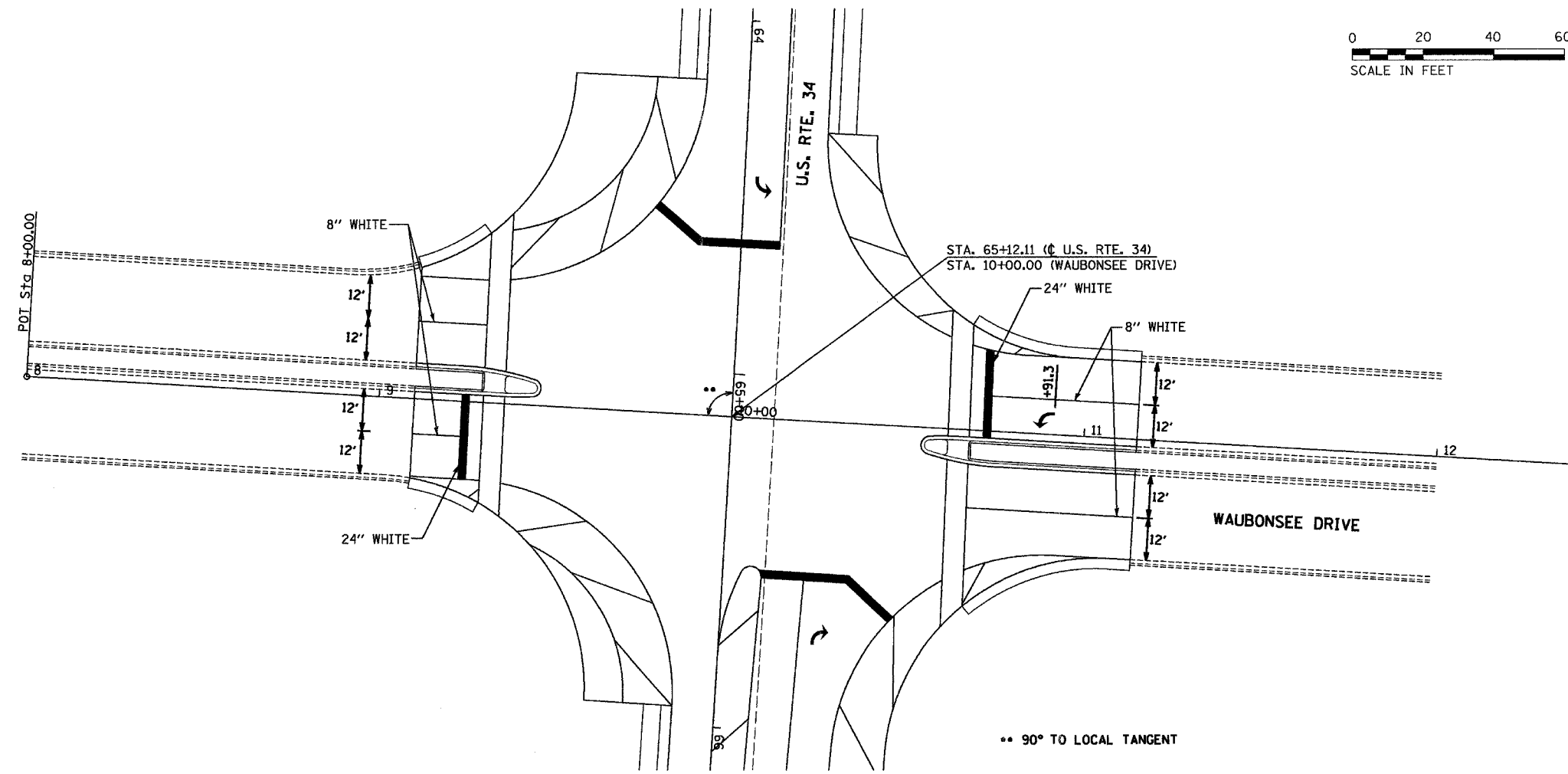
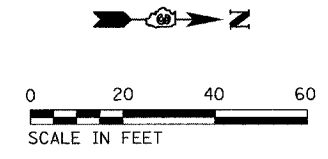

PLOT DATE = #DATE#
FILE NAME = #FILE#
PLOT SCALE = #SCALE#
USER NAME = #USER#

REVISIONS	
NAME	DATE

ILLINOIS DEPARTMENT OF TRANSPORTATION
PAVEMENT MARKING DETAILS
FAP 591 (US 34)
AND WAUBONSEE DRIVE
SECTION 06-00034-00-RP
KENDALL COUNTY

SCALE: VERT. _____
HORIZ. _____
DATE: 02/07

DRAWN BY: NOE/NV
CHECKED BY: DJD