

F.A.P. RTE.	SECTION	COUNTY	TOTAL SHEETS	SHEET NO.
*	**	KENDALL	37	24

STA. TO STA.
 FED. ROAD DIST. NO. ILLINOIS FED. AID PROJECT

* FAP 591 (US 34)
 ** SECTION 06-00034-00-RP



GRAPHIC SCALE

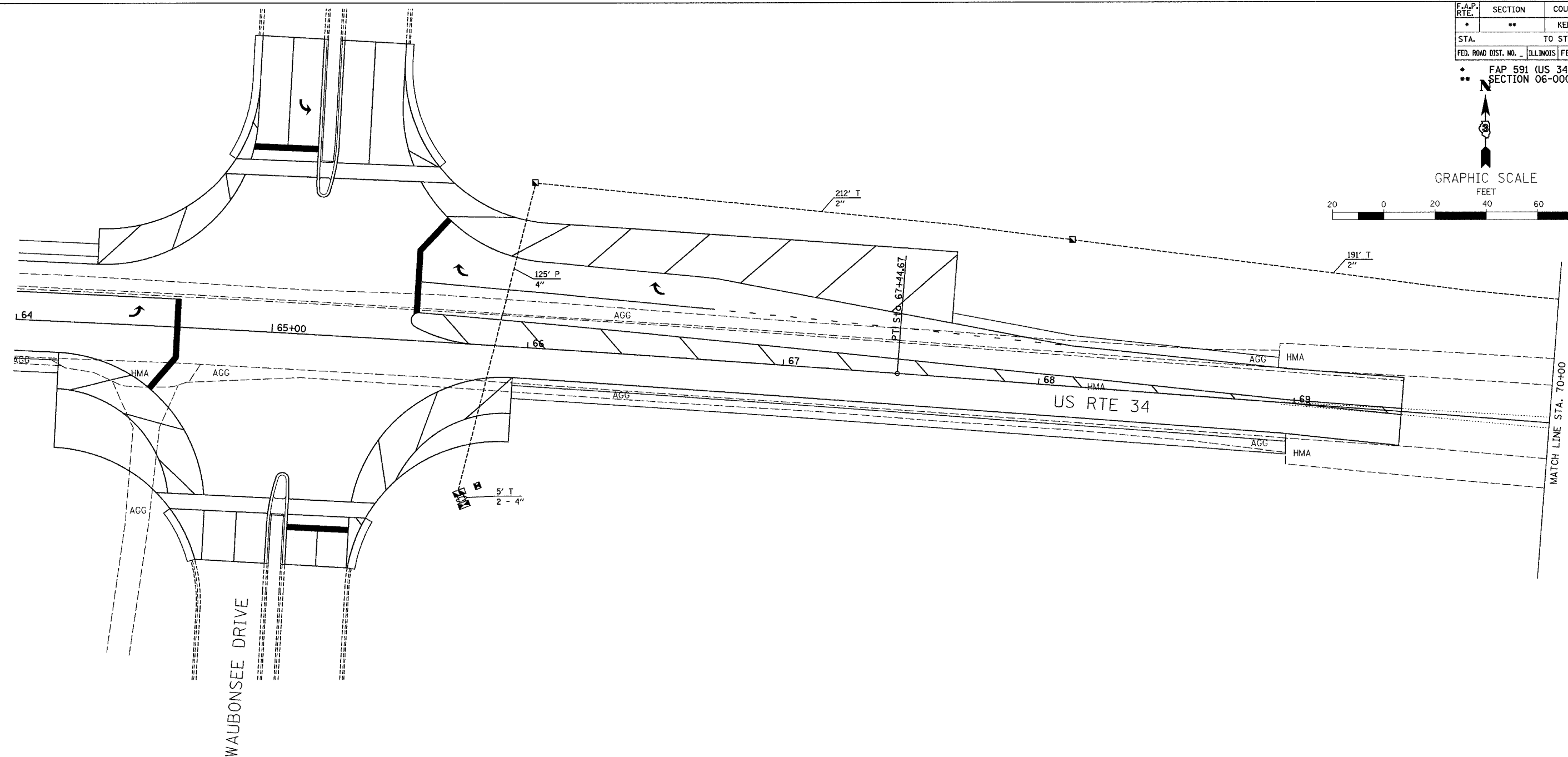
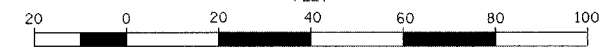

SCHEDULE OF QUANTITIES

DESCRIPTION	UNIT	TOTAL QUANTITY
TRANSCIEVER-FIBER OPTIC	EACH	1
ELECTRIC CABLE IN CONDUIT, TRACER, NO. 14 1C	FOOT	562
FIBER OPTIC CABLE IN CONDUIT, NO. 62.5/125, MM12F SM12F	FOOT	562

TRAFFIC SIGNAL LEGEND

- PROPOSED HANDHOLE, PORTLAND CEMENT CONCRETE
- PROPOSED DOUBLE HANDHOLE, PORTLAND CEMENT CONCRETE
- PROPOSED CONTROLLER AND TYPE IV CABINET
- EXISTING HANDHOLE
- PROPOSED CONDUIT
- EXISTING CONDUIT

REVISIONS	
NAME	DATE

ILLINOIS DEPARTMENT OF TRANSPORTATION
 TRAFFIC SIGNAL INTERCONNECT PLAN
 FAP 591 (US 34)
 AND WAUBONSEE DRIVE
 SECTION 06-00034-00-RP
 KENDALL COUNTY

SCALE: VERT.
 DATE 02/07

DRAWN BY ARR
 CHECKED BY JLS

PLOT DATE = 02/07
 FILE NAME = ZRIB97TSINTERC.DGN
 PLOT SCALE = 1" = 20'
 USER NAME = ARR