

ROUTE NO.	SECTION	COUNTY	TOTAL SHEETS	SHEET NO.
FAS 621	05-00075 05-R5	SANGAMON	72	16

CONTRACT NO. 93439

NO.	STATION - STATION	TYPE	DIA.	FOOT	C.L.S.M. CU. YD.
01	LT 8+60	P.R.C. FLARED END SECTIONS 24"			
02	8+66 - 8+84	S.S.-A1	24"	18	5
03	8+87 - 9+09	S.S.-A1	24"	30	14
04	9+12 - 10+14	S.S.-A1	24"	102	107
05	10+16 - 10+29	S.S.-A1	24"	22	5
06	10+32 - 10+44	S.S.-A1	24"	12	-
07	LT 10+50	P.R.C. FLARED END SECTIONS 24"			
					SUBTOTAL=131

NO.	STATION	OFFSET	STRUCTURE TYPE			DIA.	FRAME	TOP OF GRATE	INVERT	INVERT	INVERT
			MH	CB	INLET						
001	8+85	30' LT	RD			5'	T1 CL	633.1	629.1 (S)	629.2 (N)	
002	9+10	7.4' LT	RD			5'	T1 CL	633.4	629.3 (S)	629.4 (N)	
003	10+15	6.5' LT	RD			5'	T1 CL	634.1	630.2 (S)	630.3 (N)	
004	10+30	26' LT	RD			5'	T8 GRATE	633.5	630.4 (S)	630.5 (N)	

LOCATION	TYPE	24" FOOT
STA 8+62 TO 10+39	CMP	190
SUBTOTAL		190

- ⊙ DRAINAGE STRUCTURES
- STORM SEWER PIPE
- PROPOSED MANHOLE
- S.S.-B1 INDICATES STORM SEWERS, CLASS B, TYPE I OF THE SIZE INDICATED
- ▨ INDICATES PIPE CULVERT REMOVAL
- ▩ INDICATES LIMITS OF CLASS D PATCHES

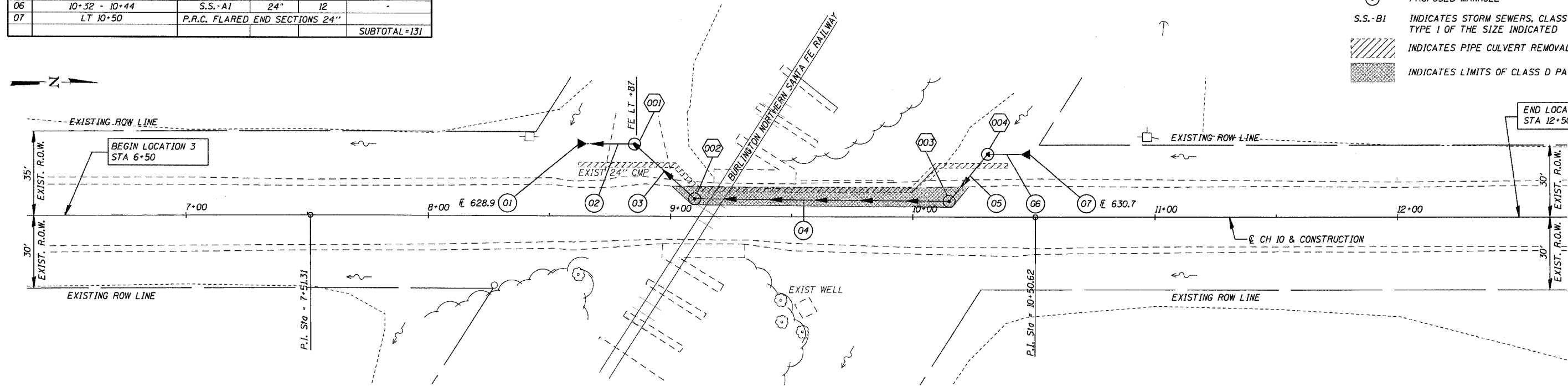

SW 1/4, NW 1/4, SEC 7, T13N, R7W, 3rd P.M.

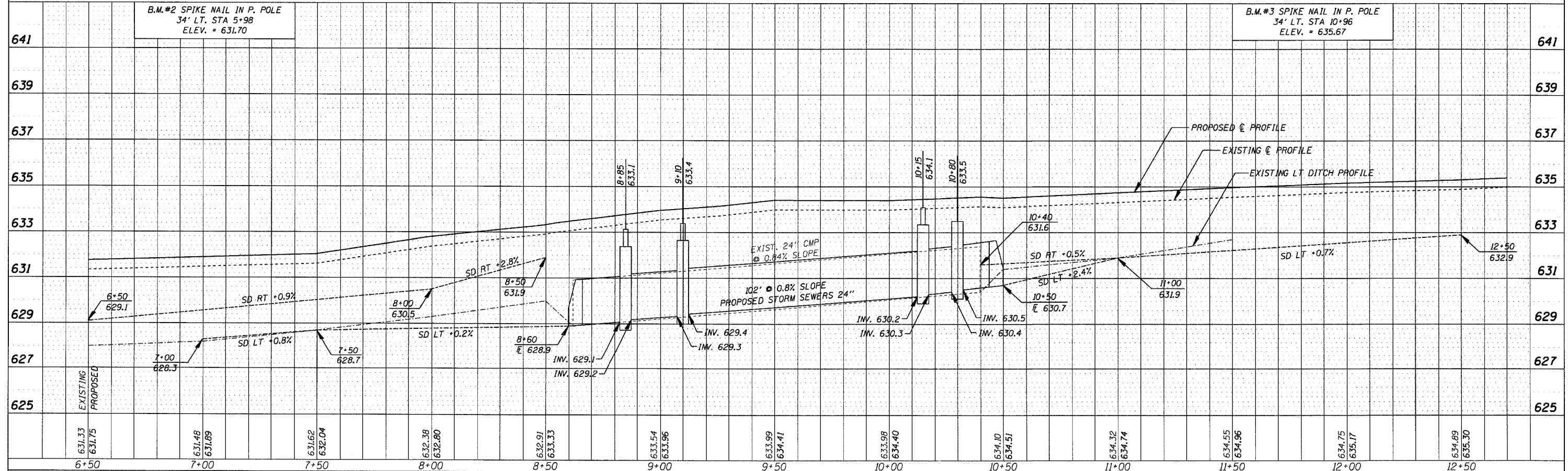

LOCATION 3 - DRAINAGE DETAILS - CH 10 - STA 6+50 TO STA 12+50

DATE: _____
BY: _____
SURVEYED: _____
CHECKED: _____
NOTE BOOK NO.: _____
FIELD FILE NAME: _____

DATE: _____
BY: _____
SURVEYED: _____
CHECKED: _____
NOTE BOOK NO.: _____
FIELD FILE NAME: _____