

ROUTE NO.	SECTION	COUNTY	TOTAL SHEETS	SHEET NO.
FAS 621	#	SANGAMON	72	30

* 05-00075-05-RS
CONTRACT NO. 93439

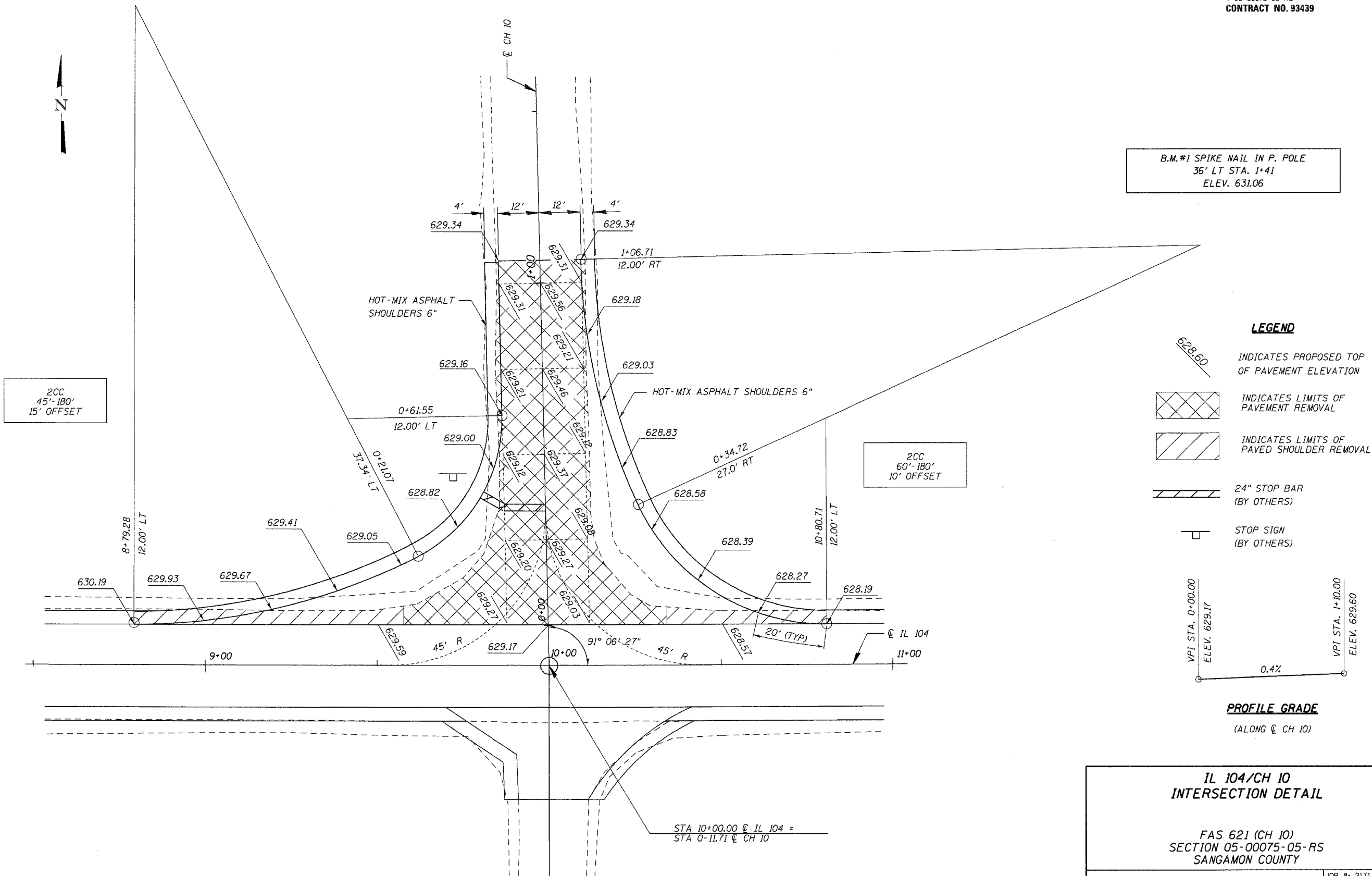

2CC
 45'-180'
 15' OFFSET

2CC
 60'-180'
 10' OFFSET

B.M. #1 SPIKE NAIL IN P. POLE
 36' LT STA. 1+41
 ELEV. 631.06

- LEGEND**
- 628.60 INDICATES PROPOSED TOP OF PAVEMENT ELEVATION
 - INDICATES LIMITS OF PAVEMENT REMOVAL
 - INDICATES LIMITS OF PAVED SHOULDER REMOVAL
 - 24" STOP BAR (BY OTHERS)
 - STOP SIGN (BY OTHERS)

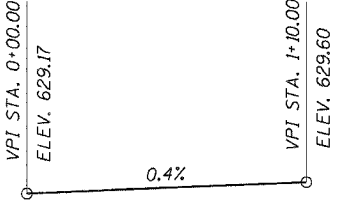

PROFILE GRADE
 (ALONG C L CH 10)

**IL 104/CH 10
 INTERSECTION DETAIL**

FAS 621 (CH 10)
 SECTION 05-00075-05-RS
 SANGAMON COUNTY

CUMMINS ENGINEERING CORPORATION

JOB #: 2171
 FILE: 2171INT
 DATE: 4/25/07

STA 10+00.00 C L IL 104 =
 STA 0+11.71 C L CH 10