

F.A.U. RTE.	SECTION	COUNTY	TOTAL SHEETS	SHEET NO.
8146	06-00029-00-TL	SANGAMON	67	25
STA. 196+00.00		TO STA. 202+30.00		
FED. ROAD DIST. NO.		ILLINOIS	FED. AID PROJECT#	
*HS-8146(003)				

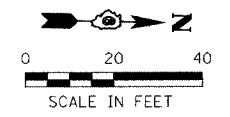

LEGEND

- SODDING
- SEEDING
- INLET AND PIPE PROTECTION
- PERIMETER EROSION BARRIER

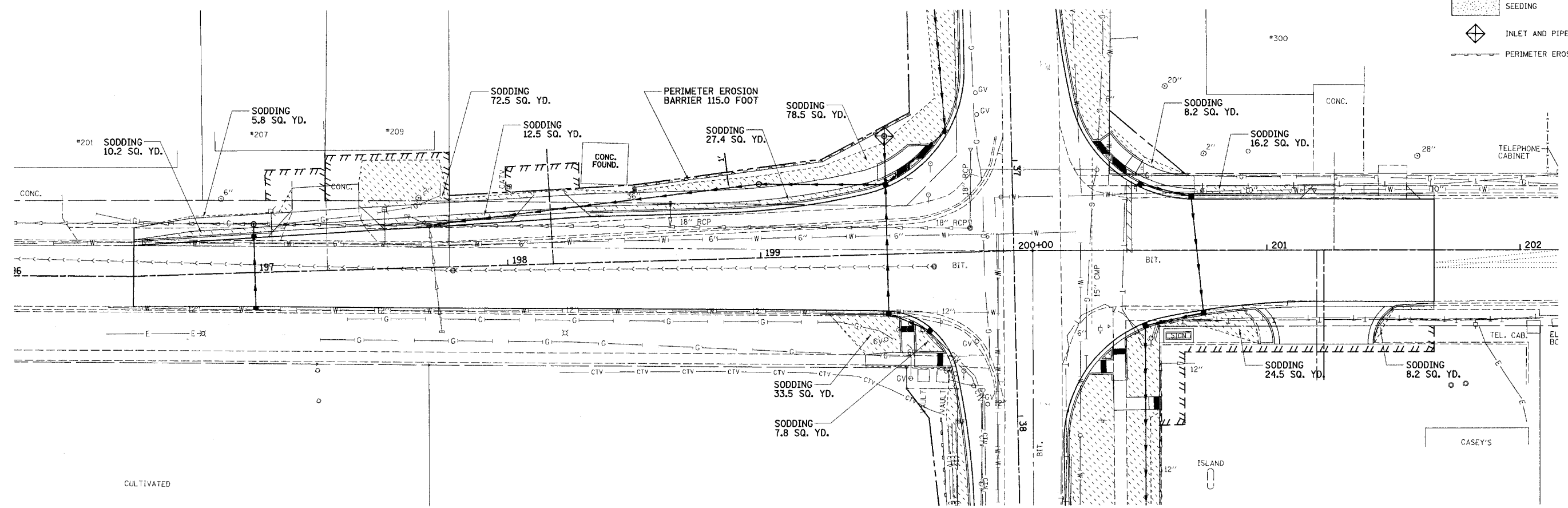

PLOT DATE = 5/24/2007
 FILE NAME = J:\06152\DRAWINGS\06152EC.dwg
 PLOT SCALE = 20.0000 / 1 IN.
 OPERATOR =

REVISIONS	
NAME	DATE
IDOT REVIEW	4/11/07

ILLINOIS DEPARTMENT OF TRANSPORTATION
EROSION CONTROL PLAN

VILLAGE OF CHATHAM
SECTION 06-00029-00-TL
SANGAMON COUNTY
WALNUT ST. / PARK AVE. IMPROVEMENTS

SCALE: VERT. _____
HORIZ. 1" = 20'

DATE: 2/01/07

DRAWN BY: SUTHEARD
CHECKED BY: BOTT

COMPUTER FILE NO.
06152EC
PROJECT 06152
5/24/07 - MDS

GREENE & BRADFORD, INC.
CONSULTING ENGINEERS
1015 N. WASHINGTON ST., CHATTANOOGA, TN 37403
TEL: 615-241-1111 FAX: 615-241-1112
WWW.GREENE-AND-BRADFORD.COM

VILLAGE OF CHATHAM - PARK AVENUE - EROSION CONTROL PLAN
STA. 196+00 TO STA. 202+20