

F.A.U. RTE.	SECTION	COUNTY	TOTAL SHEETS	SHEET NO.
8883	05-00090-01-TL	MADISON	39	18
FED. ROAD DIST. NO.	ILLINOIS	FED. AID PROJECT		
CONTRACT NO. 97213				

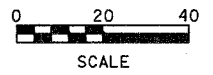

FINAL SURVEY	BY	DATE
SURVEY PLOTTED		
NOTE BOOK		
TEMP. AREAS CHECKED		
NO.		

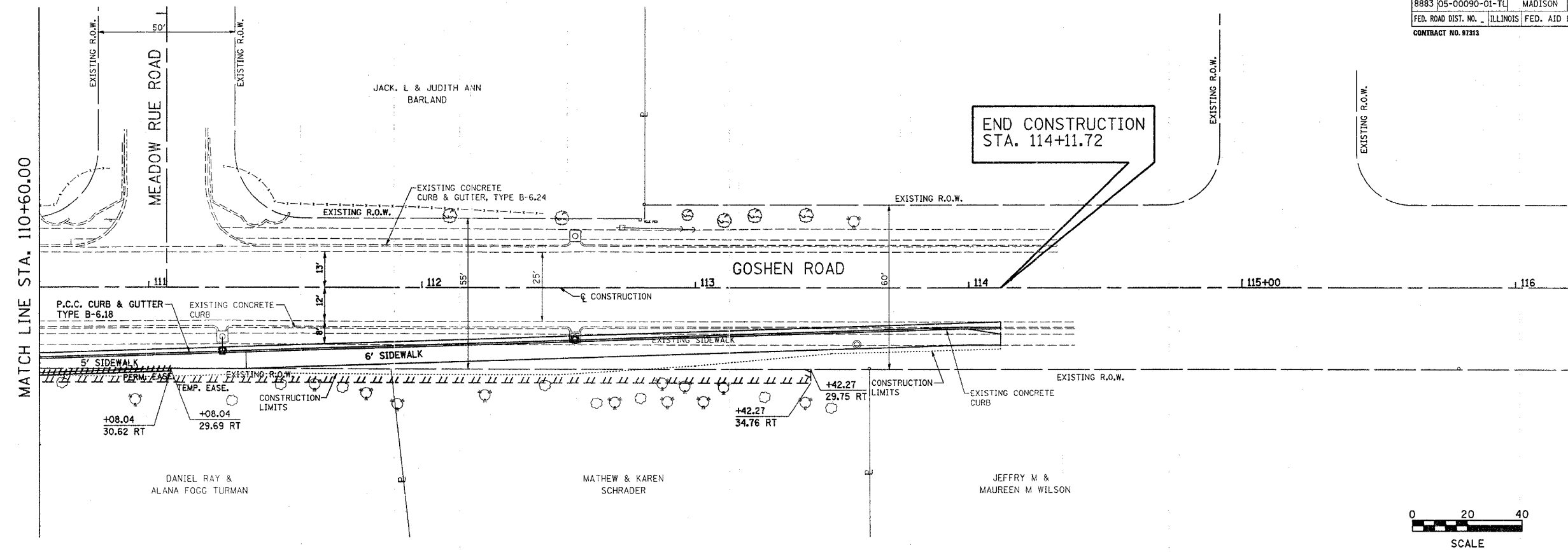

ORIGINAL SURVEY	BY	DATE
SURVEY PLOTTED		
NOTE BOOK		
TEMP. AREAS CHECKED		
NO.		

										T.B.M. - 60 "D" SPIKE IN WEST SIDE OF THE SECOND POWERPOLE ON THE EAST SIDE OF OLD TROY ROAD FROM GOSHEN ROAD. ELEV=561.703																					
565	EXISTING ROADWAY PROFILE																														
560																															
555																															
550																															
545																															
540																															
563.18	563.11	563.14	563.17	563.19	563.22	563.31	563.49	563.68	563.86	564.05	564.21	564.31	564.40	564.49	564.58																
																111+00 111+50 112+00 112+50 113+00 113+50															

Juneau Associates, Inc. P.C.
 CONSULTING ENGINEERS AND LAND SURVEYORS
 2108 State Street, P.O. Box 125 710 North Riverside Drive
 Granite City, Illinois 62040 Edwardsville, Illinois 62025
 Phone: (618) 877-1400 / (618) 482-5250 Phone: (618) 482-0000 / (618) 482-0000
 Fax: (618) 482-5241 Fax: (618) 482-0911

PLAN & PROFILE
 F.A.U. ROUTE 8883 & 8873
 GOSHEN AND OLD TROY ROADS
 EDWARDSVILLE, ILLINOIS
 SECTION No. 05-00090-01-TL

REVISIONS			
NO.	DATE	BY	REMARKS

SCALE: 1 Inch = 20 feet			
DSN. BY: BFK	DATE: 03/08/07	SHEET	
DWN. BY: JDH	DATE: 03/08/07	18	
CHK'D: BFK	DATE: 03/08/07		
DWG. NO.	JOB NO. E063800	DGN. NAME: PLAN 3	OF 39 SHTS