

Contract # 98775

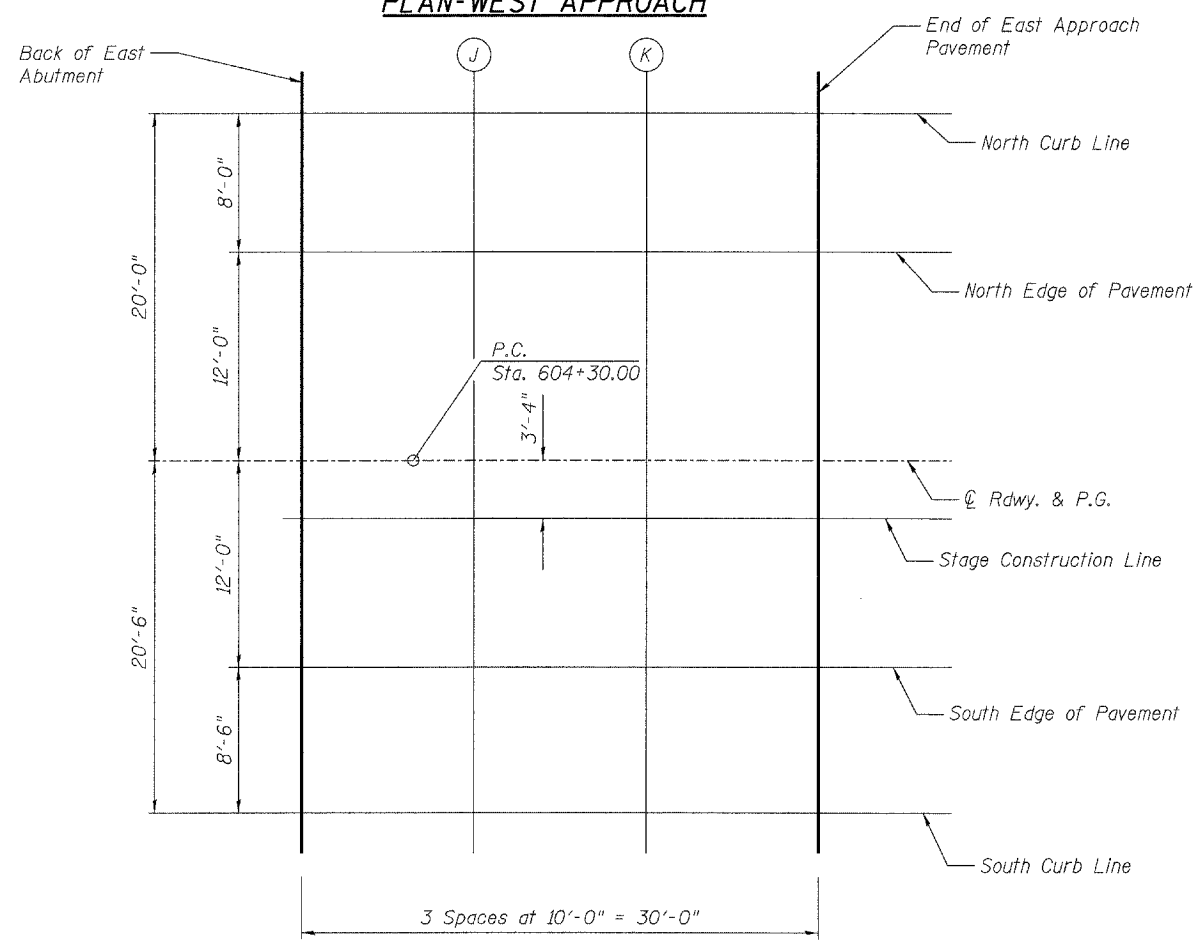
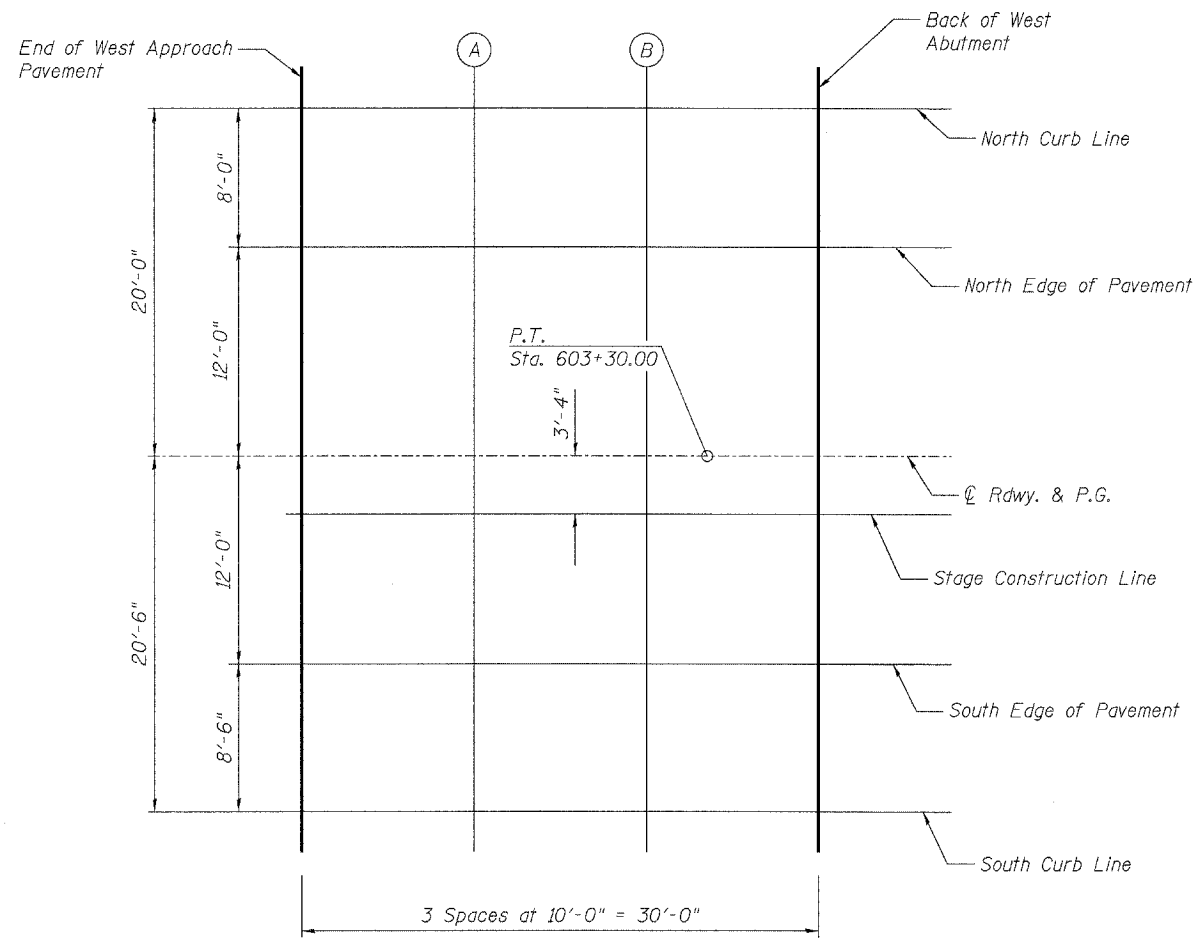

NORTH CURB LINE

Location	Station	Offset (ft)	Theoretical Grade Elevations
End W. Appr. Pav't.	603+06.27	-20.00	395.58
A	603+16.37	-20.00	395.63
B	603+26.47	-20.00	395.69
Bk. W. Abut.	603+36.50	-20.00	395.75
Bk. E. Abut.	604+23.50	-20.00	396.28
J	604+33.51	-20.00	396.37
K	604+43.53	-20.00	396.46
End E. Appr. Pav't	604+53.56	-20.00	396.55

NORTH EDGE OF PAVEMENT

Location	Station	Offset (ft)	Theoretical Grade Elevations
End W. Appr. Pav't.	603+06.36	-12.00	395.79
A	603+16.42	-12.00	395.82
B	603+26.48	-12.00	395.86
Bk. W. Abut.	603+36.50	-12.00	395.90
Bk. E. Abut.	604+23.50	-12.00	396.40
J	604+33.51	-12.00	396.49
K	604+43.52	-12.00	396.58
End E. Appr. Pav't	604+53.53	-12.00	396.67

PROFILE GRADE & ̄ ROADWAY

Location	Station	Offset (ft)	Theoretical Grade Elevations
End W. Appr. Pav't.	603+06.50	0.00	396.10
A	603+16.50	0.00	396.11
B	603+26.50	0.00	396.12
Bk. W. Abut.	603+36.50	0.00	396.14
Bk. E. Abut.	604+23.50	0.00	396.58
J	604+33.50	0.00	396.67
K	604+43.50	0.00	396.75
End E. Appr. Pav't	604+53.50	0.00	396.85

STAGE CONSTRUCTION LINE

Location	Station	Offset (ft)	Theoretical Grade Elevations
End W. Appr. Pav't.	603+06.54	3.33	396.18
A	603+16.52	3.33	396.18
B	603+26.51	3.33	396.19
Bk. W. Abut.	603+36.50	3.33	396.20
Bk. E. Abut.	604+23.50	3.33	396.63
J	604+33.50	3.33	396.71
K	604+43.49	3.33	396.80
End E. Appr. Pav't	604+53.49	3.33	396.90

SOUTH EDGE OF PAVEMENT

Location	Station	Offset (ft)	Theoretical Grade Elevations
End W. Appr. Pav't.	603+06.64	12.00	396.41
A	603+16.58	12.00	396.39
B	603+26.52	12.00	396.38
Bk. W. Abut.	603+36.50	12.00	396.38
Bk. E. Abut.	604+23.50	12.00	396.76
J	604+33.49	12.00	396.85
K	604+43.48	12.00	396.93
End E. Appr. Pav't	604+53.47	12.00	397.03

SOUTH CURB LINE

Location	Station	Offset (ft)	Theoretical Grade Elevations
End W. Appr. Pav't.	603+06.73	20.50	396.63
A	603+16.63	20.50	396.59
B	603+26.53	20.50	396.56
Bk. W. Abut.	603+36.50	20.50	396.54
Bk. E. Abut.	604+23.50	20.50	396.89
J	604+33.49	20.50	396.97
K	604+43.47	20.50	397.06
End E. Appr. Pav't	604+53.44	20.50	397.16

Note:
Offsets on the curved portion of approaches are measured radially.

REVISIONS

NAME	DATE

LIN ENGINEERING, LTD.
Consulting Engineers
Chatham, Illinois

Designed By: JBY Checked By: MTH Drawn By: AJF
Date: 12/06 File: 028-0076.DGN

ILLINOIS DEPARTMENT OF TRANSPORTATION
APPROACH PAVEMENT ELEVATIONS
ILLINOIS ROUTE 14 OVER
ANDY CREEK
F.A.P. ROUTE 869 - SECTION 104B-2
FRANKLIN COUNTY
STATION 603+80.00
STRUCTURE NO. 028-0076

E:\0602\Plans\028-0076.dgn 3:04:07 PM 5/7/2007