



SCHEDULE OF QUANTITIES

STEEL RAILING (TEMPORARY)			
STATION TO	STATION	FEET	
1581+79.29	1582+80.71	102	
		TOTAL	102
TEMPORARY CONCRETE BARRIER			
STATION TO	STATION	FEET	
1580+29	1581+79.29	150	
1582+80.71	1584+31	150	
		TOTAL	300
TEMPORARY BRIDGE TRAFFIC SIGNALS - 1 EACH			
TEMPORARY RUMBLE STRIPS - 6 EACH			
IMPACT ATTENUATORS, TEMPORARY (NON-REDIRECTIVE), TEST LEVEL 3 - 2 EACH			
TEMPORARY TRAFFIC BARRIER TERMINAL, TYPE 11 - 2 EACH			

CONTRACT NO. 98996

FAP RTE	SECTION	COUNTY	TOTAL SHEETS	SHEET NO.
869	(105A)BR-1	SALINE	44	7
STA. 1577+00		TO STA. 1587+00		
FED. ROAD DIST. NO.		ILLINOIS FED. AID PROJECT		

GENERAL NOTES

1. TRAFFIC CONTROL SHALL BE ERECTED AS SHOWN AND ACCORDING TO "TRAFFIC CONTROL AND PROTECTION, STANDARD 701321."
2. SEE SPECIAL PROVISIONS FOR ADDITIONAL TRAFFIC CONTROL REQUIREMENTS.
3. COORDINATE LOCATION OF SIGNALS WITH FINAL WORK AS DIRECTED BY THE ENGINEER.
4. CONSTRUCT TEMPORARY RUMBLE STRIPS AT LOCATIONS SHOWN ON STANDARD 701321.
5. STEEL RAILING (TEMPORARY) AND TEMPORARY CONCRETE BARRIER SHALL BE CONNECTED ACCORDING TO "TRAFFIC BARRIER TERMINAL TYPE 11, STANDARD 631051."
6. EXISTING TRAFFIC CONTROL PRESENT AT THE BRIDGE SITE IS TO REMAIN OPERATIONAL UNTIL STAGE I TC&P IS IMPLEMENTED. REMOVAL OF THE EXISTING TRAFFIC CONTROL WILL BE PAID FOR AS "TEMPORARY TRAFFIC CONTROL REMOVAL."

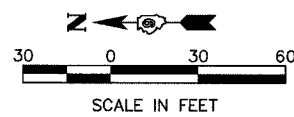
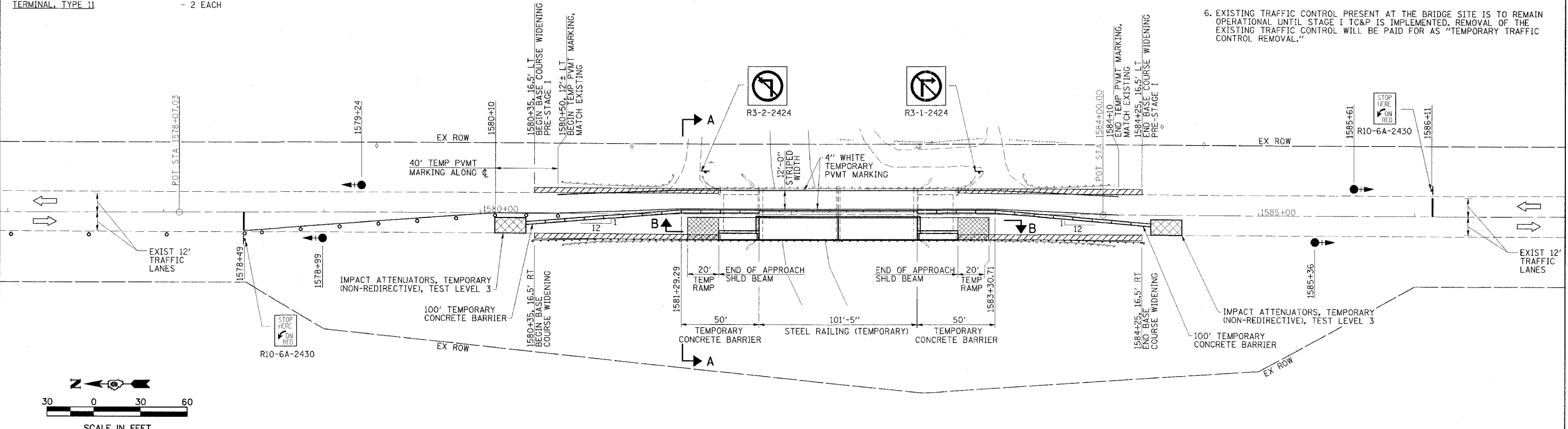

LEGEND

- TRAFFIC SIGNAL WITH BACKPLATE SIGNAL DIRECTION INDICATED
- BASE COURSE WIDENING 10"
- TEMPORARY RAMP
- PAVEMENT REMOVAL
- HMA SURFACE REMOVAL, 3 3/4"

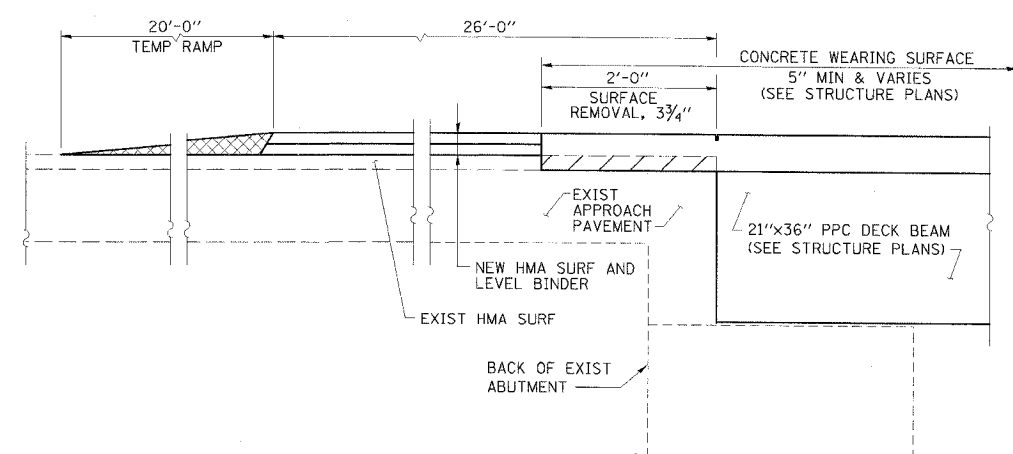
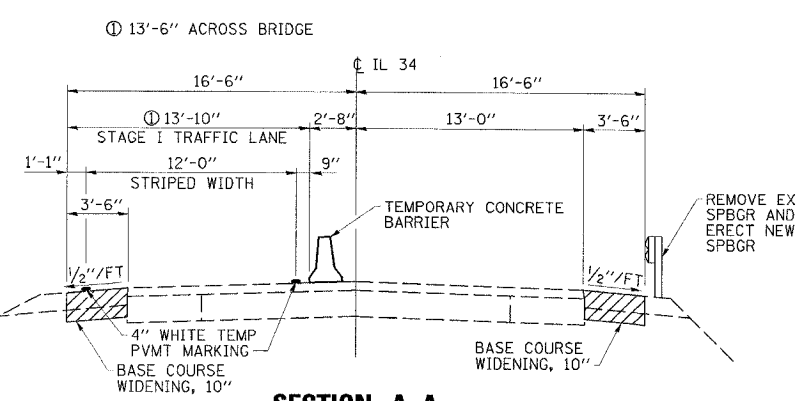

ESCA
CONSULTANTS, INC.

DESIGNED BY:	JMS/MTD	01/07
DRAWN BY:	KAH/DWH	01/07
CHECKED BY:	MTD	02/07
APPROVED BY:	RDP	04/07

STAGE I CONSTRUCTION
FAP RTE 869 (IL 34)
SECTION (105A)BR-1
SALINE COUNTY