

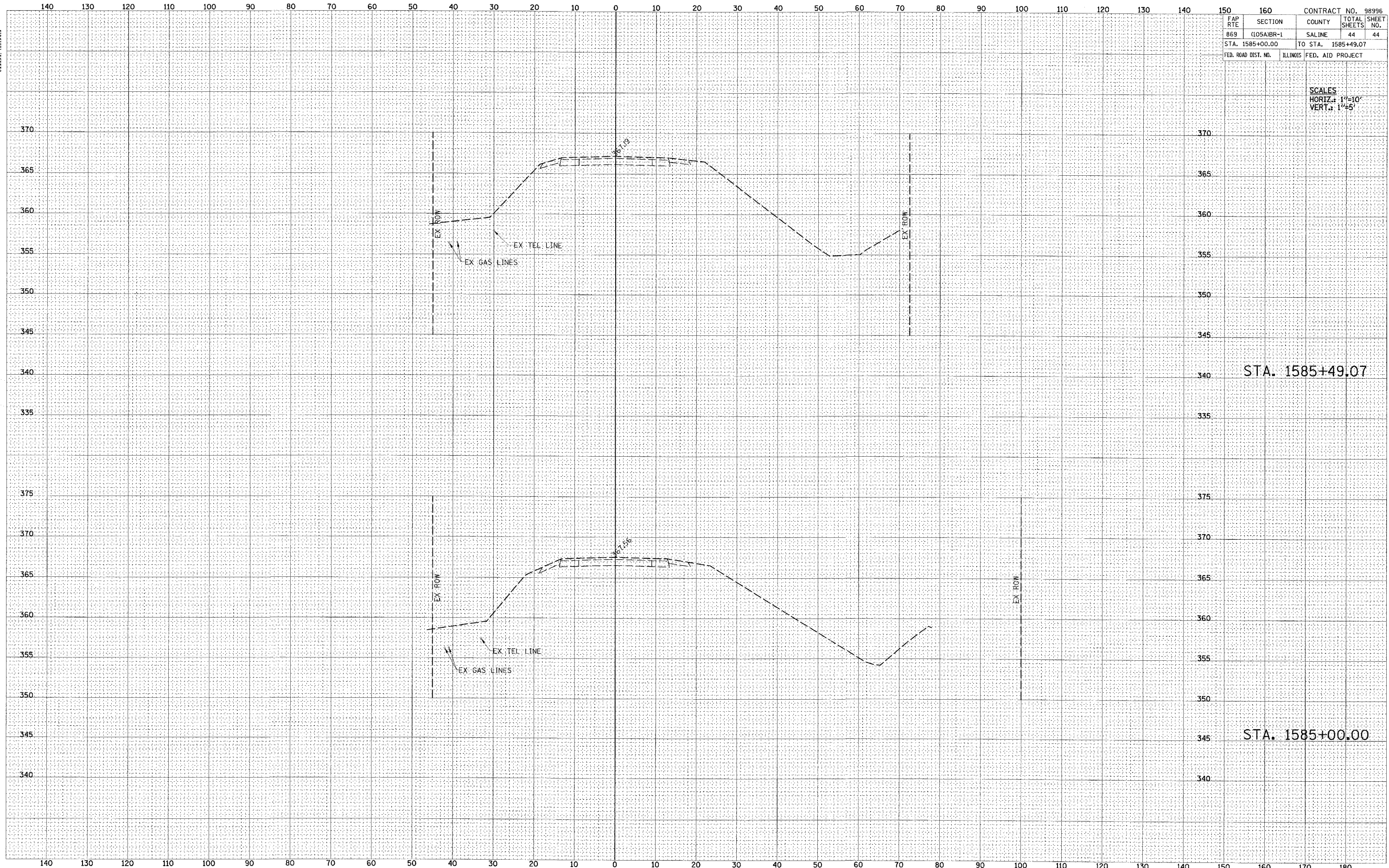

DATE	
BY	
FINAL SURVEY	
PLOTTED	
NOTE BOOK	
AREAS CHECKED	
NO.	

DATE	
BY	
ORIGINAL SURVEY	
PLOTTED	
NOTE BOOK	
AREAS CHECKED	
NO.	



CONTRACT NO. 98996				
FAP RTE	SECTION	COUNTY	TOTAL SHEETS	SHEET NO.
869	(105A)BR-1	SALINE	44	44
STA. 1585+00.00		TO STA. 1585+49.07		
FED. ROAD DIST. NO.		ILLINOIS FED. AID PROJECT		

SCALES
HORIZ.: 1"=10'
VERT.: 1"=5'

STA. 1585+49.07

STA. 1585+00.00