

- NOTES
- ELEVATIONS ARE SHOWN AT 25' INTERVALS AND ARE FOR INFORMATION ONLY. THE CONTRACTOR SHALL VERIFY ALL ELEVATIONS PRIOR TO CONSTRUCTION.
 - TRANSVERSE CONTRACTION JOINTS ARE TYPICALLY SPACED AT 15'. REFER TO IDOT STANDARDS 420001, 420101, 420106, 420201 AND 420401 FOR JOINT DETAILS AND SPACING.

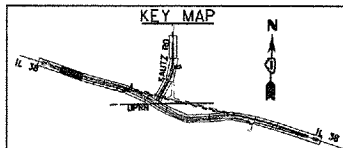
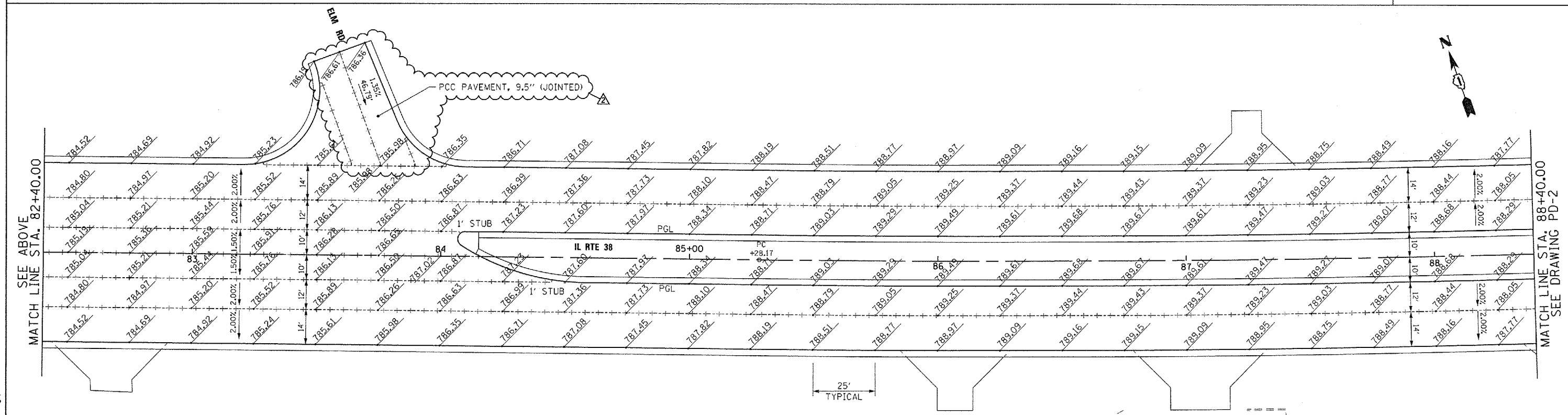
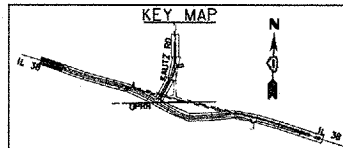

FILE NAME = D:\60122-SHT-PAVEMENT-DETAIL\S01.dgn	USER NAME = YK1m	DESIGNED - JTF	REVISED REV. 07/12/12	STATE OF ILLINOIS DEPARTMENT OF TRANSPORTATION	IL 38 PAVEMENT DETAILS			F.A.P. RTE. 347	SECTION LY (HB & VB)	COUNTY DUPAGE/KANE	TOTAL SHEETS 421	SHEET NO. 115
	PLOT SCALE = 1:20	CHECKED - EJG	REVISED -		SCALE: 1"=20'	SHEET NO. 1 OF 7 SHEETS	STA. BEGIN TO STA. 88+40	PD-1				
	PLOT DATE = 07/12/12	DATE - 03/07/12	REVISED -		CONTRACT NO. 60122							
								FED. ROAD DIST. NO. 1 ILLINOIS FED. AID PROJECT				