

**NOTES**

- ELEVATIONS ARE SHOWN AT 25' INTERVALS AND ARE FOR INFORMATION ONLY. THE CONTRACTOR SHALL VERIFY ALL ELEVATIONS PRIOR TO CONSTRUCTION.
- TRANSVERSE CONTRACTION JOINTS ARE TYPICALLY SPACED AT 15'. REFER TO IDOT STANDARDS 420001, 420101, 420106, 420201 AND 420401 FOR JOINT DETAILS AND SPACING.

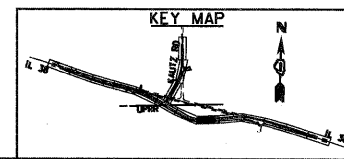
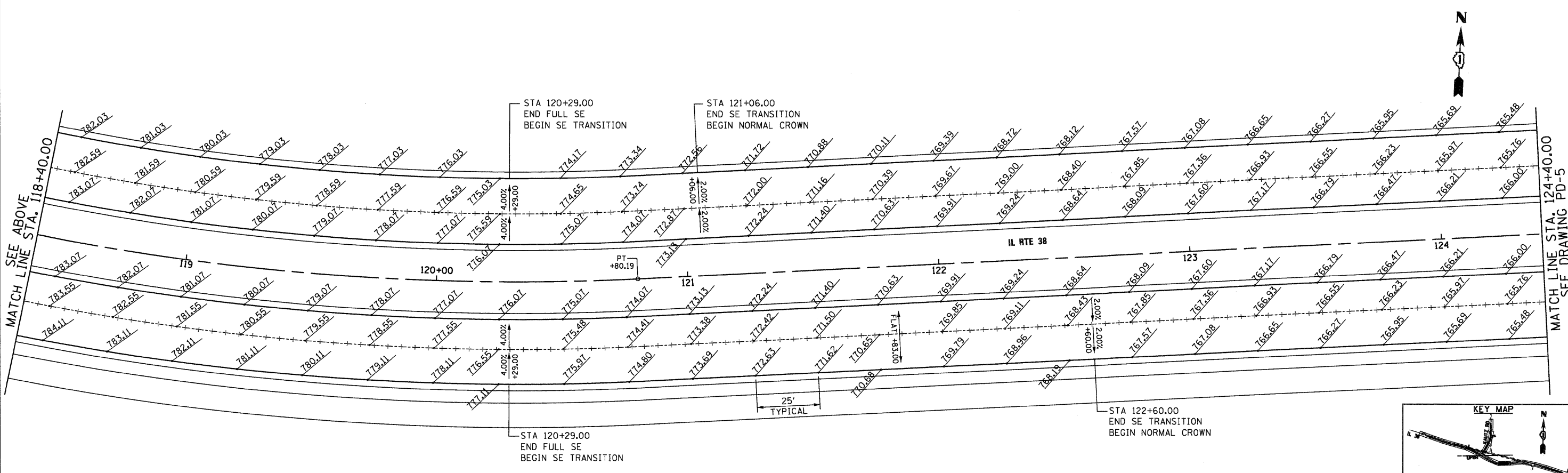
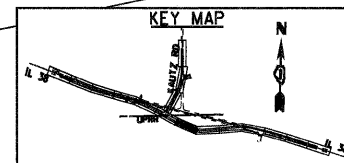
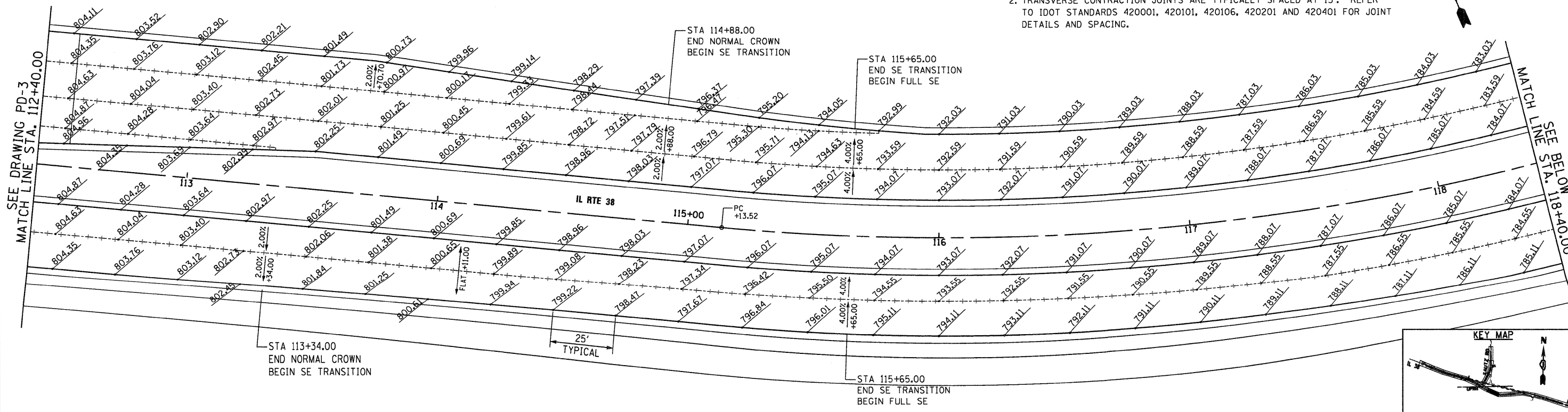

**McDonough Associates Inc.**  
 Engineers / Architects  
 130 East Randolph Street, Chicago, Illinois 60601

FILE NAME =  
 D168122-SHT-PAVEMENT-DETAILS04.dgn

USER NAME = EricG  
 PLOT SCALE = 1:20  
 PLOT DATE = 12/9/2011

DESIGNED - JTF  
 DRAWN - JTF  
 CHECKED - EJC  
 DATE - 12/09/11

REVISED -  
 REVISED -  
 REVISED -  
 REVISED -

**STATE OF ILLINOIS  
 DEPARTMENT OF TRANSPORTATION**

**IL 38 PAVEMENT DETAILS**

SCALE: 1"=20'    SHEET NO. 4 OF 7 SHEETS    STA. 112+40 TO STA. 124+40

F.A.P. RTE.	SECTION	COUNTY	TOTAL SHEETS	SHEET NO.
347	LY (HB & VB)	DUPAGE/KANE	421	118
<b>PD-4</b>		<b>CONTRACT NO. 60122</b>		
FED. ROAD DIST. NO. 1   ILLINOIS   FED. AID PROJECT				