

LEGEND

- ① PORTLAND CEMENT CONCRETE PAVEMENT 12" (JOINTED) (42000541)
- ② HOT-MIX ASPHALT SHOULDERS, 6" (48203021)
- ③ PORTLAND CEMENT CONCRETE PAVEMENT 10" (JOINTED) (J1420005)
- ④ AGGREGATE SHOULDERS WITH FILTER FABRIC, TYPE B 6" (J1481110)

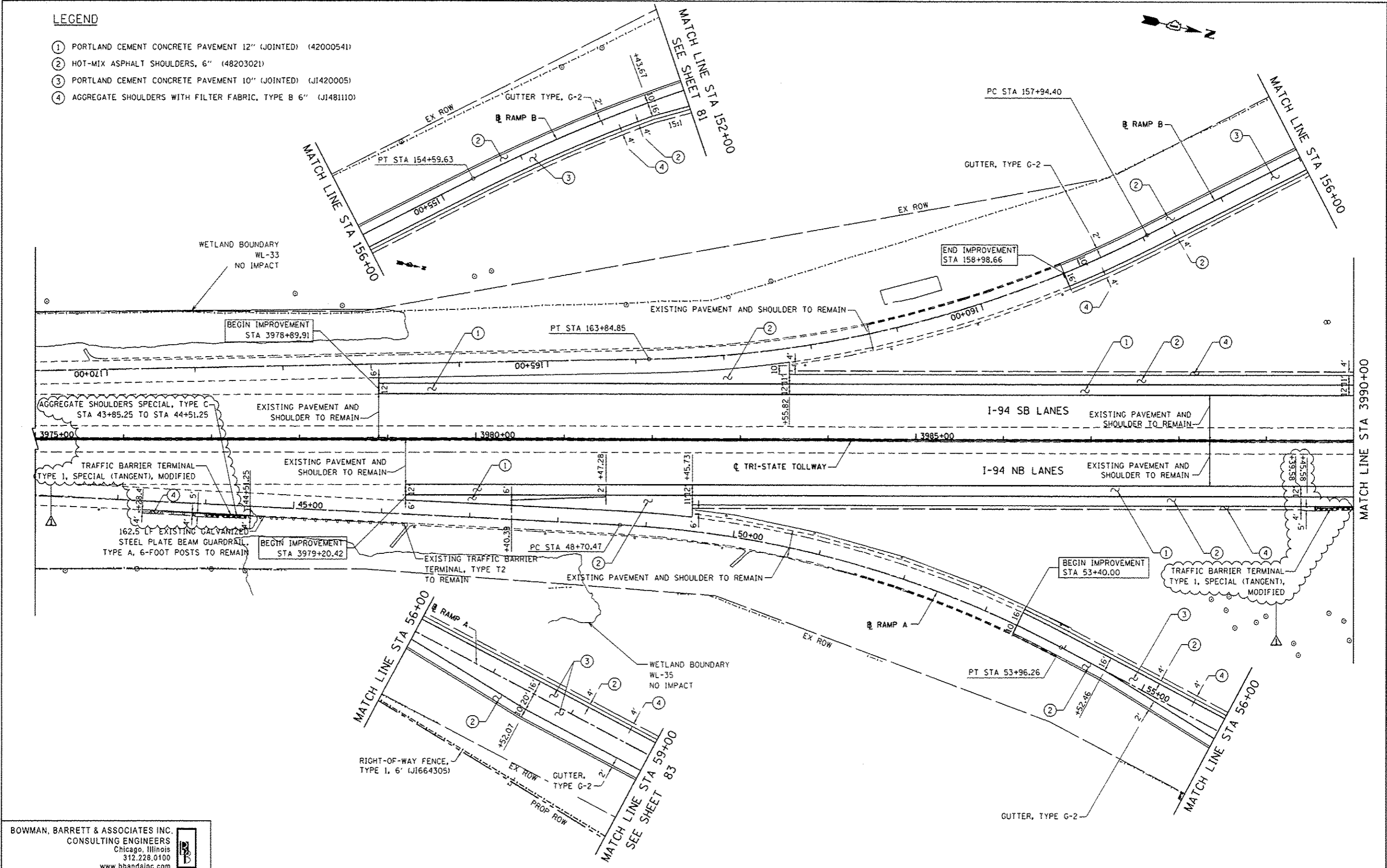

BOWMAN, BARRETT & ASSOCIATES INC.
 CONSULTING ENGINEERS
 Chicago, Illinois
 312.228.0100
 www.bbdainc.com

FILE NAME = #FILES#	USER NAME = default	DESIGNED - JDC	REVISED Δ 7/17/2012 JMK
		DRAWN - JDC	REVISED -
		CHECKED - RGR	REVISED -
		DATE - 6/19/2012	REVISED -

**STATE OF ILLINOIS
 DEPARTMENT OF TRANSPORTATION**

PROPOSED ROAD PLAN NB I-94 AND SB I-94
 SCALE: 1"=50' SHEET NO. 1 OF 9 SHEETS STA. 3975+00 TO STA. 3990+00

F.A. RTE. 94	SECTION 49-1-R-1	COUNTY LAKE	TOTAL SHEETS 677	SHEET NO. 70
CONTRACT NO. 60L77			ILLINOIS FED. AID PROJECT	

S:\1010\60L77\11\173\60L77_Sheets\066L77-1-1-1-1.dwg