

LEGEND

- ① PORTLAND CEMENT CONCRETE PAVEMENT 12" (JOINTED) (42000541)
- ② HOT-MIX ASPHALT SHOULDERS, 6" (48203021)
- ③ PORTLAND CEMENT CONCRETE PAVEMENT 10" (JOINTED) (J1420005)
- ④ AGGREGATE SHOULDERS WITH FILTER FABRIC, TYPE B 6" (J1481110)

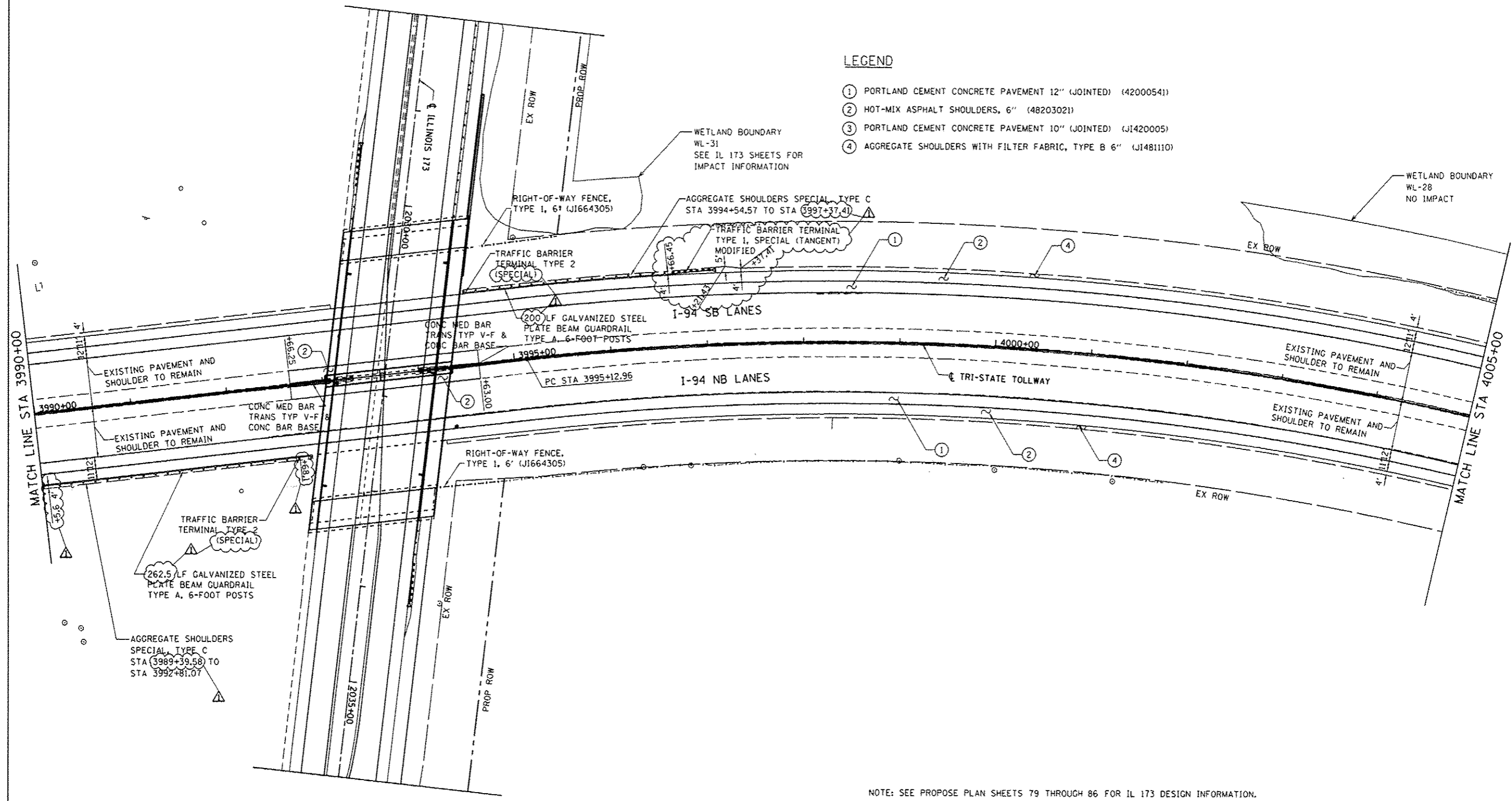

NOTE: SEE PROPOSE PLAN SHEETS 79 THROUGH 86 FOR IL 173 DESIGN INFORMATION.

BOWMAN, BARRETT & ASSOCIATES INC.
CONSULTING ENGINEERS
Chicago, Illinois
312.228.0100
www.bbainc.com

FILE NAME = #FILES#	USER NAME = default	DESIGNED - JDC	REVISED - 7/17/2012 JMK
		DRAWN - JDC	REVISED -
		CHECKED - RGR	REVISED -
		DATE - 6/19/2012	REVISED -

**STATE OF ILLINOIS
DEPARTMENT OF TRANSPORTATION**

PROPOSED ROAD PLAN NB I-94 AND SB I-94

SCALE: 1"=50' SHEET NO. 2 OF 9 SHEETS STA. 3990+00 TO STA. 4005+00

F.A. RTE.	SECTION	COUNTY	TOTAL SHEETS	SHEET NO.
94	49-1-R-1	LAKE	677	71
			CONTRACT NO. 60L77	
ILLINOIS FED. AID PROJECT				

S:\1818\MSD\06068\77 IL 173\60L77 Sheets\DIR\77-Plan\plan03.dgn