

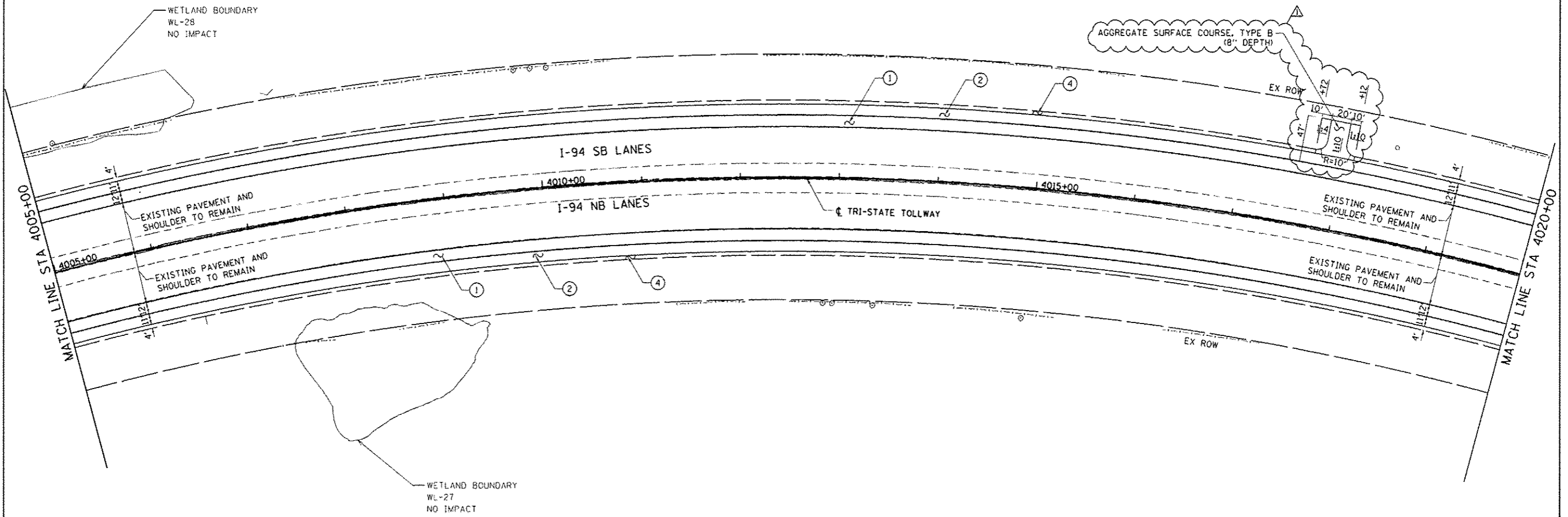

LEGEND

- ① PORTLAND CEMENT CONCRETE PAVEMENT 12" (JOINTED) (42000541)
- ② HOT-MIX ASPHALT SHOULDERS, 6" (48203021)
- ③ PORTLAND CEMENT CONCRETE PAVEMENT 10" (JOINTED) (J1420005)
- ④ AGGREGATE SHOULDERS WITH FILTER FABRIC, TYPE B 6" (J1481110)



BOWMAN, BARRETT & ASSOCIATES INC.
 CONSULTING ENGINEERS
 Chicago, Illinois
 312.228.0100
 www.bbainc.com

FILE NAME = #FILES4	USER NAME = default	DESIGNED - JDC	REVISED Δ - 7/17/2012 JMG
		DRAWN - JDC	REVISED -
	PLOT SCALE = 1/8"=1'-5"	CHECKED - RGR	REVISED -
	PLOT DATE = 7/15/2012	DATE - 6/19/2012	REVISED -

**STATE OF ILLINOIS
 DEPARTMENT OF TRANSPORTATION**

PROPOSED ROAD PLAN NB I-94 AND SB I-94	
SCALE: 1"=50'	SHEET NO. 3 OF 9 SHEETS
STA. 4005+00 TO STA. 4020+00	

F.A. RTE. 94	SECTION 49-1-R-1	COUNTY LAKE	TOTAL SHEETS 677	SHEET NO. 72
ILLINOIS FED. AID PROJECT			CONTRACT NO. 60L77	

S:\PROJECTS\60L77\1173460_27_Sheets\60L77_Plan\plan60L77.dwg