

**LEGEND**

- ① PORTLAND CEMENT CONCRETE PAVEMENT 12" (JOINTED) (42000541)
- ② HOT-MIX ASPHALT SHOULDERS, 6" (48203021)
- ③ PORTLAND CEMENT CONCRETE PAVEMENT 10" (JOINTED) (J1420005)
- ④ AGGREGATE SHOULDERS WITH FILTER FABRIC, TYPE B 6" (J1481110)

IN TOLLWAY SECTION, SEE TOLLWAY STANDARDS:

- GUARDRAIL INSTALLATION, SEE STANDARD C1
- TRAFFIC BARRIER TERMINAL, TYPE T1 (SPECIAL) TANGENT, SEE STANDARD C6
- TRAFFIC BARRIER TERMINAL, TYPE T2, SEE STANDARD C7
- TRAFFIC BARRIER TERMINAL, TYPE T5, SEE STANDARD C8
- TRAFFIC BARRIER TERMINAL, TYPE T6B, SEE STANDARD C10
- TRAFFIC BARRIER TERMINAL, TYPE T10, SEE STANDARD C11

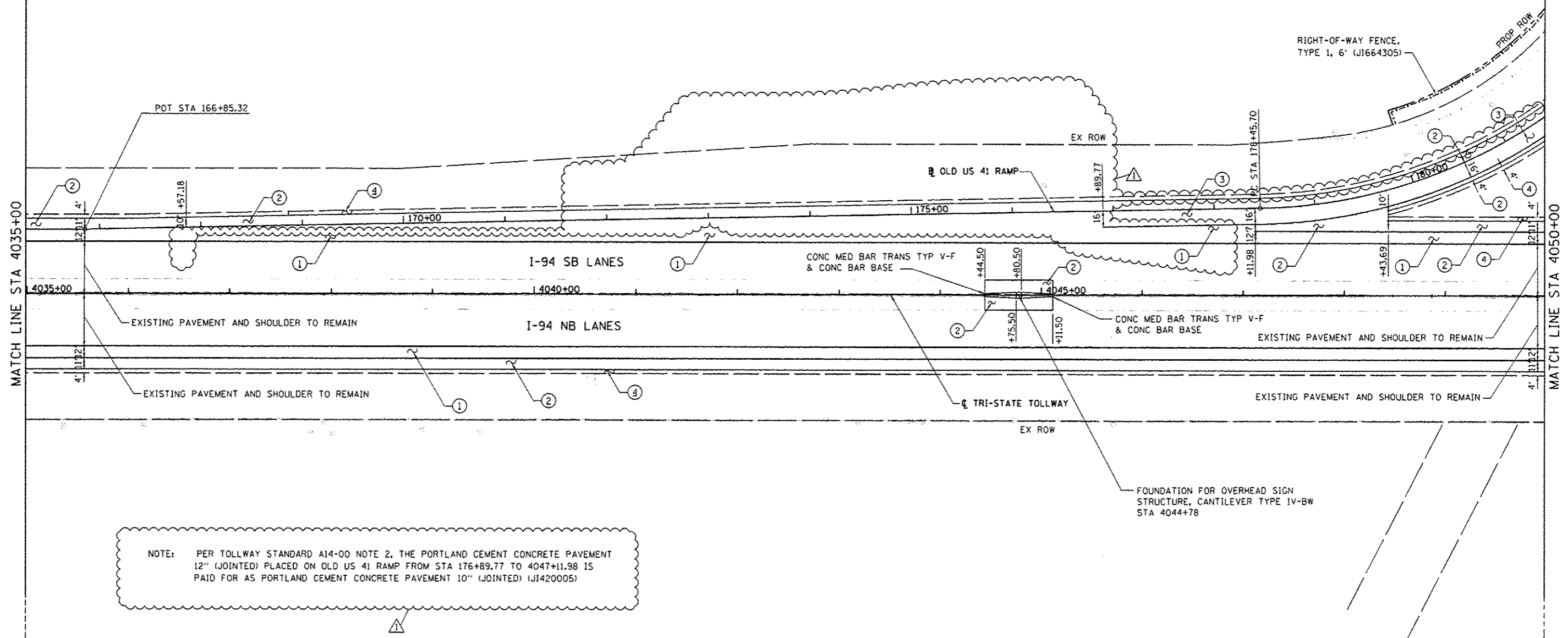

NOTE: PER TOLLWAY STANDARD A14-00 NOTE 2, THE PORTLAND CEMENT CONCRETE PAVEMENT 12" (JOINTED) PLACED ON OLD US 41 RAMP FROM STA 176+89.77 TO 4047+11.98 IS PAID FOR AS PORTLAND CEMENT CONCRETE PAVEMENT 10" (JOINTED) (J1420005)

BOWMAN, BARRETT & ASSOCIATES INC.  
CONSULTING ENGINEERS  
Chicago, Illinois  
312.228.0100  
www.bbainc.com

FILE NAME : #FILES*	USER NAME : default	DESIGNED - JDC	REVISED - 7/17/12 JDC
		DRAWN - JDC	REVISED -
		CHECKED - RGR	REVISED -
		DATE - 6/19/2012	REVISED -

STATE OF ILLINOIS  
DEPARTMENT OF TRANSPORTATION

PROPOSED ROAD PLAN NB I-94 AND SB I-94  
SCALE: 1"=50'  
SHEET NO. 5 OF 9 SHEETS  
STA. 4035+00 TO STA. 4050+00

F.A. RTE. - 94	SECTION - 49-1-R-1	COUNTY - LAKE	TOTAL SHEETS - 677	SHEET NO. - 74
CONTRACT NO. 60L177			[ILLINOIS] FED. AID PROJECT	

S:\181\181\181\CAD\98\77 IL 173\68\77 Sheets\A181R.77-INT\plan68.dwg