

PLAN	DATE
REVISED	
BY	
NOTED	
NO.	
FILE NAME	

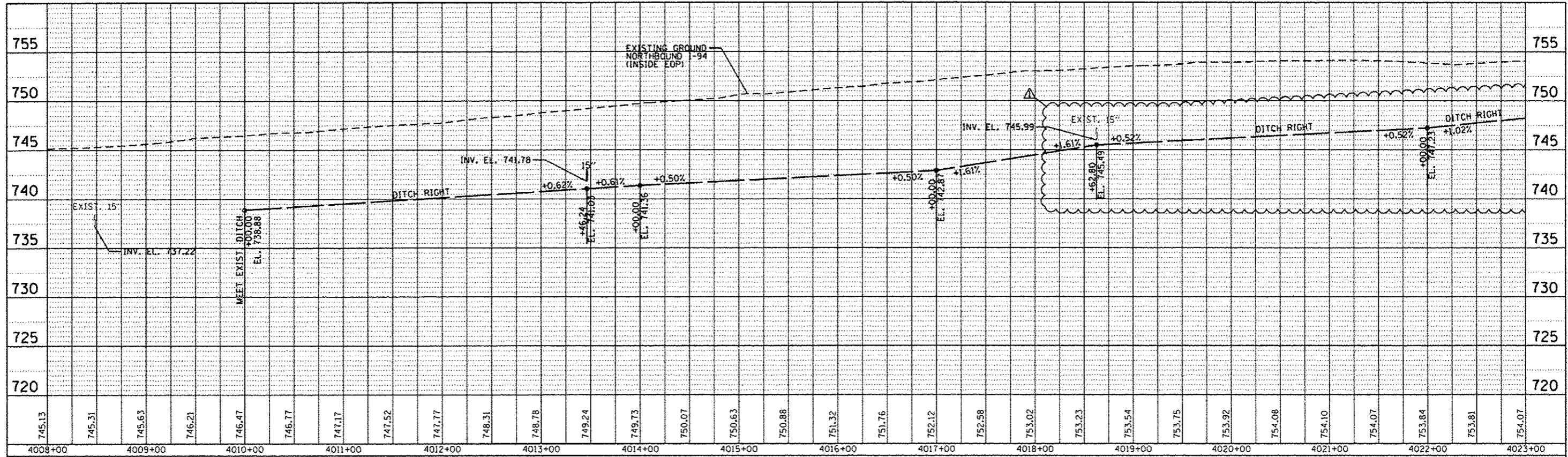

PROFILE	DATE
REVISED	
BY	
NOTED	
NO.	
FILE NAME	

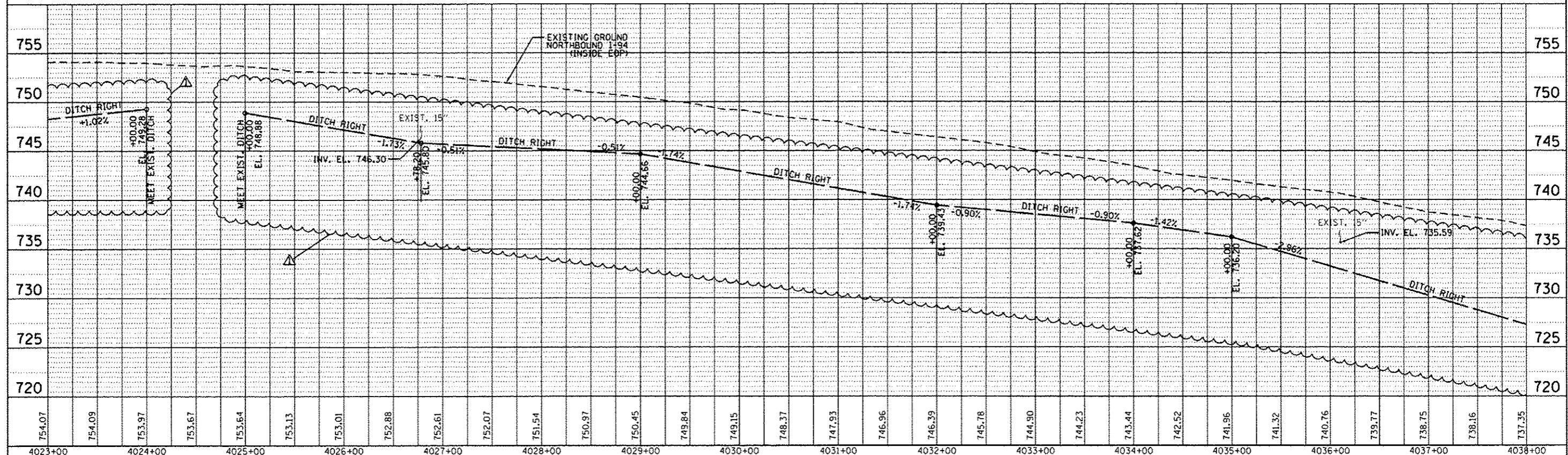

FILE NAME : D:\B\77-ent\drainage profile.dgn	USER NAME : default	DESIGNED - JAM	REVISED - 07/17/2012	STATE OF ILLINOIS DEPARTMENT OF TRANSPORTATION	PROPOSED DRAINAGE PROFILE NORTHBOUND I-94			F.A. RFE. 94 SECTION 49-1-R-1 COUNTY LAKE TOTAL SHEETS 677 SHEET NO. 202 CONTRACT NO. 60L77
PLOT SCALE = 1/4" = 10'	CHECKED - RGR	DATE - 6/19/2012	REVISED -		SCALE: 1" = 50'	SHEET NO. 2 OF 14 SHEETS	STA. 4008+00.00 TO STA. 4038+00.00	ILLINOIS FED. AID PROJECT
PLOT DATE = 7/17/2012	DATE - 6/19/2012	REVISED -	REVISED -					